

FOOTING SCHEDULE (3KSF)					
MARK	LENGTH	WIDTH	THICKNESS	REINFORCEMENT (BOT UNO)	REMARKS
F40	4' - 0"	4' - 0"	12"	6#5 EW	
F50	5' - 0"	5' - 0"	12"	7#4 EW	

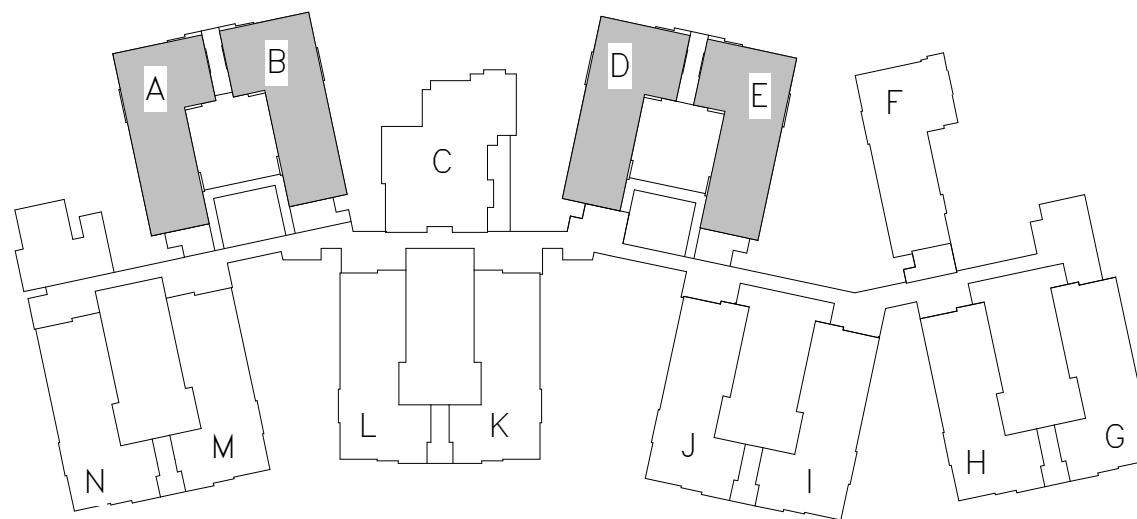

FOUNDATION PLAN - BLDGS A, B, D & E  
1/8" = 1'-0"

FINAL CONSTRUCTION DOCUMENTS  
FULLY SPRINKLERED

<b>CONSULTANTS:</b> <div><div><b>BURDETTE KOEHLER MURPHY &amp; ASSOCIATES, INC.</b> MECHANICAL/ELECTRICAL CONSULTING ENGINEERING 1416 CLARKVIEW ROAD, SUITE 500 BALTIMORE, MARYLAND 21209 410.323.0600 • FAX 410.377.2543 CENTURY ENGINEERING, INC. CIVIL &amp; STRUCTURAL ENGINEERING 10710 GILROY ROAD HUNT VALLEY, MARYLAND 21031 443.589.2400 • FAX 443.589.2401</div><div><b>KOFFEL ASSOCIATES, INC.</b> FIRE PROTECTION ENGINEERING 8815 CENTRE PARK DR., SUITE 200 COLUMBIA, MARYLAND 21045 410.790.2246 • FAX 410.702.2085 BUILDING COST CONSULTANTS COST ESTIMATING 12917 - 10TH AVENUE PLATTSMOUTH, NEBRASKA 68048 402.298.8290 • FAX 402.298.8290</div><div><b>ROBERT L. SEYMOUR ASSOCIATES</b> AUTOMATIC TRANSPORT ENGINEERING 182 THOMAS JOHNSON DR., SUITE 200 FREDERICK, MARYLAND 21702 301.662.9112 • FAX 301.662.9117 JOHN MILNER ASSOCIATES, INC. CULTURAL RESOURCES CONSULTANT 533 NORTH CHURCH ST. WEST CHESTER, PENNSYLVANIA 19380 610.436.9000 • FAX 610.436.8468</div><div><b>I.D.E.A.S., INC.</b> PLANT/PROCESS CONSULTANT 8085 CHORDON RD. KIRTLAND, OHIO 44094 440.295.1889 • FAX 440.295.1881</div></div>	<b>ARCHITECT/ENGINEERS:</b>  <b>POLT DESIGN GROUP</b> 2215 Conowingo Rd., Suite 101 Bel Air, Maryland 21015-1436 410.803.2141 410.836.6611 www.polt-design.com	<b>Drawing Title</b> UPPER LEVEL HOUSE FOUNDATION PLAN  <b>Approved:</b> Project Director	<b>Project Title</b> REPLACEMENT COMMUNITY LIVING CENTER  <b>Location</b> PERRY POINT VA MEDICAL CENTER  <b>Date</b> 06/08/18 <b>Checked</b> CEI <b>Drawn</b> CEI	<b>Project Number</b> 512-173 <b>Building Number</b> 370 <b>Drawing Number</b> SB102	<b>Office of Construction and Facilities Management</b>  Department of Veterans Affairs
---	---	---	---	---	---