

2ND. FLOOR INTERSTITIAL FRAMING PLAN WC.

DRAWING NUMBER  
I-527  
156-748

PLAN FIELD CORPORATION • IRVINE, CALIFORNIA  
REGISTERED ARCHITECTS AND ENGINEERS  
PROFESSIONAL SEAL OF STATE OF CALIFORNIA

PLAN FIELD CORPORATION • IRVINE, CALIFORNIA  
REGISTERED ARCHITECTS AND ENGINEERS  
PROFESSIONAL SEAL OF STATE OF CALIFORNIA

PLAN FIELD CORPORATION • IRVINE, CALIFORNIA  
REGISTERED ARCHITECTS AND ENGINEERS  
PROFESSIONAL SEAL OF STATE OF CALIFORNIA

DRAWING NUMBER  
I-527  
156-748

PLAN FIELD CORPORATION • IRVINE, CALIFORNIA  
REGISTERED ARCHITECTS AND ENGINEERS  
PROFESSIONAL SEAL OF STATE OF CALIFORNIA

10-26-67  
10-16-67  
10-3-67  
9-13-67

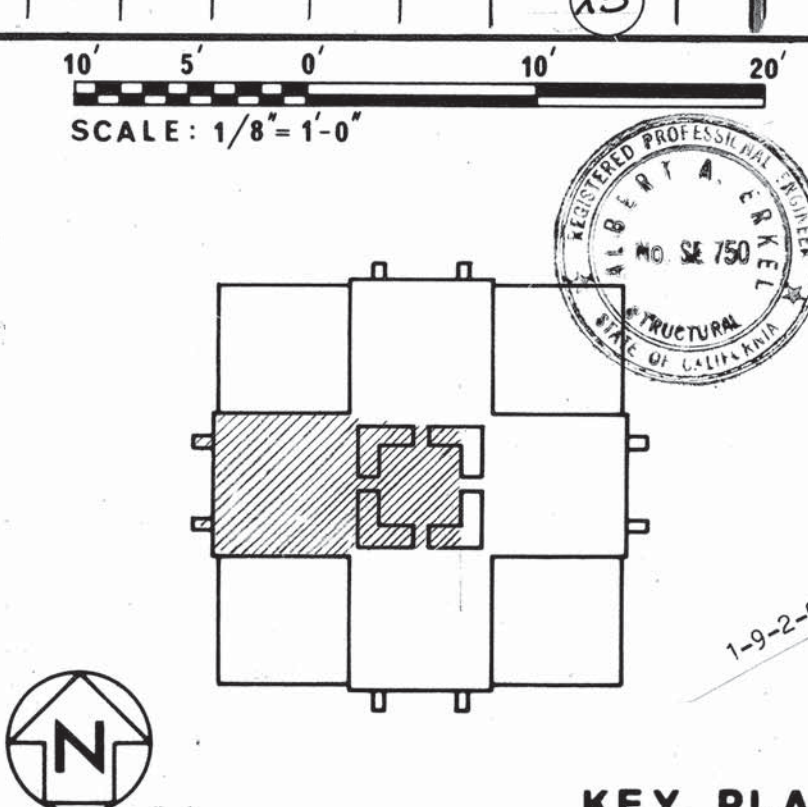
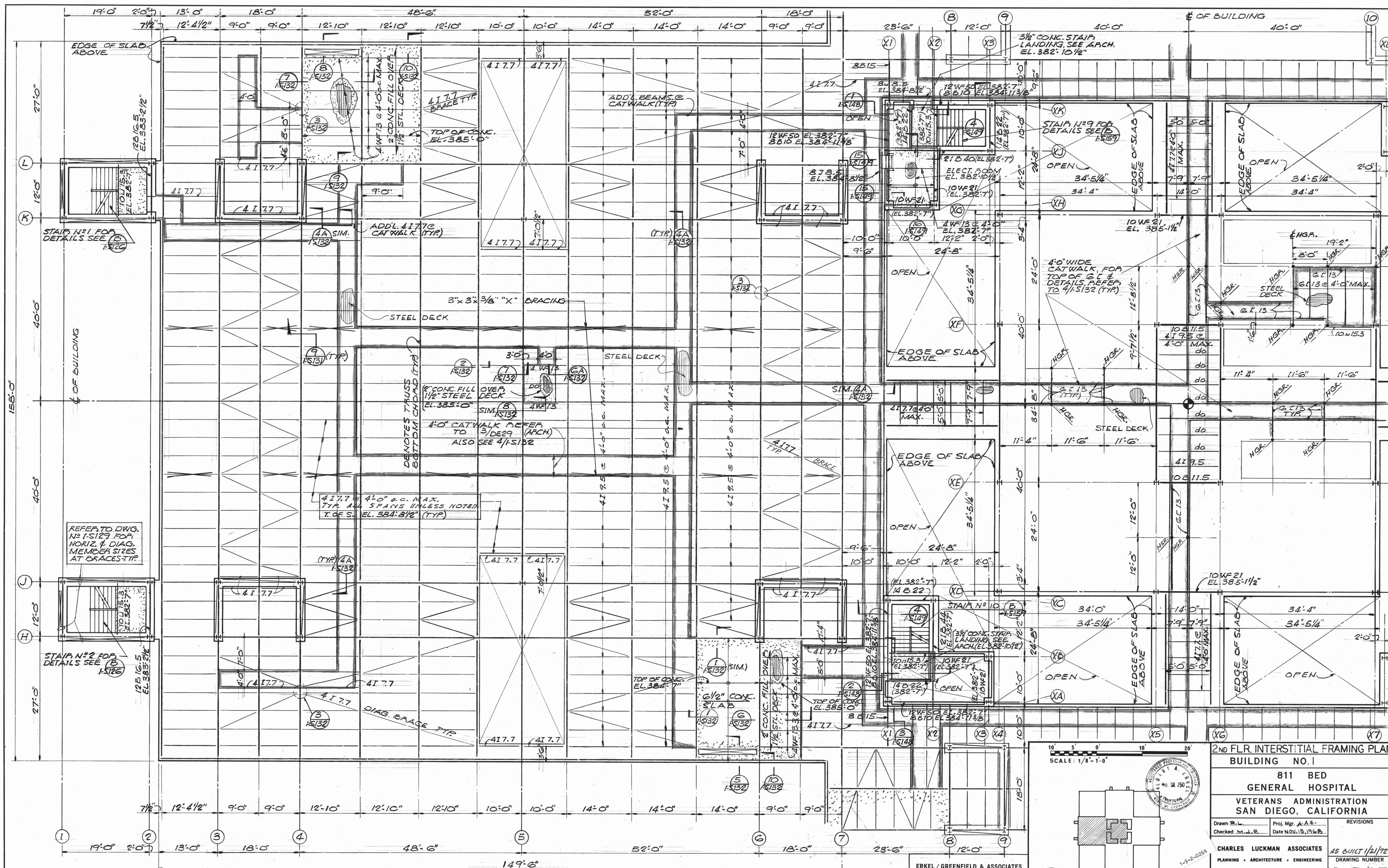

2ND FLR. INTERSTITIAL FRAMING PLAN	
BUILDING NO. 1	
811 BED GENERAL HOSPITAL	
VETERANS ADMINISTRATION SAN DIEGO, CALIFORNIA	
Drawn by: [Signature]	Proj. Mgr. J.A.E.
Checked: M.A.P.	Date NOV. 15, 1966
CHARLES LUCKMAN ASSOCIATES	
PLANNING • ARCHITECTURE • ENGINEERING	
8229 SUNSET BLVD. LOS ANGELES, 90049	
AS BUILT 1/21/72	
DRAWING NUMBER	
I-527	
Sheet 136 of 748	
Proj. No. 04-5543	