

### HAZARDOUS MATERIALS NOTES

1. ABATEMENT MUST FOLLOW VA MEDICAL CENTER SPECIFICATIONS.
2. MERCURY: MERCURY THERMOSTATS AND LAMPS MUST BE HANDLED AND DISPOSED OF AS UNIVERSAL WASTE. BREAKAGE AND/OR SPILLS SHOULD BE REPORTED IMMEDIATELY TO VA DURHAM HAZMAT TEAM. PLEASE REFER TO VA MEDICAL CENTER GUIDELINES.
3. ASBESTOS: ALL IDENTIFIED ASBESTOS CONTAINING MATERIAL (ACM), INCLUDING FLOOR TILE MASTIC, MUST BE ABATED PRIOR TO DEMOLITION. ABATEMENT MUST FOLLOW VA MEDICAL CENTER SPECIFICATIONS.
4. LEAD-BASED PAINT COMPONENTS: WHOLE COMPONENT REMOVAL OF RAILINGS, CABINETS, AND DOOR COMPONENTS MUST BE COMPLETED BY A NC LICENSED LEAD ABATEMENT CONTRACTOR OR NC CERTIFIED LEAD RENOVATOR. WHOLE COMPONENTS MUST BE WRAPPED IN 6 MIL POLYURETHANE. ONCE COMPLETELY WRAPPED, COMPONENTS CAN BE DISPOSED OF AS CONSTRUCTION DEBRIS. CONTRACTOR MUST COMPLY WITH OSHA LEAD IN CONSTRUCTION STANDARD 29 CFR 1926.62.

### DEMOLITION NOTES

1. VA SHALL HAVE OPPORTUNITY TO REMOVE ANY FURNITURE, FIXTURES AND EQUIPMENT PRIOR TO CONSTRUCTION. ANY REMAINING ITEMS NOT REMOVED BY VA SHALL BE REMOVED BY CONTRACTOR AND DISPOSED OF IN ACCORDANCE WITH SPECIFICATION SECTIONS 02 41 00 DEMOLITION AND 01 74 19 CONSTRUCTION WASTE MANAGEMENT.
2. CONTRACTOR TO COORDINATE DEMOLITION WORK WITH VA COR.
3. EXISTING BUILDING 16 TO BE DEMOLISHED IN ITS ENTIRETY. ALL ASSOCIATED WALLS, FLOORS, STAIRS, FINISHES, CEILINGS, RAMPS, RAILINGS, BEAMS, COLUMNS, FOUNDATIONS, ROOFS, CANOPIES, DOORS, MECHANICAL EQUIPMENT AND FIXTURES, ELECTRICAL EQUIPMENT AND FIXTURES, LIGHT FIXTURES, ELEVATORS, PLUMBING PIPE AND FIXTURES, AND WINDOWS TO BE DEMOLISHED.
4. REFER TO SHEET CD102 FOR DEMOLITION OF EXISTING UTILITIES.
5. REFER TO SHEET AD101 FOR DEMOLITION IN BUILDING 1.
6. DURING DEMOLITION, NO WALLS SHALL BE ALLOWED TO FALL OUTWARD FROM BUILDING.
7. SPECIALTY EQUIPMENT AND FURNISHINGS SHALL BE REMOVED BY VA PRIOR TO CONSTRUCTION.
8. PROTECT ADJACENT STRUCTURES AND BUILDINGS FROM DEMOLITION.
9. PROTECT ADJACENT EXISTING BUILDING, COLUMNS, SITE WALLS AND EQUIPMENT TO REMAIN.
10. DEMOLISH EXISTING DOOR, FRAME AND HARDWARE IN ITS ENTIRETY.
11. DEMOLISH CEILING ABOVE IN ITS ENTIRETY, INCLUDING ALL ASSOCIATED LIGHT FIXTURES AND MECHANICAL EQUIPMENT.
12. DEMOLISH INTERIOR WALL INCLUDING ALL ASSOCIATED DOORS, DOOR FRAMES, INTERIOR WINDOWS, PLUMBING FIXTURES AND LIGHT FIXTURES.
13. DEMOLISH ELEVATOR, INCLUDING SHAFT, STRUCTURE AND PIT.
14. DEMOLISH EXISTING STAIR, ALL ASSOCIATED STRUCTURE AND ASSOCIATED RAILINGS IN ITS ENTIRETY.
15. EXTERIOR WALLS TO BE DEMOLISHED IN ITS ENTIRETY. REMOVE ANY ASSOCIATED FIXTURES, WINDOWS AND DOORS.
16. DEMOLISH ROOF AND SUPPORTING STRUCTURE IN ITS ENTIRETY. DEMOLISH ALL EQUIPMENT ON ROOF.
17. DEMOLISH EXISTING FLOOR AND SUPPORTING STRUCTURE IN ITS ENTIRETY.
18. DEMOLISH EXISTING RAMP, ALL ASSOCIATED STRUCTURE AND ASSOCIATED RAILINGS IN ITS ENTIRETY.
19. DEMOLISH CANOPY ABOVE RAMP AND ALL ASSOCIATED STRUCTURE, GUTTERS AND DOWNSPOUTS.
20. EXISTING CONCRETE SLAB TO BE DEMOLISHED IN ACCORDANCE WITH PHASING PLAN. SLAB SHALL BE USED AS PLATFORM FOR INSTALLING FIRST CAISSONS IN ACCORDANCE WITH PHASING PLAN.

### DEMOLITION PLAN LEGEND

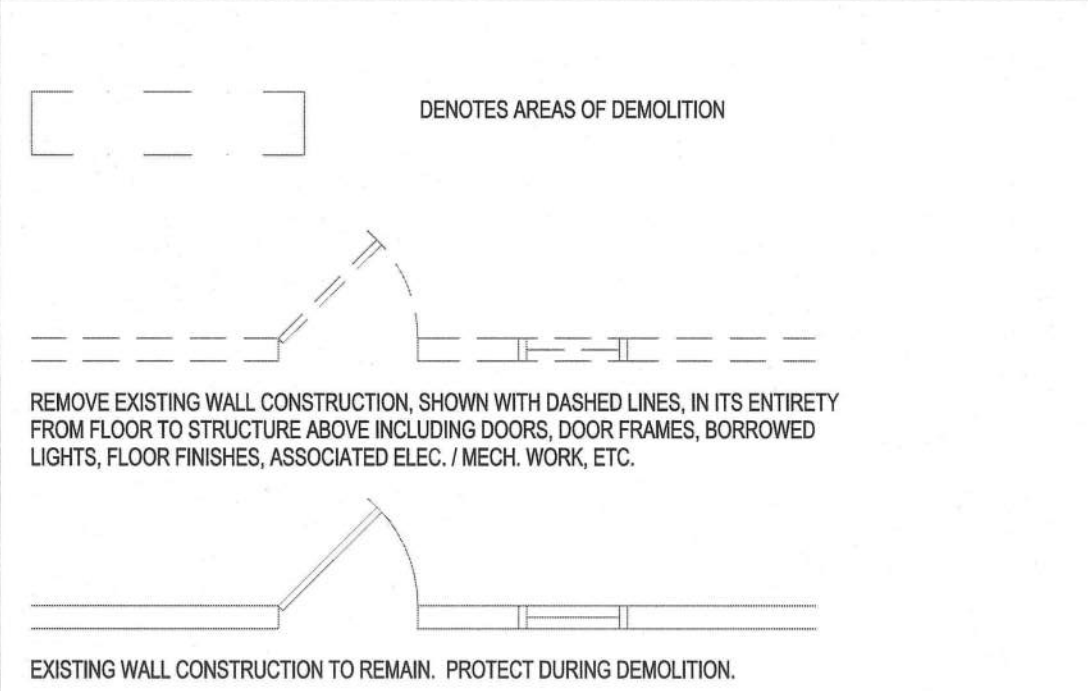

### WALL RATING LEGEND

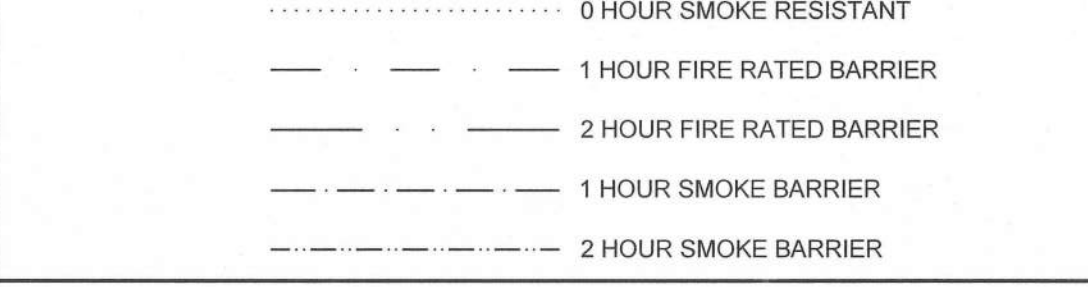

### KEY PLAN

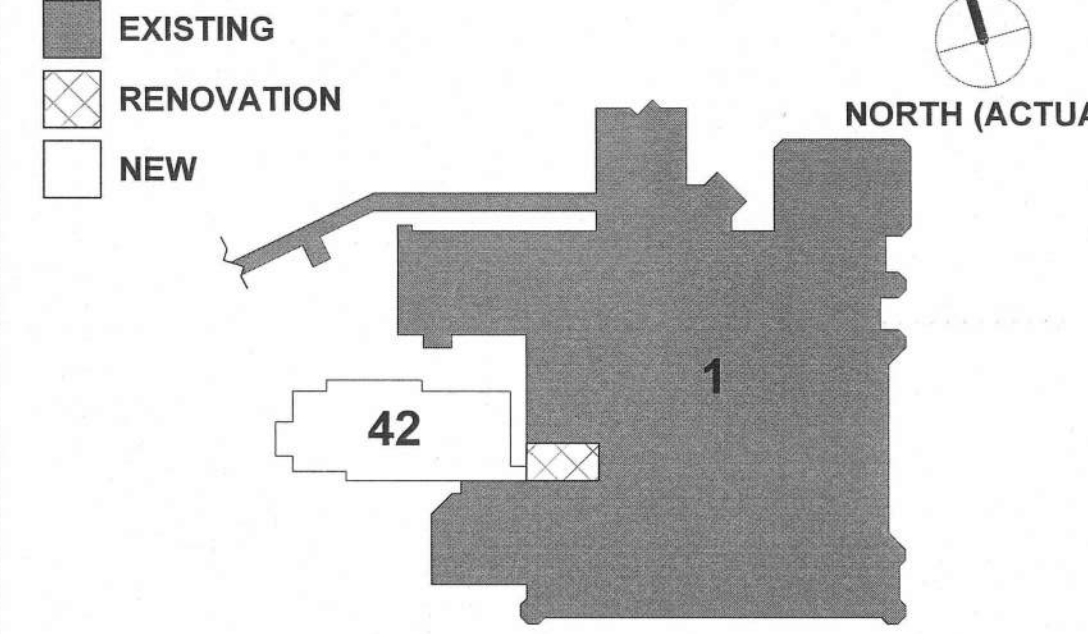

### FULLY SPRINKLERED FINAL DOCUMENTS FOR CONSTRUCTION

Project Number 558-321	Office of Construction and Facilities Management  Department of Veterans Affairs
Building Number 42	
Drawing Number AD105 Dwg. 5 of 60	

#### CONSULTANTS:

5960 Fairview Road, Suite 500  
Charlotte, NC 28210  
704-887-3500

111 West Main Street  
Durham, NC 27701  
919-628-0368

P. O. Box 51967  
Durham, NC 27717  
919-489-0926

3516 Bush Street, Suite 200  
Raleigh, NC 27609  
919-871-1070

#### PROJECT MANAGER:

www.acg-pa.com

Raleigh, NC  
Indianapolis, IN  
Philadelphia, PA  
Pittsburgh, PA  
Virginia Beach, VA  
Fort Collins, CO  
(919) 858-7420

Project Number  
13-290

Scale

Drawing Title:  
EXISTING BUILDING 16 LEVEL 1 -  
DEMOLITION FLOOR PLAN

Approved: Project Director

Project Title  
VA Durham Specialty Care  
Building 42

Location  
Durham, North Carolina

Date  
04/28/2015

Checked  
KMN

Drawn  
ERA/MEG