

A
three inches = one foot
6"

B
one and one half inches = one foot
6"

C
one inch = one foot
6"

D
three quarters inch = one foot
6"

E
one half inch = one foot
6"

F
three eighths inch = one foot
6"

G
one quarter inch = one foot
6"

one eighth inch = one foot
6"

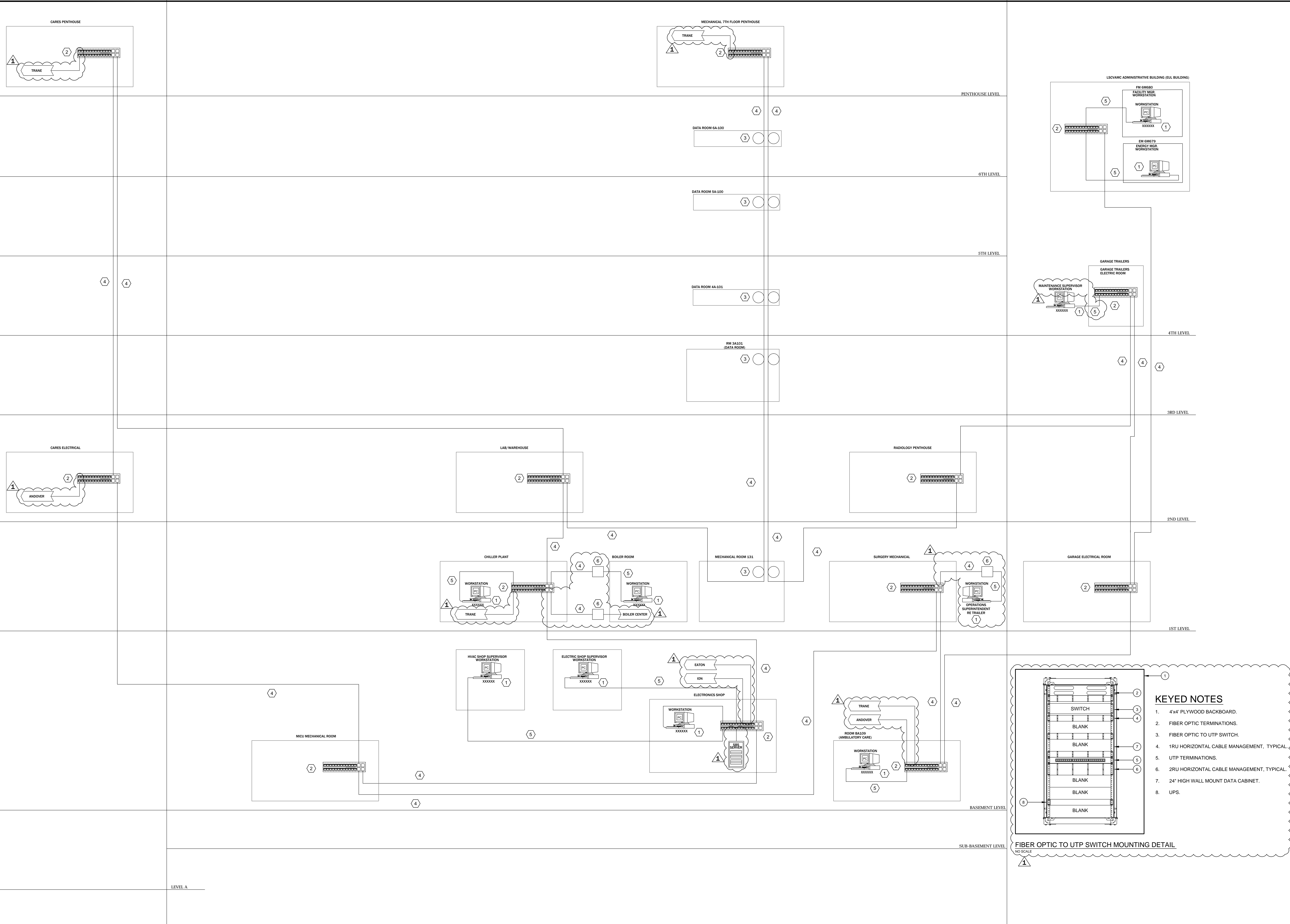

- NOTES:**
- GENERAL NOTES**
- REFER TO SHEET MI-0-600 FOR GENERAL NOTES, ABBREVIATIONS, DETAILS AND SYMBOL LEGEND.
 - REFER TO SHEET MI-1-601, MI-2-602, MI-2-605, MI-2-606 AND MI-2-607 FOR CONTROLS AND SCHEDULE.
 - REFER TO M-2-108, M-2-101, AND M-2-107 FOR PLAN LOCATIONS.
 - ALL NETWORK AND EQUIPMENT INDICATED ON THIS SHEET IS NEW AND SHALL BE PROVIDED BY THE CONTRACTOR.
- KEYED NOTES**
- PROVIDE ENGINEERING WORKSTATION(S).
 - PROVIDE FIBER OPTIC TO UTP SWITCH, IN WALL MOUNTED ENCLOSURE WITH FIBER OPTIC CLOSET CONNECTOR.
 - COIL 30 FEET OF EACH FIBER OPTIC CABLE NEATLY IN ROOM, FOR FUTURE CONNECTIONS.
 - 6 STRAND OM3 MM FIBER OPTIC.
 - UTP CONNECTION.
 - FIBER OPTIC TO UTP CONVERTER.

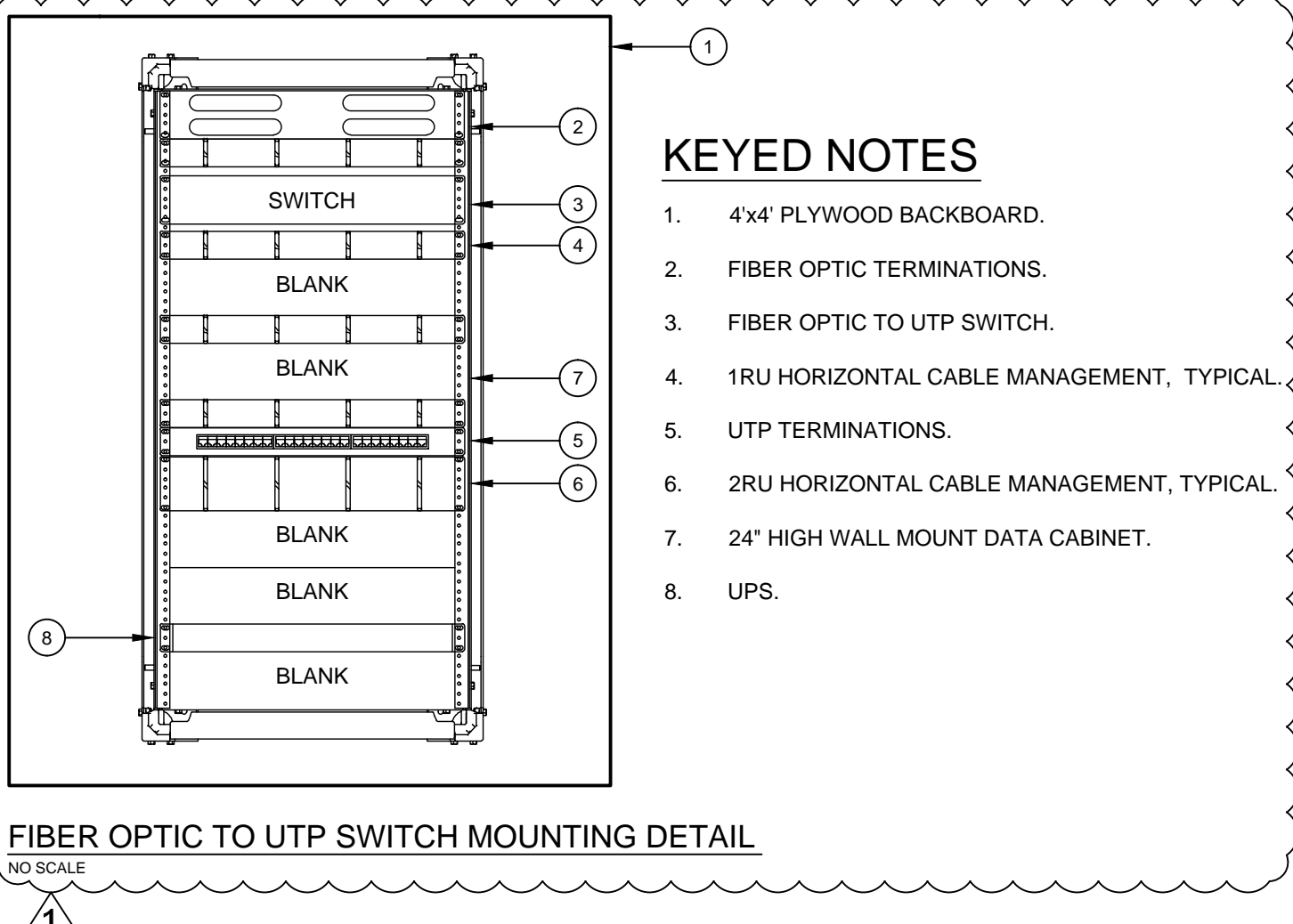

| | | | | | | |
|---|----------------------------|--|---|---|--|---|
| <p>AMENDMENT A00003</p> <p>8/23/2012</p> <p>Revisions</p> <p>Date</p> | <p>CONSULTANTS:</p> | <p>ARCHITECT/ENGINEERS:</p> <p>Westlake Reed Leskosky</p> <p>925 Euclid Avenue, Suite 1900, Cleveland, Ohio 44115</p> <p>216.522.1350</p> <p>Phoenix, Washington, Cleveland</p> <p>WRL Commission # 09099.00</p> | <p>Drawing Title</p> <p>ENGINEERING NETWORK</p> <p>RISER</p> <p>Approved Project Director</p> | <p>Project Title</p> <p>Energy Conservation Measures For Cleveland</p> <p>Local Project # 541-10-1014</p> <p>Location</p> <p>Wade Park / Cleveland, Ohio</p> <p>Date</p> <p>August 6, 2012</p> <p>Checked</p> <p>SKW</p> <p>Drawn</p> <p>RL</p> | <p>Project Number</p> <p># 541-10-1014</p> <p>Building Number</p> <p>-</p> <p>Drawing Number</p> <p>MI-2-608</p> | <p>100% CD</p> <p>Office of Facilities Management</p> <p>Department of Veterans Affairs</p> |
|---|----------------------------|--|---|---|--|---|