

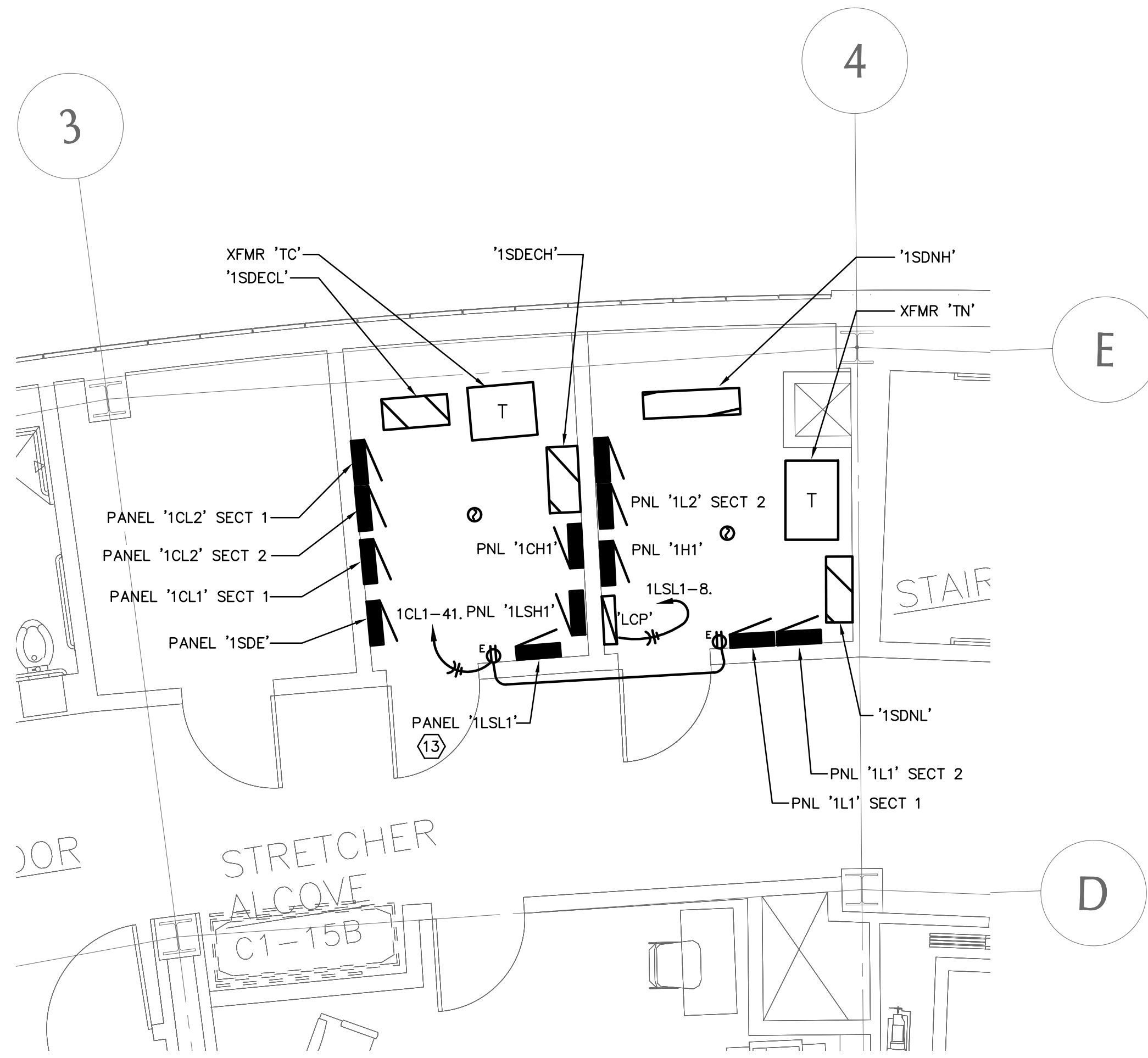

SHEET KEYNOTES

1. PROVIDE 120V CONNECTION TO MOTORIZED SHADES. CONNECT COMPLETE FOR AN OPERATIONAL SYSTEM. CONTROLLED VIA AUTOMATIC FIRE ALARM PANEL. STOP SWITCH LOCATED AT SECURITY/TRIAGE. VERIFY LOCATION WITH ARCHITECTURAL DRAWINGS PRIOR TO ROUGH-IN. CONNECT TO CIRCUIT 11.1-10.
2. BLANKET WARNER. PROVIDE 208V/1P CONNECTION TO BLANKET WARNER. VERIFY VOLTAGE WITH MANUFACTURER PRIOR TO ROUGH-IN.
3. PROVIDE 120V POWER TO EXTERIOR SIGNAGE VIA LCP. VERIFY LOCATION WITH ARCHITECTURAL DRAWINGS PRIOR TO ROUGH-IN. CONNECT TO CIRCUIT 11.1-34.
4. SURFACE MOUNT RECEPTACLE TO TOP OF CABLE RUNWAY. COORDINATE LOCATION WITH CABLE RUNWAY INSTALLER PRIOR TO ROUGH-IN.
5. PROVIDE 120V CONNECTION TO P-TUBE STATION.
6. PROVIDE COMPLETE CONNECTION TO AUTOMATIC SENSOR DOORS. COORDINATE REQUIREMENTS WITH MANUFACTURER PRIOR TO ROUGH-IN.
7. PROVIDE COMPLETE CONNECTION TO AUTO DOOR OPERATOR. PROVIDE FIRE ALARM ADDRESSABLE RELAY TO DISABLE AUTO DOOR OPERATOR UPON ACTIVATION OF FIRE ALARM SYSTEM. COORDINATE REQUIREMENTS WITH MANUFACTURER AND HARDWARE SUPPLIER PRIOR TO ROUGH-IN.
8. PROVIDE FLUSH MOUNTED CEILING RECEPTACLE FOR PATIENT LIFT. VERIFY LOCATION WITH ARCHITECTURAL PRIOR TO ROUGH-IN.
9. SEE DEDUCTIVE ALTERNATE 7.5.
10. CONNECT FIRE ALARM CONTROL PANEL TO CIRCUIT 11.1.1-2.
11. PROVIDE JUNCTION BOX FOR POWER TO CASEWORK LIGHTING. CASEWORK LIGHTING BY OTHERS. CIRCUIT TO PANEL 11.1-52.
12. CARD READER. REFER TO TECHNOLOGY PLANS.
13. MOUNT 15KVA "TLS" SUPPLY FROM WALL ABOVE PANEL.
14. PROVIDE POWER CONNECTION TO NEW P-TUBE DIVERter LOCATED IN EXISTING BUILDING. VERIFY LOCATION WITH P-TUBE ALARMER PRIOR TO ROUGH-IN. CONNECT P-TUBE DIVERter TO AVAILABLE SRAE 20A/1P BREAKER IN PANEL 20.1.1-M3.



2 ENLARGED ELECTRICAL ROOM POWER/SIGNAL PLAN - FIRST FLOOR
EP111 SCALE: 1/4" = 1'-0"

1 POWER/SIGNAL PLAN - FIRST FLOOR
EP111 SCALE: 1/8" = 1'-0"

1223 SW Washington Street
Suite 200
Portland, OR 97205
T 503 224 3860
F 503 224 2482
www.zgf.com



VETERANS AFFAIRS MEDICAL
CENTER

PORTLAND, OREGON

PROJECT 2010-0337
CONTACT Matt Jones

 **INTERFACE**
ENGINEERING

708 SW Third Avenue
Suite 400
Portland, OR 97204
TEL 503.382.2266
FAX 503.382.2262
www.interfaceengineering.com

FULLY SPRINKLERED
FINAL DESIGN

EP111

U.S. DEPARTMENT OF
VETERANS AFFAIRS