

- NOTES:
1. WIRE FENCE SHALL BE A MINIMUM OF 32 INCHES IN HEIGHT AND SHALL HAVE A MINIMUM OF 6 WIRES WITH 12" STAY SPACING.
  2. FILTER FABRIC SHALL BE A MINIMUM OF 36" IN WIDTH AND SHALL BE FASTENED ADEQUATELY TO THE WIRE WITH #9 WIRE STAPLES 1-1/2" LONG. FABRIC THAT DETERIORATES TO SUCH EXTENT THAT IT'S EFFECTIVENESS IS REDUCED SHALL BE REPLACED BY CONTRACTOR AT CONTRACTOR'S EXPENSE.
  3. STEEL POSTS SHALL BE A MIN. OF 5' HEIGHT AND SHALL BE THE SELF FASTENER ANGLE STEEL TYPE.
  4. WOOD POST'S SHALL BE A MIN. OF 6' IN HEIGHT AND 3" OR MORE IN DIAMETER. WIRE FABRIC SHALL BE FASTENED TO WOODEN POST WITH NOT LESS THAN #9 WIRE STAPLES 1-1/2 INCHES LONG.
  5. CONTRACTOR SHALL REVIEW SILT FENCE WEEKLY AND AFTER EACH RAINFALL OCCURRENCE. ANY NECESSARY REPAIRS OR CLEAN-UP TO MAINTAIN THE EFFECTIVENESS OF THE DEVICE SHALL BE MADE IMMEDIATELY.
  6. TEMPORARY MEASURE SHALL BE REMOVED BY THE CONTRACTOR ONCE STABILIZATION OR SUFFICIENT GROUND COVER IS ACHIEVED AS DIRECTED BY THE COTR.

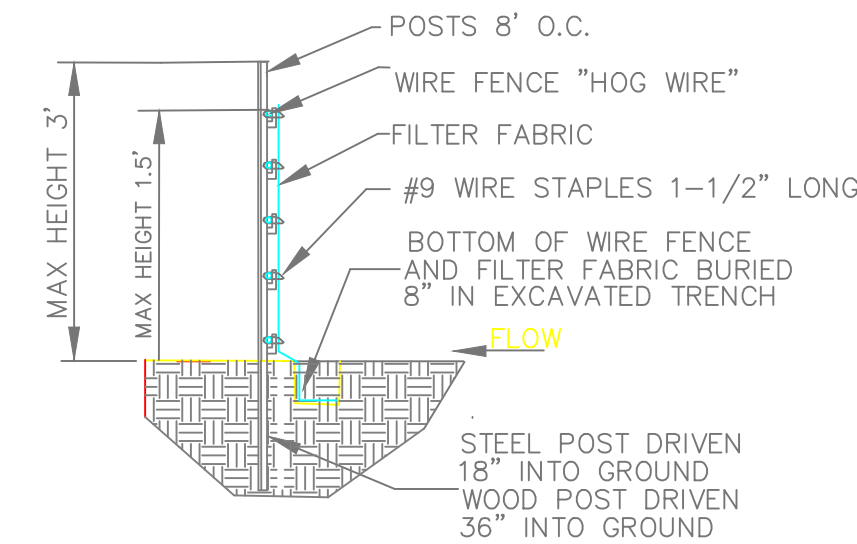

### SILT FENCE

SCALE

1  
C-101

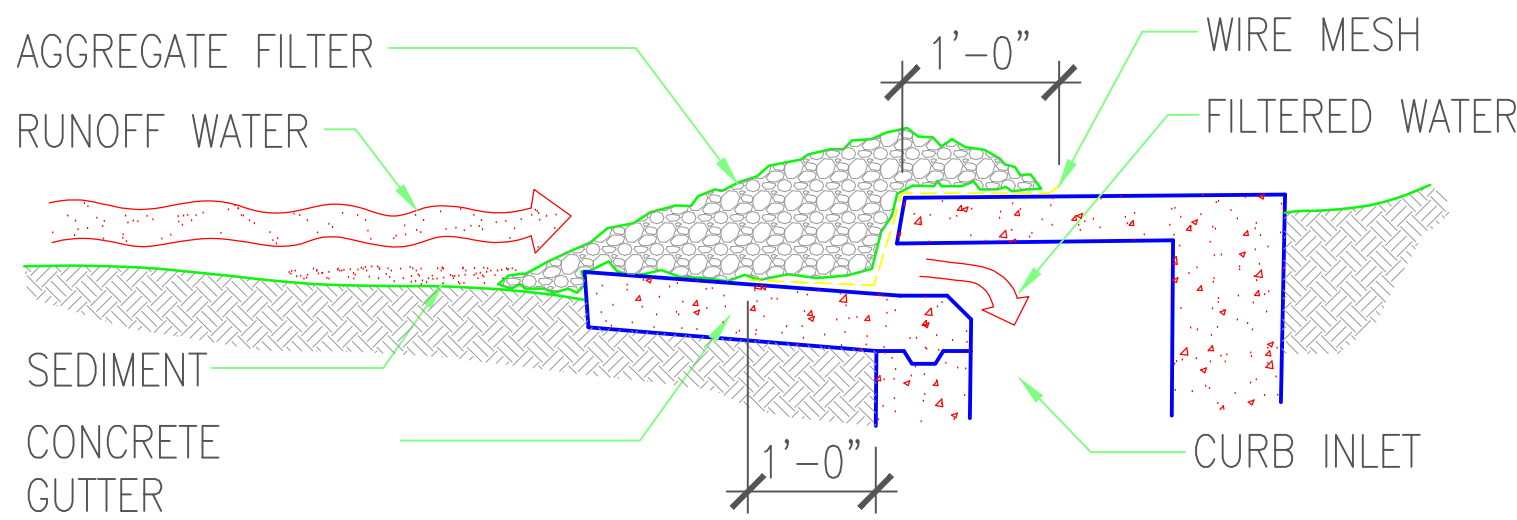
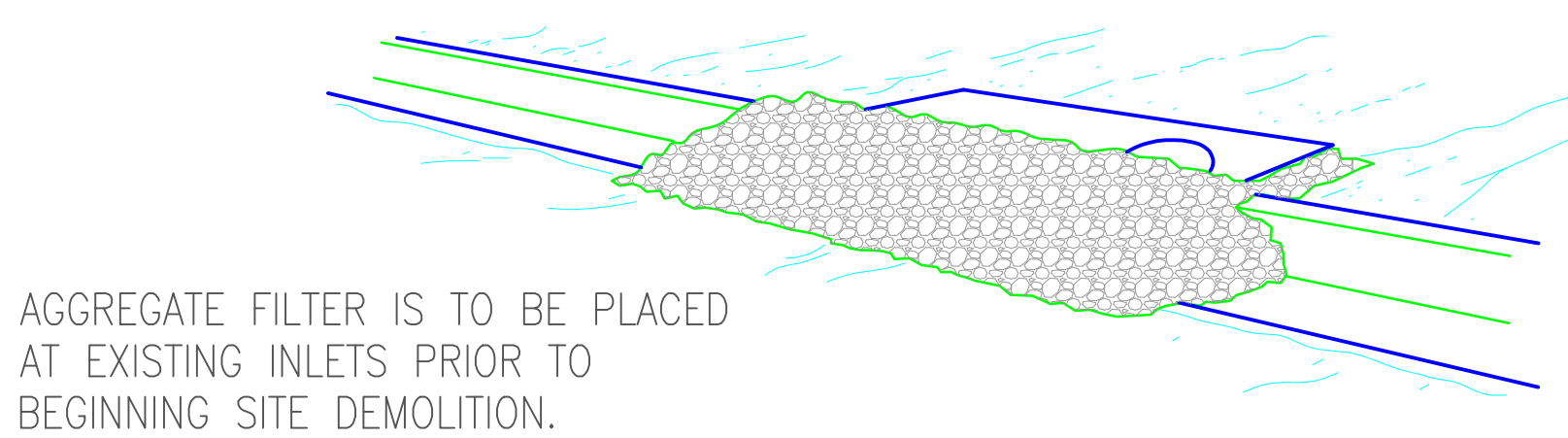

### GRAVEL INLET PROTECTION

N.T.S.

2  
C-101

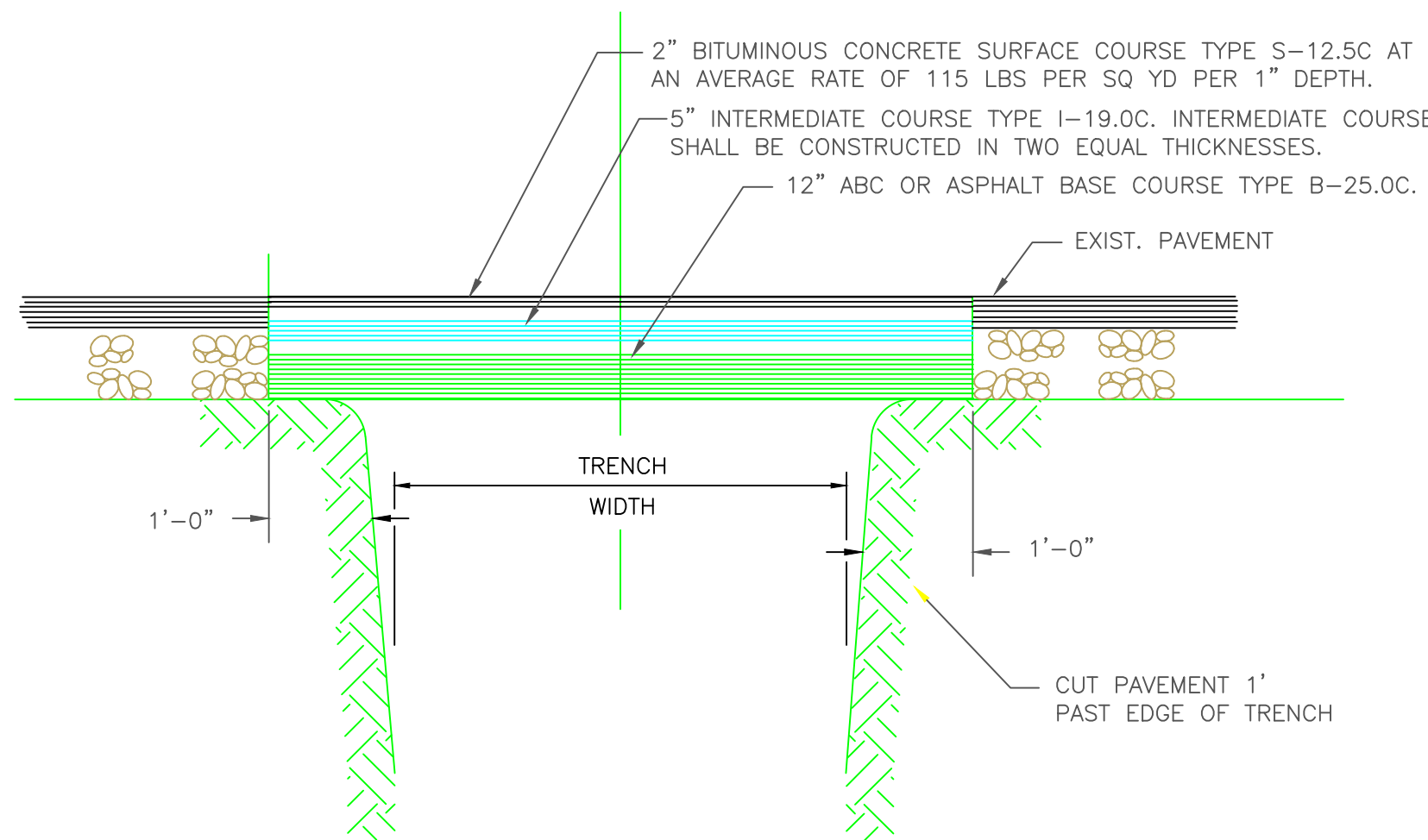

- NOTES:
1. PAVEMENT REPLACEMENT PER NORTH CAROLINA DOT STD. SPECS.
  2. EXISTING ASPHALT SHALL BE REMOVED FOR A DISTANCE OF 1 FOOT TO BOTH SIDES OF THE TRENCH OPENING.

### PAVEMENT REPLACEMENT DETAIL

NTS

3  
C-101

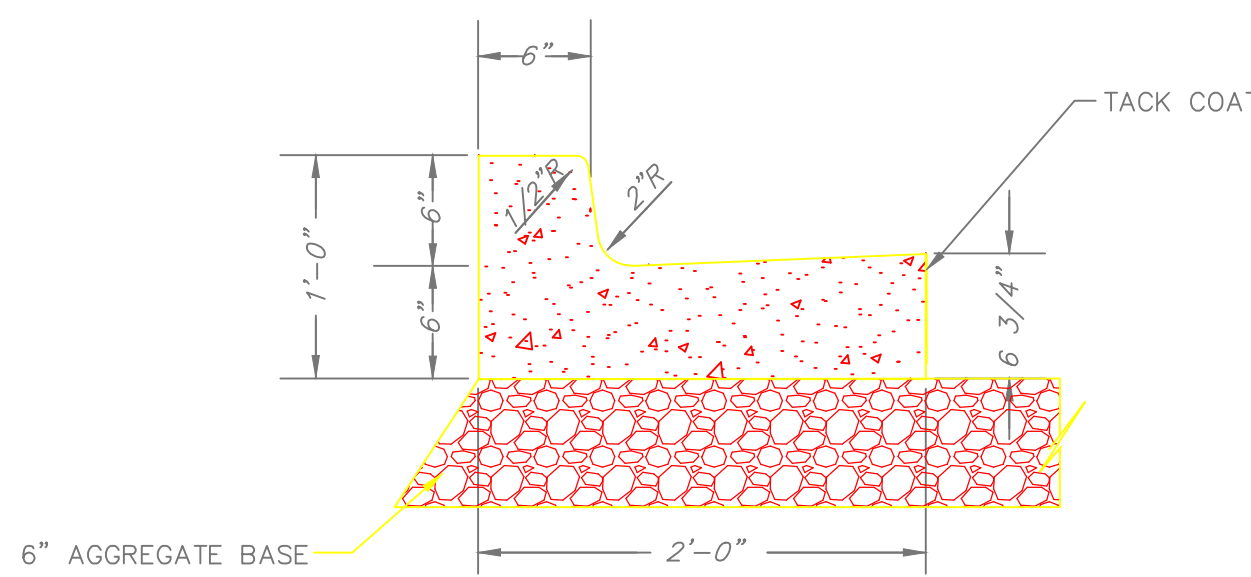

### CURB AND GUTTER

NOT TO SCALE

5  
C-101

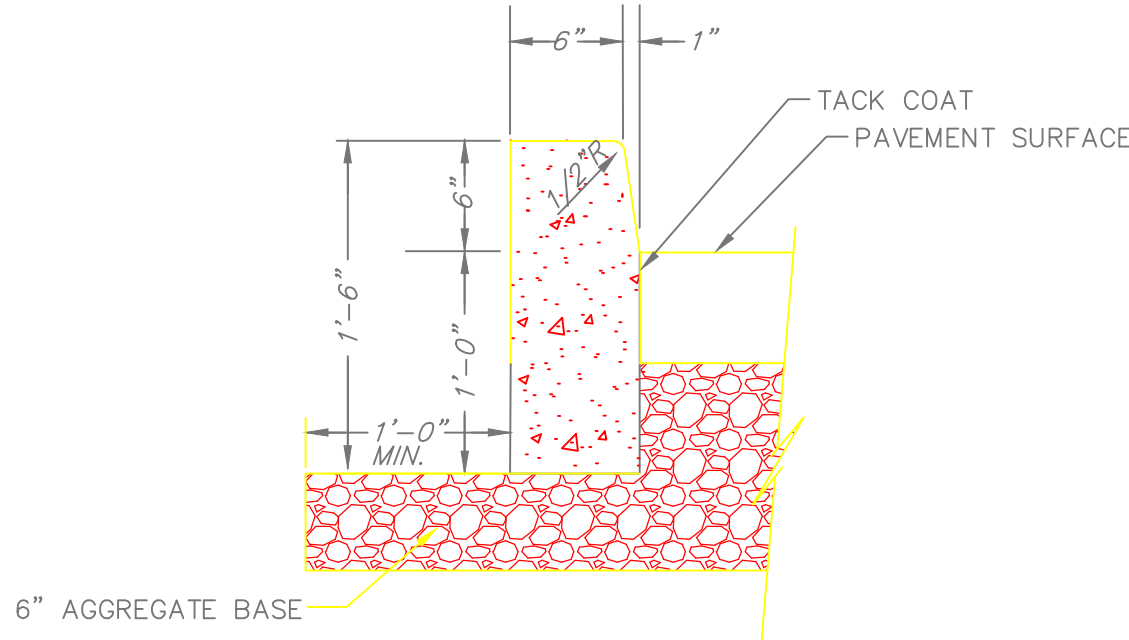

### CONCRETE CURB

NOT TO SCALE

6  
C-101

APPROXIMATELY 50 LINEAR FEET OF CURBING TO BE REPLACE BETWEEN BLDG 2 & BLDG 3 IN ADDITION TO OTHER AREAS THAT ARE REQUIRED DUE TO INSTALLATION OF NEW DOMESTIC WATER LINES

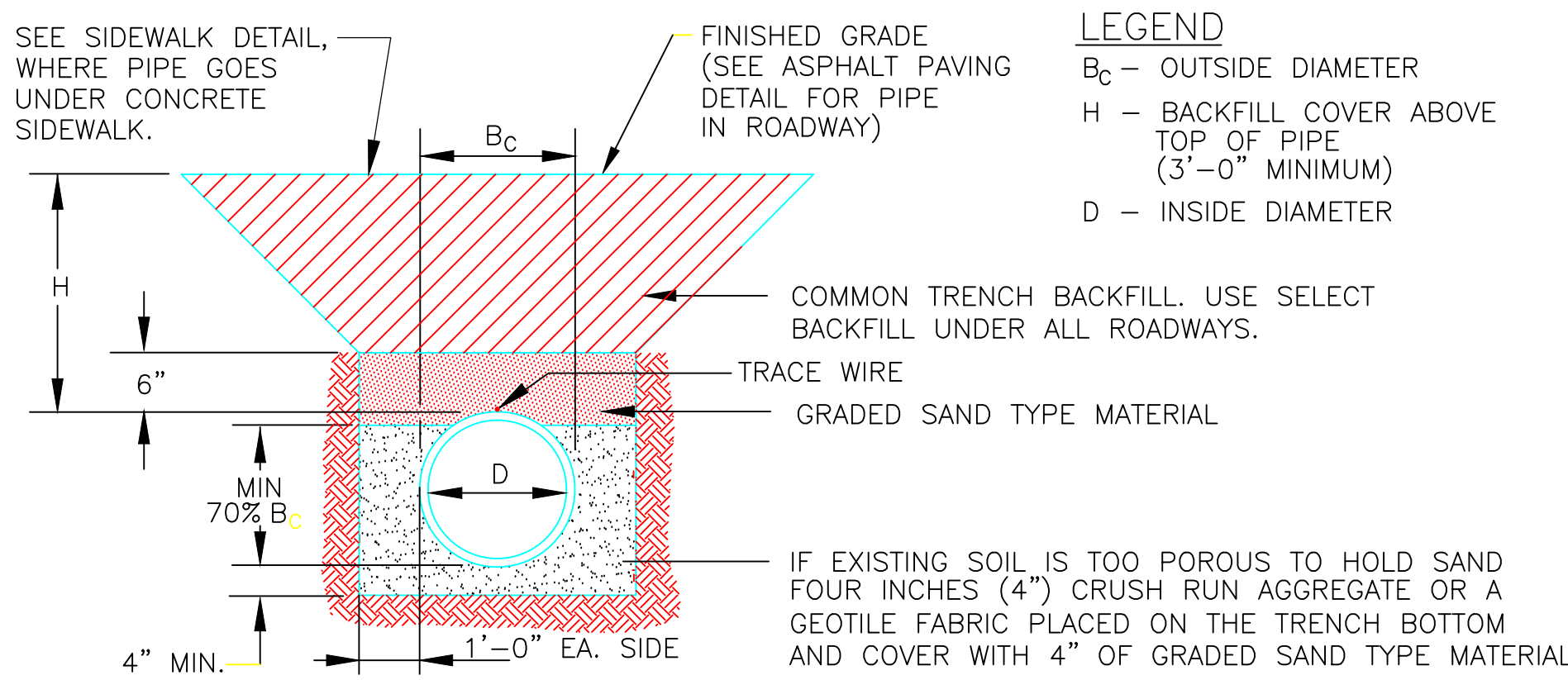

### PIPE BEDDING DETAIL

NTS

7  
C-101

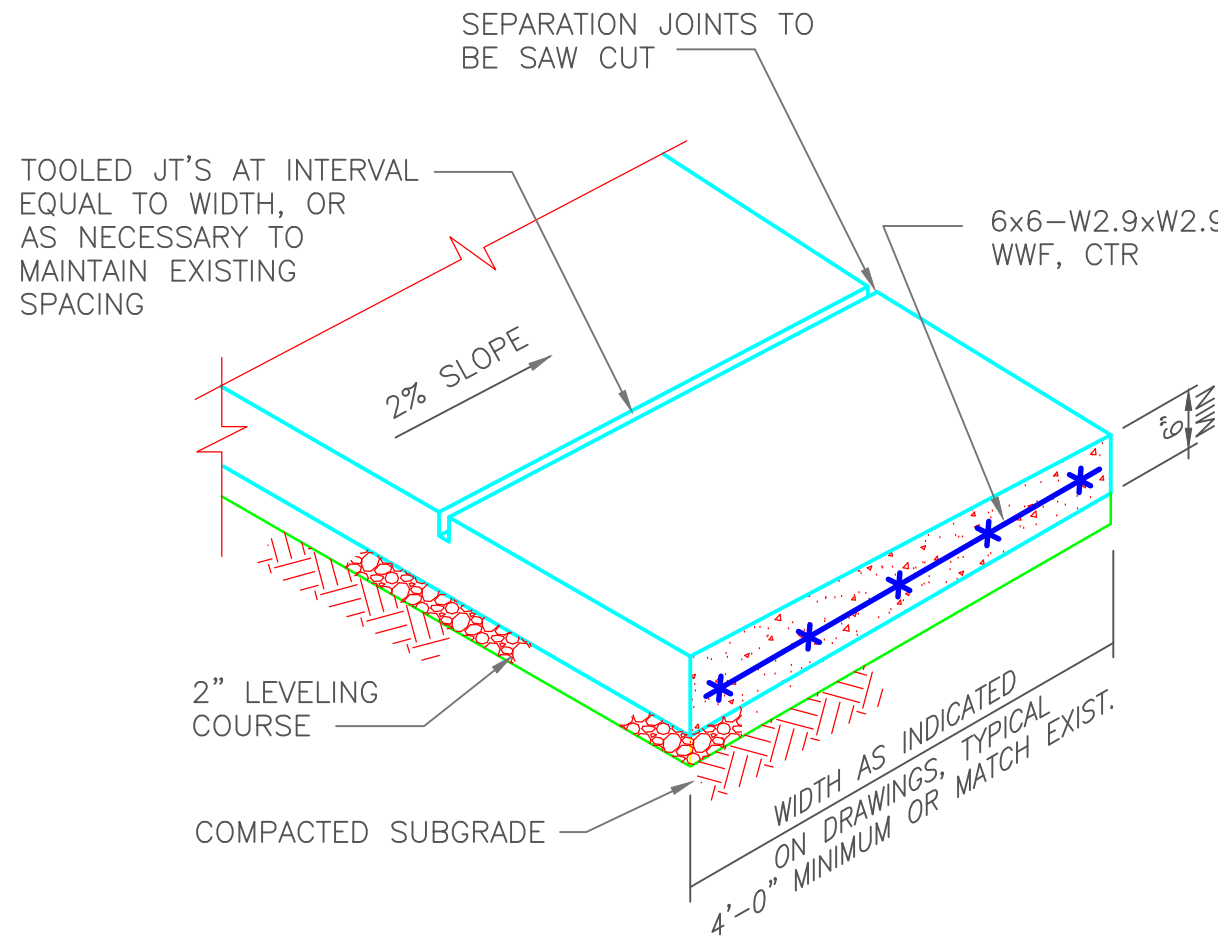

NOTES:

1. PROVIDE FULL DEPTH 3/8" PREMOLED EXPANSION JOINT FILLER ALL AROUND AT ALL UTILITY POLES, METER BOXES, ETC.
2. PLACE FULL DEPTH THRU JOINTS W/1/2"x6" PREMOLED EJF AT POINT OF TANGENCY AND AT MIN 25' INTERVALS.

### CONCRETE SIDEWALK

NOT TO SCALE

8  
C-101

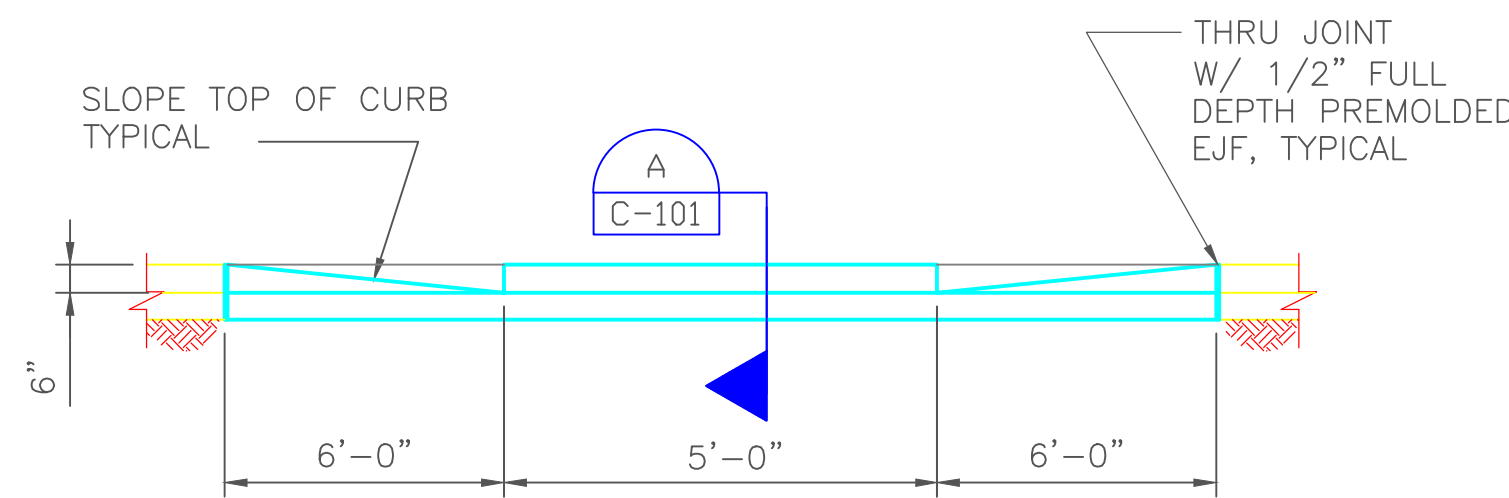

### ELEVATION

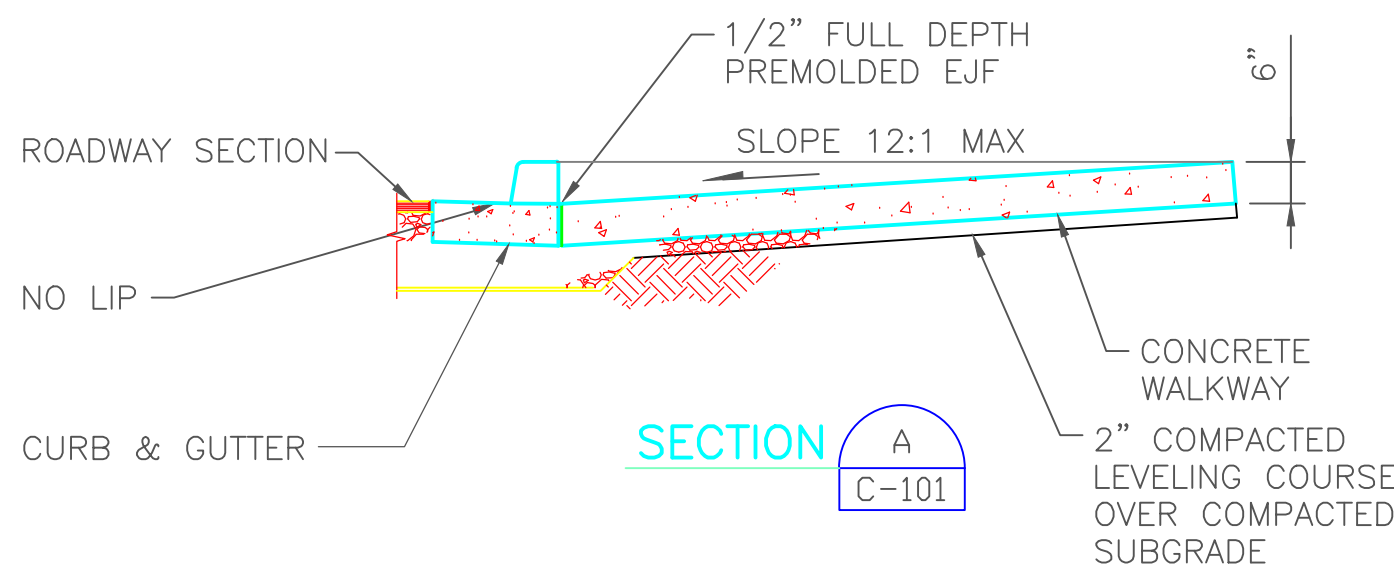

### SECTION A

C-101

### WHEELCHAIR RAMP

NTS

9  
C-101

REV-1 GENERAL NOTES ADDITION

REV-1 GENERAL NOTES ADDITION	1 AUG 12
REV-2 GENERAL NOTES ADDITION-LINEAR FEET OF CURB	29 AUG 12
Revision	Date

RECOMMEND APPROVAL			
REQUESTER	Date		
CHIEF OF SERVICE	Date	CHIEF OF STAFF	Date
ASSOC. DIR. PATIENT CARE SVC.	Date	ASSOC. DIR. for OPERATIONS	Date
APPROVAL BY:			Date
MEDICAL CENTER DIRECTOR			

Drawing Title	STANDARD DETAILS
Approved: Safety Manager/M&O Supervisor	
Approved: Chief of Facilities Management Svr.	

Project Title	REPLACE DOMESTIC WATER PIPING-NORTH LOOP
Building Number	CAMPUS
Checked	
Drawn	BLF
Location	W.G.(Bill) Hefner Medical Center 1601 Brenner Ave. Salisbury NC 28144

Date	29 JUNE 2012
Project No.	659-12-253
DRAWING NO.	C-101
DWG. 6 OF 8	



Department of Veterans Affairs