

CEILING - SOFFIT DETAIL 3 - BULKHEAD

10
AI107

SCALE: 1 1/2" = 1'-0"

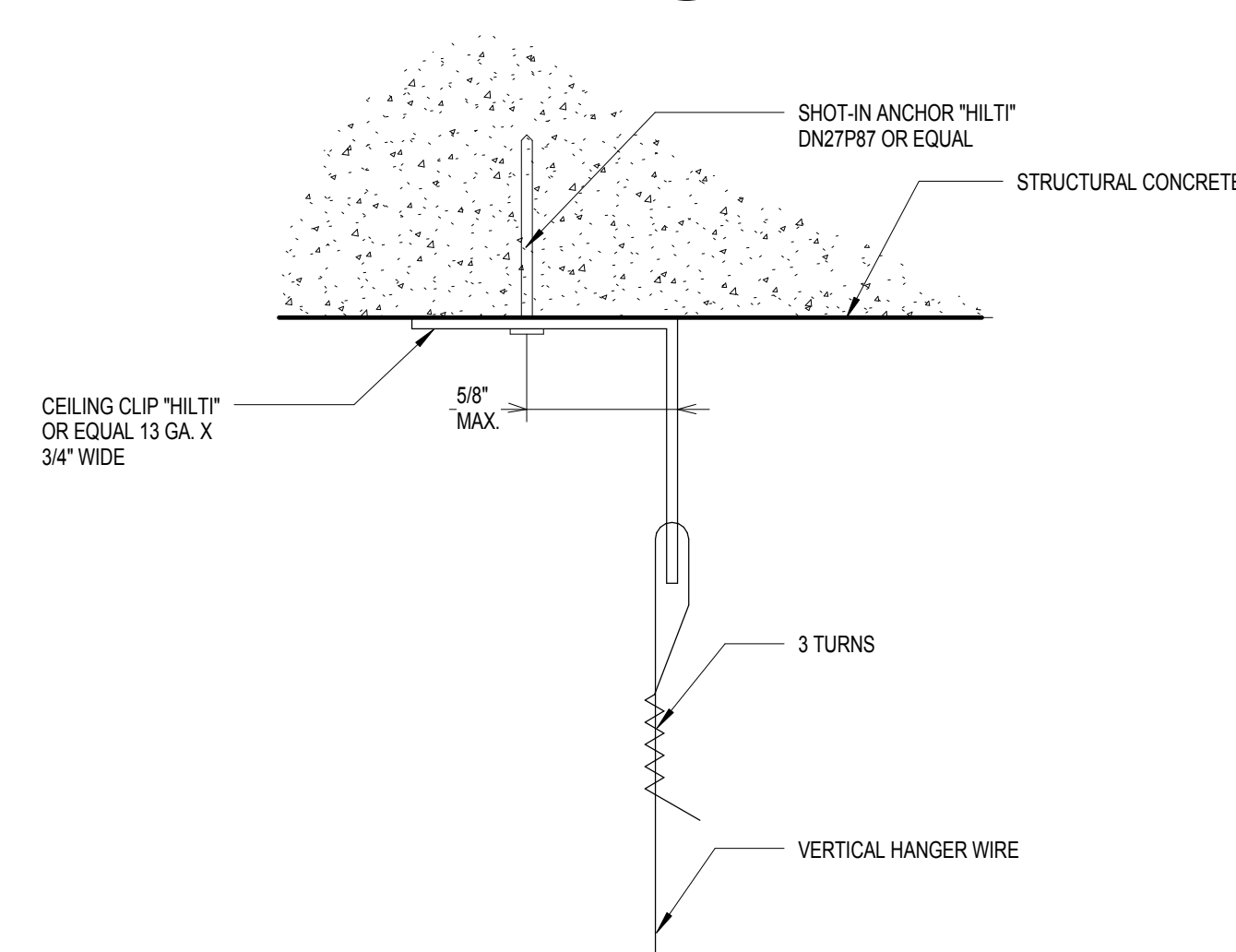

**CEILING - VERTICAL HANGER WIRE
ATTACHMENT AT CONCRETE
CONSTRUCTION**

6
AI107 SCALE: 1 1/2" = 1'-0"

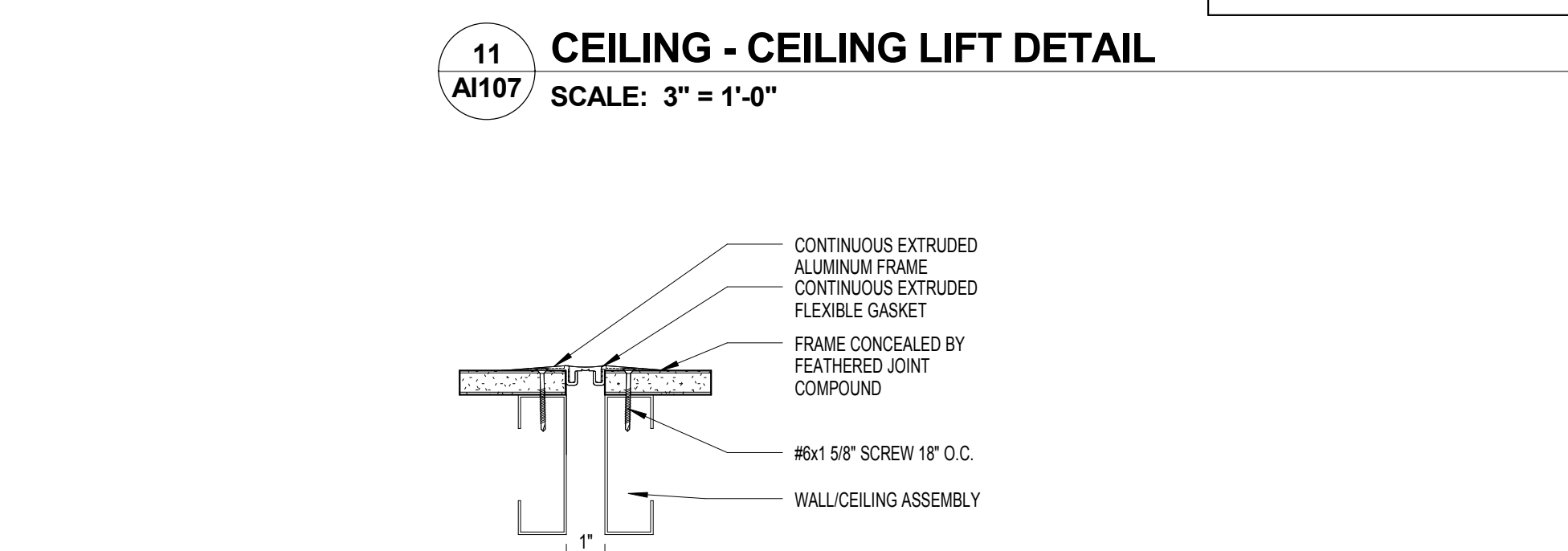

**CEILING - 1" WALL & CEILING
EXPANSION JOINT COVER**

7
AI107

SCALE: 3" = 1'-0"

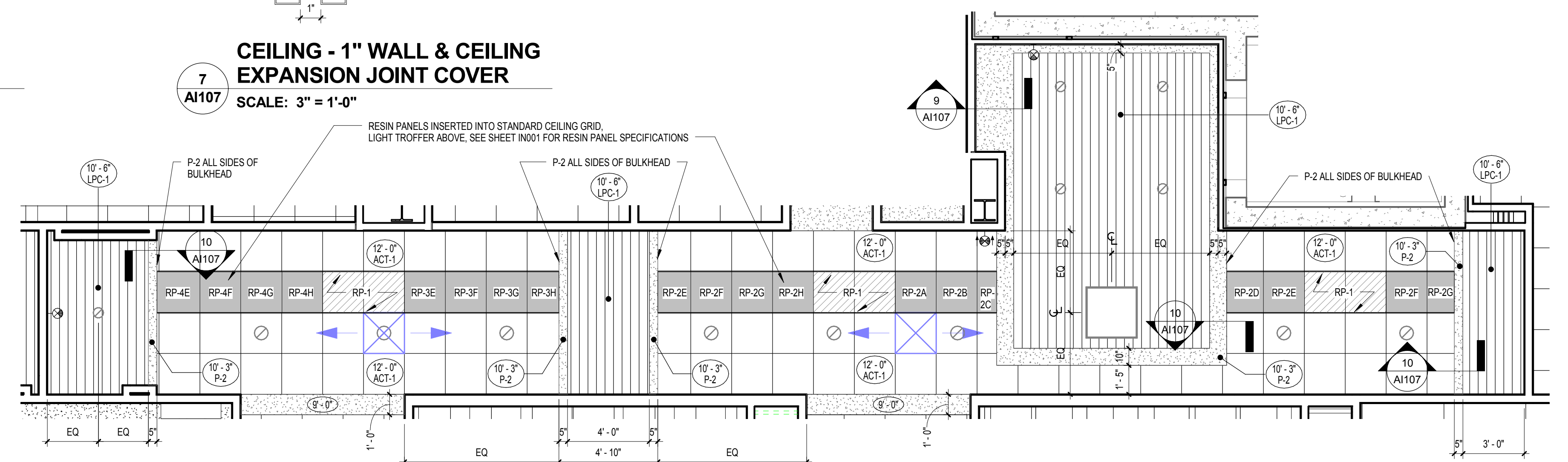

Architectural drawing of a wall section. The wall features a diamond-patterned mesh. Dimensions are provided for the wall's height and width. The height is divided into sections of 2'-11 1/2", 5'-0", 2'-6", and 1'-10". The width is divided into sections of 4'-0" and 2'-11 1/2". A note indicates "6\" AXIOM TRIM SEE ACT-2 FOR SPECS". The drawing is labeled with "A" and "B" at the top and "5" at the bottom left.

4 ENLARGED CEILING PLAN - CORRIDOR CG-2
AI107 SCALE: 1/4" = 1'-0"

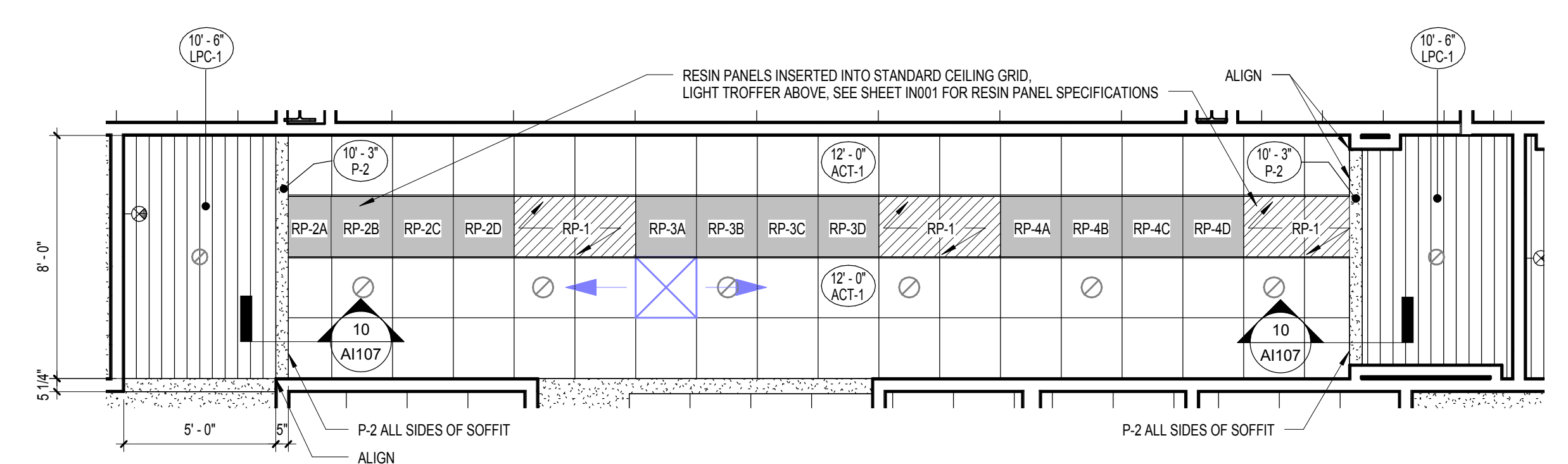

1 LEVEL 1 WAITING AND RECEPTION ENLARGED REFLECTED CEILING PLAN
AI107 SCALE: 1/4" = 1'-0"

2 LEVEL 1 WAITING AND RECEPTION - CURVED CEILING
A107 SCALE: 1/4" = 1'-0"