

three inches = one foot
one and one half inches = one foot
one inch = one foot
three quarters inch = one foot
one half inch = one foot
three eighths inch = one foot
one quarter inch = one foot
one eighth inch = one foot

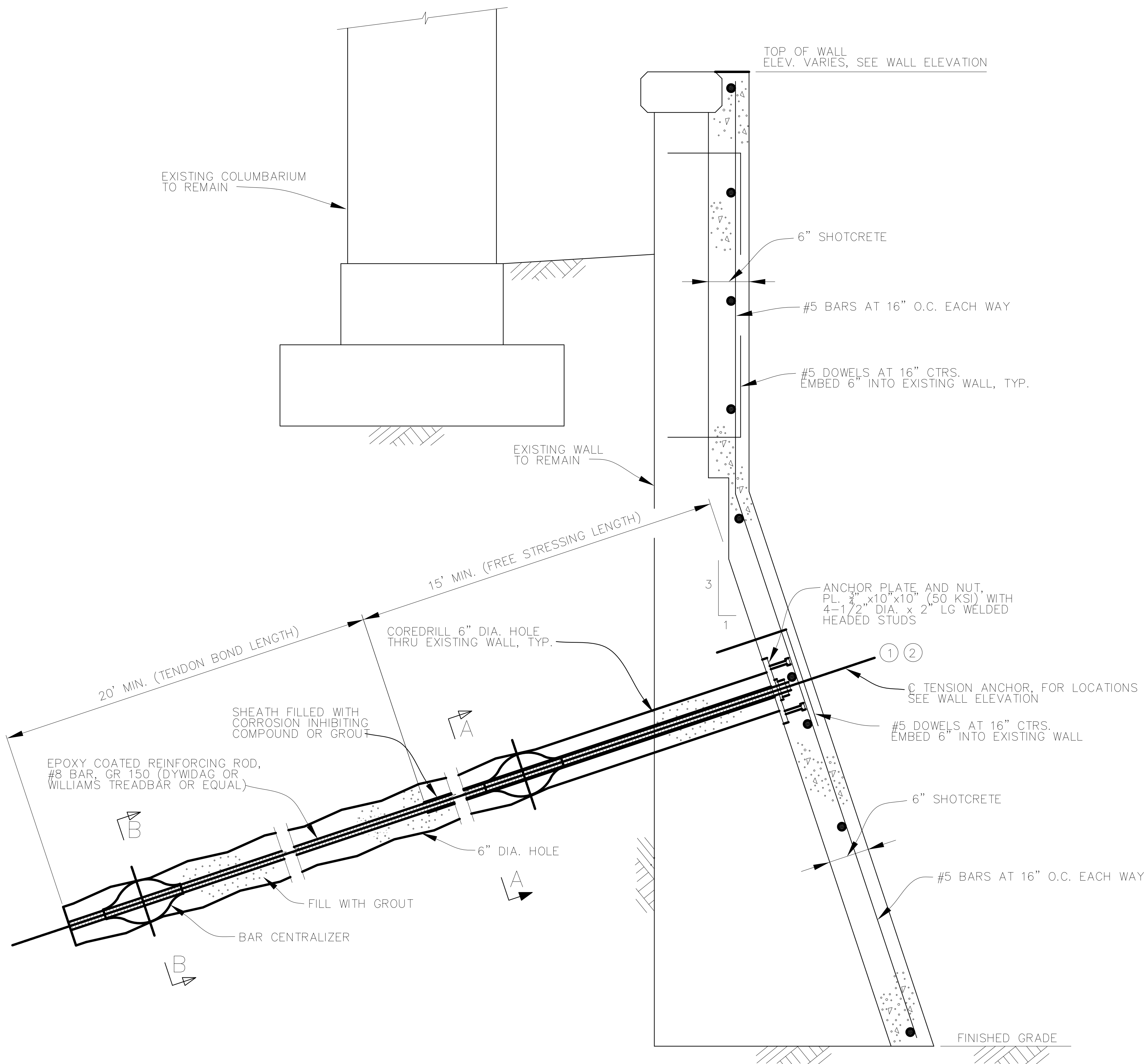

GENERAL NOTES:

- FURNISH CLASS "C" CONCRETE UNLESS OTHERWISE SHOWN.
- FURNISH GRADE 60 REINFORCING STEEL. ANCHORS SHALL BE #8 BARS, GRADE 150 EPOXY-COATED REINFORCING (DYWIDAG OR WILLIAMS THREADBAR OR EQUAL) WITH CLASS II CORROSION PROTECTION.
- TWO PREPRODUCTION TEST ANCHORS AND TWO PERFORMANCE TEST ANCHORS ARE REQUIRED. PROOF TEST ALL REMAINING ANCHOR LOCATIONS. ALL TESTS SHALL BE CONDUCTED IN ACCORDANCE WITH PTI GUIDELINES. MAXIMUM TEST LOAD FOR PREPRODUCTION ANCHORS SHALL LIMIT ANCHOR STRESS TO 0.80 F_{pu}. MAXIMUM TEST LOAD PERFORMANCE AND PROOF TEST SHALL BE 1.33DL (43.0 kips). LOCK OFF LOAD AT EACH ANCHOR LOCATION SHALL BE 36.0 kips.
- THE PRICE BID PER SQUARE FOOT OF RETAINING WALL (FASCIA) SHALL INCLUDE ALL CONCRETE, REINFORCING STEEL AND ANY OTHER MATERIALS NECESSARY TO COMPLETE THE WALL.
- THE PRICE BID PER LINEAR FOOT OF TENSION ANCHOR SHALL INCLUDE ALL DRILLING, REINFORCEMENT, GROUT, AND LOAD TEST.

CONSTRUCTION PROCEDURE:

- WHEN ALL ANCHORS HAVE BEEN INSTALLED AND INSPECTED BY SPECIAL INSPECTOR, THE PERMANENT SHOTCRETE FASCIA MAY BE COMPLETED.

- MODIFY THE ANCHOR SPACING AS NECESSARY TO AVOID CONFLICTS. MODIFICATION TO ANCHOR SPACING SHALL BE APPROVED BY THE ENGINEER.

- #8 BARS, GRADE 150 EPOXY-COATED REINFORCING (DYWIDAG OR WILLIAMS THREADBAR OR EQUAL). ANCHORS MAY BE SKEWED 15° (MAX) HORIZONTALLY AND VERTICALLY IN ORDER TO AVOID CONFLICTS UNLESS OTHERWISE NOTED. AVOID CONFLICTS WITH EXISTING UTILITIES WITH A 2'-0" MINIMUM CLEARANCE.

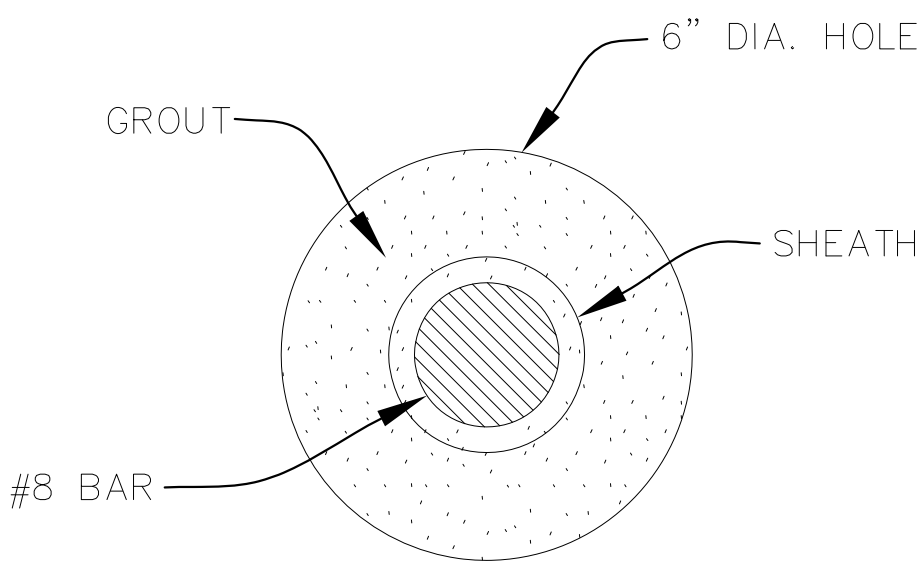

SECTION A-A

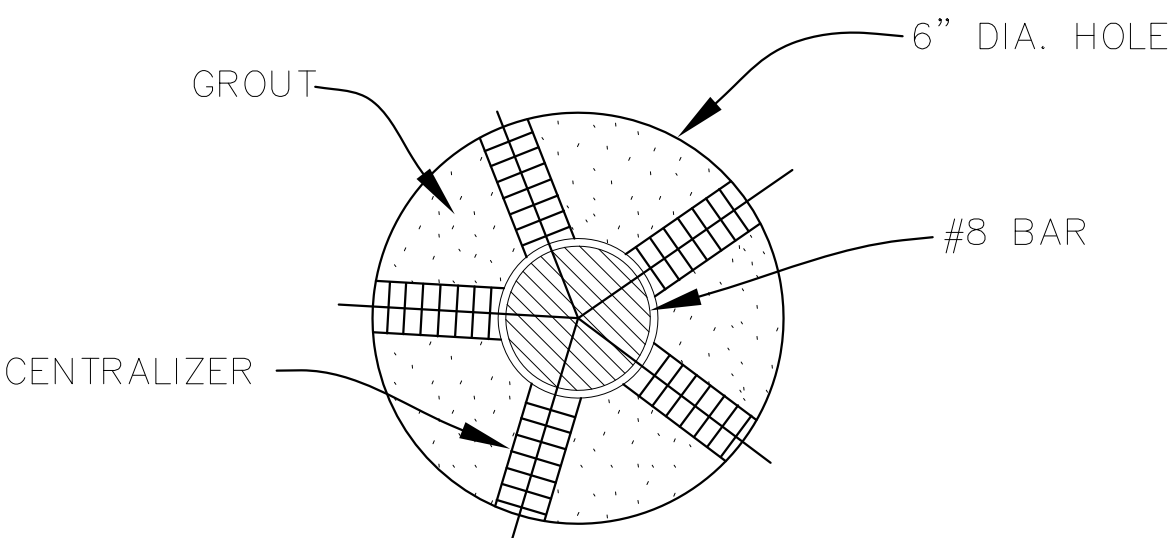

SECTION B-B

ESTIMATED ANCHOR QUANTITIES										
PANEL	1	2	3	4	5	6	7	8	9	10
NO. OF ANCHORS	0	0	1	1	1	1	2	3	1	10
EST. ANCHOR LENGTH (FT)	0	0	35	35	35	35	70	105	35	350

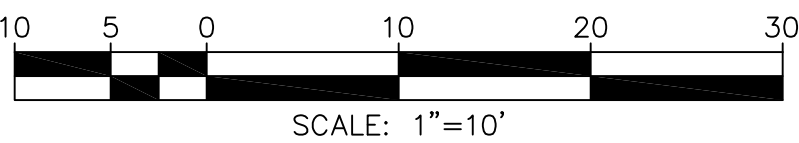

Revisions:	Date	CONSULTANTS:	ARCHITECT/ENGINEERS:	Drawing Title	Project Title	Project Number	NATIONAL CEMETERY ADMINISTRATION DESIGN AND CONSTRUCTION SERVICE	
		ENVIRONMENTAL PAR ENVIRONMENTAL SERVICES, INC. 1906 21ST STREET SACRAMENTO, CA 95811 (916) 739-8356 MLMANIERY@YAHOO.COM JGMANIERY@YAHOO.COM	HAZMAT RGA ENVIRONMENTAL 2617 McGAW AVENUE IRVINE, CA 92614 (949) 854-2025 DAVID.SILVER@TERRACON.COM	JACOBS Jacobs Engineering Group Inc. Consultants in Architecture, Engineering, Planning, and the Environment Irvine Office 2600 Michelson Drive, Suite 500 Irvine, California 92612 (949) 224-7500 Fax (949) 224-7501	TENSION ANCHOR DETAILS	FORT ROSECRANS NATIONAL CEMETERY REPLACE MAINTENANCE BUILDINGS	892-CM3-035	Department of Veterans Affairs
				Approved: Project Director	Location: FORT ROSECRANS NATIONAL CEMETERY CABRILLO MEMORIAL DR, SAN DIEGO, CA 92106	Drawing Number		
					Date: 07/18/2018	Checked: AJC	Drawn: SEM	
						Dwg. 15 of 48		