

GENERAL NOTES

1. ALL PROVIDED DETAILS APPLY; REFER TO DETAIL SHEET.

2. REFER TO PIPING SCHEMATIC FOR ADDITIONAL INFORMATION.

KEYED NOTES

① 3/4" HEATING WATER SUPPLY DOWN TO SERVE NEW HOT WATER CONVECTOR. TIE INTO TAKE-OFF ABOVE THE CEILING THAT HAS BEEN VALVED AND CAPPED FOR FUTURE.

② 3/4" HEATING WATER RETURN DOWN TO SERVE NEW HOT WATER CONVECTOR. TIE INTO EXISTING TAKE-OFF ABOVE THE CEILING THAT HAS BEEN VALVED AND CAPPED FOR FUTURE USE.

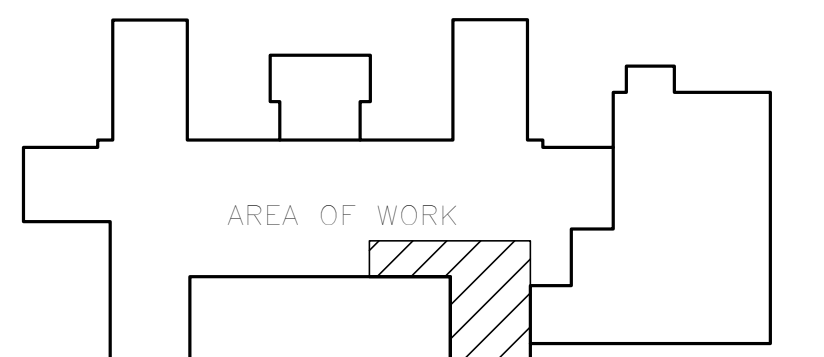

KEY PLAN - 2ND FLOOR
NOT TO SCALE

1 SECOND FLOOR EAST MECHANICAL PIPING PLAN AREA B
1/4" = 1'-0"



ADDENDUM #1	10/30/2018
BID SET	06/18/2018
100% REVIEW	1/30/2018
50% REVIEW	12/18/2017
Revisions:	Date:

CONSULTANT

NORTHERN DESIGN WORKS

420 RAIL STREET
NEGAUNEE, MI 49866
PHONE: 906-475-6616
NDW PROJECT NUMBER: 1718

ARCHITECT/ENGINEER OF RECORD

MEP ASSOCIATES, LLC

engineers | consultants | commissioning
MEP Associates, LLC | 1720 Arbor Court | Eau Claire, WI 54601
Phone: 715.837.5880 | Fax: 715.837.5881 | www.mepassociates.com
MEP PROJECT NO.: G29.17.04

STAMP

Office of
Construction
and Facilities
Management

VA U.S. Department
of Veterans Affairs

Drawing Title
**SECOND FLOOR EAST
MECHANICAL PIPING PLAN**

Approved: Project Director

Phase
**CONSTRUCTION
DOCUMENTS**

FULLY SPRINKLERED

Project Title
**INSTALL PERIMETER HEAT TO
IMAGING AND 4-EAST**

Location
IRON MOUNTAIN, MICHIGAN

Issue Date
JUNE 18, 2018

Checked
RCA

Drawn
JTG

Project Number
585-17-105

Building Number
No. 1

Drawing Number
MP121
Dwg. 11 of 24