

one and one half inches = one foot
one inch = one foot
three quarters inch = one foot
one half inch = one foot
one quarter inch = one foot
one eighth inch = one foot

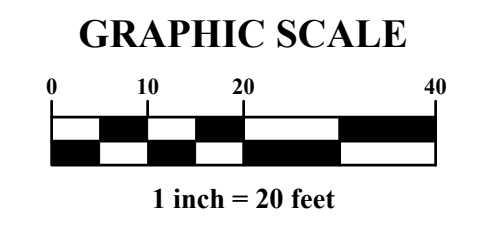
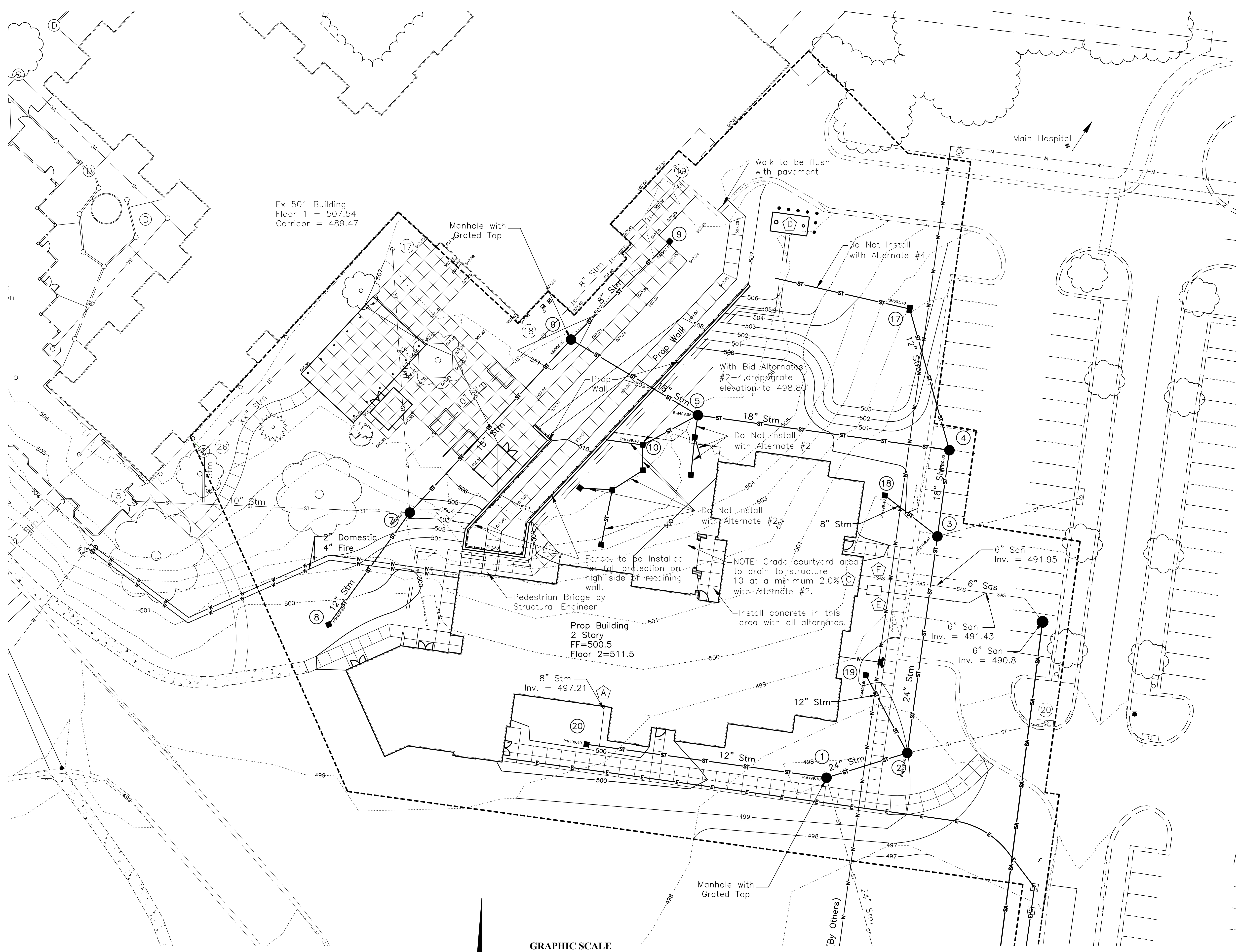

SITE BID ALTERNATE LIST:

- BID ALTERNATE #1:**
ELIMINATE LOADING DOCK PAVING AND LOCATION OF THE REMOTE FUEL STORAGE TANK AND BOLLARDS AS SHOWN ON CS108. DUE TO REMOVAL OF LOADING DOCK PAVING THE LIMITS OF DEMOTION (CS105) AND PAVEMENT REPLACEMENT (CS108) ARE MODIFIED. SEE LP106FOR MODIFIED LANDSCAPE PLANTINGS.
- BID ALTERNATE #2:**
ELIMINATE TEMPORARY CONSTRUCTION ACCESS AND CONCRETE WALKS, STEPS, RAMPS, PLANTER WALLS, UNDERDRAINS, RAINWATER HARVESTING SYSTEM AND IRRIGATION IN COURTYARD AREA AS SHOWN ON SHEET LP105. SIDEWALK TO REMAIN INCLUDES WALK ON SOUTH AND EAST SIDES OF BUILDING AND PORTIONS EXITING THE NORTH SIDE OF THE ELEVATOR LOBBY AREA. SEE CS109AFOR CLARIFICATION ON ANY SIDEWALKS TO REMAIN IN CONTRACT.
- BID ALTERNATE #3:**
EXTEND LIMITS OF GRADING TO SINGLE WIDE CORRIDOR (SEE ARCHITECTURAL DRAWINGS FOR LIMITS OF SINGLE WIDE CORRIDOR).
- BID ALTERNATE #4:**
DELETE CONNECTING CORRIDOR, ADD RETAINING WALL AND PEDESTRIAN WALK BRIDE (SEE STRUCTURAL PLANS FOR DETAILS). ADD 6' WIDE WALK CONNECTION FROM 501 BUILDING TO PROPOSED BUILDING, REDUCE LIMITS OF UPPER COURTYARD CONCRETE INSTALLATION. FOR GRADING MODIFICATIONS AND CLARIFICATION OF SCOPE, SEE CS109A. INSTALL LOW VOLTAGE DUCT BANK PER MECHANICAL PLANS.

LEGEND

Existing

- Sanitary Sewer
- Storm Sewer
- Water Main
- Electric
- Fire Hydrant
- Water Valves
- Electric Pull Box
- Electric Outlet
- Electric Pedestal Box
- Wooden Light Pole
- Metal Light Pole
- Mailbox
- Fence Post
- Sign
- Trees
- Bushes
- Contours
- Structure Number

Proposed

- Contours
- Spot Elevation
- Limits of Disturbance (1.91 Acres)
- Storm Structure Number
- Water Line
- Water Valve
- Fire Department Connection
- Storm Line
- Storm Manhole
- Storm Catch Basin
- Storm Yard Inlet
- Sanitary Service
- Sanitary Main (By Others)
- Sanitary Manhole (By Others)
- Electric Line
- Electric Manhole
- Gas Line

Key Notes

- Roof Drain Connection Location (Sitework limits to 5' outside building)
- Rainwater Collection System Roof Drainage Connection Location
- Sanitary Sewer Connection Location (Sitework limits to 5' outside building)
- Fuel Oil Tank
- Contractor to Verify As-Built Water Elevations and ensure 24" clearance to sanitary lateral
- 2.5' Sanitary Lateral Riser between Water Main and Proposed Building

Notes

- Location of existing utilities indicated on these plans is approximate. Contractor shall verify location of all existing utilities prior to construction.
- No blasting is allowed on-site.
- See Detail C, CS104 for patching of existing pavement associated with proposed utility work.
- See Specification 31 20 11 for backfill requirements with utility excavation.
- Reference CS109 for grading in areas not impacted by deduct alternates.

Revisions:		Date:		CONSULTANTS:		ARCHITECT/ENGINEERS:		Drawing Title:		Project Title:		Project Number:		Office of Construction and Facilities Management Department of Veterans Affairs			
				 Evans, Mechwart, Hombler & Tilton, Inc. Engineers • Surveyors • Planners • Scientists 3550 New Albany Road, Columbus, OH 43254 Phone: 614.775.4500 • Toll Free: 888.775.3448 emht.com		 C.C. HODGSON ARCHITECTURAL GROUP P.C.		ALTERNATE GRADING AND UTILITY PLAN		RELOCATE DEMENTIA UNIT		VA PN 613-207					
								Approved: Project Director		Location VAMC MARTINSBURG		Building Number 513					
										Date 8/6/2012		Checked JAM		Drawn SBO		Drawing Number CS109A	
																Dwg. 9 of 17	

VA FORM 08-6231