

one and one half inches = one foot
one inch = one foot
three quarters inch = one foot
one half inch = one foot
one quarter inch = one foot
one eighth inch = one foot

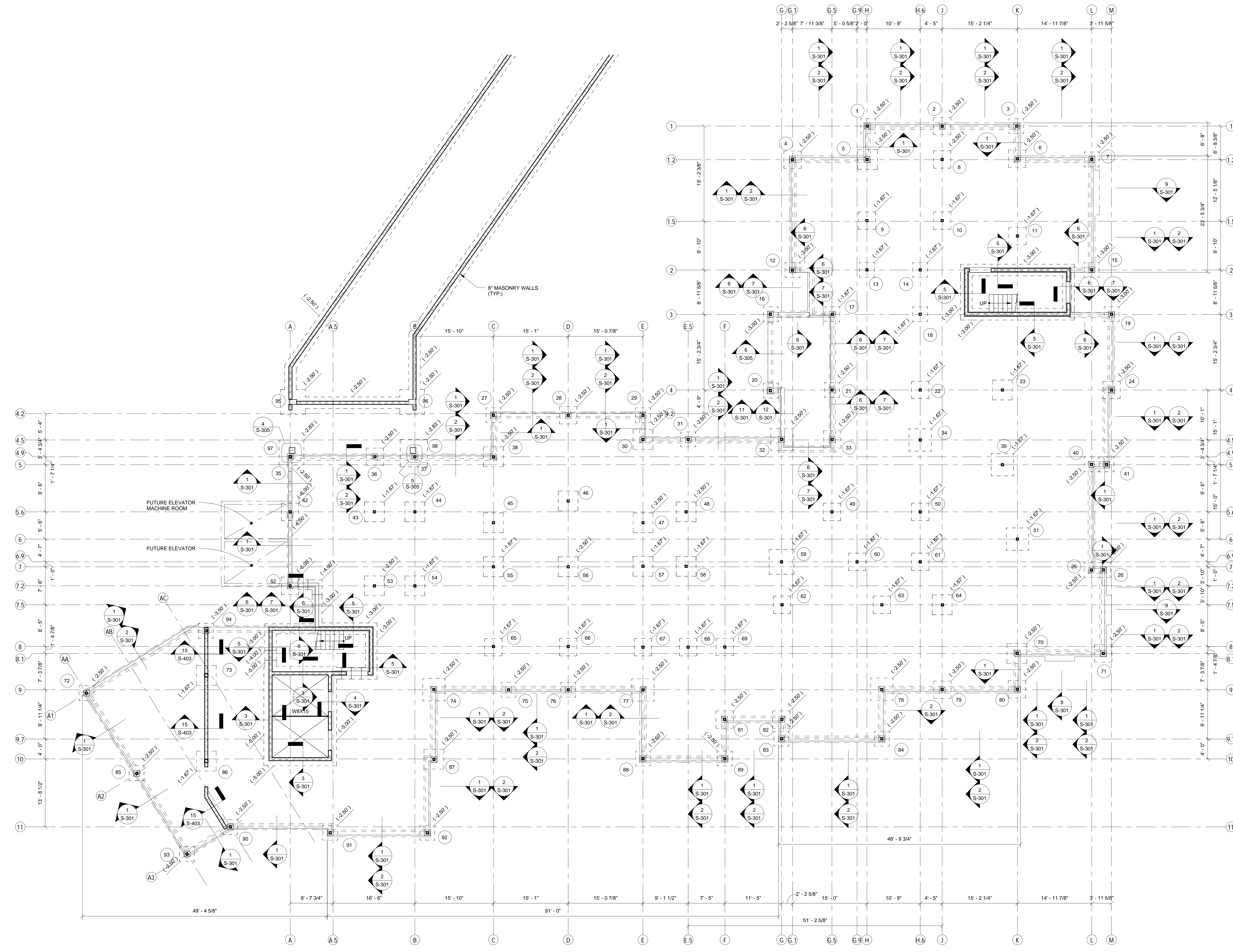

1 FIRST FLOOR / FOUNDATION PLAN
1/8" = 1'-0"

- NOTES**
1. FLOOR SLAB TO BE 4" SLAB ON GRADE REINF. WITH 6x6-10/10 W.W.F. PLACED OVER 6 MIL POLYETHYLENE ON 4" WASHED GRAVEL.
 2. TOP OF SLAB EL. 0'-0" (SEE ARCH. DWGS.)
 3. SEE ARCH. DWGS FOR ALL DIMENSIONS.
 4. CONTRACTOR TO COORDINATE WITH ARCH. AND MEP AND REPORT ANY DISCREPANCIES BEFORE PROCEEDING WITH THE WORK.

<div>Revisions:</div> <table border="1"><thead><tr><th>Revisions:</th><th>Date</th></tr></thead><tbody><tr><td> </td><td> </td></tr><tr><td> </td><td> </td></tr><tr><td> </td><td> </td></tr></tbody></table>	Revisions:	Date							<div>CONSULTANTS:</div> <div>Tadger-Cohen-Edelson Assoc.</div> <div>CONSULTING STRUCTURAL ENGINEERS</div> <div>1109 Spring Street Suite #510 Silver Spring, MD 20910</div> <div>T: (301) 587-1520 F: (301) 588-1966 www.tadgerco.com</div> <div>11/01/2012</div>	<div>ARCHITECT/ENGINEERS:</div> <div>C.C. HODGSON</div> <div>ARCHITECTURAL GROUP P.C.</div>	<div>Drawing Title</div> <div>1ST FLOOR / FOUNDATION PLAN</div> <div>Approved: Project Director</div>	<div>Project Title</div> <div>RELOCATE DEMENTIA UNIT</div> <div>Location</div> <div>VAMC MARTINSBURG</div> <div>Date</div> <div>8/6/2012</div>	<div>Project Number</div> <div>VA PN 613-107</div> <div>Building Number</div> <div>513</div> <div>Drawing Number</div> <div>S-101</div> <div>Dwg. of --</div>	<div>Office of Construction and Facilities Management</div> <div></div>
	Revisions:	Date												