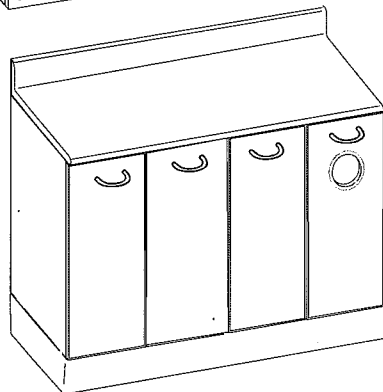
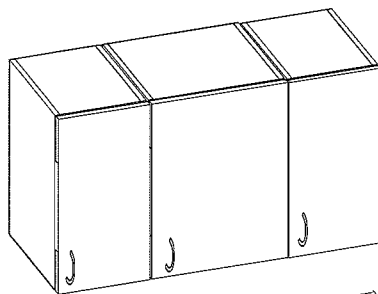
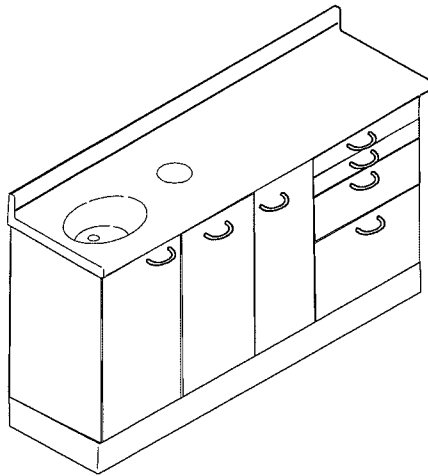


# CaseWorx

## UPPER AND METAL BASE MODULES Installation Instructions

---



*Pelton & Crane*

## TABLE OF CONTENTS

CaseWorx Labeling System .....	3
Base Module Installation .....	4
Upper Module Installation .....	7
Tapmaster Faucet Service Information .....	10
Care and Maintenance for Cabinetry Surfaces .....	11
Care and Maintenance for Solid Surfacing (SS) Countertops .....	12

---

### Technical Support

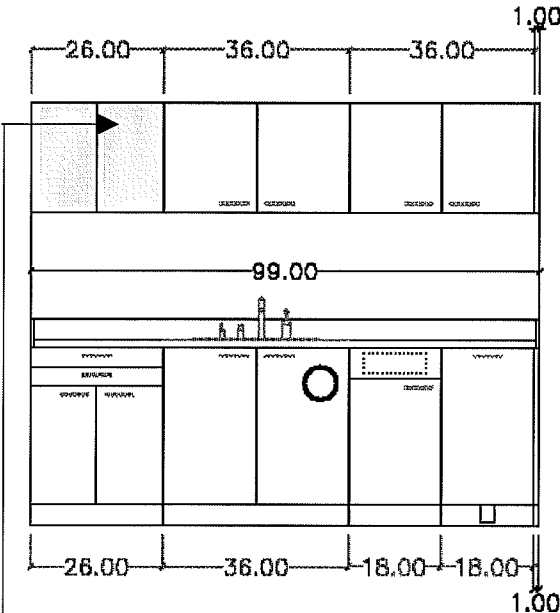
Technical assistance is available Monday through Friday,  
8:00 am to 6:00 pm (Eastern Standard Time).

<b>Phone:</b> 800-659-5922 <b>Fax:</b> 704-583-8506
--

## CASEWORX LABELING SYSTEM

**IMPORTANT:** When installing cabinets, pay attention to the serial number and the configuration # in the lower left and right hand corners of the serial plate. Cabinets should be separated by serial numbers and installed from left to right keeping configuration numbers in sequence.

**IMPORTANT:** END PANELS AND DRESS PANELS MUST BE ORDERED FOR BOTH UPPER AND BASE CABINETS.

Cabinet Color:	Countertop Color:	Handle/Push/Knob
<p>QUOTE #</p> <p><b>GROUP BOXES BY THE CWX NUMBER</b></p> 		

Group boxes by the CWX number located at the top of label.

Position cabinet configuration according to the highlighted module indicated on the label.

## BASE MODULE INSTALLATION

**NOTE: INSTALL UPPER WALL MOUNT CABINETS BEFORE BASE CABINETS.**

1. Remove cabinet module from carton and carefully position cabinet on its back.
2. Remove all drawers and doors from cabinet taking care to store doors and drawers in a manner in which all can go back in their original position. The hinges used are 'snap-on/off' and can easily be removed by pulling the tab marked "pull" located at the back end of the hinge base plate. Hold onto door securely because the hinges disengage quickly when the tab is pulled.

**Note: Some modules may have false floors in the base of cabinets. Remove the false floors and store them carefully.**

3. Remove hardware package from cabinet and obtain the bag with leveling feet hardware:

(4) leveling legs, (4) 10mm socket screws and (4) 10mm screw cover caps, 4 spring nuts

4. Install the level legs into the sockets attached to the bottom of module.

5. Place steel base in the desired location with slotted holes facing up.

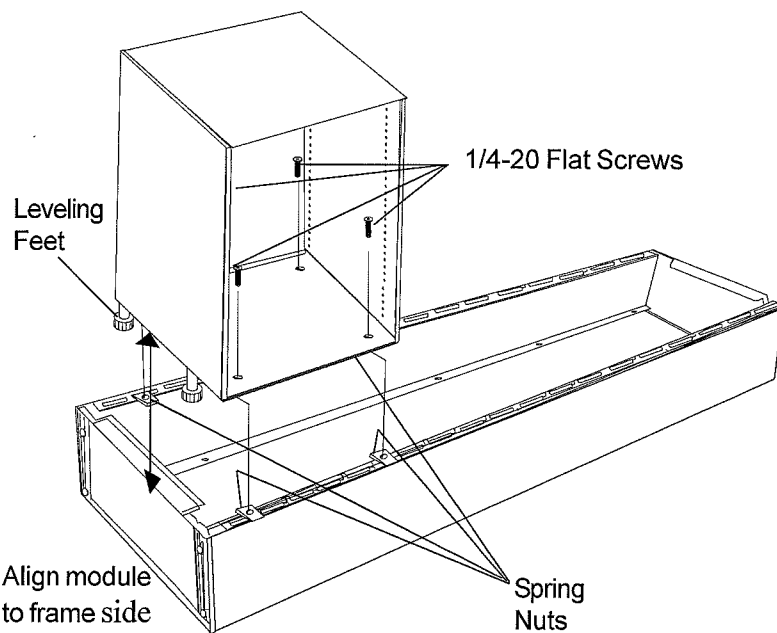
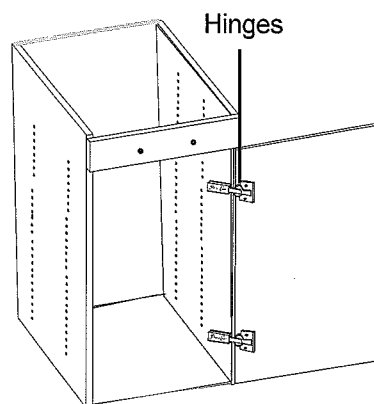
**NOTE: When installing the modules to the frame, start at the left of frame and finish installation at the right.**

**NOTE: If module is a sink requiring plumbing through base of cabinet, drill or route access holes for plumbing at this time.**

6. Install spring nuts into the appropriate slotted holes in frame where the module corners are mounting to frame.
7. Position module aligning the holes in module base corners with the spring nuts.

**NOTE: Ensure the first module installed is in alignment with the left side of metal frame.**

8. Install 1/4-20 flat screws in the front and back holes of modules and through the spring nuts being careful not to overtighten screws.
9. Level module by turning base of leveling feet. Ensure module is level across the top and the leveling feet make contact with the floor.
10. Continue installing modules aligning the next module with the first until all modules are installed.



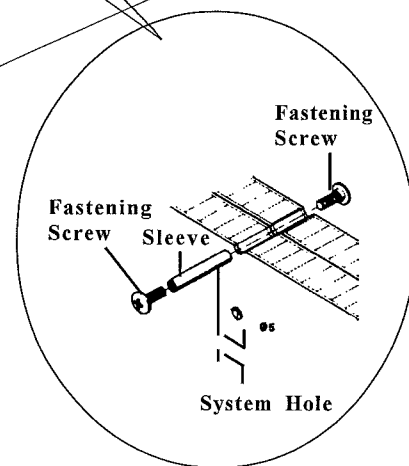
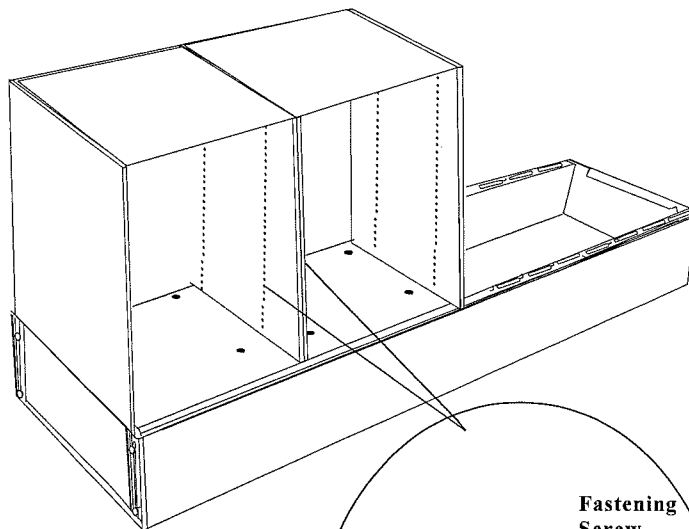
## BASE MODULE INSTALLATION

11. Using the 5mm diameter x 30mm long sleeve and 4mm diameter joining screw, secure units together. Start the fastening screw into the sleeve, push sleeve into system hole until it is flush with cabinet, from opposite side, using second fastening screw, draw modules together.

Recommended fastening locations are listed below.

- From top front, use the third system hole down from the top, including the hinge or drawer slide mounting hole. Repeat for top back.
- From the bottom front, use the third system hole up from the bottom. Repeat for the bottom back.

12. To secure a module to the treatment room desk module, use the (4) #10 x 1-1/4" pan head screws provided with the desk module. Modules should be clamped together before securing to assure proper alignment.

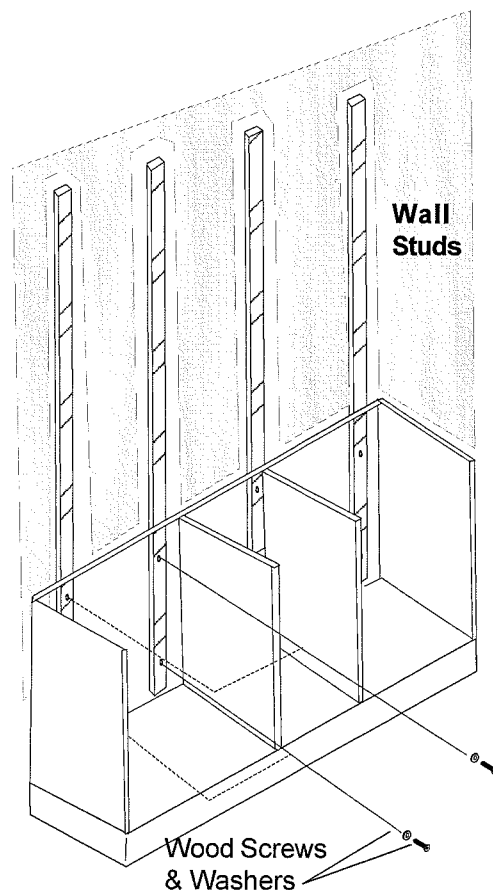


### **Securing Cabinet to Wall**

1. Remove the false floor panels located in the cabinet base. Level cabinet by turning the leveling feet making sure that all leveling feet are touching the floor and that cabinet is level.
2. Locate and mark stud locations in wall behind base cabinet. Drill a 1/8" hole through the back panel of modules at each stud location. Hole location should be approximately 2" down from top panel inside the module. Secure cabinet to wall using 3" wood screws and washers.
3. If applicable, using the 4mm x 1" screw, secure an end dress panel to each end of the cabinet. The brass insert closest to the edge of the dress panel goes to the front of the cabinet. The end dress panel fits flush with the bottom and back of the module, with a 3/4" gap at the top.

### **Mounting locations are as follows:**

- From top front, use the third system hole down from the top, including the hinge or drawer slide mounting hole. Repeat for top back.
  - From the bottom front, use the third system hole up from the bottom. Repeat for the bottom back.
4. Remove countertop from carton and position on cabinet. Center the top on base modules and push back against wall. Use clamp to hold top in place while securing countertop to base using (4) #10 x 1-1/4" screws in each module position.
  5. Replace all doors and drawers and adjust if necessary. A posidrive screwdriver is available for ease of adjustments.
  6. After unit has been installed, caulk between the top of the backsplash and the wall. Caulk sidesplash into place if applicable.



## BASE MODULE INSTALLATION

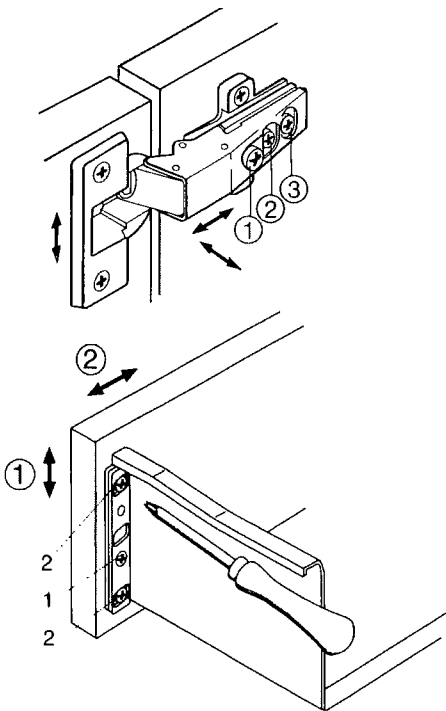
### Hinge Adjustments

1. Side Adjustment
2. Height Adjustment
3. Depth Adjustment

NOTE: Remove cover cap and use a posidrive screwdriver for hinge adjustment.

### Drawer Adjustments

1. Vertical adjustment: Loosen screws **2** lightly, adjust screw **1** (adjustment  $\pm 2\text{mm}$ ), tighten screws **2**.
2. Horizontal adjustment: Loosen screws **2** lightly, adjust front to desired position (adjustment  $1.5\text{mm}$ ), tighten screws **2**.
3. Angle correction: Loosen top screw or bottom screw **2** according to your needs. Push angle correction wedge (type 6155) in between, tighten screws **2** and tear off wedge. Angle correction  $\pm 1^\circ$ .



## UPPER MODULE INSTALLATION



**WARNING: DO NOT ATTEMPT TO HANG CABINETS BY ANY OTHER MEANS THAN WITH THIS HANGING RAIL SYSTEM. CABINETS ARE NOT DESIGNED TO BE HUNG VIA SCREWS THROUGH BACK PANEL. THE WALL MOUNT HANGING SYSTEM CONSISTS OF A METAL HANGING RAIL SECURED TO THE WALL USING SCREWS AND TOGGLE BOLTS. UPPER UNITS ARE THEN MOUNTED TO THE HANGING RAIL USING HARDWARE ALREADY ASSEMBLED IN THE UPPER CABINETS. THE UNITS ARE SECURED TO EACH OTHER AND A END DRESS PANEL IS ATTACHED TO EACH END.**

1. Determine the height of the wall cabinet and mark a level line. (**Figure 1**)
  - 80" height is recommended for Sterilization Center (22" between countertop and upper cabinet) and 72" height is recommended for Treatment Room (14" between countertop and upper cabinet).
  - For locating from top of upper unit. Establish top of your cabinet elevation. Install the rail 2-5/8" below the top elevation and the bottom of the rail. (Minimum space required between the ceiling and the screw holes on the hanging rail is 1-3/4".)
2. Along marked level line, locate and mark studs in wall. Place hanging rail to level line and using screw holes in hanging rail as a template, mark location for a toggle bolt between studs and, if rail does not end directly over a stud, at ends of the hanging rail. (**Figure 1**)
3. Remove hanging rail and install E-Z toggle bolts in marked locations. Screw hanging rail to the wall.

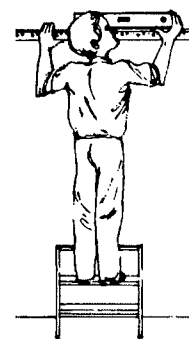


Figure 1

### Install E-Z Toggle:

- A. Place #2 phillips head or cordless screwdriver into the recess of the E-Z toggle. Press firmly into the wallboard and turn the anchor clockwise until seated flush with the wall. Repeat for all toggle bolt locations required. Make sure arrow on E-Z toggle is either pointing up or down. (**Figure 2**)
- B. From center, place hanging rail and washer into position over installed E-Z toggle. Insert screw with the special point (#8 diameter with 2-1/8" length). (**Figure 3**)
- C. With screw inserted into E-Z toggle, begin turning to engage clamp. Do not use power driver to engage clamp. (**Figure 4**)
- D. Continue turning screw until tight, the clamp will move forward against the drywall as the screw is turned. Repeat for all toggle locations. (**Figure 5**)

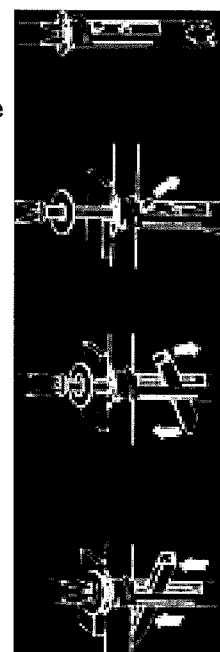
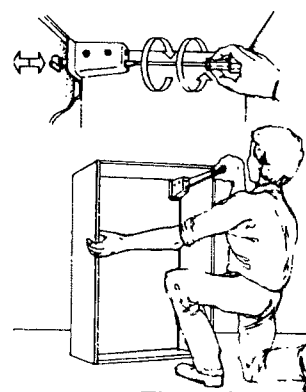


Figure 5

## UPPER MODULE INSTALLATION

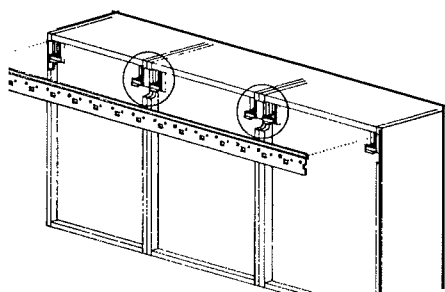
4. Install 3" pan head screw with washer into each stud behind the hanging rail.

5. Prepare the cabinets for hanging. We suggest removing the cabinet doors and shelves before hanging. The hinges are 'snap-on/off' and can easily be removed by pulling the tab marked "pull" located at the back end of the hinge baseplate. Hold onto door securely because the hinges disengage quickly when the tab is pulled. Preposition the hanger bracket arm by turning the adjusting screw: grasp the hanger arm and pull out as you turn the adjusting screw located in the front of hanger hardware. Otherwise you can turn the screw and nothing appears to be happening. Turn the bottom screw counter clockwise until the arm is fully extended. **(Figure 6)**

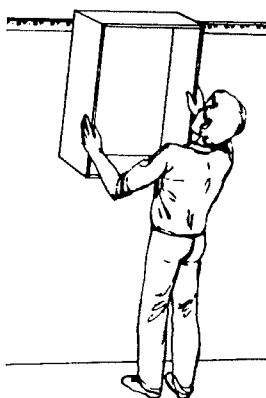


**Figure 6**

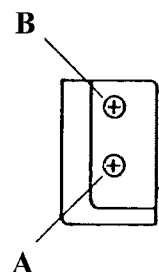
6. Hang each cabinet, making sure that the wall brackets are hooked onto the hanging rail properly. Do not do any final adjusting until all cabinets are hung. The cabinets can now be adjusted in or out, and up or down until level and plumb. **(Figures 7a,7b, and 7c)** Start by adjusting bottom screw **A** clockwise until cabinets are pulled firm against wall. After all cabinets are firm against wall, adjust cabinets until level using top screw **B**.



**Figure 7A**



**Figure 7B**



**Figure 7C**

### Adjustments:

Side-to-side: adjustment is unlimited.

Height adjustment: up or down 1-1/4". Turn screw **A** clockwise to raise. The cabinet and counter clockwise to lower the cabinet. **Figure 7C)**

Depth adjustment: in or out 1-3/16". Turn screw **B** clockwise to pull the cabinet towards the wall and counter clockwise to move the cabinet. Away from the wall.

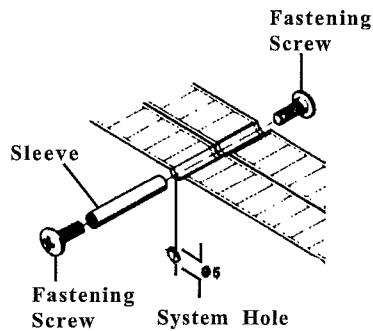


## UPPER MODULE INSTALLATION

- Using the 5mm diameter x 30mm long sleeve and 4mm diameter joining screw, secure units together. Start the fastening screw into the sleeve, push sleeve into system hole until it is flush with cabinet. From opposite side, using second fastening screw, draw cabinets together. Fastening locations are listed below. (**Figure 8**)

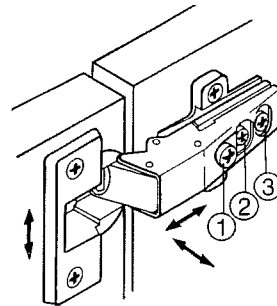
### Fastening locations:

Use the system holes directly behind the hinge base plates on the front of the cabinet and the back bottom and top system holes in the back of the cabinet.



**Figure 8**

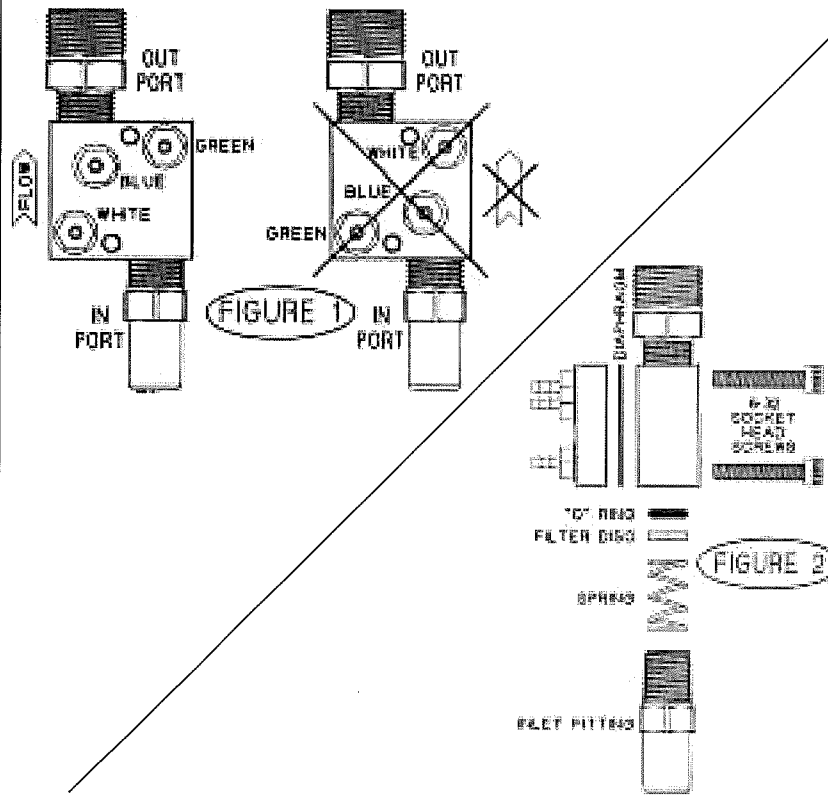
- Using (4) 4mm x 25mm screws in each dress panel, secure end dress panel to each end of the upper unit. System hole mounting locations as listed above.
- Replace doors and adjust if necessary. (**Figure 9**)



**Figure 9**

## TAPMASTER FAUCET SERVICE INFORMATION

SYMPTOMS	CAUSE	REMEDY
Tapmaster leaking and/or noise problems in valve blocks. <i>(Note: Tapmaster uses a differential pressure principle to close. Do not set faucet handle at a trickle).</i>	These symptoms are generally caused by water borne debris lodged in the valve block porting and/or damage to the diaphragm from this debris. Tapmaster warranty does not cover damage or failure by water borne debris.	In most situations, depending upon accessibility, debris may be removed from the valve blocks without removing them from the water lines. Shut off the water supply and disassemble the valve blocks by removing the 6-32 socket head screws <i>(hint: remove screws halfway and tap to unseat valve block halves)</i> . Clean all ports of any foreign matter with particular attention to the main inlet ports <i>(3 of circular group of 6)</i> . If no debris is found it will be necessary to remove the blocks from the lines and the 1/8" MPT x 3/8" tube inlet fittings to permit complete access. <b>Take care not to lose the spring, filter disc and O-ring.</b> After inspecting and cleaning the inlet port reinstall, in order, the O-ring, filter disc <i>(smooth side against O-ring)</i> and spring as per <b>figure 2</b> . Reinstall the inlet fitting with Teflon tape or thread sealant <i>(do not over tighten)</i> . Inspect diaphragms for punctures and/or severe abrasions and replace if necessary. Reassemble the valve blocks making certain to orient the control tubing half of each block as per <b>figure 1</b> .



If the above procedure fails to correct the problem, test the 3-way pilot valve for leaks and if necessary replace or return entire Tapmaster assembly to Integra for service. For infield service, order Tapmaster rebuild kit P/N 4001 from Integra Dynamics, Inc.

INTEGRA DYNAMICS, INC.  
 20 Bedwood Road N.E.  
 Calgary, Alberta Canada T3K 2K4  
 TEL: 403-275-5554 or 1-800-791-8117  
 FAX: 403-275-5928

## CARE AND MAINTENANCE FOR CABINETRY SURFACES

### **Disinfecting the Surfaces**

Disinfect cabinet surfaces by spraying or wiping with surface disinfectant using the spray-wipe-spray technique as endorsed by OSAP (Office Sterilization and Asepsis Procedures).



**CAUTION:** Follow the manufacturer's directions for use of disinfectants! Use only the disinfectants that have been tested and approved!

For additional infection control as well as to reassure your patients that you are following strong protective practices, we strongly recommend the use of coverings such as plastic, foil or treated paper or autoclavable components (such as light handles, assistant's instrumentation cover, tray mat, etc.) as well as the use of surface cleaners and disinfectants either daily or following each patient, depending on the circumstances.

### **Cleaning the Surfaces**

To remove dirt and disinfectant residues, clean the surfaces regularly with a normal commercial cleaning agent.



**CAUTION:** DO NOT use abrasive cleaners! Doing so can cause damage to the cabinet surface.

### **Resistance Medicaments**

Because of their high concentration and the substances they contain, many medicaments can affect surfaces by dissolving, etching, bleaching or discoloring! Carefully wipe with a damp cloth and use a cleaning agent to lessen potential damage!

## CARE AND MAINTENANCE FOR SOLID SURFACING (SS) COUNTERTOPS

### **General Care**

Wipe the surface with a damp cloth. If stain develops, clean with soap and water. Or if preferred, Windex® can be used. Always towel dry to prevent spotting.

**CAUTION:** Do not use Formula 409® or Fantastik® to clean the solid surfacing. Chemicals in these products could fade the surface.

### **Removing Stains**

When stains do not clean with soap and water, take the following steps.

Matte Finish: Using a circular motion, apply an abrasive cleaner and buff with a Scotch-Brite® pad.

**IMPORTANT:** When buffing, sanding or applying abrasive cleaners, always use a circular motion to preserve original countertop finish.

### **Cuts and Scratches**

Matte Finish: Sand the surface lightly in a circular motion with 220 grit sandpaper. Wipe the surface, then follow with an abrasive cleaner. End by buffing with a maroon or green Scotch-Brite® pad.

### **Hygiene**

Pelton & Crane Solid Surfacing is nonporous and provides an inhospitable environment for germ or mildew growth. With proper care and cleaning, the countertop will remain very sanitary.

### **General Precautions**

- Do not set hot items directly onto the countertop. Excessive heat can mar the countertop.
- Do not use sharp objects directly on the countertop. Although minor scratches and cuts can be repaired, care should be taken to keep the surface looking new.
- Do not expose surface to harsh chemicals. If these chemicals come in contact with the surface, immediately wash surface off with water using appropriate precautions. Buff in a circular motion with Scotch-Brite® pad.

**NOTES**

This image shows a single sheet of white paper with horizontal ruling lines. The lines are evenly spaced and run across the width of the page. There are no margins, text, or other markings on the paper.

Pelton & Crane, A DCI Company  
PO Box 7800  
Charlotte, NC 28241-7800  
USA

©2004, Pelton & Crane  
We reserve the right to make any alterations which may be due to any technical improvements.

Order No. **049336**  
**Rev. 0, 04/04**  
Printed in USA