

three inches = one foot
one and one half inches = one foot
one inch = one foot
three quarters inch = one foot
one half inch = one foot
three eighths inch = one foot
one quarter inch = one foot
one eighth inch = one foot

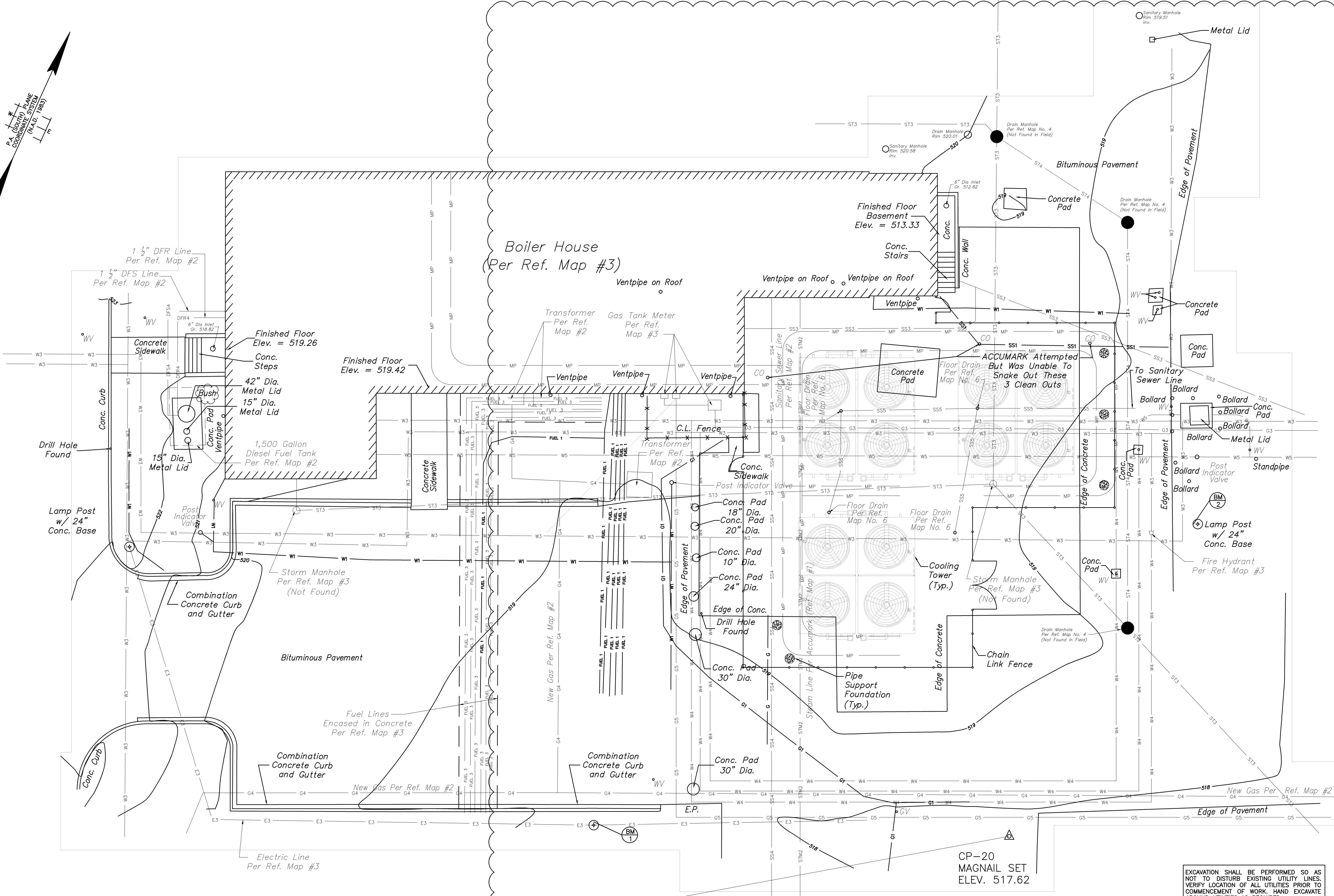
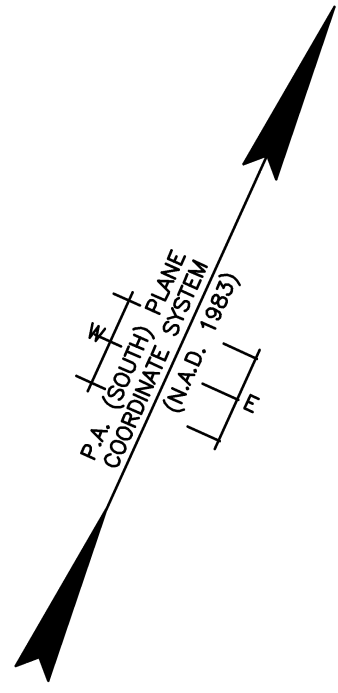

LEGEND

○ Bollard	BOLLARD
⊙ W	WATER VALVE
○	MANHOLE
F.Hyd. D	FIRE HYDRANT
○ CO	CLEAN OUT
Vent Pipe ○	VENT PIPE
— W1 —	WATER LINE PER ACCUMARK MARKOUT
— G1 —	GAS LINE PER ACCUMARK MARKOUT
— SS1 —	SANITARY SEWER LINE PER ACCUMARK MARKOUT
— FUEL 1 —	FUEL LINE PER ACCUMARK MARKOUT
— STM2 —	STEAM LINE (PER REF. MAP # 1)
— G3 —	GAS LINE (PER REF. MAP # 3)
— SS3 —	SANITARY SEWER LINE (PER REF. MAP # 3)
— E3 —	ELECTRIC LINE (PER REF. MAP # 3)
— ST3 —	STORM DRAINAGE LINE (PER REF. MAP # 3)
— W3 —	WATER LINE (PER REF. MAP # 3)
— FUEL 3 —	FUEL LINE (PER REF. MAP # 3)
— G4 —	NEW GAS LINE (PER REF. # 2)
— SS4 —	SANITARY SEWER LINE (PER REF. MAP # 2)
— DFR4 —	DIESEL FUEL SUPPLY LINE (PER REF. MAP # 2)
— W4 —	DIESEL FUEL RETURN LINE (PER REF. MAP # 2)
— G5 —	WATER LINE (PER REF. MAP # 4)
— ST4 —	GAS LINE (PER REF. MAP # 4)
●	STORM DRAINAGE LINE (PER REF. MAP # 4)
— W5 —	STORM DRAINAGE MANHOLE (PER REF. MAP # 4)
— SS5 —	WATER LINE (PER REF. MAP # 5)
— MP —	SANITARY SEWER LINE (PER REF. MAP # 6)
—	MECHANICAL PIPING LINE (PER REF. MAP # 7)
—	CONTOUR LINE (MAJOR)
—	CONTOUR LINE (MINOR)

EXCAVATION SHALL BE PERFORMED SO AS NOT TO DISTURB EXISTING UTILITY LINES. VERIFY LOCATION OF ALL UTILITIES PRIOR TO COMMENCEMENT OF WORK. HAND EXCAVATE AROUND UTILITIES AS REQUIRED.

REFERENCE MAPS:

- UTILITY DESIGNATING FIELD SHEET, VETERAN'S ADMINISTRATION MEDICAL CENTER, BEHIND UTILITY BUILDING, LEBANON, PENNSYLVANIA, PREPARED BY ACCUMARK, SUBSURFACE UTILITY SERVICES, DATED MAY, 2012.
- UTILITY LOCATIONS PROVIDED BY MILLER-REMICK, SITE PLAN, UTILITY LINE LOCATIONS, VETERANS AFFAIRS MEDICAL CENTER, LEBANON, PENNSYLVANIA, DATED OCTOBER 10, 1995, REVISED TO JULY 8, 2009.
- PARTIAL SITE PLAN, U.S. VETERAN'S ADMINISTRATION MEDICAL CENTER, AFBC CO-FIRING OF COAL AND HOSPITAL WASTES, SOUTH LEBANON TOWNSHIP, LEBANON COUNTY, PENNSYLVANIA, PREPARED BY SKELLY AND LOY INC., DATED MARCH 18, 1991.
- LEBANON VA MEDICAL CENTER, INCINERATOR BUILDING, S. LINCOLN AVENUE, LEBANON, PA, 17042, SHEET G-1, DATED SEPTEMBER 18, 1993, PREPARED BY STECKBECK ENGINEERING ASSOCIATES.
- BUILDING #10 WATER BY-PASS PLAN/LOCATION, VAMC, LEBANON, PA, 17042, DATED AUGUST 3, 1992.
- FLOOR PLAN, ELEVATIONS, ROOF PLAN AND DETAILS, LEBANON VA MEDICAL CENTER, INCINERATOR BUILDING, S. LINCOLN AVENUE, LEBANON, PA, 17042, SHEET A-1, REVISED TO SEPTEMBER 7, 1993, PREPARED BY RALPH E. KAYLOR AIA INC.
- STRUCTURAL FOUNDATION PLAN, COOLING TOWER REPLACEMENT, VA MEDICAL CENTER, LEBANON, PA., SHEET NO. SB-101, PREPARED BY MILLER-REMICK, LLC, DATED AUGUST 27, 2012.

BENCHMARKS

- BM 1 BOX-CUT SET IN CONCRETE BASE OF LIGHTPOLE #91. ELEV. 521.02
- BM 2 BOX-CUT SET IN CONCRETE BASE OF LIGHTPOLE #100. ELEV. 520.62

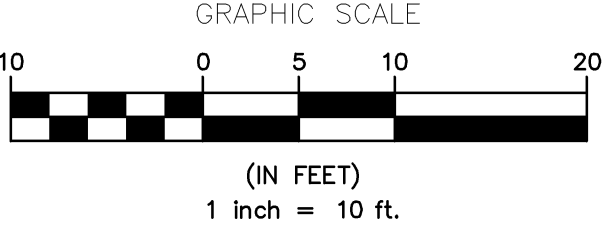

GENERAL NOTES:

- NO DETERMINATIONS HAVE BEEN MADE REGARDING HAZARDOUS MATERIAL CONDITIONS.
- NO DETERMINATIONS HAVE BEEN MADE REGARDING FRESHWATER WETLANDS LOCATIONS.
- PLANIMETRIC AND TOPOGRAPHIC FEATURES SHOWN HEREON ARE DRAWN IN ACCORDANCE WITH SURVEY PERFORMED ON THE GROUND BY T&M ASSOCIATES, MAY 17, 2012. HORIZONTAL DATUM IS NORTH AMERICA DATUM (N.A.D. 1983). VERTICAL DATUM IS NORTH AMERICAN VERTICAL DATUM (N.A.V.D. 1988).
- EXISTING UTILITY INFORMATION SHOWN HEREON HAS BEEN COLLECTED FROM A UTILITY MARKOUT PERFORMED BY ACCUMARK, APRIL, 2012 AND IS NOT GUARANTEED AS TO ACCURACY OR COMPLETENESS. THE CONTRACTOR SHALL VERIFY ALL INFORMATION TO HIS SATISFACTION PRIOR TO EXCAVATION. WHERE EXISTING UTILITIES ARE TO BE CROSSED BY PROPOSED CONSTRUCTION, TEST PITS SHALL BE DUG BY THE CONTRACTOR PRIOR TO CONSTRUCTION TO ASCERTAIN EXISTING INVERTS, MATERIALS AND SIZES. TEST PIT INFORMATION SHALL BE GIVEN TO THE ENGINEER PRIOR TO CONSTRUCTION TO PERMIT ADJUSTMENTS AS REQUIRED TO AVOID CONFLICTS.
- THIS PLAN DOES NOT INCLUDE PARKING OR HANDICAPPED PARKING STRIPS.
- PIPES NOTED AS PER ACCUMARK REF. MAP NO. 1 ARE FROM RECORD INFORMATION AND WERE NOT DETECTED IN THE FIELD.

CP-21
MAGNAIL SET
ELEV. 521.69

CONSULTANTS:



ARCHITECT/ENGINEERS:



Drawing Title
TOPOGRAPHIC SURVEY

Project Title
COOLING TOWER REPLACEMENT

Project Number
595-11-135
Building Number
10

Office of
Construction
and Facilities
Management

Approved Project Director

Location
VA MED. CENTER, LEBANON, PA
Date
8/27/2012
Checked
NEZ
Drawn
BRM

Drawing Number
CS-101
Dwg. 2 of 26

