

three inches = one foot
one and one half inches = one foot
one inch = one foot
three quarters inch = one foot
one half inch = one foot
three eighths inch = one foot
one quarter inch = one foot
one eighth inch = one foot

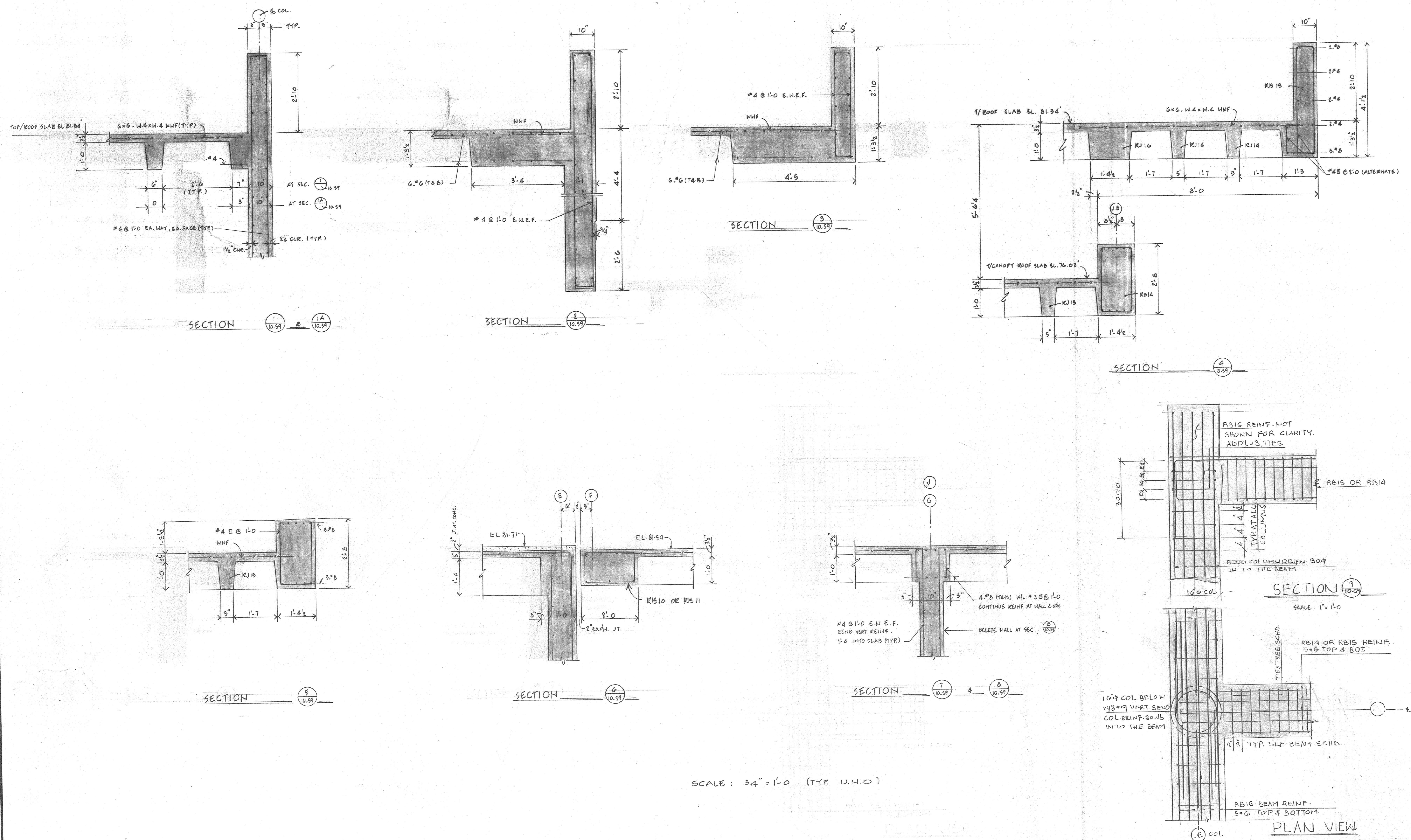

SCALE: 3/4" = 1'-0" (TYP. U.N.O.)

Revisions	Date

Drawing Title Framing Details & Sections Support Facility		Project Title 60 Bed Nursing Home Care Unit		Date 6-17-81
Approved: Division Chief <i>[Signature]</i>		Building Number Ten		Project No. 654-035
Approved: Service Director <i>[Signature]</i>		Location VAMC Reno, Nevada		Drawing No. 10-S9
Drawn K.K.B.		Checked L.S.H.		Dwg. Of