

LEGEND:

- EXISTING PROPERTY LINE
- EXISTING FENCE
- NEW FENCE
- EXISTING WOODLINE/VEGETATION
- NEW WOODLINE/VEGETATION
- EXISTING WATERLINE
- NEW WATER LINE
- NEW 8" FIRE LINE
- EXISTING GAS LINE
- NEW GAS LINE
- EXISTING SANITARY SEWER FORCE MAIN
- NEW SANITARY SEWER FORCE MAIN
- NEW STORM WATER LINE
- EXISTING OVERHEAD UTILITIES
- NEW GATE VALVE (C8/CU501)
- NEW POST INDICATOR VALVE (B4/CU501)
- NEW FIRE HYDRANT (E3/CU501)
- STORM
- NEW CLEAN-OUT (E8/CU501)
- NEW FDOT TYPE "E" INLET
- WATER METER

NOTES:

- STORMWATER PIPING AND STRUCTURES ARE SHOWN FOR UTILITY COORDINATION ONLY. FOR DETAILED STORMWATER DESIGN, SEE SHEET CG101.

KEY NOTES:

- CONNECT TO EXISTING 8" PVC WATERMAIN. INSTALL 8" TAPPING SLEEVE & VALVE (E2/CU502) & (E5/CU502).
- INSTALL 8" DOUBLE DETECTOR CHECK BFP WITH INSULATED ENCLOSURE. (A7/CU502)
- INSTALL 2" PVC DOMESTIC WATERLINE.
- INSTALL 3" PVC DOMESTIC WATERLINE.
- INSTALL 8" AWWA C900 DR18 PVC FIRE LINE.
- INSTALL 2" GTV. (C8/CU501)
- INSTALL 3" GTV. (C8/CU501)
- INSTALL 6" GTV. (C8/CU501)
- INSTALL 8" GTV. (C8/CU501 WITHIN PROPERTY) OR *(E5/CU502 AT THE PUBLIC R/W)
- INSTALL 6" PIV. (C3/CU501)
- INSTALL 6" AWWA C900 DR18 PVC FIRELINE.
- INSTALL 4"x2" TEE.
- INSTALL 8"x6" TEE.
- INSTALL 6" FIRE HYDRANT ASSEMBLY. (E3/CU501)
- INSTALL 3"x1" REDUCER, 1" GTV, 1" RPZ BFP W/INSULATED ENCLOSURE & HOSE BIBB.
- CONNECT TO EXISTING 4" GAS MAIN, INSTALL 2" VALVE.
- INSTALL 2" PE GAS LINE.
- CONNECT TO EXISTING 8" PVC SANITARY SEWER FM, INSTALL 8"x2" TAPPING SLEEVE & VALVE (E2/CU502) & (E3/CU502).
- INSTALL 2" PVC SANITARY SEWER FORCE MAIN.
- INSTALL SANITARY SEWER LIFT STATION. (A1/CU503)
- INSTALL 6" ASTM 3034 PVC SANITARY SEWER LATERAL @ 1.0%.
- INSTALL CLEAN-OUT (E8/CU501).
- INSTALL SANITARY SEWER MANHOLE. (E6/CU501)
- INSTALL 8" PVC SANITARY SEWER PIPE @ 0.40%.
- INSTALL 8"x6" REDUCER.
- INSTALL 2" RPZ BFP WITH INSULATED ENCLOSURE. (A2/CU502)
- (NOT USED)
- INSTALL 4" PVC DOMESTIC WATERLINE.
- INSTALL REDUCER AS REQUIRED.
- INSTALL 2" OMNI C2 METER & BOX. (F8/CU502 PER CITY OF PCB UTILITIES DEPARTMENT REQUIREMENTS)
- INSTALL 8"x3" TEE.
- INSTALL 8" TEE.
- CLOSELY COORDINATE UTILITY LOCATIONS WITH STRUCTURAL FOOTINGS.
- FIRE DEPARTMENT CONNECTION. (SEE SHEET FP101).
- INSTALL 90° FITTING.

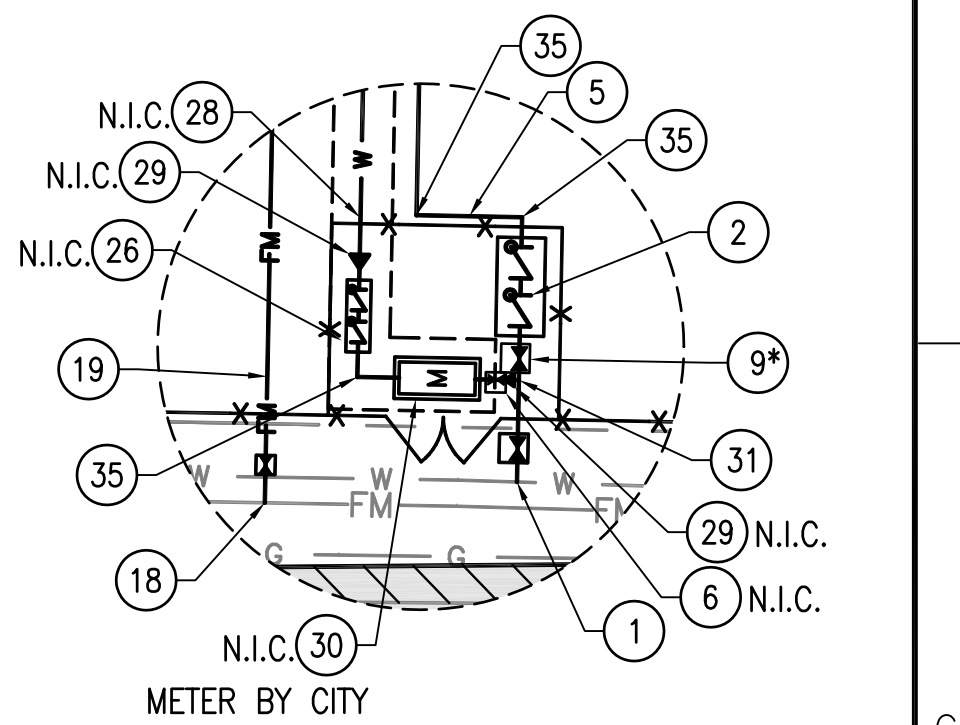
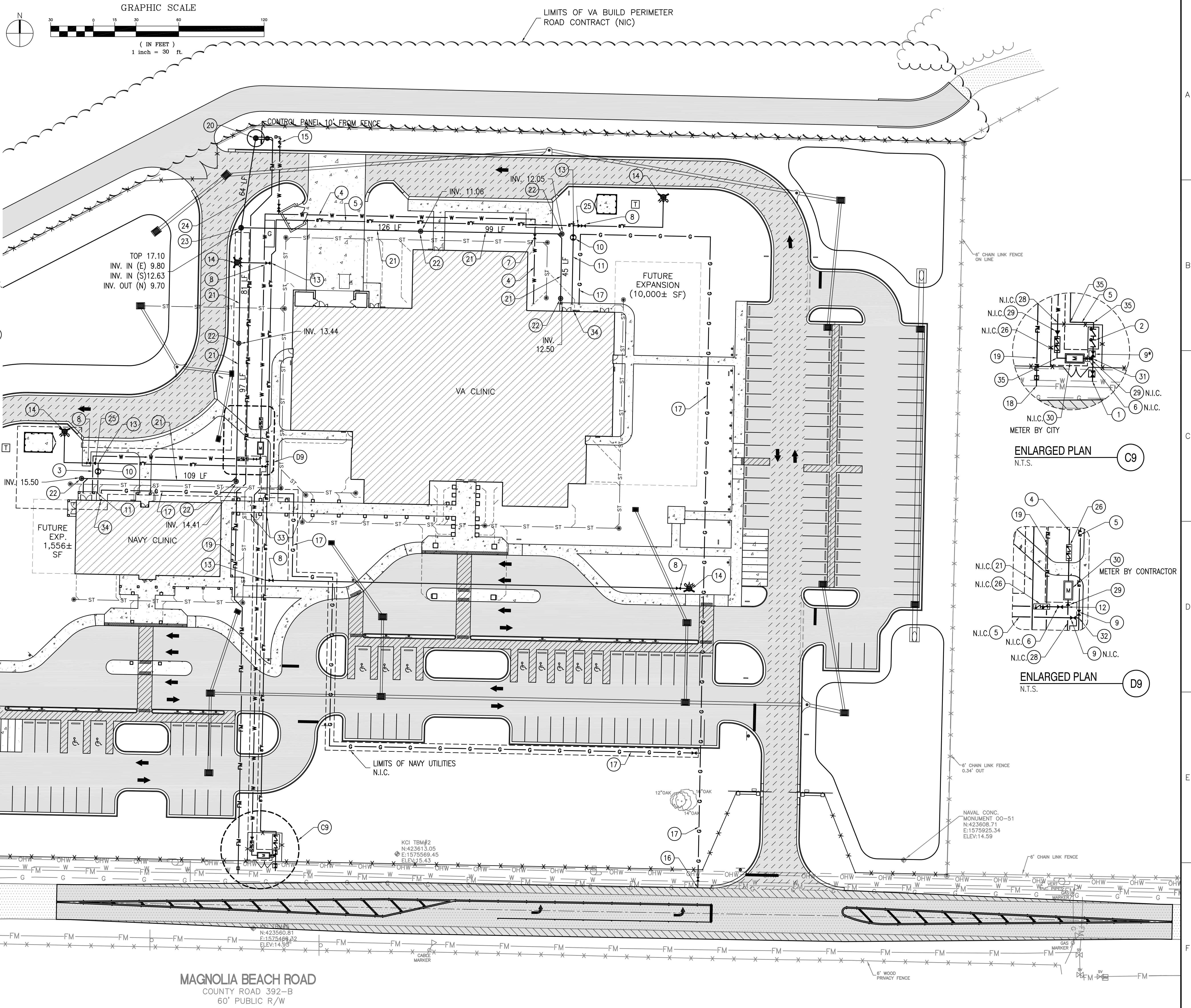
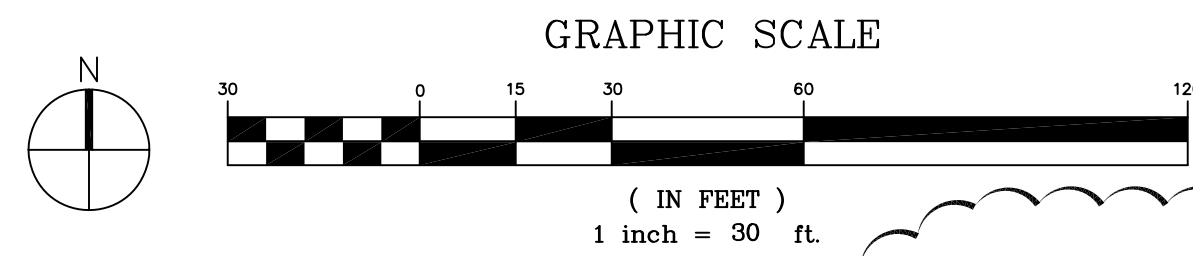

ENLARGED PLAN C9
N.T.S.

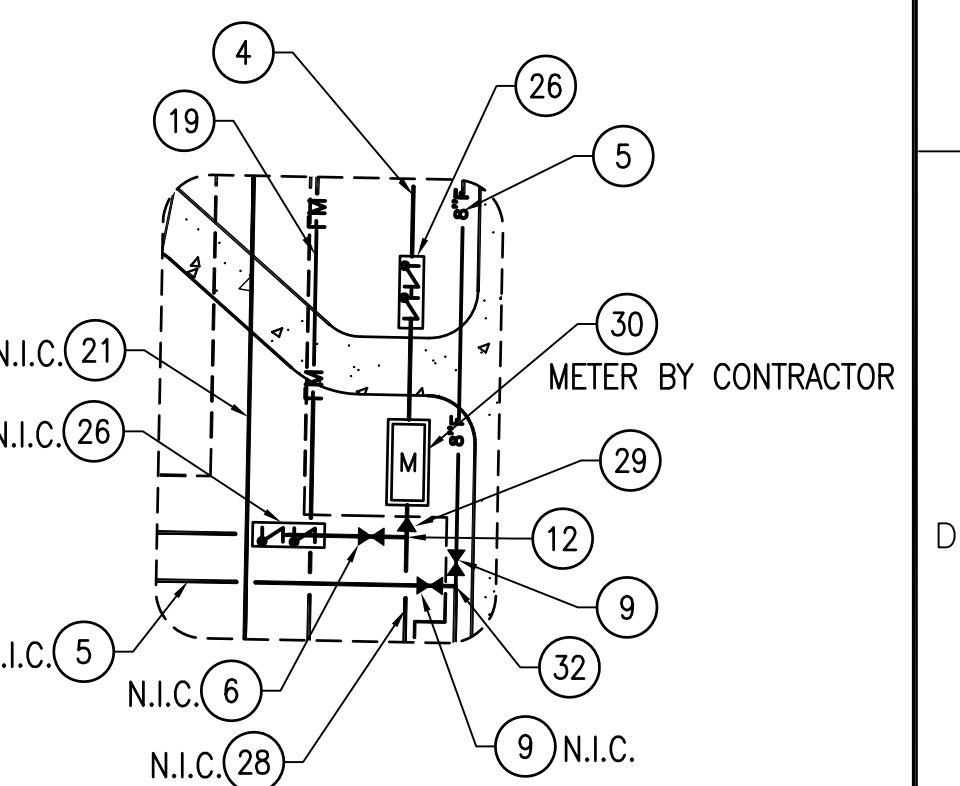

ENLARGED PLAN D9
N.T.S.

MAGNOLIA BEACH ROAD
COUNTY ROAD 392-B
60' PUBLIC R/W

CONSULTANTS:

CIVIL:
KENNETH HORNE & ASSOCIATES
7201 NORTH 9TH AVENUE, STE. 6
PENSACOLA, FLORIDA 32504
PH: (850) 471-9005
FX: (850) 471-0093

COMM/DES:
SCHMIDT CONSULTING GROUP, INC.
40 S. PALAFOX PLACE, STE. 300
PENSACOLA, FLORIDA 32502
PH: (850) 438-0050
FX: (850) 432-8631

SURVEYORS:
KCI TECHNOLOGIES, INC.
10401 HIGHLAND MANOR DRIVE, SUITE 120
TAMPA, FLORIDA 33610
PH: (813) 740-2300

LANDSCAPE ARCHITECT:
CSA GROUP, INC.
6300 PICCADILLY SQUARE DRIVE
MOBILE, ALABAMA 36609
PH: (251) 344-4023
FX: (251) 344-4052

ARCHITECT/ENGINEERS:



BES DESIGN/BUILD, LLC
766 Middle St, Fairhope, AL 36532
Phone: 251.990.5778 Fax: 251.990.3716

Drawing Title

UTILITY PLAN

Approved Project Director

Project Title

PANAMA CITY
JOINT OUTPATIENT CLINIC
VA GULF COAST HEALTH CARE

Location

PANAMA CITY, FLORIDA

Date

SEPTEMBER 5, 2012

Checked

KCH

Drawn

LPR

Project Number

520-326

Building Number

-

Drawing Number

CU101

Dwg 12 of 21

Office of
Construction
and Facilities
Management

