

three eighths inch = one foot
one eighth inch = one foot
one quarter inch = one foot
one half inch = one foot
one inch = one foot
one and one half inches = one foot
two inches = one foot
three inches = one foot
four inches = one foot
five inches = one foot
six inches = one foot
seven inches = one foot
eight inches = one foot
nine inches = one foot
ten inches = one foot
eleven inches = one foot
twelve inches = one foot
thirteen inches = one foot
fourteen inches = one foot
fifteen inches = one foot
sixteen inches = one foot
seventeen inches = one foot
eighteen inches = one foot
nineteen inches = one foot
twenty inches = one foot
twenty one inches = one foot
twenty two inches = one foot
twenty three inches = one foot
twenty four inches = one foot
twenty five inches = one foot
twenty six inches = one foot
twenty seven inches = one foot
twenty eight inches = one foot
twenty nine inches = one foot
thirty inches = one foot
thirty one inches = one foot
thirty two inches = one foot
thirty three inches = one foot
thirty four inches = one foot
thirty five inches = one foot
thirty six inches = one foot
thirty seven inches = one foot
thirty eight inches = one foot
thirty nine inches = one foot
forty inches = one foot
forty one inches = one foot
forty two inches = one foot
forty three inches = one foot
forty four inches = one foot
forty five inches = one foot
forty six inches = one foot
forty seven inches = one foot
forty eight inches = one foot
forty nine inches = one foot
fifty inches = one foot
fifty one inches = one foot
fifty two inches = one foot
fifty three inches = one foot
fifty four inches = one foot
fifty five inches = one foot
fifty six inches = one foot
fifty seven inches = one foot
fifty eight inches = one foot
fifty nine inches = one foot
sixty inches = one foot
sixty one inches = one foot
sixty two inches = one foot
sixty three inches = one foot
sixty four inches = one foot
sixty five inches = one foot
sixty six inches = one foot
sixty seven inches = one foot
sixty eight inches = one foot
sixty nine inches = one foot
seventy inches = one foot
seventy one inches = one foot
seventy two inches = one foot
seventy three inches = one foot
seventy four inches = one foot
seventy five inches = one foot
seventy six inches = one foot
seventy seven inches = one foot
seventy eight inches = one foot
seventy nine inches = one foot
eighty inches = one foot
eighty one inches = one foot
eighty two inches = one foot
eighty three inches = one foot
eighty four inches = one foot
eighty five inches = one foot
eighty six inches = one foot
eighty seven inches = one foot
eighty eight inches = one foot
eighty nine inches = one foot
ninety inches = one foot
ninety one inches = one foot
ninety two inches = one foot
ninety three inches = one foot
ninety four inches = one foot
ninety five inches = one foot
ninety six inches = one foot
ninety seven inches = one foot
ninety eight inches = one foot
ninety nine inches = one foot
one hundred inches = one foot

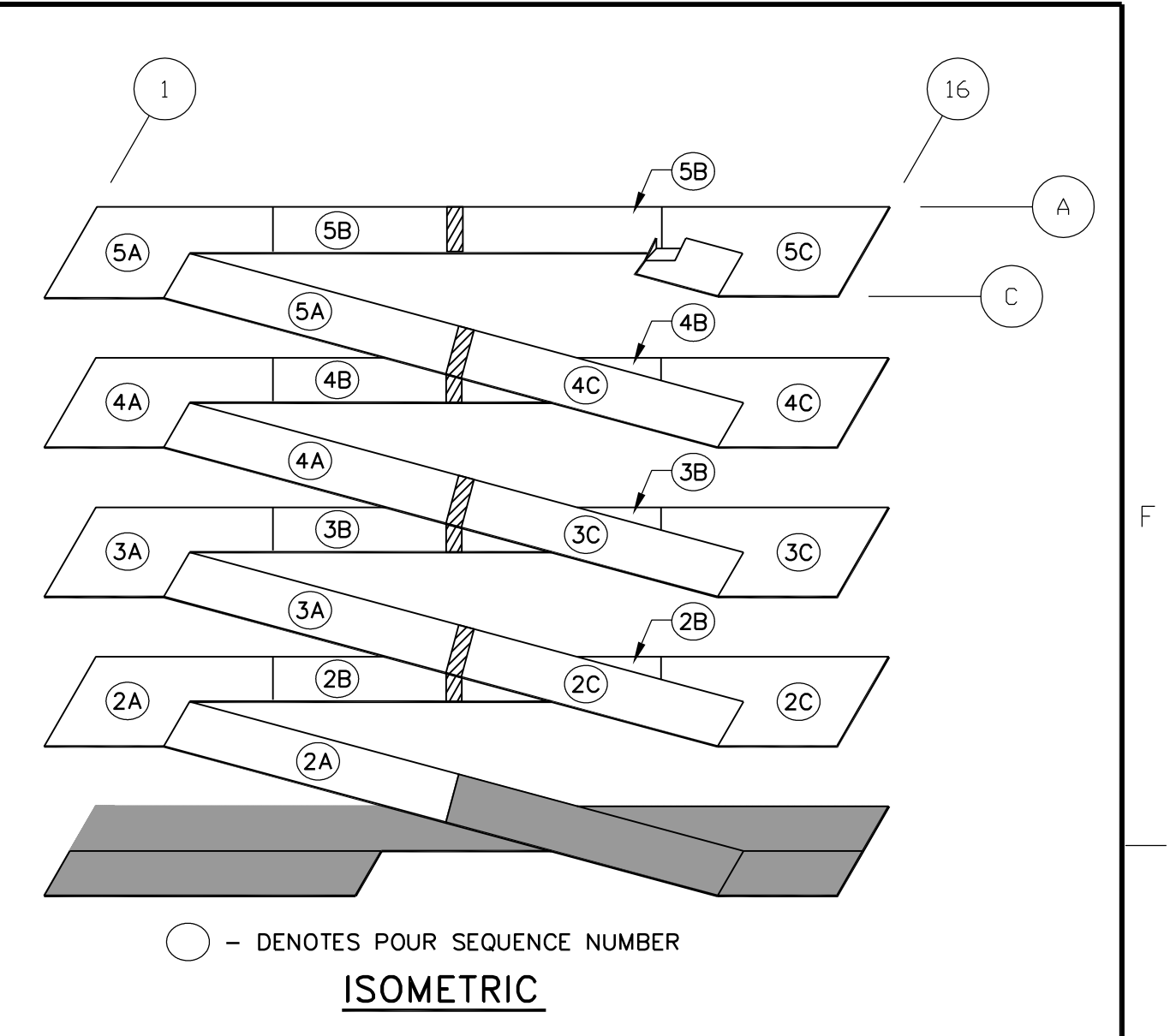
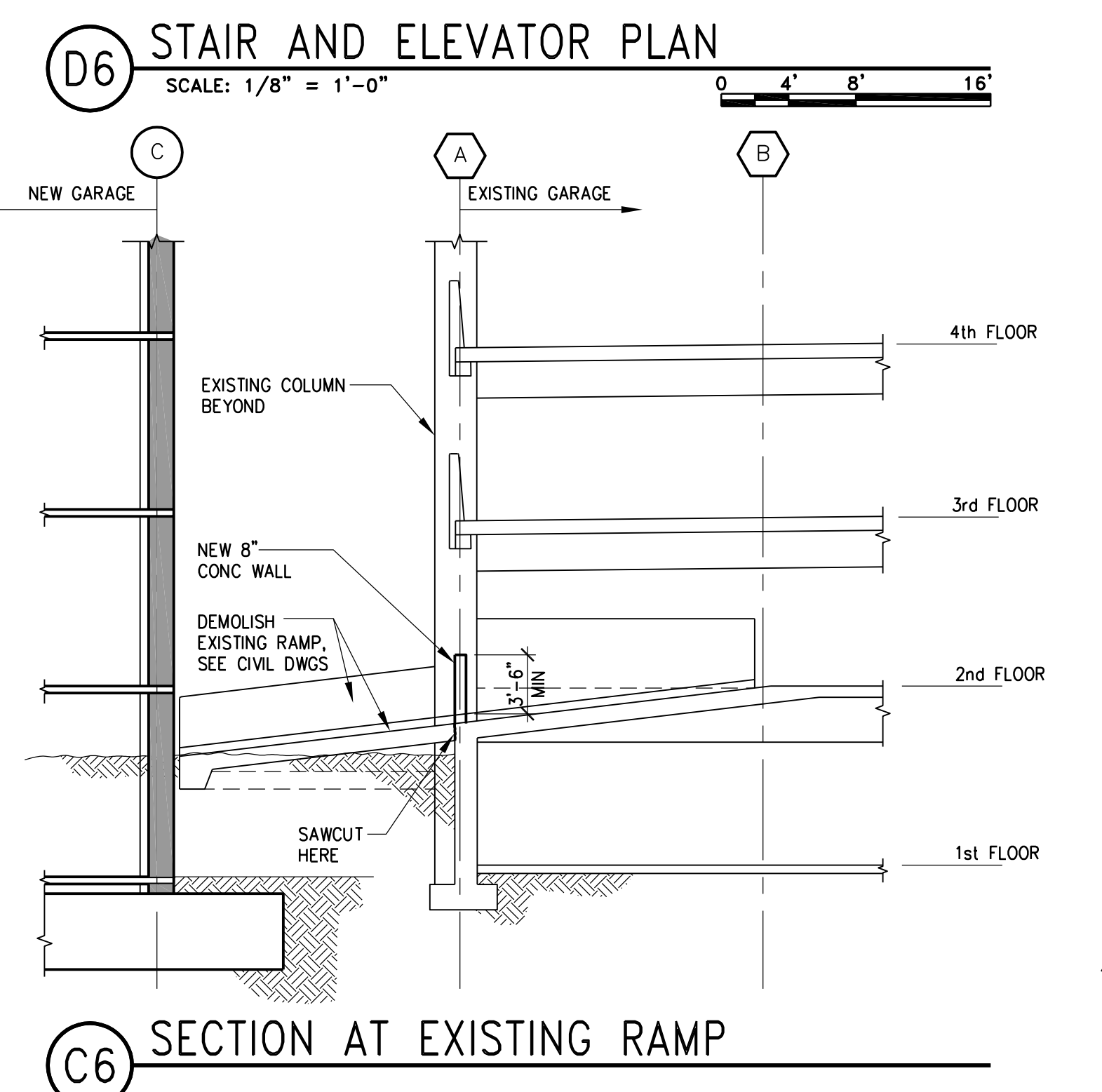
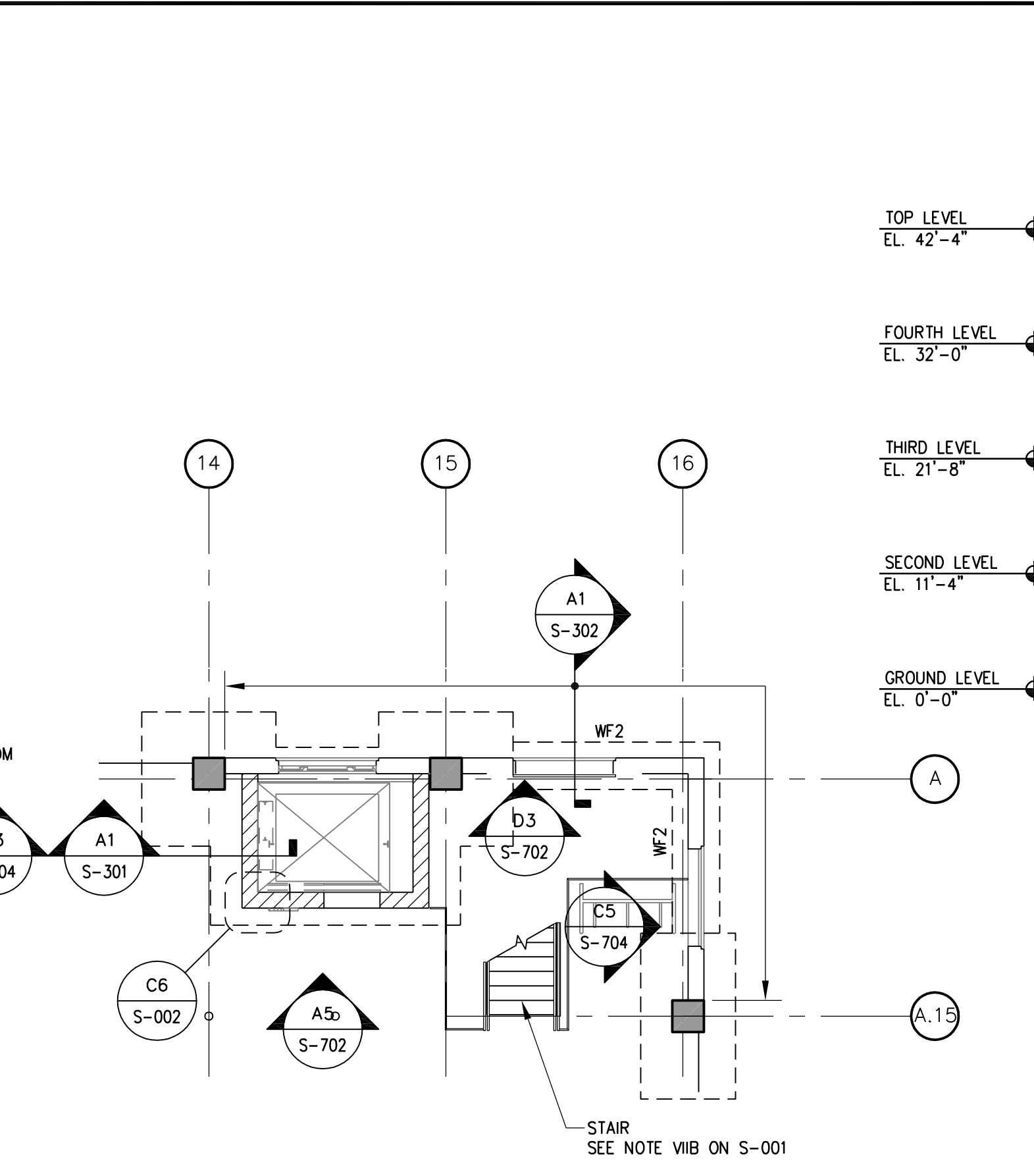
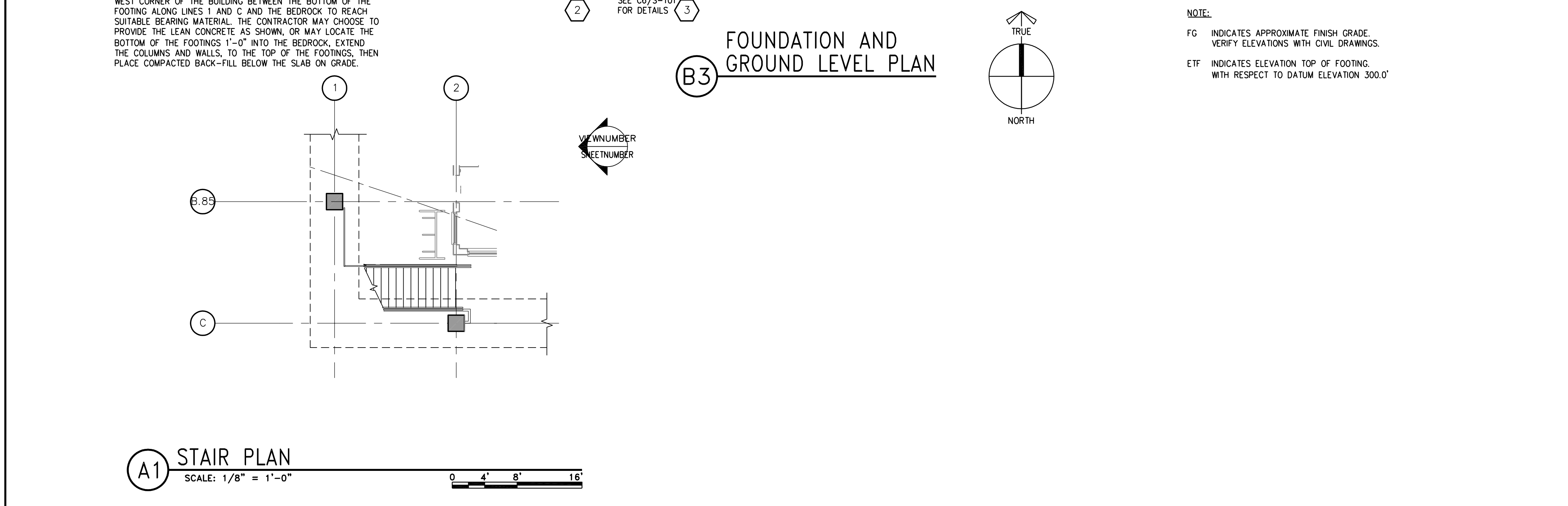
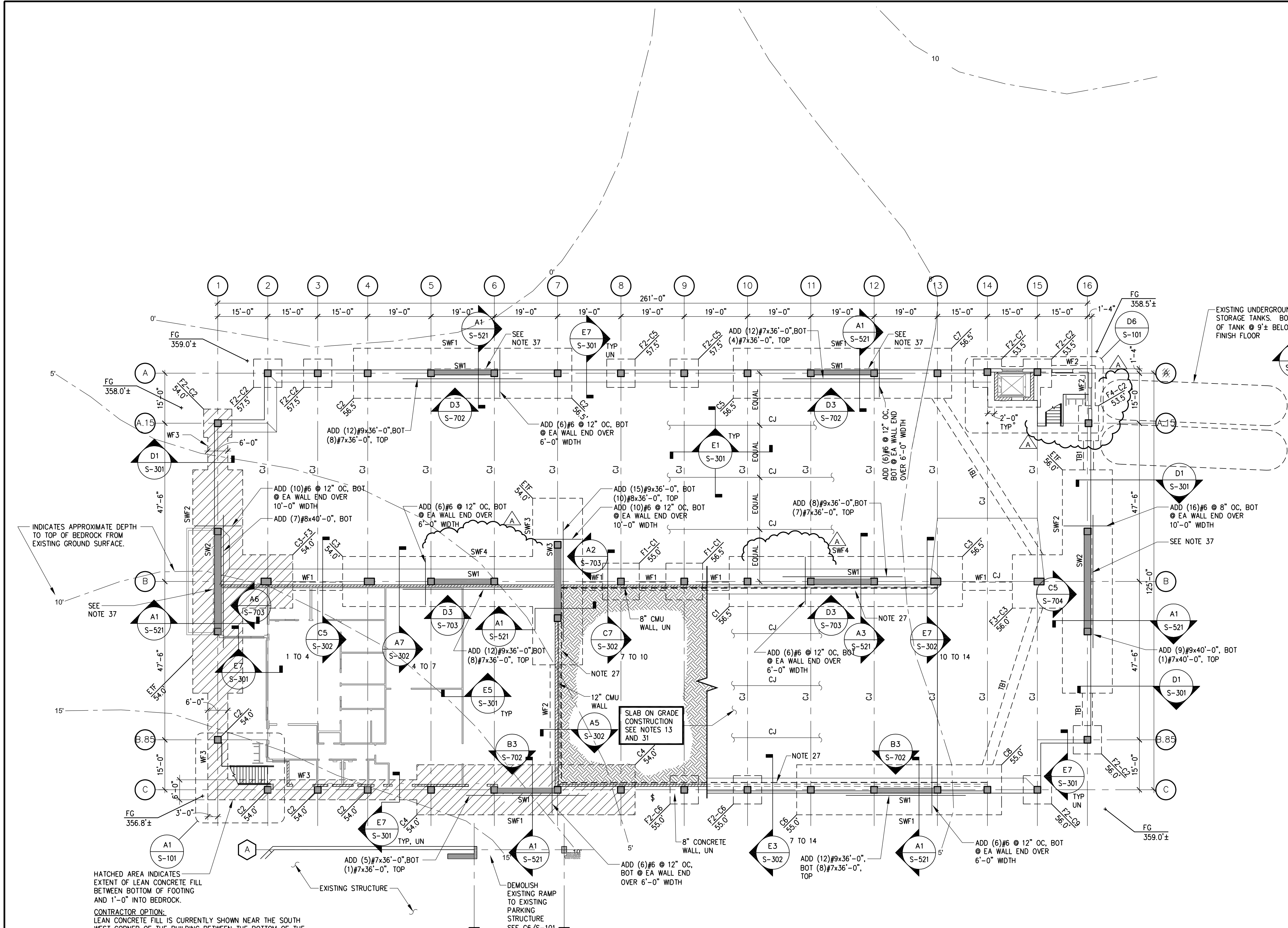

- ISOMETRIC**
- - DENOTES POUR SEQUENCE NUMBER
- SHEET NOTES:**
- SEE SHEET S-301 FOR GENERAL NOTES.
 - VERIFY ALL DIMENSIONS WITH ARCHITECTURAL DRAWINGS.
 - ALL COLUMNS, AND FOOTINGS ARE CENTERED ON GRID LINES, UNLESS NOTED.
 - FOR FLOOR ELEVATIONS BETWEEN POINTS SHOWN, USE STRAIGHT LINE INTERPOLATION. SEE A1/S-103.
 - TYPICAL ELEVATOR PIT DETAIL, SEE A1/S-301.
 - F INDICATES FOOTING MARK, SEE SCHEDULE ON SHEET S-303.
 - WF INDICATES WALL FOOTING MARK, SEE SCHEDULE ON SHEET S-303.
 - IB INDICATES TIE BEAM MARK, SEE SCHEDULE ON SHEET S-303.
 - SWF INDICATES SHEAR WALL FOOTING, SEE SCHEDULE ON S-303.
 - S INDICATES STEPPED FOOTING CONTINUOUS FOOTING, SEE DETAIL C5/S-301.
 - C INDICATES COLUMN MARK, SEE SCHEDULE ON SHEET S-610.
 - 12 SW INDICATES SHEAR WALL, SEE ELEVATIONS ON S-702, S-703 AND S-704.
 - SLAB-ON-GRADE CONSTRUCTION.
 - PARKING AREA AND DRIVE ASILES
 - SLAB SHALL BE 5" THICK CONCRETE, REINFORCED WITH #3 AT 18" ON CENTER EACH DIRECTION, PLACED IN THE MIDDLE OF THE SLAB, OVER 6" OF DRAIN ROCK SUCH AS STANDARD AGGREGATE NO. 67, ASTM-D448, OVER 12" SELECT FILL. UNHABITED SPACES, ELECTRICAL, MECHANICAL, STORAGE ROOMS, ETC.
 - SLAB SHALL BE 5" THICK CONCRETE, REINFORCED WITH #4 AT 16" ON CENTER EACH DIRECTION, PLACED IN THE MIDDLE OF THE SLAB, OVER 2" SAND ON 10 MIL VISQUEEN, OVER 6" DRAIN ROCK SUCH AS STANDARD AGGREGATE NO. 67, ASTM-D448, OVER 12" SELECT FILL.
 14. TYPICAL FOOTINGS AND WALL REINFORCEMENT LAP SPLICES, SEE DETAIL A6/S-002.
 15. REINFORCEMENT, WELDED SPLICE, SEE DETAIL E3/S-002.
 16. TYPICAL WALL REINFORCEMENT AROUND OPENINGS, SEE DETAIL A4/S-002.
 17. PIPES AT CONCRETE FOOTINGS, SEE DETAIL C3/S-002 AND C1/S-301.
 18. REINFORCEMENT BAR BENDING, SEE DETAIL C1/S-002.
 19. SLAB CONTROL AND CONSTRUCTION JOINTS, SEE DETAIL E1/S-301.
 20. CONCRETE CURBS, SEE DETAIL E3/S-301.
 21. THICKENED SLAB, SEE DETAIL E3/S-301.
 22. WALL VERTICAL CONSTRUCTION JOINTS, SEE DETAIL A5/S-301.
 23. CONCRETE STAIR ON GRADE, SEE DETAIL D5/S-301.
 24. MASONRY WALL CONTROL JOINTS, SEE DETAIL B1/S-301, EXPANSION JOINTS, SEE DETAILS B3/S-301 AND B5/S-301.
 25. CONSTRUCTION JOINT AT CONTINUOUS FOOTING, SEE DETAIL C3/S-301.
 26. UNLESS OTHER ARRANGEMENTS ARE MADE, THE GEOTECHNICAL ENGINEER THAT PROVIDED THE GEOTECHNICAL REPORT SHALL BE RETAINED BY THE OWNER TO PROVIDE OBSERVATION AND SOIL TESTING SERVICES DURING THE GRADING AND FOUNDATION PHASES OF THE WORK. COPIES OF THE INSPECTION AND TESTING REPORTS, AND A LETTER FROM THE GEOTECHNICAL ENGINEER STATING THAT ALL GRADING AND FOUNDATIONS WORK HAS BEEN COMPLETED ACCORDING TO THE RECOMMENDATIONS IN THE GEOTECHNICAL REPORT, SHALL BE PROVIDED TO THE BUILDING DEPARTMENT, OWNER, AND WALKER PARKING CONSULTANTS (WPC).
 27. PROVIDE A 4" DIAMETER PERFORATED PIPE AT THE BASE OF THE RAMP WALL. SEE DETAILS ON S-302. MECHANICAL CONTRACTOR SHALL CONNECT THE DRAIN PIPE TO STORM WATER DRAIN SYSTEM.
 28. TRENCH DRAIN DETAIL, SEE D3/S-301.
 29. SLOPING RAMP DETAIL, SEE D7/S-301.
 30. NOT USED.
 31. ALTHOUGH A DATUM ELEVATION MAY BE SHOWN FOR THE GROUND LEVEL, THE FLOOR IS NOT FLAT. REFER TO THE ARCHITECTURAL DRAWINGS FOR THE ACTUAL FLOOR ELEVATIONS ON ALL LEVELS. ALL FLOORS WITHIN THE GARAGE SHALL HAVE A MINIMUM SLOPE TO THE FLOOR DRAINS, EQUAL TO TWO PERCENT (2%), UNLESS NOTED OTHERWISE.
 32. CMU WALL REINFORCING PLACEMENT, SEE DETAIL C7/S-301.
 33. SLAB-ON-GRADE EDGE DETAILS, SEE A3, D1 & E7/S-301.
 34. NOT USED.
 35. NOT USED.
 36. NOT USED.
 37. 4" OF CONCRETE TO BE ADDED FOR ARCHITECTURAL FINISHES TO THE EXTERIOR STRUCTURAL THICKNESS OF SHEAR WALLS ALONG LINES 1, 16 AND A.

CONSULTANTS:		ARCHITECT/ENGINEERS:		Drawing Title		Project Title		Project Number		Office of Construction and Facilities Management Department of Veterans Affairs	
		WALKER PARKING CONSULTANTS		FOUNDATION AND GROUND LEVEL PLAN		PARKING AND EMERGENCY RESPONSE STRUCTURE		662-611			
		135 Main Street Suite 1030 San Francisco, CA 94105 415.644.0630 Ph 415.644.0637 Fax						Building Number 211			
ADDENDUM A ISSUED FOR BIDS Revisions						Approved Project Director Medical Center Director: Chief Engineer:		Location SFVA MEDICAL CENTER		Drawing Number S-101	
09/17/12 09/22/11 Date						LAWRENCE H. CARROLL DICK MINEMIA		Date APRIL 2011		Sht. 68 of 120	