

Area has been abated

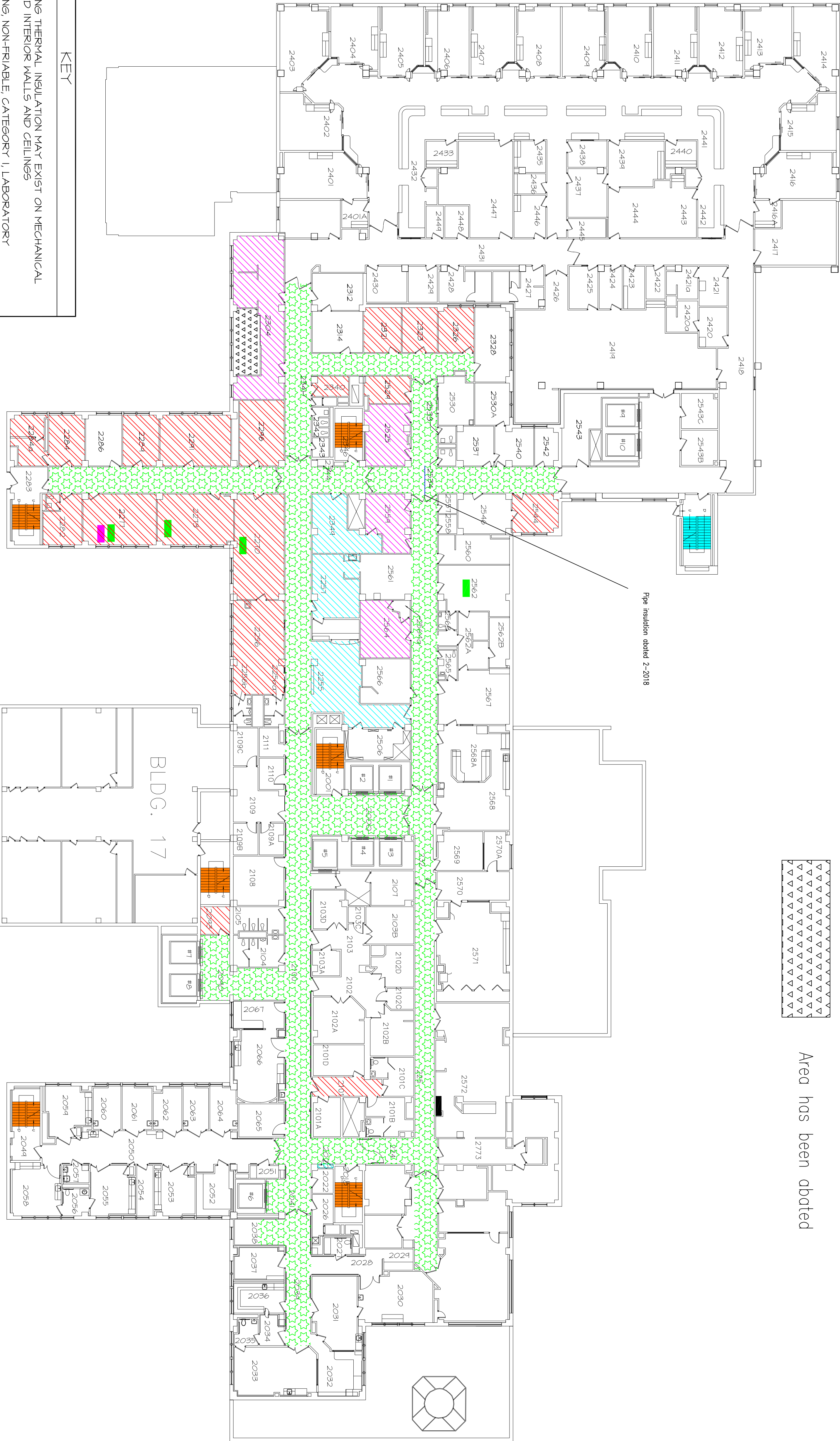

KEY

- ASBESTOS CONTAINING THERMAL INSULATION MAY EXIST ON MECHANICAL LINES INSIDE FINISHED INTERIOR WALLS AND CEILINGS
- ASBESTOS CONTAINING, NON-FRIABLE, CATEGORY 1, LABORATORY HOOD/TABLE TOP (TRANSITE-LIKE)
- ASBESTOS CONTAINING, NON-FRIABLE, CATEGORY 1, MASTIC ON SINK, BLACK
- ASBESTOS CONTAINING, NON-FRIABLE, CATEGORY 1, 12" x 12" VFT & MASTIC, WHITE W/BROWN SPOTTED
- ASBESTOS CONTAINING, NON-FRIABLE, CATEGORY 1, 12" x 12" VFT & MASTIC, BROWN W/DARK BROWN
- ASBESTOS CONTAINING, NON-FRIABLE, CATEGORY 1, 12" x 12" VFT, WHITE W/TELLON SPOTTED (MASTIC ONLY)
- ASBESTOS CONTAINING, NON-FRIABLE, CATEGORY 1, 9" x 9" VFT & MASTIC TAN WITH BLACK MASTIC
- ASBESTOS CONTAINING, NON-FRIABLE, CATEGORY 1, RESIDUAL BLACK HALLWAY FLOORING MASTIC

BUILDING NO. 1
SECOND FLOOR

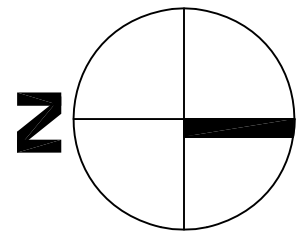

| DRAWING TITLE | | | | DRAWING TITLE | |
|---|----------|------------|----------|---------------|-------|
| VA Medical Center 4101 Woolworth Avenue Omaha, NE 68105 | | | | | |
| JOB NUMBER | DRAWN BY | DATE | CAD FILE | SCALE | SHEET |
| 10284.0002 | MWR | 12-21-2013 | Blr2.dwg | NONE | |