

| SYMBOL SCHEDULE | |
|-----------------|------------------------------------|
| SYMBOL | DESCRIPTION |
| ○ | CAN LIGHT FIXTURE |
| □ | RECESSED FLUORESCENT LIGHT FIXTURE |
| ● | CEILING MOUNTED EXIT FIXTURE |
| □ | SUPPLY DIFFUSER |
| □ | RETURN GRILLE |
| □ | CUBICLE CURTAIN TRACK |
| □ | SLOT AIR SUPPLY GRILLE |
| □ | LINE OF CHANGE IN CEILING HEIGHT |
| □ | SMOKE DETECTOR |
| □ | LAY IN HEATING PANEL |

REFLECTED CEILING PLAN - WING A

NOTES:

1. Refer to Section 55 of the Specifications for material, ceiling type, and finish.
2. Slot air supply grilles to be laid out in the room and side of room as indicated.

CORE FLOOR PLAN
REFER TO FLOOR PLAN ARCH
SHEET 2 FOR CONTINUATION

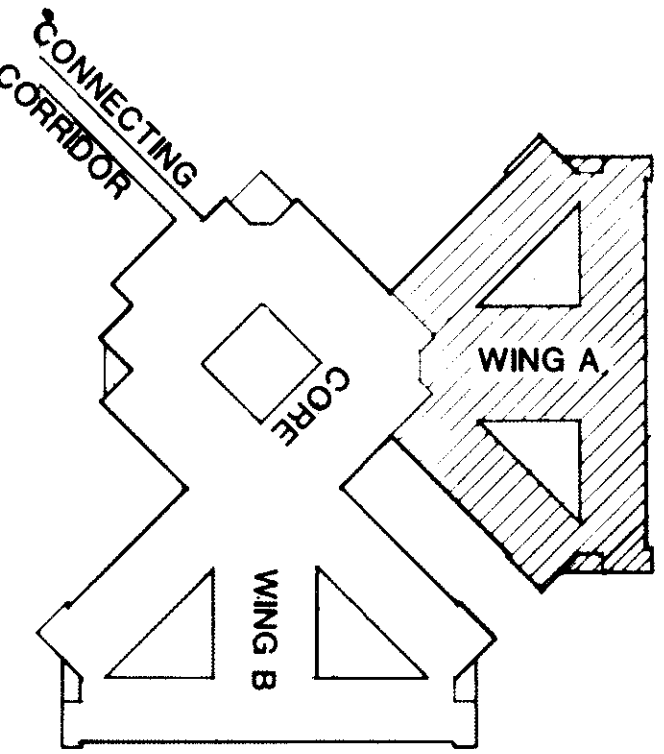

KEY PLAN
1"=100'-0"

DAHL, BRADEN, CHAPMAN, INC.
Architecture / Planning / Interior Design
EDWARD L. WILSON, JR.
Consulting Engineers
YANDELL & HILLER, INC.
Consulting Engineers

Drawing Title
**1/8" REFLECTED CEILING
PLAN - WING A**

Project Title
**120 BED NURSING
HOME CARE UNIT**

Approved Project Director
60

Location
VAMC DALLAS, TX.

Date
28 OCT 81

Project No
549-026

Drawing No
60.19

Amendment
60.19

Veterans
Administration

