

## AURORA FOUR SERIES SURGICAL LIGHTS

Skytron's Aurora Four surgical lighting system provides complete surgeon control of positioning, focus, and intensity from the sterilizable center handle. Energy efficient LEDs provide cool, color corrected light that is diffused evenly over the surgical site for optimum shadow reduction.

### Accessories / Options

**Wall Control** provides controls for main power, intensity control from 0 to 100% in 5 steps for each lighthead, color temperature selection of 4100°K or 4500°K, safety fuses and LED 40,000 hour change indicator. Required, priced separately.

**Optional AUA5TV Camera Ready Lighthead** accepts a Precision HD camera in place of the sterilizable focus/positioning handle. A sterilizable camera cover allows the surgeon lighthead positioning and focus control.

**Precision HD Camera System** provides dynamic, superb 1080i and 1080p digital quality video. The camera system consists of a Precision HD handle mounted camera, camera control unit (CCU), and video cabling. Camera system priced separately. Camera ready lighthead (AUA5TV) required.

**Sterile Handles** and various adapters are available for sterilizable handles and sterile disposable covers.

### Technical Data

Fixture Weight: 237 lbs (108 kg)  
Moment Load: 864 ft lbs (1172 N·m)

Minimum Ceiling Height: 8' 9-5/16" (2676mm)  
Maximum Ceiling Height: 10' 3-1/4" (3131mm)

Electrical: 100-240VAC, 148-240VA, 50/60 Hz, 1 phase

Max Intensity at 1 meter (lux): @4100K = 320,000  
@4500K = 281,000

Central Illuminance at 1 meter (lux): @4100K = 160,000  
@4500K = 140,500

CRI: @4100K = 95 @4500K = 96

Color Temperature: @4100K @4500K

Total Irradiance (watts/m<sup>2</sup>): @4100K = 532.3  
@4500K = 475.9

R9: @4100K = 91 @4500K = 95



Model AUA55 Shown

### Standards

ANSI/AAMI ES60601-1: 2005 / C1: 2009 / A2: 2010  
CAN/CSA-C22.2 No. 60601.1: 2008 COR 2 2011  
IEC 60601-2-41 (2nd Ed. 2009-08)  
IEC 60601-1-6 (3rd Ed. 2010-01)  
IEC 60601-1-2 (3rd Ed. 2007-03)  
CE

### Architectural Specification

The Aurora Four surgical lighting system consists of a ceiling mounted dual radial arm system with two 24" (610mm) diameter lightheads. Continuous 360° rotation is provided at all fixture rotation points.

Standard lightheads are equipped with a sterilizable center handle that allows surgeon control of lighthead positioning, focus and intensity. A focus knob and positioning handles are provided on the side of the lighthead for non-sterile control.

Each 24" (610mm) lighthead contains 5 focusable LED pods. Each focusable pod contains 7 individual LEDs with VSRD reflector technology. Each lighthead also contains 12 fixed focus center mounted LEDs. Total system output is 320,000 lux at a color temperature of 4,100K. LED life expectancy is 40,000 hours.

SKYTRON Aurora Four series, model AUA55, AUA5TV5 or AUA55TV.

## Product Elevation View

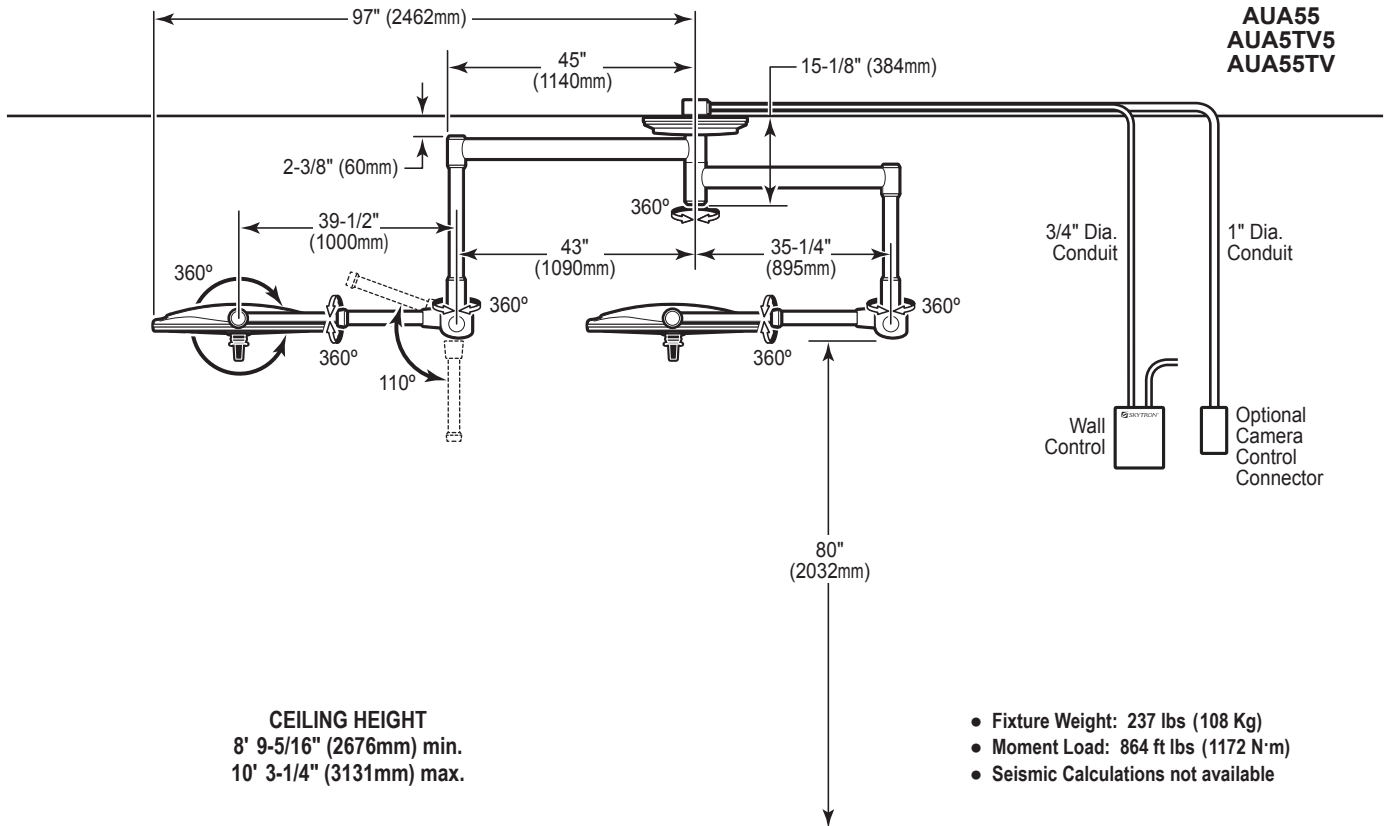

## Mounting

Refer to Installation Instructions for specific mounting structure guidelines, wiring and wall control installation details.

### Wall Control

– Required, Priced Separately –

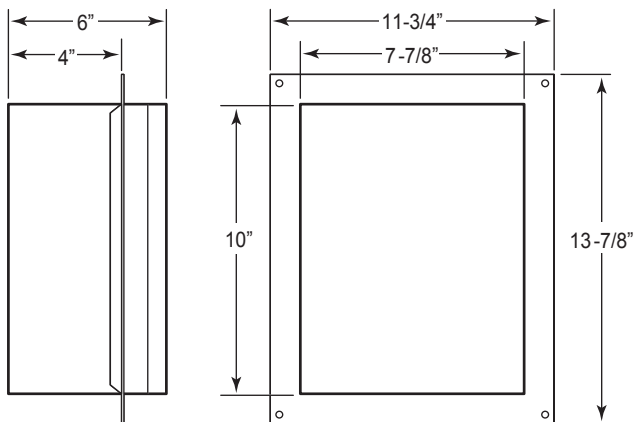

SIDE VIEW

BACK VIEW

(Not to Scale)

### Typical Mounting Structure

– Provided by Others –

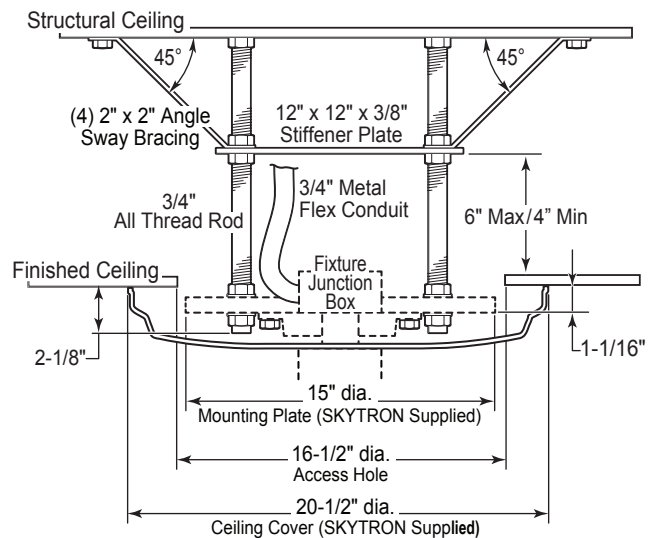

The base language for this document is ENGLISH. Any translations must be made from the base language.



5085 Corporate Exchange Blvd. S.E.  
Grand Rapids, MI 49512 • 616.656.2900

M7415

AUT1W

## SPECTRA AUT1 LED EXAMINATION LIGHT WALL MOUNTED

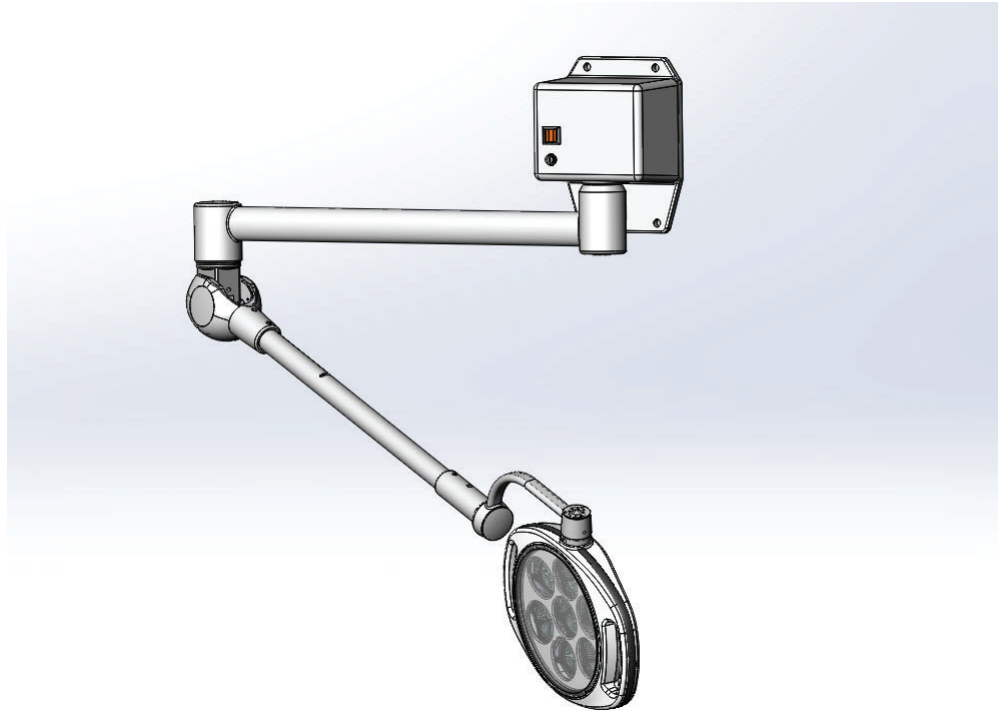

### Introduction

The Spectra AUT1 series LED examination light was developed to bring excellent, color correct light to various departments that require examination lighting. The performance is matched by its low cost of ownership and durability. Applications include emergency departments, labor and delivery, imaging, and general examination.

### Standard Features

- Sealed lighthead provides smooth surface for clean wipedown between cases
- Lighthead mounted intensity control allows one touch adjustment of light intensity level
- Spring balanced articulating arm offers easy positioning and stability
- Cool temperature LEDs keep environment from becoming uncomfortably hot
- Total reach of 73 3/4" (1873mm)
- 360° rotation at lower arm; 355° pitch and 360° roll rotation of lighthead

### Accessories

- Optional sterilizable handle (B4-242-02)

### Architectural Specification

Lighting system should consist of a 12" (305mm) LED exam light. Includes polymer lighthead with 7 high efficiency LEDs (51,200 lux), VSRD optics, and a minimum life of 40,000 hours. Wall mounted with a total reach of 73 3/4" (1873mm). 360° rotation at lower arm; 355° pitch, 360° roll rotation of lighthead. Light should be Skytron Spectra AUT1W.

### Technical Data

**Electrical:** 100-240 VAC, 50/60 Hz, single phase, 0.4 amps, 45 VA

**Intensity:** 51,200 lux at 1 meter

**Light Field Diameter at 1 meter:** 6" (152mm)

**Color Temperature:** 4317K

**CRI:** 96

**LED Life:** 40,000 hours

**Total Reach:** 73 3/4" (1873mm)

**Fixture Weight:** 27.45 lbs (12.45 kg)

**Moment Load:** 88.2 ft-lbs (119.6 Nm)

**Mounting height:** 70" (1778mm)

