

A

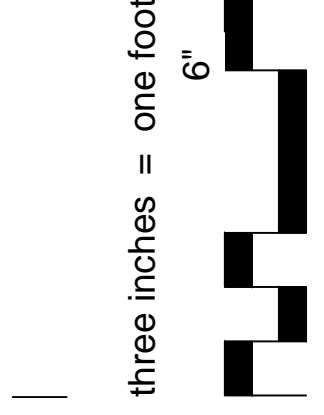

B

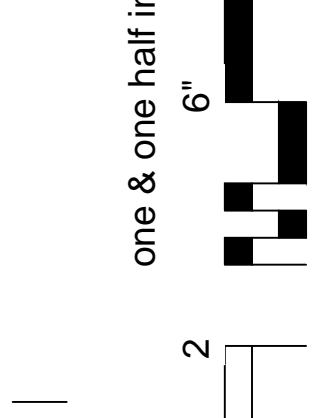

C

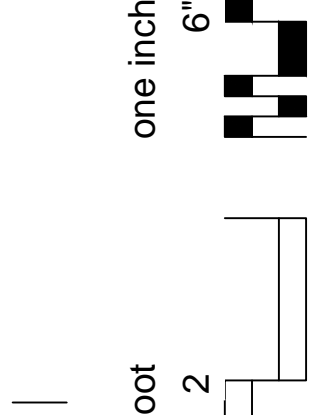

D

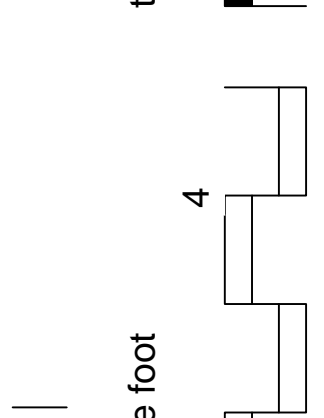

E

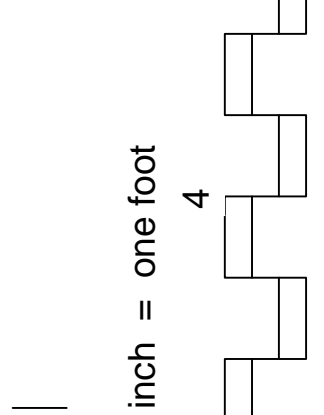

F

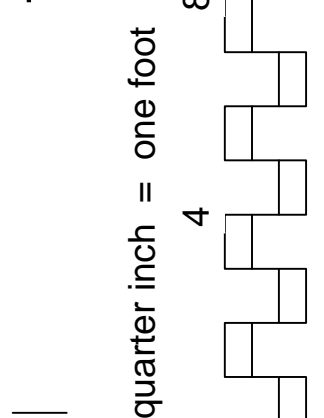

G

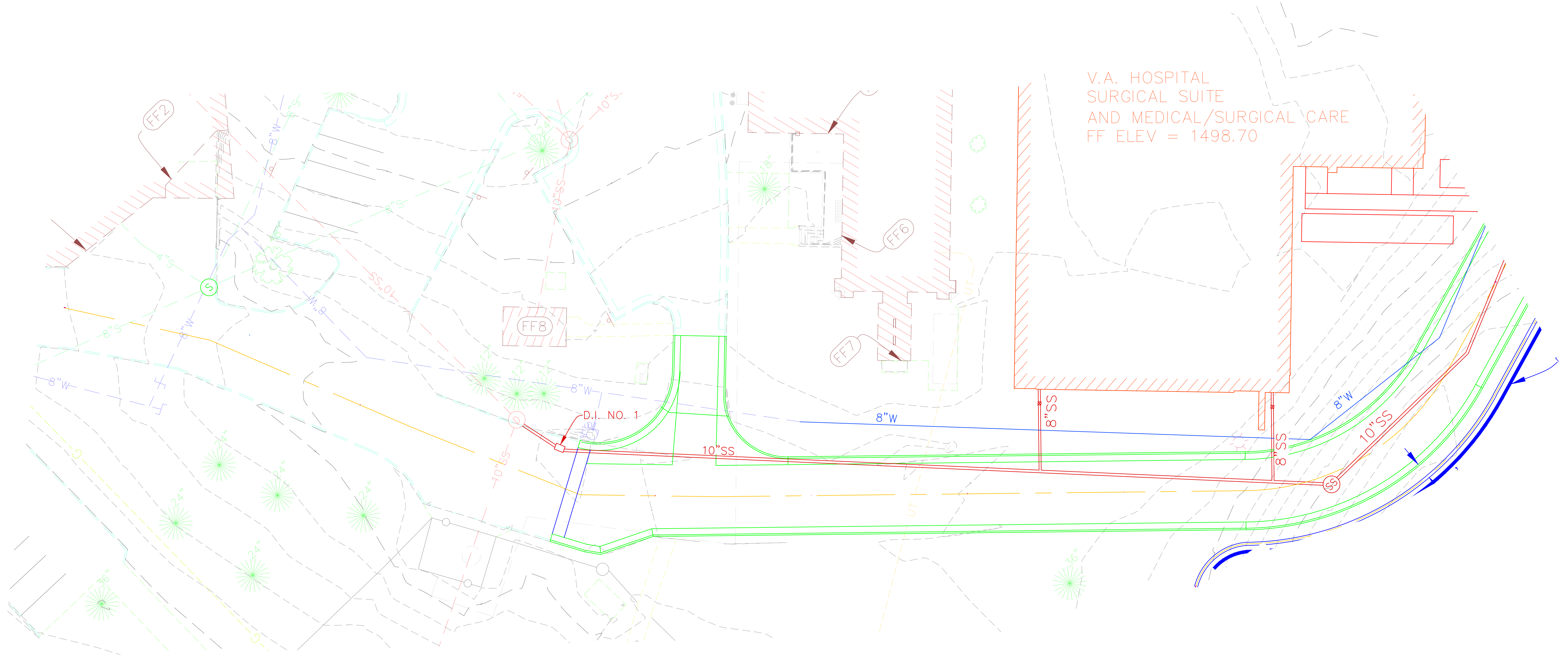
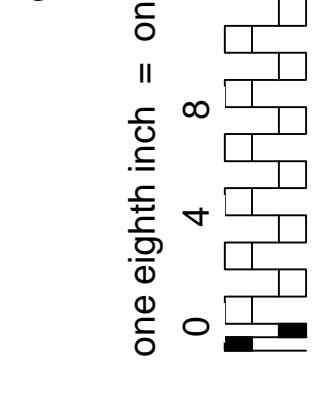

V.A. HOSPITAL  
SURGICAL SUITE  
AND MEDICAL/SURGICAL CARE  
FF ELEV = 1498.70

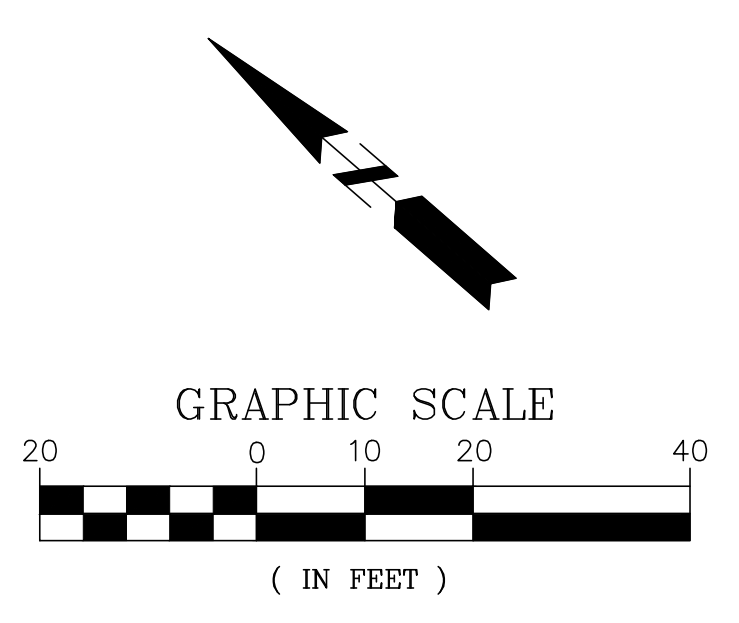

LEGEND

- FIRE HYDRANT
- STREET LIGHT
- LIGHT POLE
- HISTORICAL LIGHT POLE
- POWER POLE
- TRAFFIC SIGNAL
- TELEPHONE BOX
- EXISTING MANHOLE
- SIGN
- STREET SIGN
- GAS METER
- UTILITY CLOSURE
- GUY WIRE
- OVERHEAD POWER
- GAS VALVE
- WATER SHUTOFF
- WATER VALVE
- UNDERGROUND POWER
- UNDERGROUND TELEPHONE
- FIBER OPTIC
- UNDERGROUND TELEVISION
- OVERHEAD TELEVISION
- OXYGEN LINE
- WATER LINE
- GAS LINE
- SANITARY SEWER
- STORM SEWER
- CHAIN LINK FENCE
- BARBED WIRE FENCE
- WOOD FENCE
- EXISTING CURB & GUTTER
- EXISTING DROP INLET
- EXISTING CONTOUR
- BUSHES
- DECIDUOUS TREE
- CONIFEROUS TREE
- CONCRETE SURFACE
- EXISTING BUILDING LINE
- M.W. MONITORING WELL
- POWER BOX
- SANITARY SEWER CLEANOUT
- GAS VALVE

BENCHMARK #1  
TOP OF FIRE HYDRANT @ SE. SIDE OF SITE  
NORTH SIDE OF PRIVATE DRIVE  
ELEV. = 1504.81  
NAVD 88 DATUM

BENCHMARK #2  
TOP OF FIRE HYDRANT @ E. SIDE OF SITE  
WEST SIDE OF PRIVATE DRIVE  
ELEV. = 1498.72  
NAVD 88 DATUM

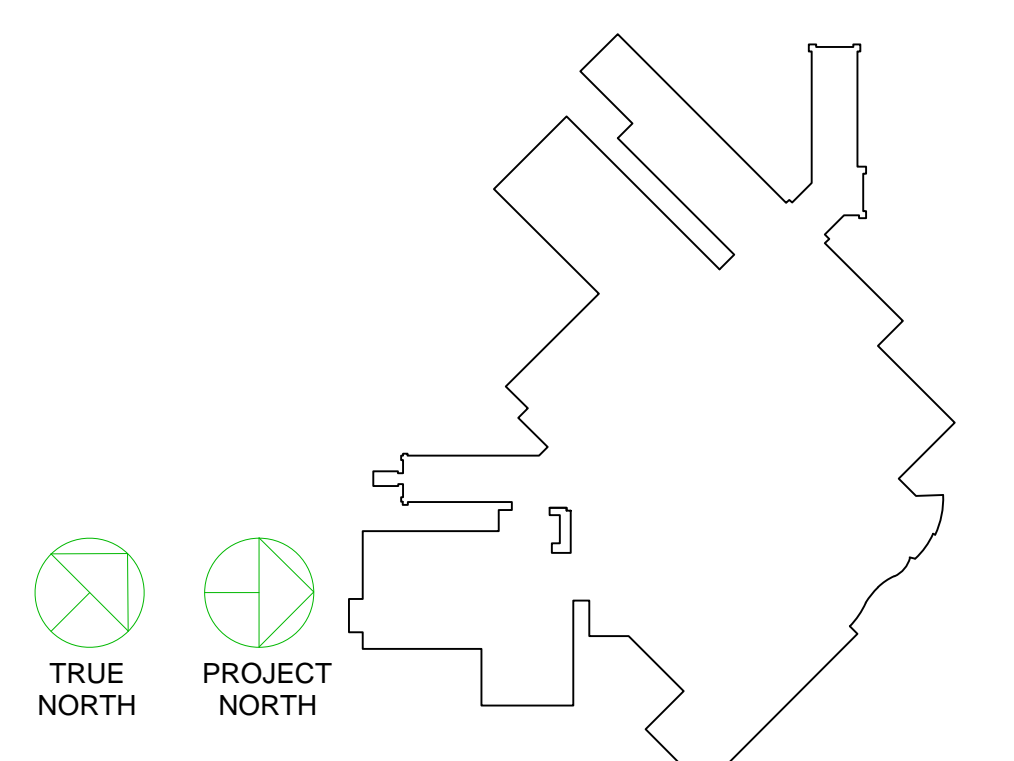
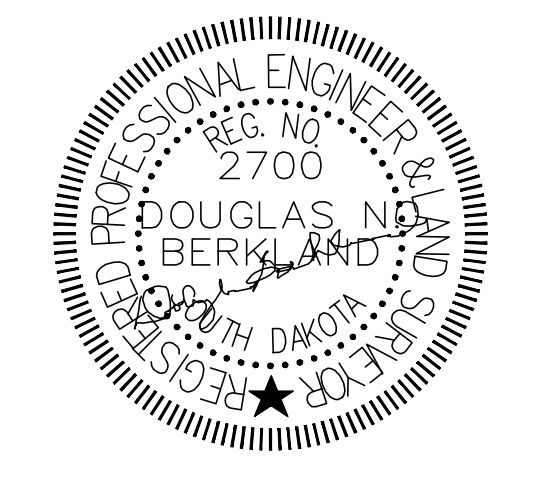
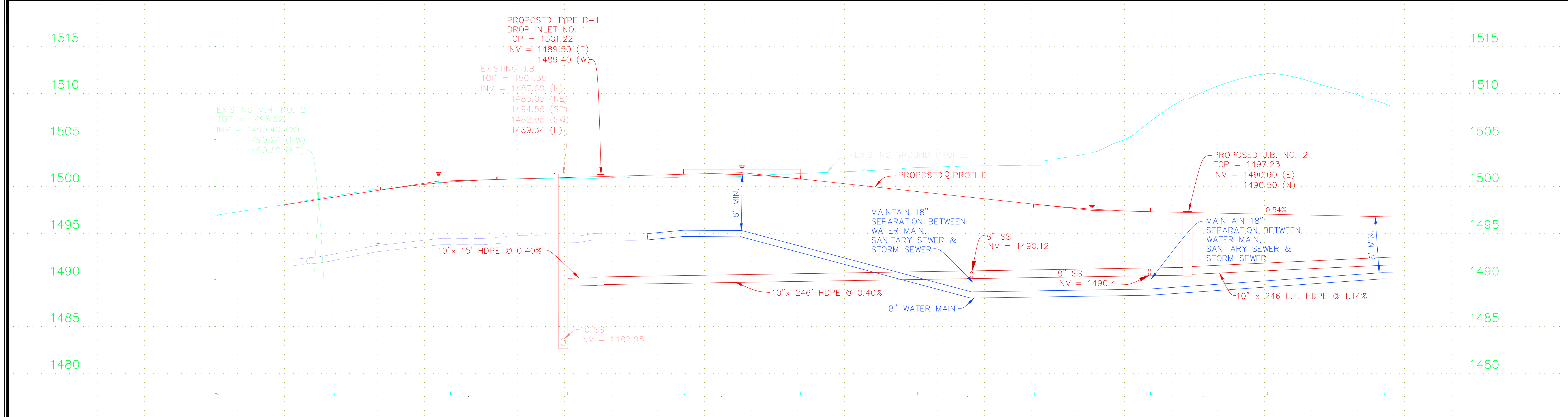

100% FINAL  
FULLY SPRINKLERED

Revision Schedule		CONSULTANTS:		ARCHITECT/ENGINEERS/COST ESTIMATORS:		Drawing Title:		Project Title:		Project Number	
Revision Number	Revision Date	CIVIL/LANDSCAPE/SURVEYOR	FIRE PROTECTION	ELLERBE BECKET		PLAN/PROFILE OF PROPOSED ROAD & UTILITIES		RECONSTRUCT ROAD		438-13-102	
		SAYRE ASSOCIATES	FP&C			Approved: Project Director		Location		Building Number	
		216 South Duluth Ave	1520 Main Street					SIoux FALLS, SD			
		Indianapolis, IN 46224	Indianapolis, IN 46224					Date		Drawing Number	
		t: 605-332-7211	t: 317-468-5188					10/26/12			
		f: 605-332-7222	f: 317-468-5189					Checked		Dwg. 10 of 17	
								DNB			
								Drawn			
								JNH			

