

F.1	REMOVE TERRAZZO WALL BASE COMPLETE. FLASH PATCH AND PREPARE SLAB FOR NEW FINISH IN MANNER REQUIRED BY NEW FINISH MANUFACTURER.
F.2	REMOVE ASBESTOS TILE AND COORD. W/ DRAWING HA-100 FOR ASBESTOS MATERIAL REMOVAL DRAWINGS AND NOTES. PROVIDE FLOWABLE FLOOR FILL (GYPCRETE OR EQUAL) AT ABATED FLOOR AREAS

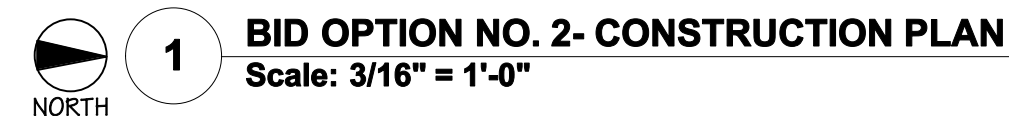
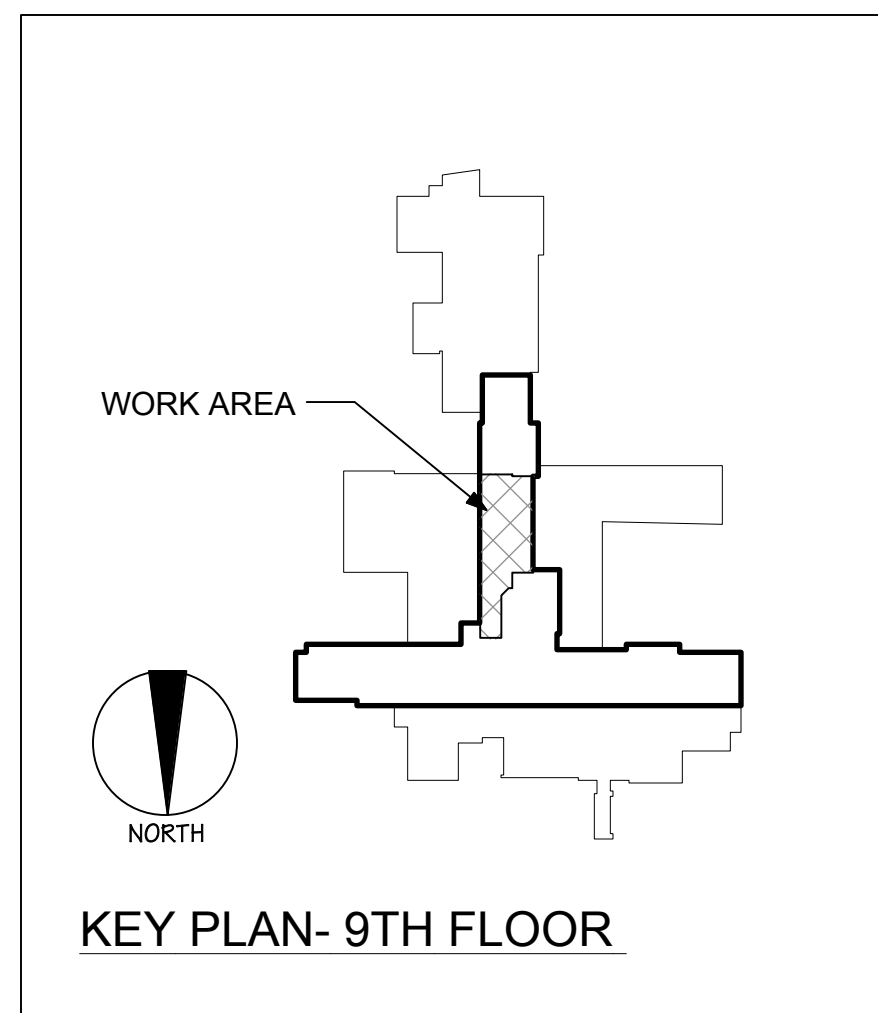

NOTE:
NEW FLOORING TO
BE DETERMINED-
COORDINATE WITH
OWNER

[illegible]