

1/156

NOTES

1. REFER TO SHEET 1-E1 FOR LEGEND, ABBREVIATIONS, AND GENERAL NOTES.
2. COORDINATE INSTALLATION OF NEW POWER FEEDS TO MECHANICAL EQUIPMENT WITH THE MECHANICAL CONTRACTOR.

- ① PROVIDE 2#12#1/2 IN 3/4" C FROM POWER PANEL 'B04', CIRCUIT 36, TO INTEGRAL 24VAC TRANSFORMER (8VA LOAD) AT EACH VAV AND CAV (ONE 20 AMP CIRCUIT FOR ALL VAV AND CAV BOXES WITH THIS KEYNOTE). INSTALL JUNCTION BOX AND FLEXIBLE CONNECTION TO VAV OR CAV AT EACH LOCATION.
- ② PROVIDE 3#12#1/2 IN 3/4" C FROM POWER PANEL 'B01-H', CIRCUIT 22.

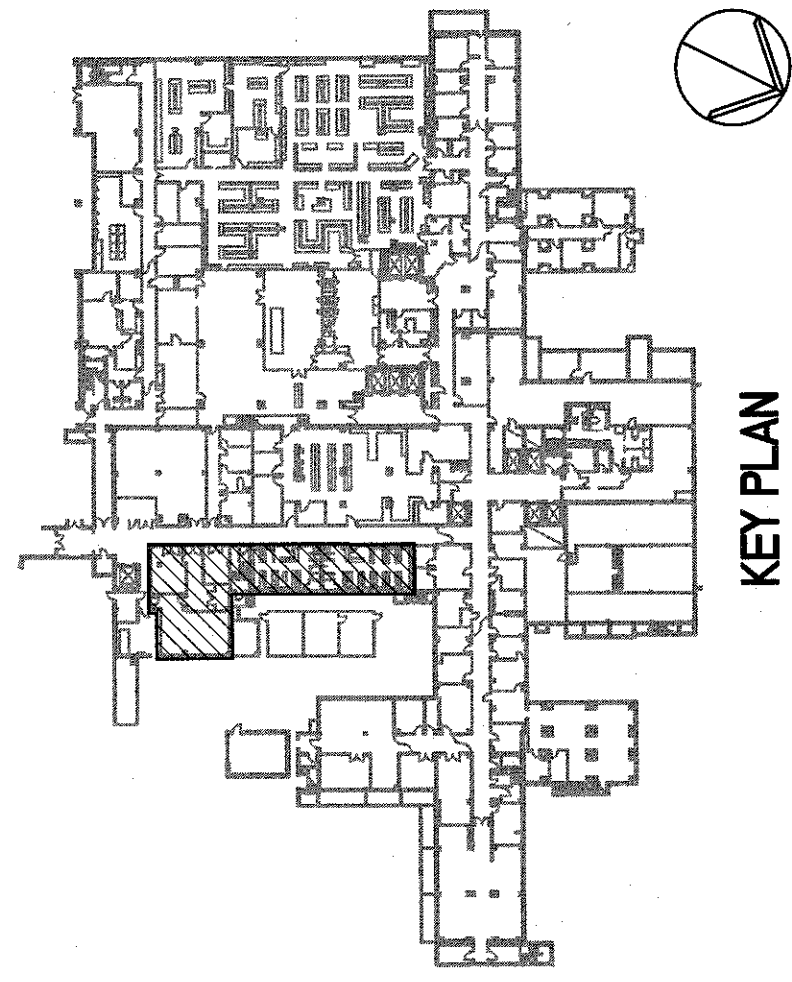

KEY PLAN
NOT TO SCALE
FULLY SPRINKLERED BUILDING
BID DOCUMENTS

ARCHITECT/ENGINEERS:

PARADIGM
ENGINEERS AND CONSTRUCTORS

PO BOX 436223 Louisville, Kentucky 40253 - PH: 502.339.8511 - www.paradigmusa.com

Project Number:
636A8-11-011

IOWA 52246-2208

Drawing Number:

Department of

Department of