

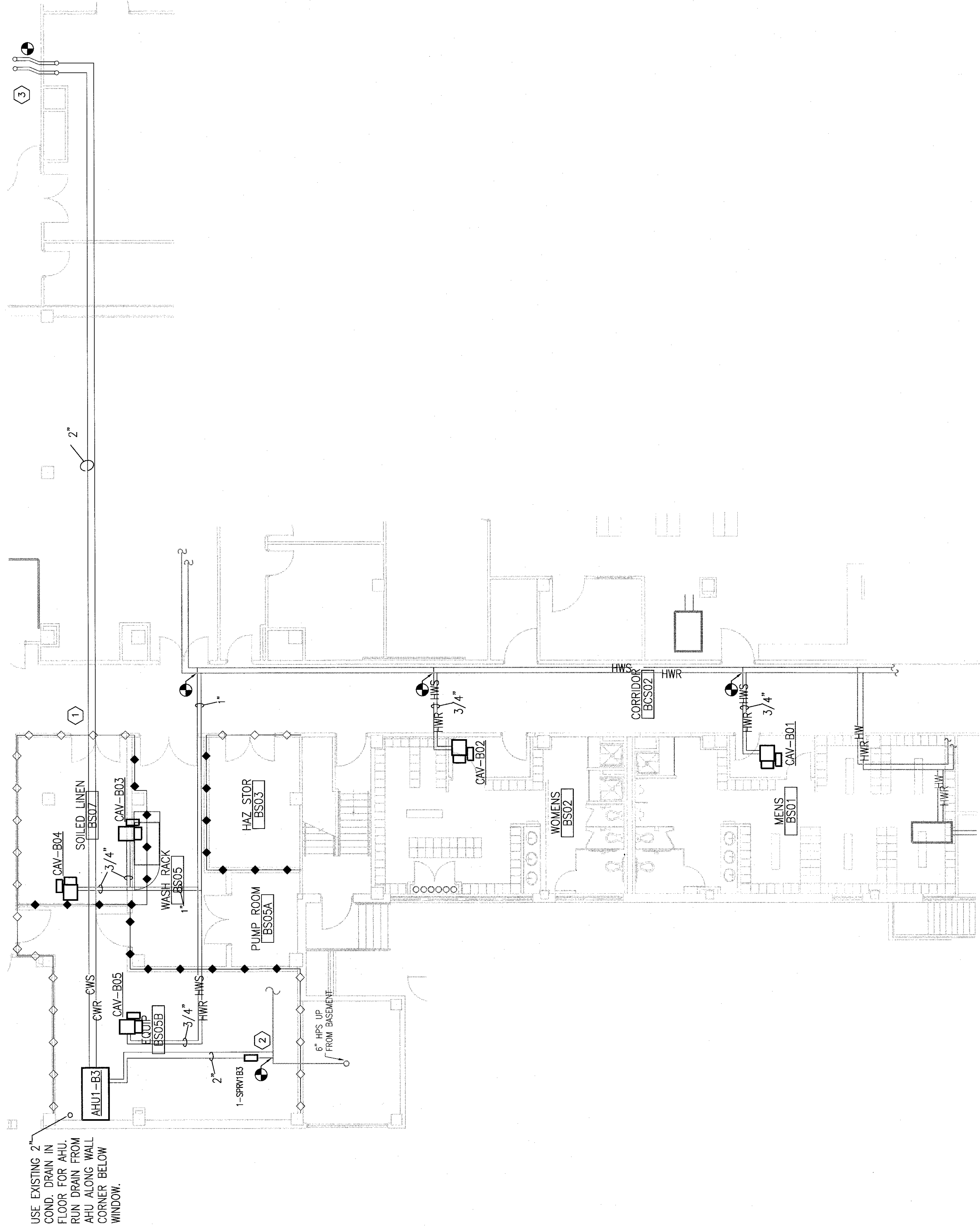

SYMBOLS/EQUIPMENT LEGEND

- WALL-MOUNTED THERMOSTAT
- CONNECTION BETWEEN NEW AND EXISTING
- CAV/WW AIR TERMINAL UNIT



BASEMENT FLOOR PLAN - NEW HYDRONIC PIPING
18" x 11"

GENERAL NOTE:

ALL EXISTING PIPING, DUCTWORK, SPRINKLERS, CONDUIT, LIGHTING OR OTHER CONSTRUCTION SHALL BE RELOCATED AS NECESSARY FOR ALL DEMOLITION AND INSTALLATION WORK.

KEY NOTES

- CONNECT NEW CHILLED WATER PIPING FOR AHU-1 TO EXISTING SERVICE IN CORRIDOR. NEW PIPING SHALL BE PROVIDED WITH SHUT-OFF AND BALANCING VALVES.
- CONNECT NEW STEAM SUPPLY AND RETURN LINES TO EXISTING 6" HPS SERVICE AND RUN TO AHU-B3. CONTRACTOR SHALL BE RESPONSIBLE FOR PROVIDING ALL LABOR AND MATERIALS REQUIRED FOR THIS INSTALLATION, INCLUDING BUT NOT LIMITED TO: VALVES, HANGERS AND SUPPORTS, PRESSURE REDUCING VALVE, DRIP TRAPS, ETC. PROVIDE PRESSURE REDUCING VALVE AS REQUIRED TO MEET THE COIL STEAM PRESSURE REQUIREMENTS.
- TIE IN NEW 2" CWS AND CWS INTO EXISTING 10" CWS AND CWS TURNING UP INTO SHAFT IN THIS AREA.

GENERAL NOTES

- CONSERVATE ALL WORK WITH EXISTING CONDITIONS. ALL OTHER TRADES, AND IN ACCORDANCE WITH ALL STATE, LOCAL AND NATIONAL CODES, AS WELL AS WITH ALL FEDERAL, HEALTHCARE REGULATIONS.
- CONTRACTOR SHALL BE RESPONSIBLE FOR ALL FEES, PERMITS AND LICENSES FOR THE COMPLETE INSTALLATION OF THEIR WORK.
- CONTRACTOR SHALL VISIT AND EXAMINE THE SITE PRIOR TO SUBMITTING BID TO BECOME FAMILIAR WITH EXISTING CONDITIONS.
- BEFORE ANY WORK IS STARTED, THE CONTRACTOR SHALL MAKE A THOROUGH SURVEY WITH THE OWNER IN WHICH ALTERATIONS OCCUR AND RECORDS WHICH ARE SUBJECTS OF ACCESS, AND FORNISH A REPAIR REPORT SHALL BE SIGNED BY BOTH OWNER AND CONTRACTOR, AND SHALL BE PROVIDED TO THE CONTRACTING OFFICER.
- ALL NEW HVAC EQUIPMENT AND DDC CONTROLS SHALL BE TIED BACK INTO EXISTING CONTROL SYSTEM AT NEAREST ETHERNET HUB.
- ALL EXISTING SPRINKLER HEADS, PRES. ALARMS, ETC. ARE TO REMAIN INTACT FOR USE AFTER RENOVATION. SPRINKLER SYSTEM SHALL REMAIN IN OPERATION THROUGHOUT PERIOD OF WORK. CONTRACTOR SHALL ENSURE THAT NO DAMAGE IS DONE TO EXISTING SPRINKLER SYSTEM - I.E. PROTECTIVE CASES SHALL BE INSTALLED OVER SPRINKLER HEADS DURING RENOVATION, ETC.
- CARE SHOULD BE TAKEN BY ALL CONTRACTORS TO AVOID DAMAGING OR DISTURBING EXISTING CONSTRUCTION WHICH IS TO REMAIN. CONTRACTORS SHALL BE RESPONSIBLE FOR MAKING ANY REPAIRS NECESSARY TO RECTIFY DAMAGED AND RESTORE EXISTING CONSTRUCTION TO UNDAMAGED STATE UPON COMPLETION OF WORK AT NO EXPENSE TO OWNER.
- ALL PIPING EXPOSED TO THE OUTDOORS SHALL BE WRAPPED IN HEAT TAPE.
- ALL NEW DEVICES, EQUIPMENT, CONTROLS, ETC. (INCLUDING BUT NOT LIMITED TO: WVS, COILS, GRILLES, REGISTERS, AND DIFFUSERS, HOT WATER PIPING, ETC.) SHALL BE TESTED AND BALANCED AS PART OF THIS WORK. EXISTING EQUIPMENT TO REMAIN SHALL BE TESTED AND BALANCED AS NOTED ON DRAWINGS.
- ALL EQUIPMENT, PIPING, THERMISTERS, GAGES, VALVES, ETC. THAT ARE LOCATED OUTSIDE SHALL BE OF OUTDOOR-USE QUALITY. THE WINTER ENVIRONMENT IN IOWA CITY IS COLD, COY, AND THE PRESENCE OF SALT DURING PERIODS OF SNOW REMINDERS IT CORROSIVE - CONTRACTOR SHALL SEEK APPROVAL FROM VA ENGINEERING STAFF AND PARADIGM ENGINEERS AND CONSTRUCTORS BEFORE PURCHASING ANY EQUIPMENT.
- PIPING RUNS SHOWN ARE REPRESENTATIVE ONLY. CONTRACTOR SHALL BE RESPONSIBLE FOR ANY CONDITIONS IN THE FIELD (EXISTING OR PREDICTED BY LOCATION OF NEW EQUIPMENT) THAT MAKE NECESSARY ALTERNATE ROUTING OF PIPING.
- ALL WY/CW TERMINALS WITH HOT-WATER REHEAT SHALL HAVE 2-ROW HEATING COILS. SEE NEW EQUIPMENT SCHEDULES FOR MORE INFORMATION.
- CONTRACTOR SHALL BE RESPONSIBLE FOR REPAIRING (PATCHING, SEALING, FIRE-STOPPING, ETC.) ALL ABANDONED WALL PENETRATIONS AND ANY NEW PENETRATIONS CREATED FOR DUCT, PIPE, CONDUIT, ETC.
- CONTRACTOR SHALL BE RESPONSIBLE FOR REPAIRING ANY ARCHITECTURAL WORK (INCLUDING BUT NOT LIMITED TO: FLOORING, CEILING TILE AND GRID, SMOKE PARTITIONS ABOVE CEILING, GYPSUM WALL BOARD AND PAINTING, PLASTER, ETC.) THAT IS DAMAGED, DISTURBED, OR REMOVED INCIDENTAL TO THIS WORK.
- CONTRACTOR SHALL BE RESPONSIBLE FOR ANY AND ALL ASBESTOS ABATEMENT ASSOCIATED WITH NEW AND DEMOLITION WORK.
- ALL NEW AIR TERMINAL UNITS SHALL BE PROVIDED WITH AUTOMATIC CIRCUIT SETTERS AND SHUT-OFF VALVES. SEE DETAILS AND SPECIFICATIONS FOR MORE INFORMATION.

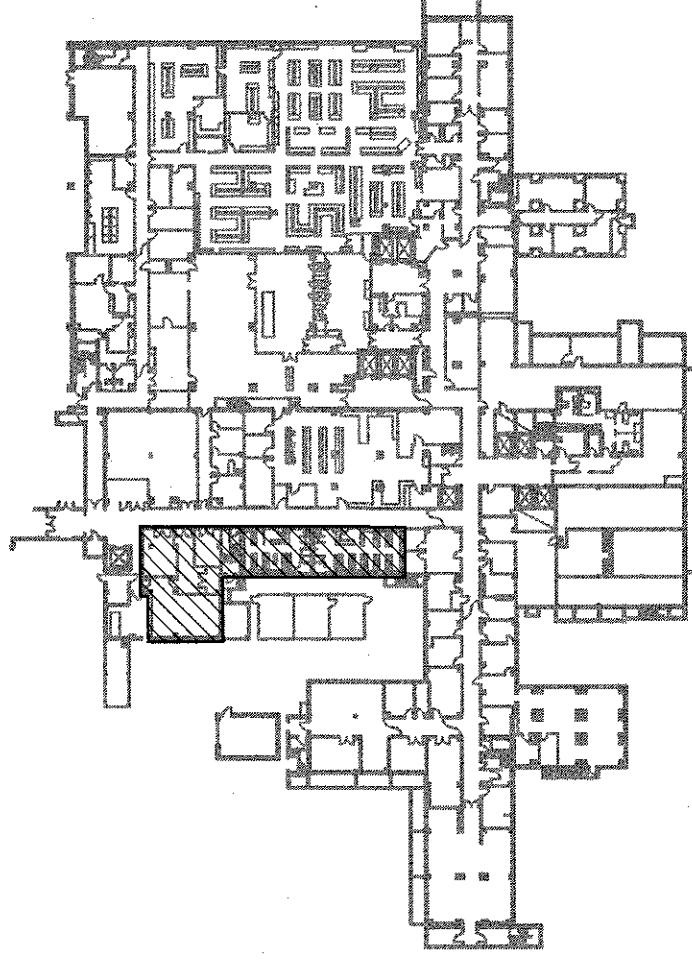

KEY PLAN
NOT TO SCALE
FULLY SPRINKLERED BUILDING
BID DOCUMENTS

CONSULTANTS:		ARCHITECT/ENGINEERS:		Drawing Title: BASEMENT FLOOR NEW HYDRONIC PIPING		Project Title: SURGICAL SUPPORT AND LOCKERS		Project Number: 636A8-11-011		Office of Construction and Facilities Management	
Date		KERRY LEE PICKETT 36602-006 REGISTERED PROFESSIONAL		Approved Project Director		Location: IOWA CITY VAMC 801 KENNETH A WEST IOWA CITY, IOWA 52242-208		Building Number: 1		Department of Veterans Affairs	
		PARADIGM ENGINEERS AND CONSTRUCTORS PO BOX 436223 Louisville, Kentucky 40253 - PH: 502.339.8511 - www.paradigmus.com		19 July 2012 STATE OF KENTUCKY KERRY LEE PICKETT 36602-006 REGISTERED PROFESSIONAL PHYSICAL THERAPY		Drawing Number: 1-H7		Drawing Number: 1			
						Date: 07-26-12		Checklist: KLP		Drawn: JEM	