

GA28-2 EXISTING CONDITIONS & DEMOLITION PLAN

SCALE: 1/4"=1'-0"

GA28-2 RENOVATION & NEW
PLAN

SCALE: 1/4"=1'-0"

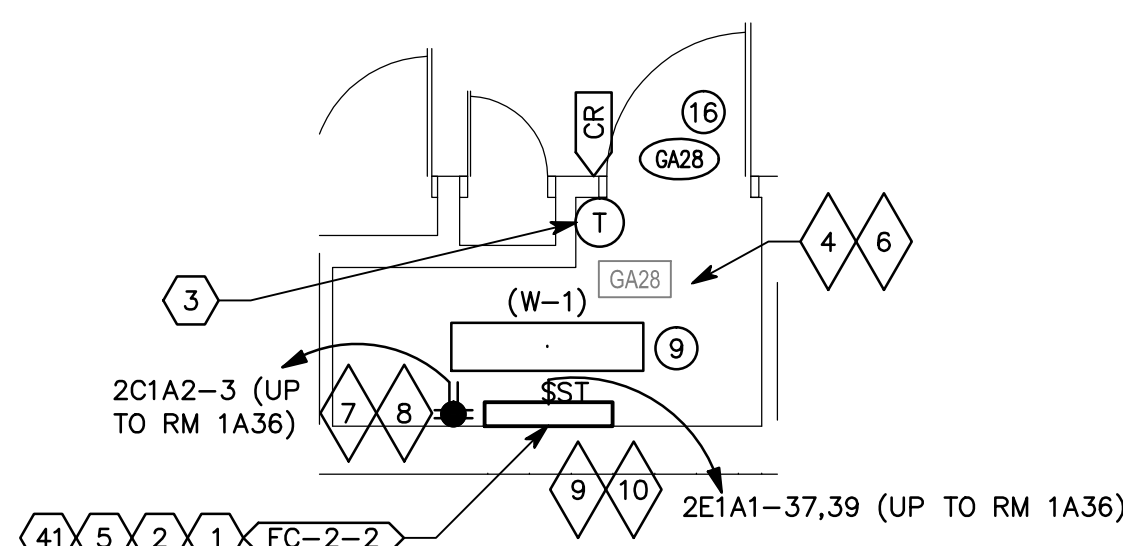
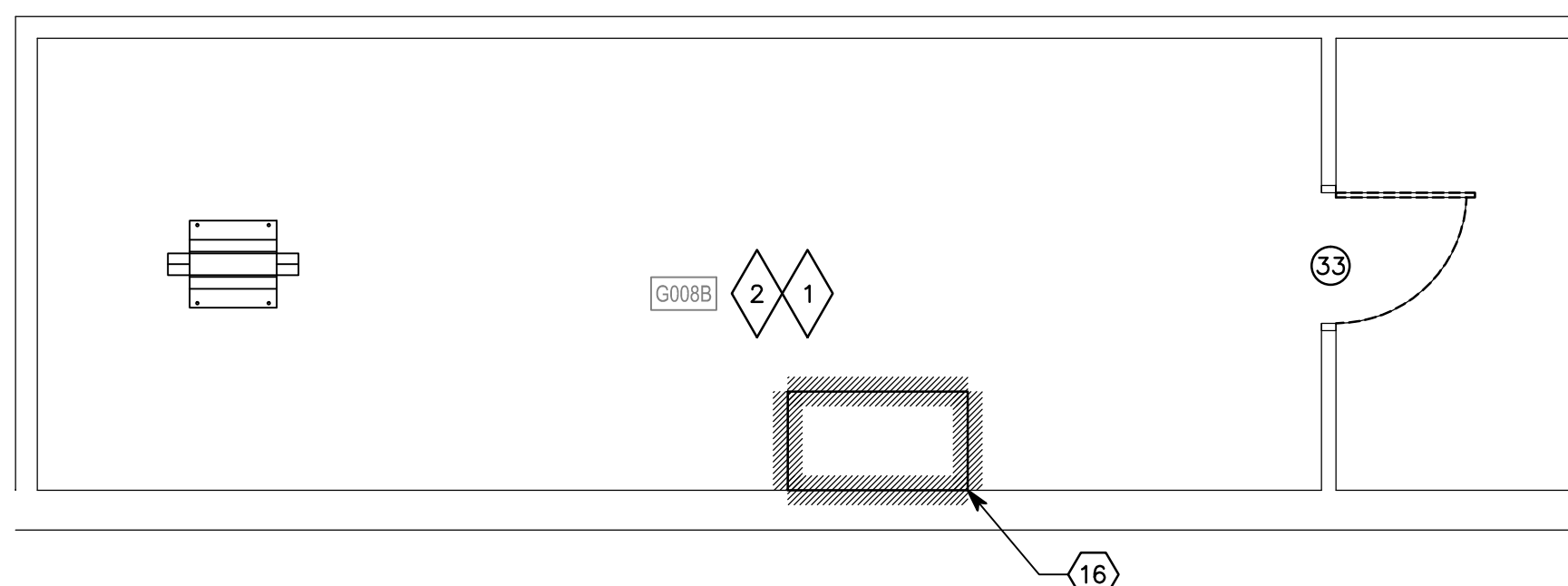

G008B-2 EXISTING CONDITIONS & DEMOLITION PLAN

SCALE: 1/4"=1'-0"

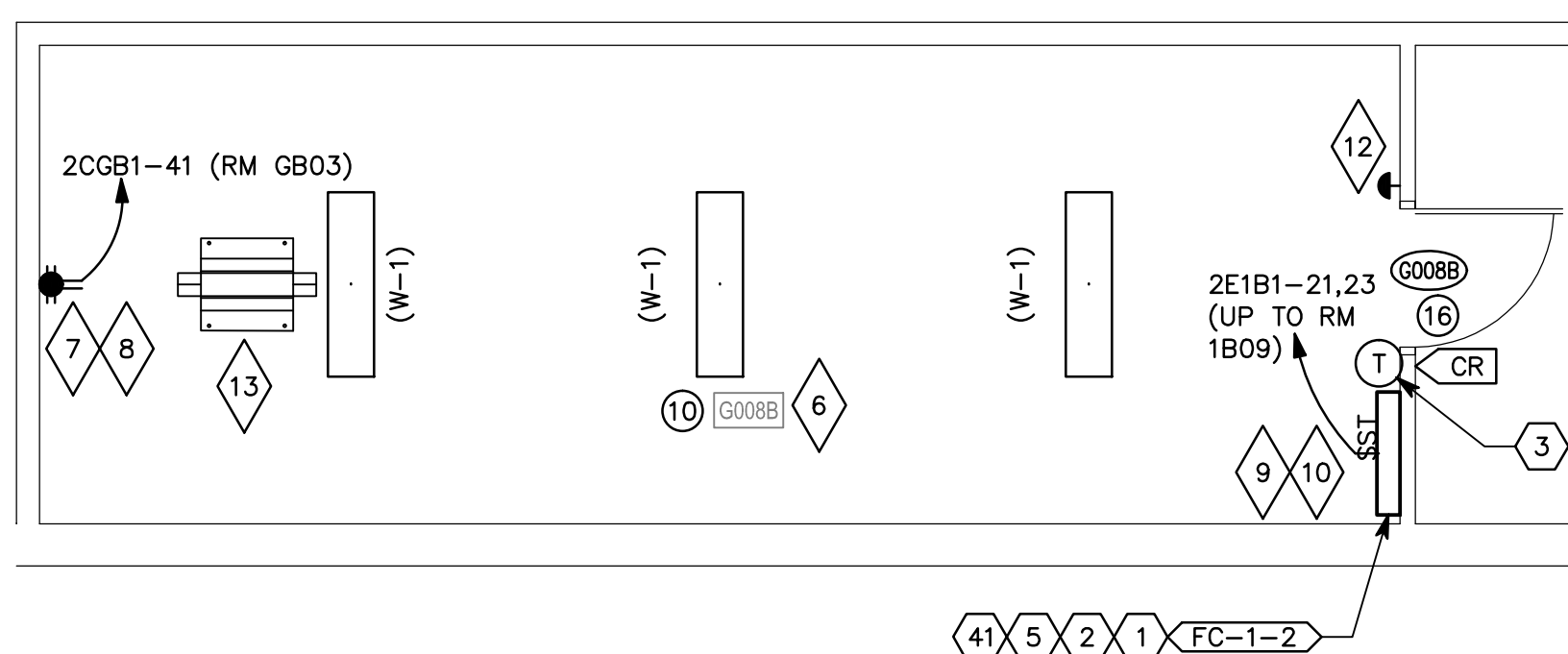

Ⓔ1 G008B-2 RENOVATION & NEW PLAN

SCALE: 1/4"=1'-0"

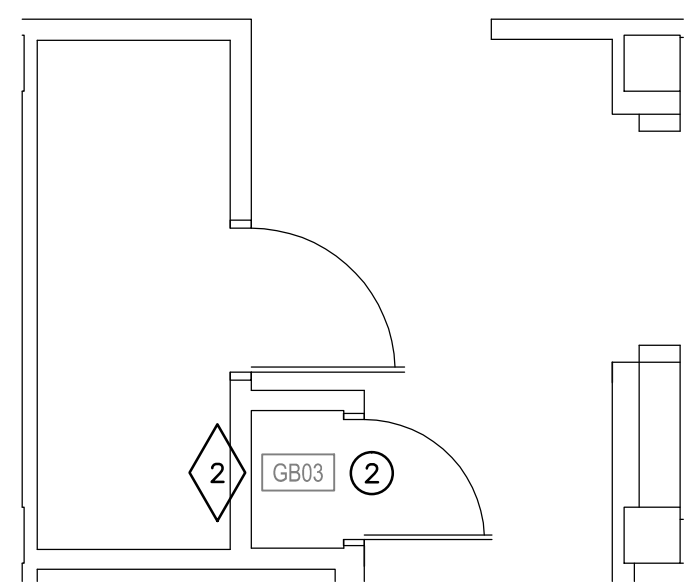

GB03-2 EXISTING CONDITIONS & DEMOLITION PLAN

SCALE: 1/4"=1'-0"

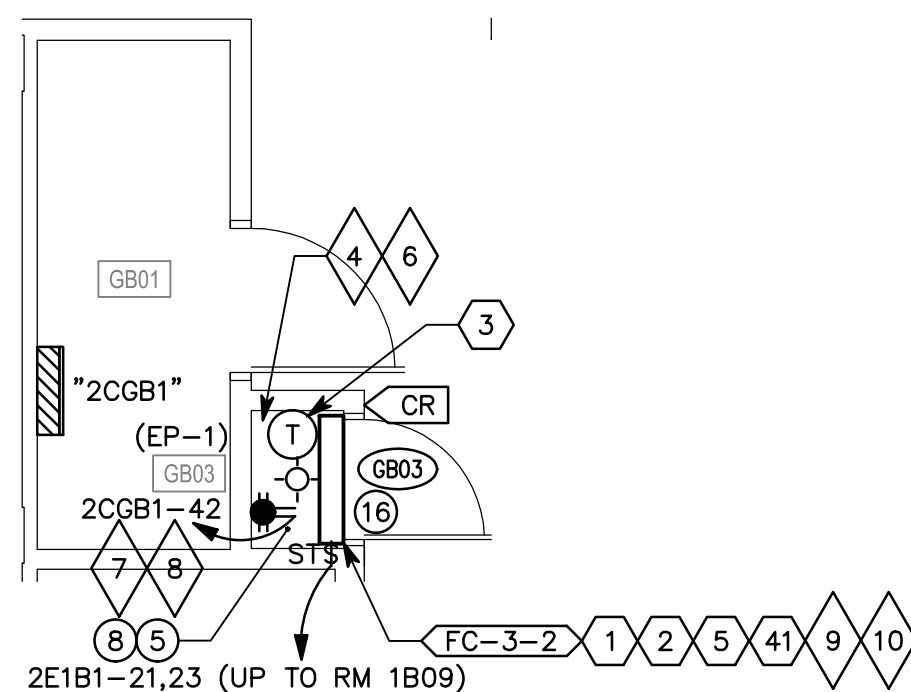

GB03-2 RENOVATION & NEW PLAN

SCALE: 1/4"=1'-0"

ELECTRICAL
KEYNOTES

1. REMOVE EXISTING LIGHT FIXTURE AND EXISTING LIGHT SWITCH. CONDUIT, CONDUCTORS AND JUNCTION BOXES SHALL REMAIN IN PLACE AND REUSABLE FOR RE-USE. LIGHT FIXTURE AND SWITCH SHALL BE REPLACED AND ALL INTERCONNECTING CIRCUITRY SHALL REMAIN OPERABLE AS ILLUSTRATED ON NEW WORK DRAWINGS.
2. REMOVE EXISTING UPS UNIT. RETURN ALL FUNCTIONAL UPS UNITS TO THE VA. DISCONNECT ALL CIRCUITRY FROM UPS UNITS USING PROPER METHODS.
3. EXISTING EMERGENCY OUTLET SHALL REMAIN.
4. PROVIDE NEW LIGHT FIXTURE PER LIGHT FIXTURE SCHEDULE AS DETAILED. RECONNECT EXISTING CIRCUIT TO POWER NEW LIGHT FIXTURE. PROVIDE AND INSTALL A 20 AMPERE DUAL TECHNOLOGY OCCUPANCY SENSOR/LIGHT SWITCH COMBO TO CONTROL THE LIGHTING.
5. PROVIDE LIGHT FIXTURE PER LIGHT FIXTURE SCHEDULE. EXTEND NEW CRITICAL POWER CIRCUIT BEING PULLED IN TO POWER NEW IT OUTLET. PROVIDE A 20 AMPERE DUAL TECHNOLOGY OCCUPANCY SENSOR/LIGHT SWITCH COMBO TO CONTROL THE LIGHTING.
6. PROVIDE UPS UNIT, APC-SMT2200RM2U (RACK MOUNTED) OR APC-SMT2200. PROVIDE WALL MOUNTED SHELF FOR UPS UNIT THAT IS A MINIMUM OF 10" BY 24" IN SIZE AND CAN HOLD A MINIMUM OF 125 LBS. PROVIDE SHELF TO VA AND INSURE VENDOR APPROVAL. INSTALL UPS ON SHELVEING UNIT AND SECURE UPS TO SHELF AND WALL. RECONNECT EXISTING IT EQUIPMENT REMOVED/DISCONNECTED IF ITEM KEYNOTE 2.
7. PROVIDE A FOUR-PLEX RED RECEPTACLE(S), HOSPITAL GRADE WITH A STEEL PLATE. PATCH EXISTING WALL FLUSH MOUNTED, WITH CIRCUIT NUMBER AND PANEL DESIGNATION ENGRAVED ON THE STEEL PLATE. PATCH EXISTING WALL AS REQUIRED TO ACCOMMODATE NEW INSTALLATION.
8. PROVIDE A NEW SQUARE D, SINGLE POLE 20 AMPERE, NOOB STYLE BOLTED CIRCUIT BREAKER FOR NEW CIRCUIT. GENERATE AND REPRINT NEW COMPUTER GENERATED, TYPEWRITTEN PANEL CIRCUIT DIRECTORY SCHEDULE WITH THE UPDATED CIRCUITRY INFORMATION.
9. PROVIDE A NEW SQUARE D, SINGLE POLE 20 AMPERE, NOOB STYLE BOLTED CIRCUIT BREAKER FOR NEW CIRCUIT. GENERATE AND REPRINT NEW COMPUTER GENERATED, TYPEWRITTEN PANEL CIRCUIT DIRECTORY SCHEDULE WITH THE UPDATED CIRCUITRY INFORMATION.
10. PROVIDE A 20 AMP THERMAL SWITCH RATED FOR MECHANICAL EQUIPMENT.
11. PROVIDE WATER SENSOR UNDERNEATH RAISED FLOOR. TO BE CONNECTED AND MONITORED BY CONTRACTOR BUILDING MANAGEMENT SYSTEM.
12. PROVIDE EMERGENCY SHUT OFF SWITCH FOR ALL IT POWER. LOCATE SWITCH IN PLAIN SIGHT BY EXIT. PROVIDE PLASTIC COVER PROTECTOR FOR SHUT OFF SWITCH.
13. PROVIDE ADEQUATE DRIP SHIELD OVER ALL EQUIPMENT. PROVIDE PLASTIC COVER TO PROTECT EM SHUT OFF SWITCH.
14. PROVIDE NEW 120V/208V 3A, 100A SQUARE D PANEL WITH 24 SPARE 20A AMP SINGLE POLE BREAKERS WITH LAB 100 AMP 1 POLE BREAKER. PULL POWER FROM 4LGB2. PROVIDE A 100A, 3 POLE BREAKER FOR CIRCUITS 20,22,24. PROVIDE 100 AMP EXISTING CIRCUITRY HANDLER FED FROM 4LGB2-20,22,22,24 TO NEW PANEL. 4CGB1-2,4,6 USE EXISTING CONDUIT FE-PULL NEW CONDUCTORS TO MATCH EXISTING AND PROVIDE NEW CIRCUIT BREAKER TO MATCH EXISTING FOR AIR HANDLER UNIT RE-WIRING.
15. PROVIDE A NEW SQUARE D, 3 PHASE, 3C 100 AMP TYPEWRITTEN PANEL CIRCUIT DIRECTORY SCHEDULE WITH THE UPDATED CIRCUITRY INFORMATION. PROVIDE A 30A 3 PHASE, NEMA 3R DISCONNECT AT CU.
16. PROVIDE NEW 120V/208V 3A, 100A SQUARE D PANEL WITH 24 SPARE 20A AMP SINGLE POLE BREAKERS WITH LAB 100 AMP 1 POLE BREAKER. PULL POWER FROM THREE LEAST CRITICAL CIRCUITS THAT YOU CAN RE-FEED FROM YOUR OWN 208V COORDINATE WITH LAB PERSONNEL AND COTR. RE-PULL NEW CONDUCTORS; CONDUIT AND PROVIDE A 100 AMP EXISTING CIRCUITRY HANDLER EXISTING FOR RE-WIRED CIRCUIT.

[illegible]

CONSULTANTS:

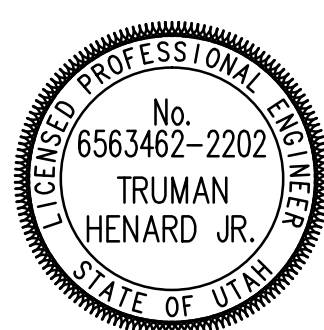

ARCHITECT/ENGINEERS:



**TRACY STOCKING
& ASSOCIATES**

17 Exchange Place, Salt Lake City, UT 84111
office: (801) 463-7103, mobile: (801) 541-7533
fax: (801) 463-7966, www.tsa-usa.com



324 S. State St., Suite 400
Salt Lake City, UT 84111
800-678-7077
801-328-5151
fax: 801-328-5155
www.spectrum-engineers.com

Tracy D. Stocking, AIA tracy@tsa-usa.com

Drawing Title
ENLARGED IT CLOSET PLANS

Approved: Project Director

Project Title	RENOVATE INFORMATION TECHNOLOGY CLOSETS
---------------	---

Location	VAMC - SLC, UT
----------	----------------

Date
OCTOBER 30, 2012

UT

Checked	Drawn
TXH	PSS

Project Number
660-11-113

Building Number
B.02

Drawing Number

GE416

Office of
Construction
and Facilities
Management

Department of
Veterans Affairs