

LEGEND

- Fixtures to remain, replace faucet, see plumbing, typ.
- Remove fixture, see plumbing, typ.
- Doors and frames to remain
- Remove door and frame
- Glazing to remain
- Remove glazing, typ.
- Existing wall to remain
- Demo wall
- Remove existing handrails & crashguards indicated, typ.

NOTES

- 1 Automatic doors to be removed, typ.
- 2 Handrails to be removed, typ.
- 3 Remove portion of partition as indicated, typ.
- 4 Relocate security camera, coordinate with VA, typ.
- 5 Remove wall mounted HVAC system complete. See Mechanical, typ.
- 6 Remove existing lightning fixtures, see electrical, typ.
- 7 Remove existing doors to allow new automatic doors, typ.
- 8 Relocate vending machine to new exterior location, see 1/A-2.0, typ.
- 9 Remove windows and counter as indicated, typ.
- 10 Fire extinguisher cabinet to remain, typ.
- 11 Ice and water machine to remain, typ.
- 12 Remove existing laminate from casework, typ.
- 13 Remove exhaust. See mechanical, typ.
- 14 Remove existing raised decking, typ.
- 15 Existing joists to remain, typ.
- 16 Down spouts to remain, typ.
- 17 Lightning protection grounding to remain, typ.
- 18 Existing defibrillator to remain. Contractor to relocate during construction, coordinate with VA, typ.
- 19 In toilet rooms, remove all floor and wall finishes. Remove existing ceramic tile and gyp board wall finishes. Install moisture resistant gyp. board prior to wall tile installation. Provide submittals for moisture resistant gyp. board and ceramic tile, including assembly, prior to construction.
- 20 In toilet rooms, remove toilet fixtures complete, typ.
- 21 Remove door and frame, typ.
- 22 Remove existing hose bib. Cap beyond face of wall, patch and repair brick as required.
- Remove existing corner wall guards, typ.
- 23 Salvage and relocate existng door.
- 24 Remove portion of wall to allow new opening, see detail 1,4 / A-5.2.
- 25 Remove existing casework complete, typ.
- 26 Remove existing handrails & crash guards, typ.
- 27
- NOTE: SEE MECHANICAL, ELECTRICAL, AND PLUMBING SHEETS FOR ADDITIONAL SCOPE OF WORK

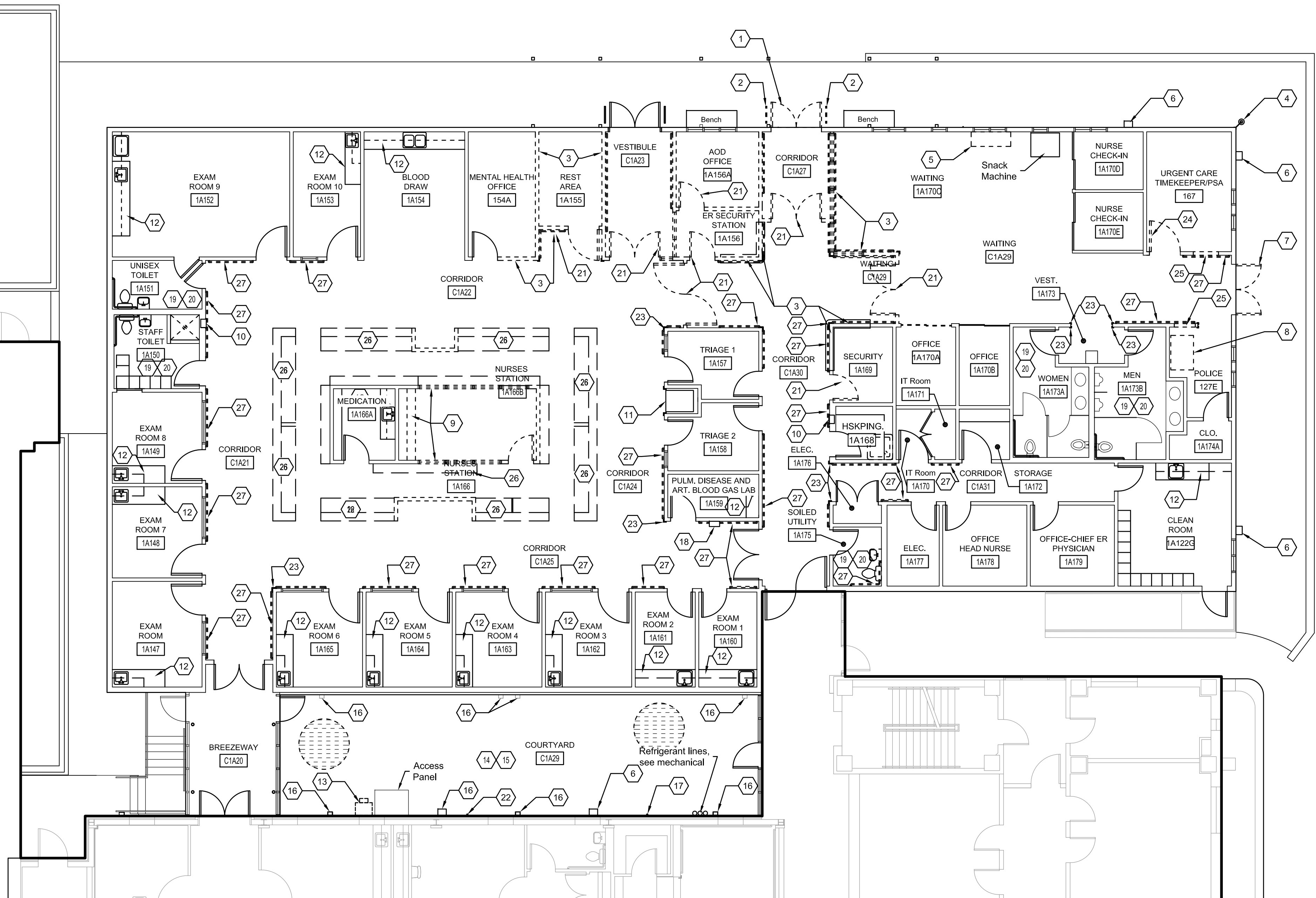

1 Floor Plan - Demolition
D-2.0 scale: 1/8" = 1'-0"

GENERAL NOTES

1. Repair and repaint exterior of the building.
2. Replace automatic doors at entrances.
3. Replace interior finishes of the building.
- A. Remove all floor finishes to show new plan finishes
- B. Paint walls
- C. Upgrade light fixtures (See Electrical), typ.
- D. Remove and replace laminate on all casework, cabinetwork, etc. throughout Urgent Care unless otherwise noted. Completely remove all casework at nurses station. Install systems furniture, including the removal/relocation and/or installation of all electrical, lighting, data and telephone in furniture.
4. Replace HVAC units, see mechanical for scope of work.
5. Refurbish bathrooms, toilet and utility rooms: flooring, walls, fixtures, partitions, etc.
6. Upgrade electrical distribution in building.
7. Cover outside patio area and replace damaged flooring.
8. Remove abandoned air handler and repair roof.
9. Remove and replace all handrails and crash guards.

Revisions		
No.	Date	Remarks

Hernandez Consulting
ALBERT ARCHITECTURE



Allen&Hoshall
engineering since 1915

Approved:	
Title	Signature

Drawing Title	
Demolition Floor Plan	
Approved Service Engineer	
Approved Service Director	

Project Title	
Southeast VA Health Care System (SLVHCS) A&E Design Urgent Care	
Approved Service Engineer	
Approved Service Director	

Date	
January 18, 2013	
Project No.	VA256-C-0231
Drawn	S. Gonzalez
Check	



Department of Veterans Affairs