

Finish Schedule

Room No.	Rm. Name	Floor	Base	Walls		Ceiling		Remarks
				Material	Fin.	Matl.	Fin.	
C1A23	Vestibule	Vinyl	4" Rubber	Gyp. bd.	Pl.	ACT-1	White	
1A168B	Nurse's Station	Vinyl	4" Rubber	Gyp. bd.	Pl.	ACT-1	White	
C1A22	Corridor	Vinyl	4" Rubber	Gyp. bd.	Pl.	ACT-1	White	
C1A21	Corridor	Vinyl	4" Rubber	Gyp. bd.	Pl.	ACT-1	White	
C1A25	Corridor	Vinyl	4" Rubber	Gyp. bd.	Pl.	ACT-1	White	
C1A24	Corridor	Vinyl	4" Rubber	Gyp. bd.	Pl.	ACT-1	White	
1A154	Blood Draw	Vinyl	4" Rubber	Gyp. bd.	Pl.	ACT-1	White	
1A151	Unisex Toilet	Vinyl	4" Rubber	Gyp. bd., CT	Pl., CT	ACT-1	White	
1A150	Staff Toilet	Vinyl	4" Rubber	Gyp. bd., CT	Pl., CT	Gyp. bd., Pl.	White	
1A166A	Medication	Vinyl	4" Rubber	Gyp. bd.	Pl.	ACT-1	White	
G1A31	Corridor	Vinyl	4" Rubber	Gyp. bd.	Pl.	ACT-1	White	
1A122G	Clean Storage	Vinyl	4" Rubber	Gyp. bd.	Pl.	ACT-1	White	
C1A20	Breastway	Vinyl	4" Rubber	Gyp. bd.	Pl.	ACT-1	White	
C1A29	Waiting	Vinyl	4" Rubber	Gyp. bd.	Pl.	ACT-1	White	
1A173	Vestibule	Vinyl	4" Rubber	Gyp. bd.	Pl.	ACT-1	White	
1A174	Nurse Check-in	Vinyl	4" Rubber	Gyp. bd.	Pl.	ACT-1	White	
1A174A	Closet	Vinyl	4" Rubber	Gyp. bd.	Pl.	ACT-1	White	
C1A30	Corridor	Vinyl	4" Rubber	Gyp. bd.	Pl.	ACT-1	White	
C1A29	Courtyard	Wood						Paint brick wall match existing, see 1A16.0
1A147	Exam Room	Vinyl	4" Rubber	Gyp. bd.	Pl.	ACT-1	White	
1A148	Exam Room 7	Vinyl	4" Rubber	Gyp. bd.	Pl.	ACT-1	White	
1A149	Exam Room 8	Vinyl	4" Rubber	Gyp. bd.	Pl.	ACT-1	White	
1A152	Exam Room 9	Vinyl	4" Rubber	Gyp. bd.	Pl.	ACT-1	White	
1A153	Exam Room 10	Vinyl	4" Rubber	Gyp. bd.	Pl.	ACT-1	White	
1A154A	Break Room	Vinyl	4" Rubber	Gyp. bd.	Pl.	ACT-1	White	
1A155	Rest Area	Vinyl	4" Rubber	Gyp. bd.	Pl.	ACT-1	White	
1A156	Exam Room 11	Vinyl	4" Rubber	Gyp. bd.	Pl.	ACT-1	White	
1A156B	Exam Room 12	Vinyl	4" Rubber	Gyp. bd.	Pl.	ACT-1	White	
1A156A	Mental Health	Vinyl	4" Rubber	Gyp. bd.	Pl.	ACT-1	White	
1A157	Triage	Vinyl	4" Rubber	Gyp. bd.	Pl.	ACT-1	White	
1A158	Triage 2	Vinyl	4" Rubber	Gyp. bd.	Pl.	ACT-1	White	
1A159	Pulm. Disease / Art. Blood Lab	Vinyl	4" Rubber	Gyp. bd.	Pl.	ACT-1	White	
1A160	Exam Room 1	Vinyl	4" Rubber	Gyp. bd.	Pl.	ACT-1	White	
1A161	Exam Room 2	Vinyl	4" Rubber	Gyp. bd.	Pl.	ACT-1	White	
1A162	Exam Room 3	Vinyl	4" Rubber	Gyp. bd.	Pl.	ACT-1	White	
1A163	Exam Room 4	Vinyl	4" Rubber	Gyp. bd.	Pl.	ACT-1	White	
1A164	Exam Room 5	Vinyl	4" Rubber	Gyp. bd.	Pl.	ACT-1	White	
1A165	Exam Room 6	Vinyl	4" Rubber	Gyp. bd.	Pl.	ACT-1	White	
1A167	AOD	Vinyl	4" Rubber	Gyp. bd.	Pl.	ACT-1	White	
1A167A	Pharmacy	Vinyl	4" Rubber	Gyp. bd.	Pl.	ACT-1	White	
1A168	Housekeeping	Vinyl	4" Rubber	Gyp. bd.	Pl.	ACT-1	White	
1A169	Security	Vinyl	4" Rubber	Gyp. bd.	Pl.	ACT-1	White	
1A170A	Children's Area	Carpet	4" Rubber	Gyp. bd.	Pl.	ACT-1	White	See 2. AOD, training others to perform for children's support services
1A170B	Office	Vinyl	4" Rubber	Gyp. bd.	Pl.	ACT-1	White	
1A170D	Nurse Check-in	Vinyl	4" Rubber	Gyp. bd.	Pl.	ACT-1	White	
1A170E	Nurse Check-in	Vinyl	4" Rubber	Gyp. bd.	Pl.	ACT-1	White	
1A172	Storage	Vinyl	4" Rubber	Gyp. bd.	Pl.	ACT-1	White	
1A173A	Women's Restroom	Vinyl	4" Rubber	Gyp. bd., CT	Pl., CT	ACT-1	White	
1A173B	Men's Restroom	Vinyl	4" Rubber	Gyp. bd., CT	Pl., CT	ACT-1	White	
1A175	Soiled Utility	Vinyl	4" Rubber	Gyp. bd., CT	Pl., CT	ACT-1	White	
1A176	Elec.	Vinyl	4" Rubber	Gyp. bd.	Pl.	ACT-1	White	
1A177	Elec.	Vinyl	4" Rubber	Gyp. bd.	Pl.	ACT-1	White	
1A178	Office Head Nurse	Vinyl	4" Rubber	Gyp. bd.	Pl.	ACT-1	White	
1A179	Office - Chief ER Physician	Vinyl	4" Rubber	Gyp. bd.	Pl.	ACT-1	White	

Finish Legend

Mark	Manufacturer	Pattern/Color/ Number	Size
Flooring			
FL-01	Mannington	Bamboo Plank/ Caramel	4" x 36"
FL-02	Mannington	American Walnut/ Cocoa/ 12126	4" x 36"
FL-03	Crossville	Palais / Louvre, random	6" x 6", 12" x 18", 18" x 18"
FL-04	Mannington	Fresco/ Burnished Copper/ 12176	18" x 18"
CPT-01	FLOR	Rake me over, Toy Poodle/ Lime / 747, 711	19.7" x 19.7"
Wall Base			
RB-01	Johnsontite	Tightlock Rubber / Sterling Silver / 69	4"
Wall Tile (see A-5.1)			
CT-1	American Olean	Legacy, glass tile, Linear Mosaic/ Jungle Blend/ LG49	n/a
CT-2	Crossville	Palais / Louvre, random	6" x 6"
Ceiling			
ACT-01	Armstrong	Acoustic/ White/ 1935	24" x 24" x 3/4"
Paint			
P1	Benjamin Moore	Basil Green	n/a
P2	Benjamin Moore	Orange	n/a
P3	Benjamin Moore	Happy Valley	n/a
P4	Benjamin Moore	Strathmore Manor	n/a
P5	Benjamin Moore	Rosemary Green	n/a
P6	Benjamin Moore	Stem Green	n/a
P7	Benjamin Moore	Match existing exterior color	n/a
P8	Benjamin Moore	Tangy Orange	n/a
P9	Benjamin Moore	Silhouette	n/a
P10	Benjamin Moore	Chambourd	n/a
Countertop, Cabinets			
CNT-01	Corian Countertop	Shale	1 1/2"
CNT-02	Corian Countertop	Arctic Ice	1 1/2"
CBN-01	Herman Miller	Arc Pull/ Brushed Nickel	n/a
CBN-02	Herman Miller	Woodgrain Laminate/ Honey Maple	n/a
CBN-03	3 Form	Varia Ecoresin/ tba	n/a

1 Finish Floor Plan

General Notes

- Prior to the start of construction, provide samples for all finishes indicated. Color as selected by architect from manufacturers full range of colors.
- Contractor to allow for (5) 5'-0" x 5'-0" painted wall mock-ups with 3 colors each to match architects sample prior to painting of walls. Coordinate locations for mock-ups with architect prior to the start of construction.
- All interior hollow metal frames are to be painted P9 - Benjamin Moore - Silhouette.
- All interior metal doors are to be painted P10 - Benjamin Moore - Chambourd.
- All interior paint, excluding paint for the door frames or wood, shall be at a minimum of semi gloss or satin. No flat paint will be accepted.
- Exam room curtains and tracks to be removed and reinstalled as part of ceiling installation by contractor. The number of curtains are limited to four.
- VA will be responsible for removing patient lifts if it is deemed necessary in order to complete ceiling installations. The number of lifts is one.
- See Herman Miller design drawings of Nurse's Station for additional scope of work. Submit shop drawings and samples for all Herman Miller systems furniture for architect's review prior to the start of construction.
- At all toilet room walls, replace existing gyp. board with new 5/8" moisture resistant gyp. board behind new ceramic tile wall finishes, typ. Provide submittals for moisture resistant gyp. board and ceramic tile, including assembly, prior to construction.
- Remove all existing doorstops and install new doorstops to match existing at all rooms and areas with swinging doors. Finalize locations with VA, typ.
- Contractor to supply VA with 10% overage of all flooring, ceiling tile, wall tile and paint, typ.

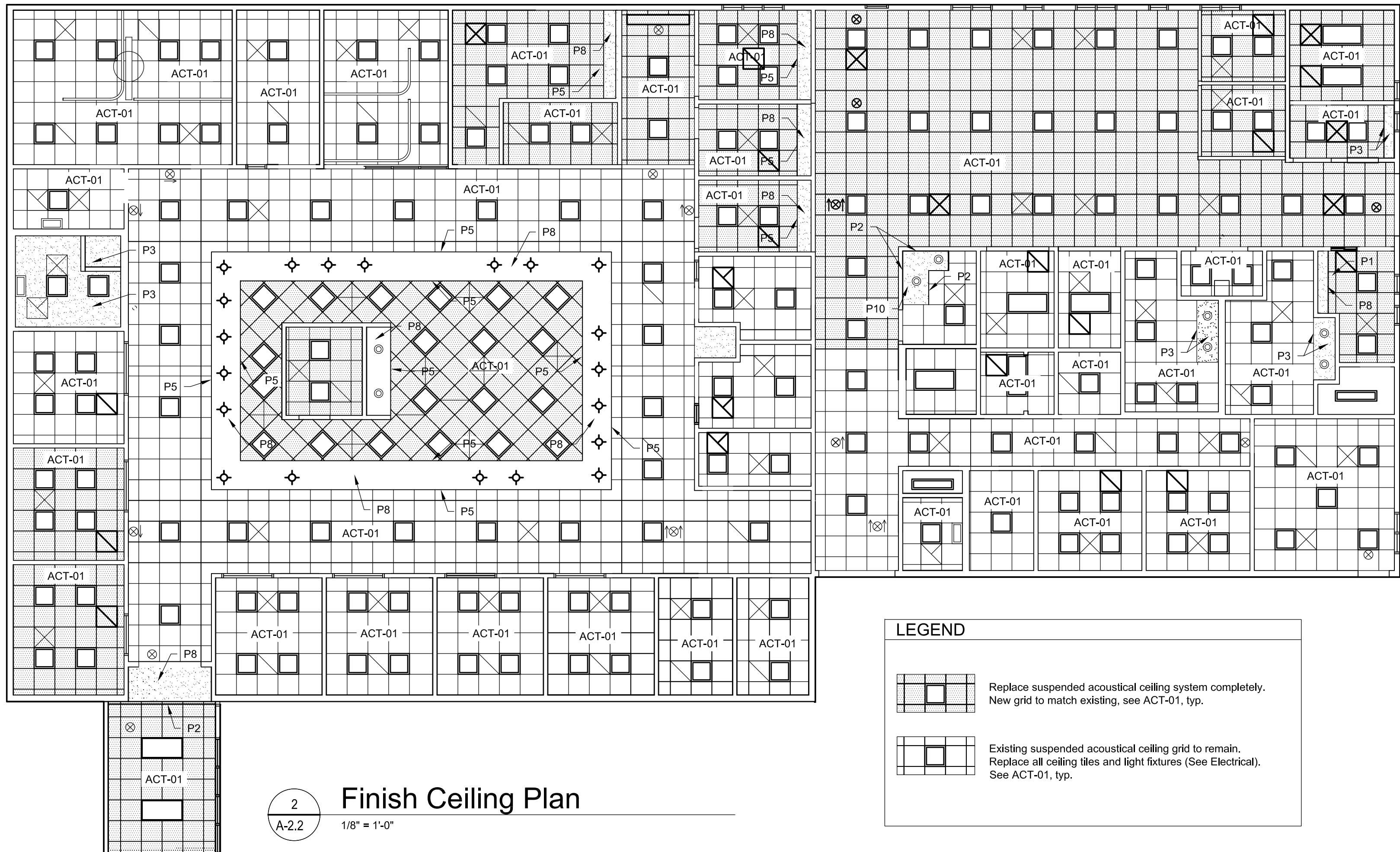

2 Finish Ceiling Plan

Revisions		
No.	Date	Remarks

Hernandez Consulting
ALBERT ARCHITECTURE

JBHM
ARCHITECTS, P.A.

Allen&Hoshall
engineering since 1915

Approved:	
Title	Signature

Drawing Title	
Finish Floor Plan	
Approved: Senior Engineer	
Approved: Senior Director	

Project Title	
Southeast VA Health Care System (SLVHCS) A&E Design Urgent Care	
Building Number	Checked
Location	Drawn: S. Gonzalez
1601 Perdido Street, New Orleans, LA	

Date	January 18, 2013
Project No.	VA256-C-0231
DRAWING NO.	A-2.2
Drawn	5 OF 12



Department of
Veterans Affairs