

Scale: As Show









three inches = one foot

one and one half inches = one foot

one inch = one foot

three quarters inch = one foot

one half inch = one foot

three eighths inch = one foot

one quarter inch = one foot

one eighth inch = one foot

F:\Design Tree Engineering Projects\022 - JLG Architects\02212002 - C-BASE PROPOSED.dwg 10-17-12 09:32:21 AM gmd

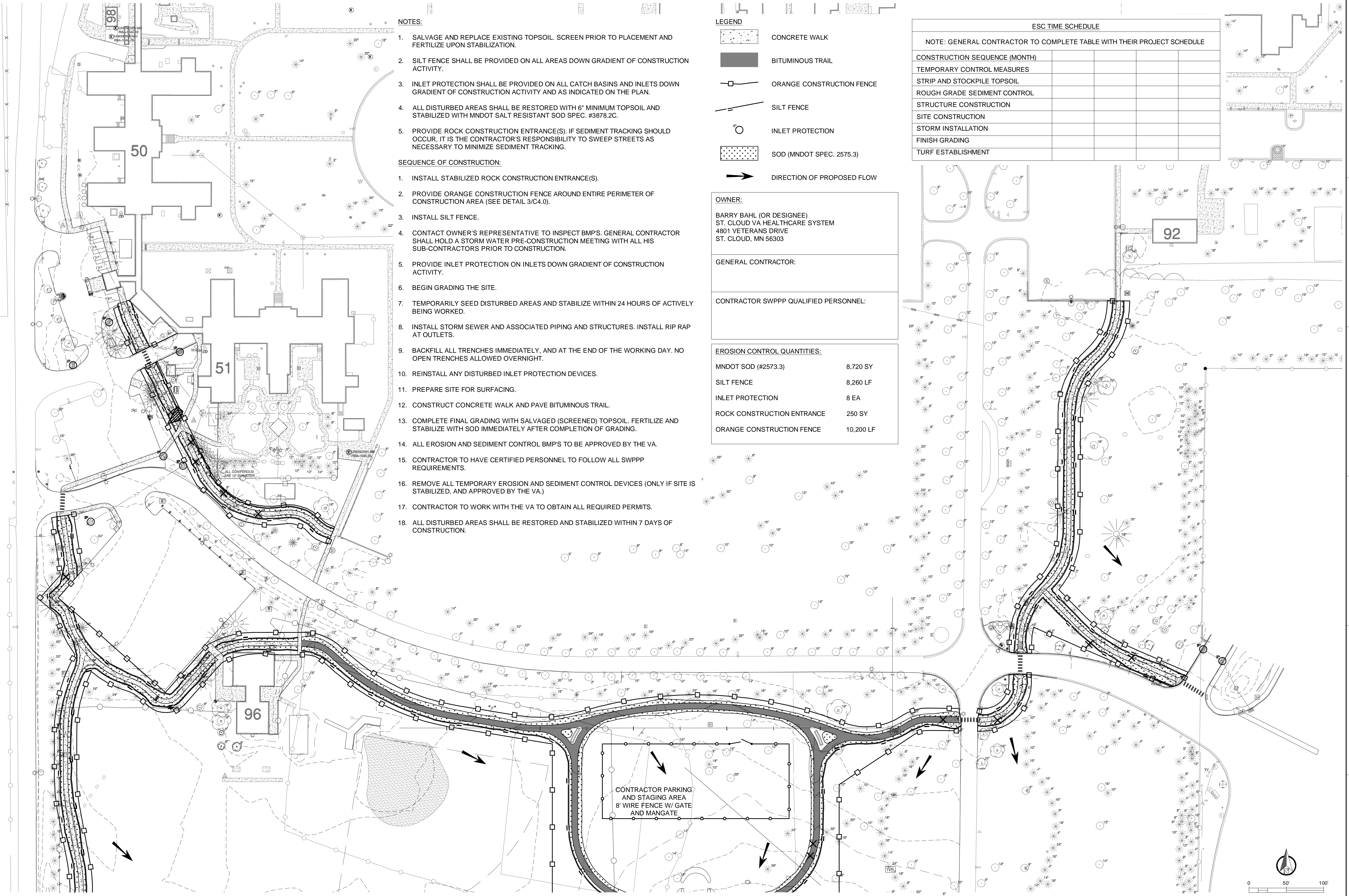

NOTES:

1. SALVAGE AND REPLACE EXISTING TOPSOIL. SCREEN PRIOR TO PLACEMENT AND FERTILIZE UPON STABILIZATION.
2. SILT FENCE SHALL BE PROVIDED ON ALL AREAS DOWN GRADIENT OF CONSTRUCTION ACTIVITY.
3. INLET PROTECTION SHALL BE PROVIDED ON ALL CATCH BASINS AND INLETS DOWN GRADIENT OF CONSTRUCTION ACTIVITY AND AS INDICATED ON THE PLAN.
4. ALL DISTURBED AREAS SHALL BE RESTORED WITH 6" MINIMUM TOPSOIL AND STABILIZED WITH MNDOT SALT RESISTANT SOD SPEC. #3878.2C.
5. PROVIDE ROCK CONSTRUCTION ENTRANCE(S). IF SEDIMENT TRACKING SHOULD OCCUR, IT IS THE CONTRACTOR'S RESPONSIBILITY TO SWEEP STREETS AS NECESSARY TO MINIMIZE SEDIMENT TRACKING.

SEQUENCE OF CONSTRUCTION:

1. INSTALL STABILIZED ROCK CONSTRUCTION ENTRANCE(S).
2. PROVIDE ORANGE CONSTRUCTION FENCE AROUND ENTIRE PERIMETER OF CONSTRUCTION AREA (SEE DETAIL 3/C4.0).
3. INSTALL SILT FENCE.
4. CONTACT OWNER'S REPRESENTATIVE TO INSPECT BMP'S. GENERAL CONTRACTOR SHALL HOLD A STORM WATER PRE-CONSTRUCTION MEETING WITH ALL HIS SUB-CONTRACTORS PRIOR TO CONSTRUCTION.
5. PROVIDE INLET PROTECTION ON INLETS DOWN GRADIENT OF CONSTRUCTION ACTIVITY.
6. BEGIN GRADING THE SITE.
7. TEMPORARILY SEED DISTURBED AREAS AND STABILIZE WITHIN 24 HOURS OF ACTIVELY BEING WORKED.
8. INSTALL STORM SEWER AND ASSOCIATED PIPING AND STRUCTURES. INSTALL RIP RAP AT OUTLETS.
9. BACKFILL ALL TRENCHES IMMEDIATELY, AND AT THE END OF THE WORKING DAY. NO OPEN TRENCHES ALLOWED OVERNIGHT.
10. REINSTALL ANY DISTURBED INLET PROTECTION DEVICES.
11. PREPARE SITE FOR SURFACING.
12. CONSTRUCT CONCRETE WALK AND PAVE BITUMINOUS TRAIL.
13. COMPLETE FINAL GRADING WITH SALVAGED (SCREENED) TOPSOIL. FERTILIZE AND STABILIZE WITH SOD IMMEDIATELY AFTER COMPLETION OF GRADING.
14. ALL EROSION AND SEDIMENT CONTROL BMP'S TO BE APPROVED BY THE VA.
15. CONTRACTOR TO HAVE CERTIFIED PERSONNEL TO FOLLOW ALL SWPPP REQUIREMENTS.
16. REMOVE ALL TEMPORARY EROSION AND SEDIMENT CONTROL DEVICES (ONLY IF SITE IS STABILIZED, AND APPROVED BY THE VA.)
17. CONTRACTOR TO WORK WITH THE VA TO OBTAIN ALL REQUIRED PERMITS.
18. ALL DISTURBED AREAS SHALL BE RESTORED AND STABILIZED WITHIN 7 DAYS OF CONSTRUCTION.

LEGEND

- CONCRETE WALK
- BITUMINOUS TRAIL
- ORANGE CONSTRUCTION FENCE
- SILT FENCE
- INLET PROTECTION
- SOD (MNDOT SPEC. 2575.3)
- DIRECTION OF PROPOSED FLOW

OWNER:

BARRY BAHL (OR DESIGNEE)  
ST. CLOUD VA HEALTHCARE SYSTEM  
4801 VETERANS DRIVE  
ST. CLOUD, MN 56303

GENERAL CONTRACTOR:

CONTRACTOR SWPPP QUALIFIED PERSONNEL:

EROSION CONTROL QUANTITIES:

MNDOT SOD (#2573.3)	8,720 SY
SILT FENCE	8,260 LF
INLET PROTECTION	8 EA
ROCK CONSTRUCTION ENTRANCE	250 SY
ORANGE CONSTRUCTION FENCE	10,200 LF

ESC TIME SCHEDULE

NOTE: GENERAL CONTRACTOR TO COMPLETE TABLE WITH THEIR PROJECT SCHEDULE

CONSTRUCTION SEQUENCE (MONTH)					
TEMPORARY CONTROL MEASURES					
STRIP AND STOCKPILE TOPSOIL					
ROUGH GRADE SEDIMENT CONTROL					
STRUCTURE CONSTRUCTION					
SITE CONSTRUCTION					
STORM INSTALLATION					
FINISH GRADING					
TURF ESTABLISHMENT					

CONTRACTOR PARKING  
AND STAGING AREA  
8' WIRE FENCE W/ GATE  
AND MANGATE

100% CD'S - FOR CONSTRUCTION

Scale: As Shown



Design Tree  
ENGINEERING AND  
LAND SURVEYING

Alexandria Office  
120 17th Avenue W.  
Alexandria, MN 56308  
(320) 762-1290

St. Cloud Office  
3359 West St. Germain, Suite 250  
St. Cloud, MN 56301  
(320) 217-5557



Alexandria  
525 Broadway Street  
Alexandria, MN 56308  
phone 320.759.9030  
facsimile 320.759.9062

www.jlgarchitects.com  
copyright © 2012

STAMP/SEAL:

I HEREBY CERTIFY THAT THIS PLAN,  
SPECIFICATION, OR REPORT WAS PREPARED  
BY ME OR UNDER MY DIRECT SUPERVISION,  
AND THAT I AM A DULY LICENSED ENGINEER  
UNDER THE LAWS OF THE STATE OF  
MINNESOTA.

GINA M. DULLINGER 45489  
REG. NO.  
DATE: 10/16/2012

Drawing Title

EROSION CONTROL PLAN

Approved Project Director

Project Title

CREATE CAMPUS WALKING  
PATH

Location

VA MEDICAL CENTER, ST. CLOUD, MN 56303

Date  
10/16/2012

Checked  
DJF

Drawn  
GMD

Project Number

02212002

Building Number

Drawing Number

C3.0

Dwg 12 of 24





three eighths inch = one foot  
one eighth inch = one foot  
one quarter inch = one foot  
three eighths inch = one foot  
one half inch = one foot  
one inch = one foot  
three quarters inch = one foot  
one and one half inches = one foot  
three inches = one foot

NOTES:

1. SALVAGE AND REPLACE EXISTING TOPSOIL. SCREEN PRIOR TO PLACEMENT AND FERTILIZE UPON STABILIZATION.
  2. SILT FENCE SHALL BE PROVIDED ON ALL AREAS DOWN GRADIENT OF CONSTRUCTION ACTIVITY.
  3. INLET PROTECTION SHALL BE PROVIDED ON ALL CATCH BASINS AND INLETS DOWN GRADIENT OF CONSTRUCTION ACTIVITY AND AS INDICATED ON THE PLAN.
  4. ALL DISTURBED AREAS SHALL BE RESTORED WITH 6" MINIMUM TOPSOIL AND STABILIZED WITH MNDOT SALT RESISTANT SOD SPEC. #3878.2C.
  5. PROVIDE ROCK CONSTRUCTION ENTRANCE(S). IF SEDIMENT TRACKING SHOULD OCCUR, IT IS THE CONTRACTOR'S RESPONSIBILITY TO SWEEP STREETS AS NECESSARY TO MINIMIZE SEDIMENT TRACKING.
- SEQUENCE OF CONSTRUCTION:
1. INSTALL STABILIZED ROCK CONSTRUCTION ENTRANCE(S).
  2. PROVIDE ORANGE CONSTRUCTION FENCE AROUND ENTIRE PERIMETER OF CONSTRUCTION AREA (SEE DETAIL 3/C4.0).
  3. INSTALL SILT FENCE.
  4. CONTACT OWNER'S REPRESENTATIVE TO INSPECT BMP'S. GENERAL CONTRACTOR SHALL HOLD A STORM WATER PRE-CONSTRUCTION MEETING WITH ALL HIS SUB-CONTRACTORS PRIOR TO CONSTRUCTION.
  5. PROVIDE INLET PROTECTION ON INLETS DOWN GRADIENT OF CONSTRUCTION ACTIVITY.
  6. BEGIN GRADING THE SITE.
  7. TEMPORARILY SEED DISTURBED AREAS AND STABILIZE WITHIN 24 HOURS OF ACTIVELY BEING WORKED.
  8. INSTALL STORM SEWER AND ASSOCIATED PIPING AND STRUCTURES. INSTALL RIP RAP AT OUTLETS.
  9. BACKFILL ALL TRENCHES IMMEDIATELY, AND AT THE END OF THE WORKING DAY. NO OPEN TRENCHES ALLOWED OVERNIGHT.
  10. REINSTALL ANY DISTURBED INLET PROTECTION DEVICES.
  11. PREPARE SITE FOR SURFACING.
  12. CONSTRUCT CONCRETE WALK AND PAVE BITUMINOUS TRAIL.
  13. COMPLETE FINAL GRADING WITH SALVAGED (SCREENED) TOPSOIL. FERTILIZE AND STABILIZE WITH SOD IMMEDIATELY AFTER COMPLETION OF GRADING.
  14. ALL EROSION AND SEDIMENT CONTROL BMP'S TO BE APPROVED BY THE VA.
  15. CONTRACTOR TO HAVE CERTIFIED PERSONNEL TO FOLLOW ALL SWPPP REQUIREMENTS.
  16. REMOVE ALL TEMPORARY EROSION AND SEDIMENT CONTROL DEVICES (ONLY IF SITE IS STABILIZED, AND APPROVED BY THE VA.)
  17. CONTRACTOR TO WORK WITH THE VA TO OBTAIN ALL REQUIRED PERMITS.
  18. ALL DISTURBED AREAS SHALL BE RESTORED AND STABILIZED WITHIN 7 DAYS OF CONSTRUCTION.

LEGEND

- CONCRETE WALK  
BITUMINOUS TRAIL  
ORANGE CONSTRUCTION FENCE  
SILT FENCE  
INLET PROTECTION  
SOD (MNDOT SPEC. 2575.3)  
DIRECTION OF PROPOSED FLOW

OWNER:

BARRY BAHL (OR DESIGNEE)  
ST. CLOUD VA HEALTHCARE SYSTEM  
4801 VETERANS DRIVE  
ST. CLOUD, MN 56303

GENERAL CONTRACTOR:

CONTRACTOR SWPPP QUALIFIED PERSONNEL:

EROSION CONTROL QUANTITIES:

MNDOT SOD (#2573.3)	8,720 SY
SILT FENCE	8,260 LF
INLET PROTECTION	8 EA
ROCK CONSTRUCTION ENTRANCE	250 SY
ORANGE CONSTRUCTION FENCE	10,200 LF

ESC TIME SCHEDULE

NOTE: GENERAL CONTRACTOR TO COMPLETE TABLE WITH THEIR PROJECT SCHEDULE

CONSTRUCTION SEQUENCE (MONTH)				
TEMPORARY CONTROL MEASURES				
STRIP AND STOCKPILE TOPSOIL				
ROUGH GRADE SEDIMENT CONTROL				
STRUCTURE CONSTRUCTION				
SITE CONSTRUCTION				
STORM INSTALLATION				
FINISH GRADING				
TURF ESTABLISHMENT				

100% CD'S - FOR CONSTRUCTION

Scale: As Shown



Design Tree  
ENGINEERING AND  
LAND SURVEYING

Alexandria Office  
120 17th Avenue W.  
Alexandria, MN 56308  
(320) 762-1290

St. Cloud Office  
3339 West St. Germain, Suite 250  
St. Cloud, MN 56301  
(320) 217-5557



Alexandria  
525 Broadway Street  
Alexandria, MN 56308  
phone 320.759.9030  
facsimile 320.759.9062

www.jlgarchitects.com  
copyright © 2012

STAMP/SEAL:

I HEREBY CERTIFY THAT THIS PLAN,  
SPECIFICATION, OR REPORT WAS PREPARED  
BY ME OR UNDER MY DIRECT SUPERVISION,  
AND THAT I AM A DULY LICENSED ENGINEER  
UNDER THE LAWS OF THE STATE OF  
MINNESOTA.

GINA M. DULLINGER 45489  
DATE: 10/16/2012 REG. NO.

Drawing Title  
EROSION CONTROL PLAN

Approved Project Director

Project Title  
CREATE CAMPUS WALKING  
PATH

Location  
VA MEDICAL CENTER, ST. CLOUD, MN 56303

Date  
10/16/2012

Checked  
DJF

Drawn  
GMD

Project Number  
02212002

Building Number

Drawing Number  
C3.1

Dwg 13 of 24

