

three inches = one foot
one and one half inches = one foot
one inch = one foot
three quarters inch = one foot
one half inch = one foot
three eighths inch = one foot
one quarter inch = one foot
one eighth inch = one foot

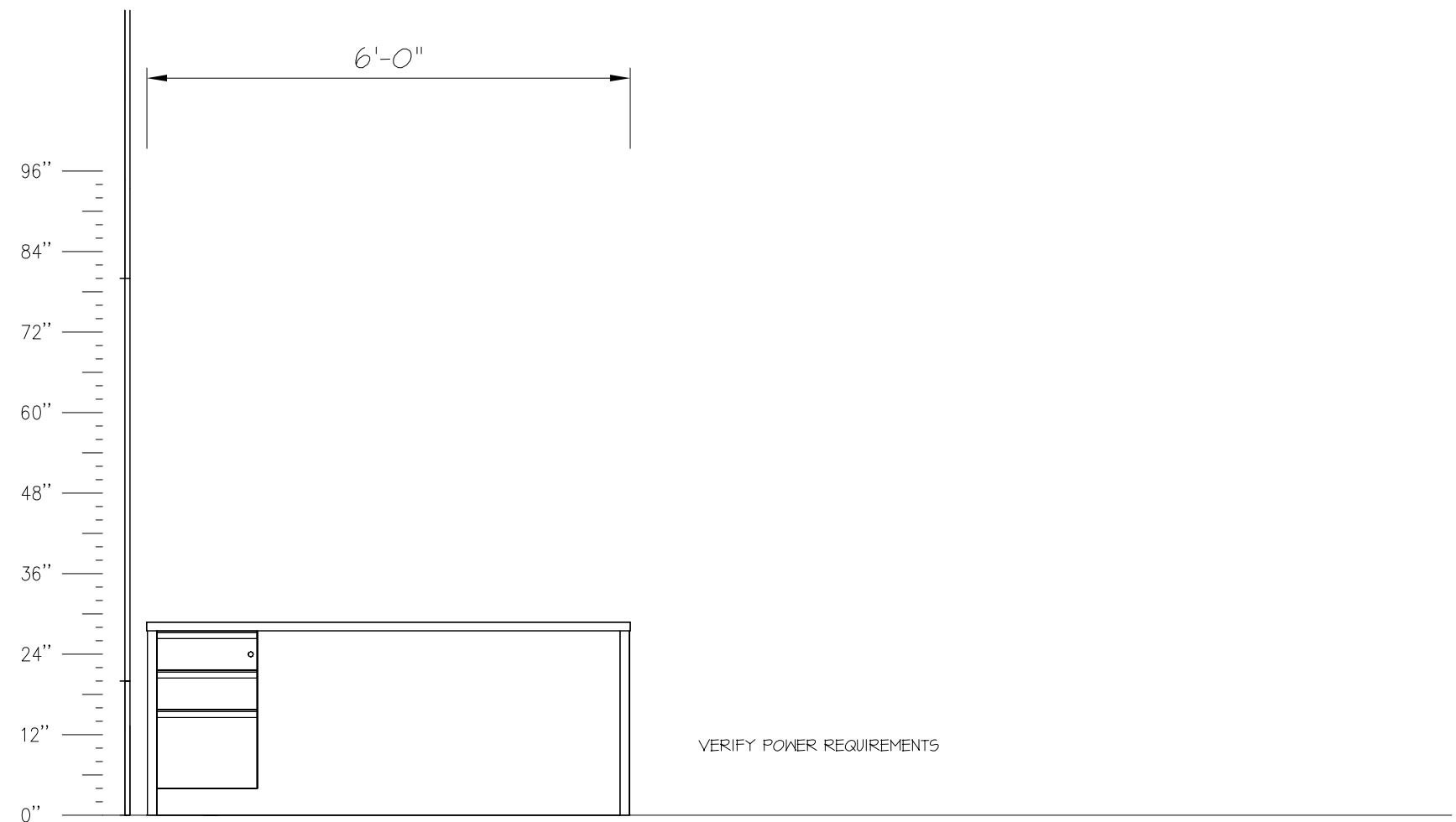

E1 OFFICE SPACE 110

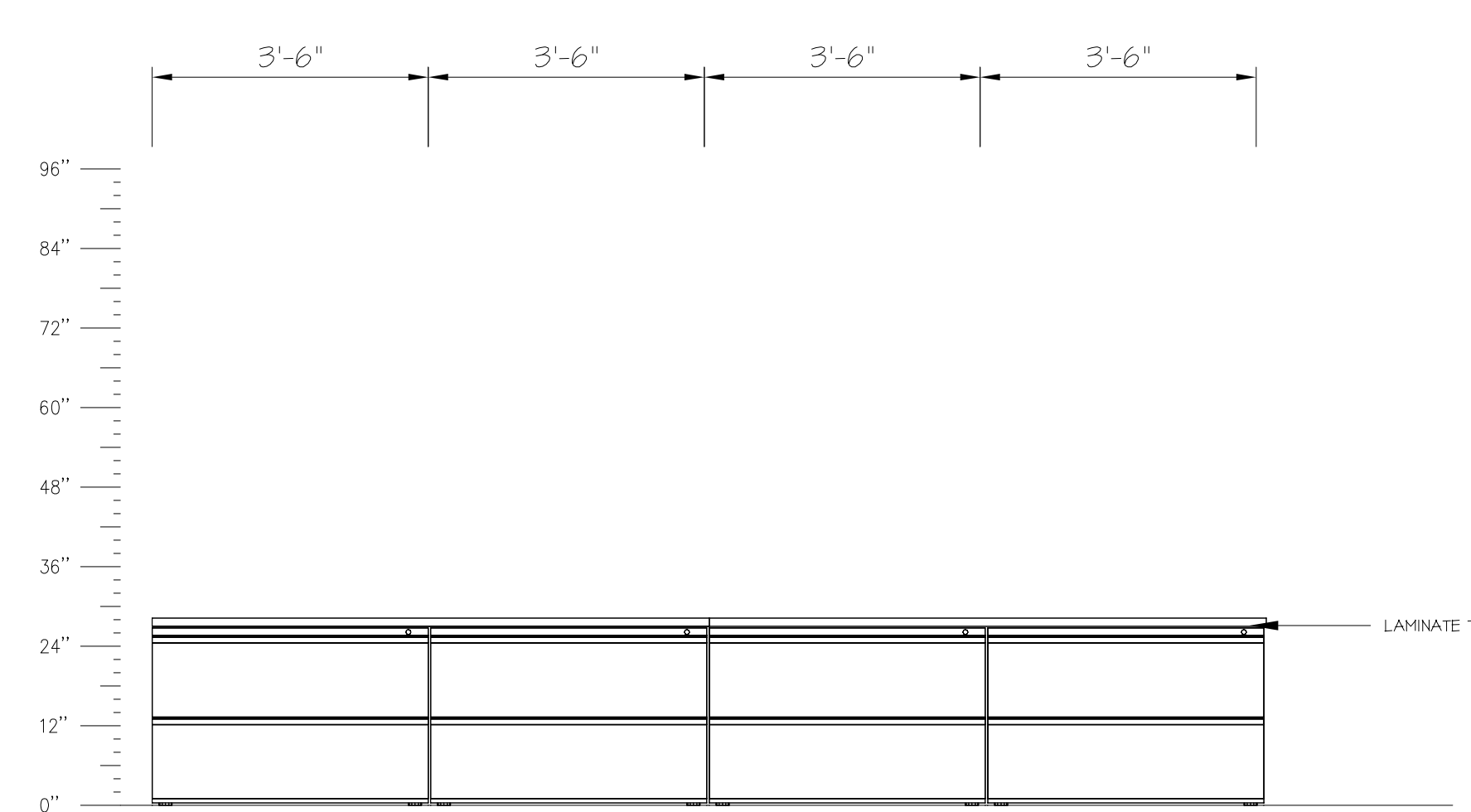

E2 OFFICE SPACE 110

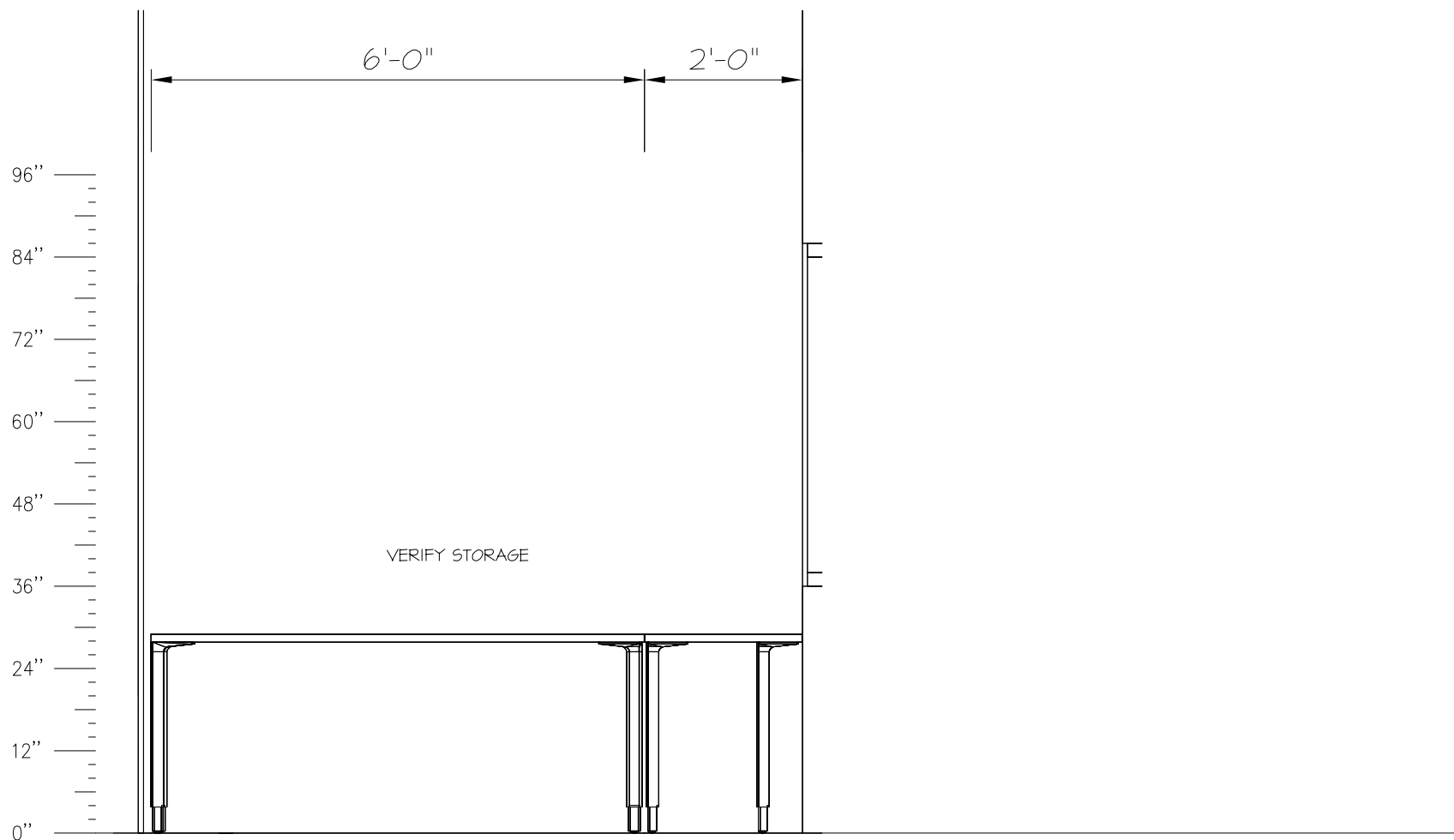

E3 COOK SUPER OFFICE 1100

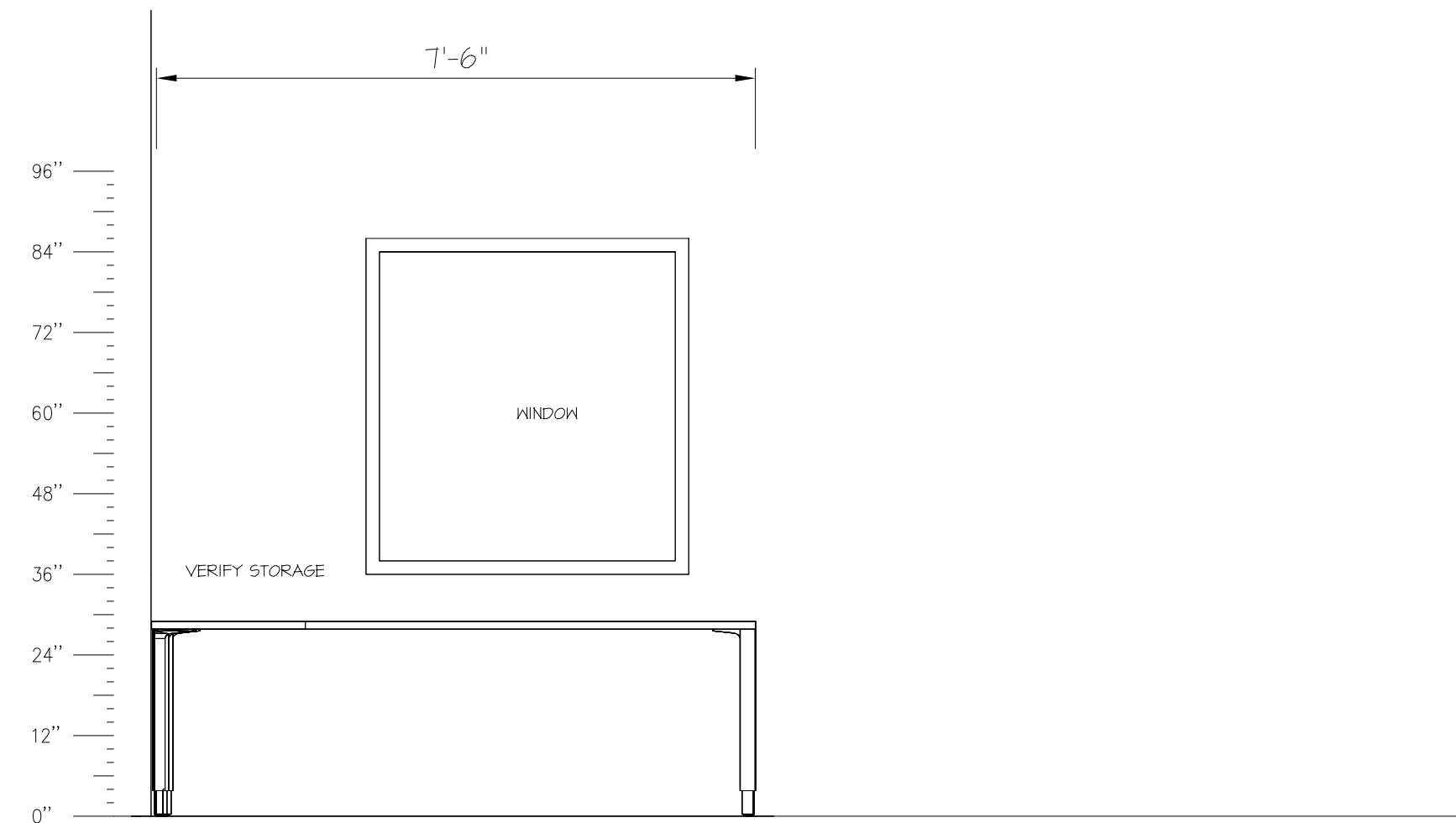

E4 COOK SUPER OFFICE 1100

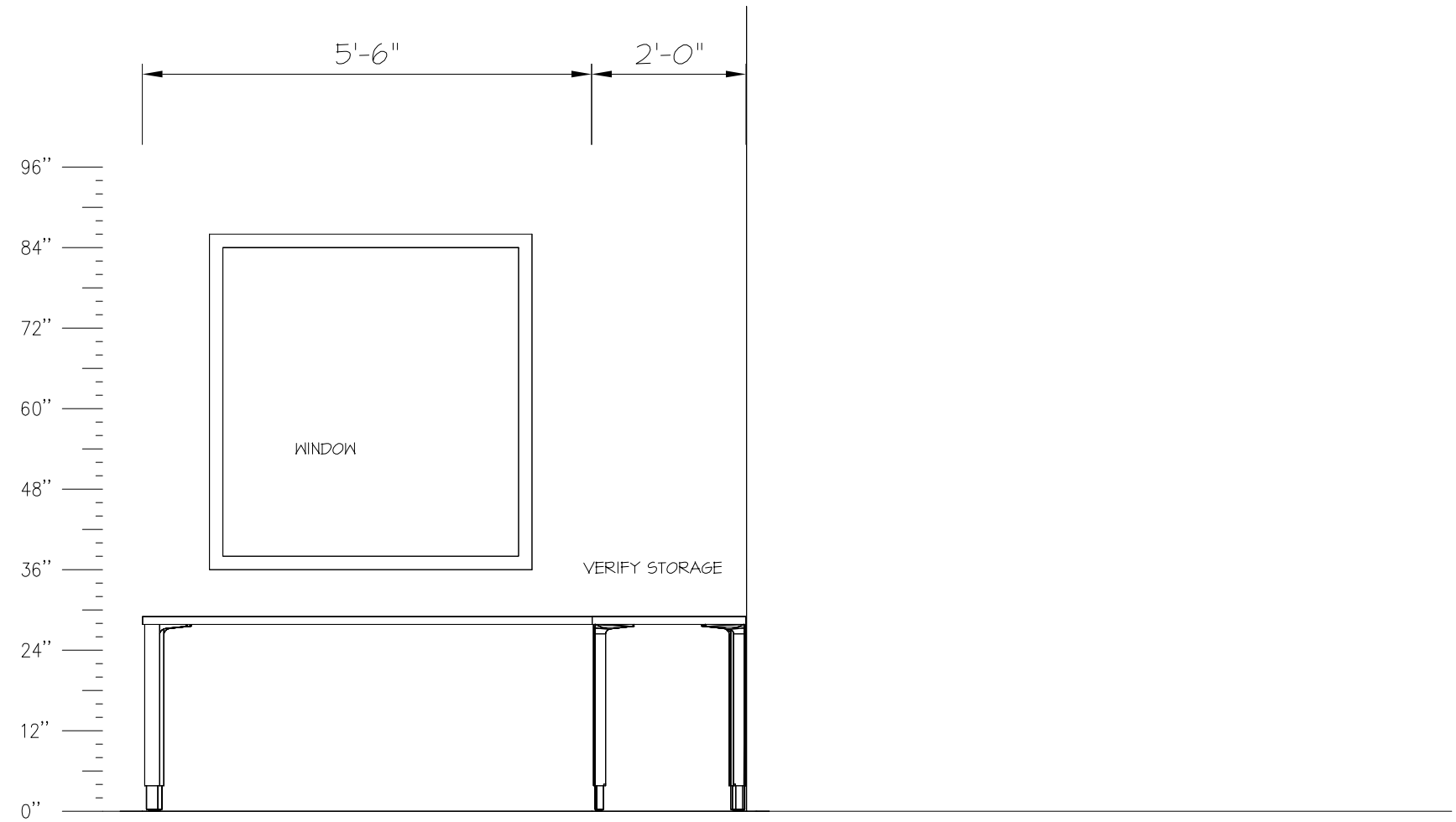

E5 PRODUCTION OFFICE 110A

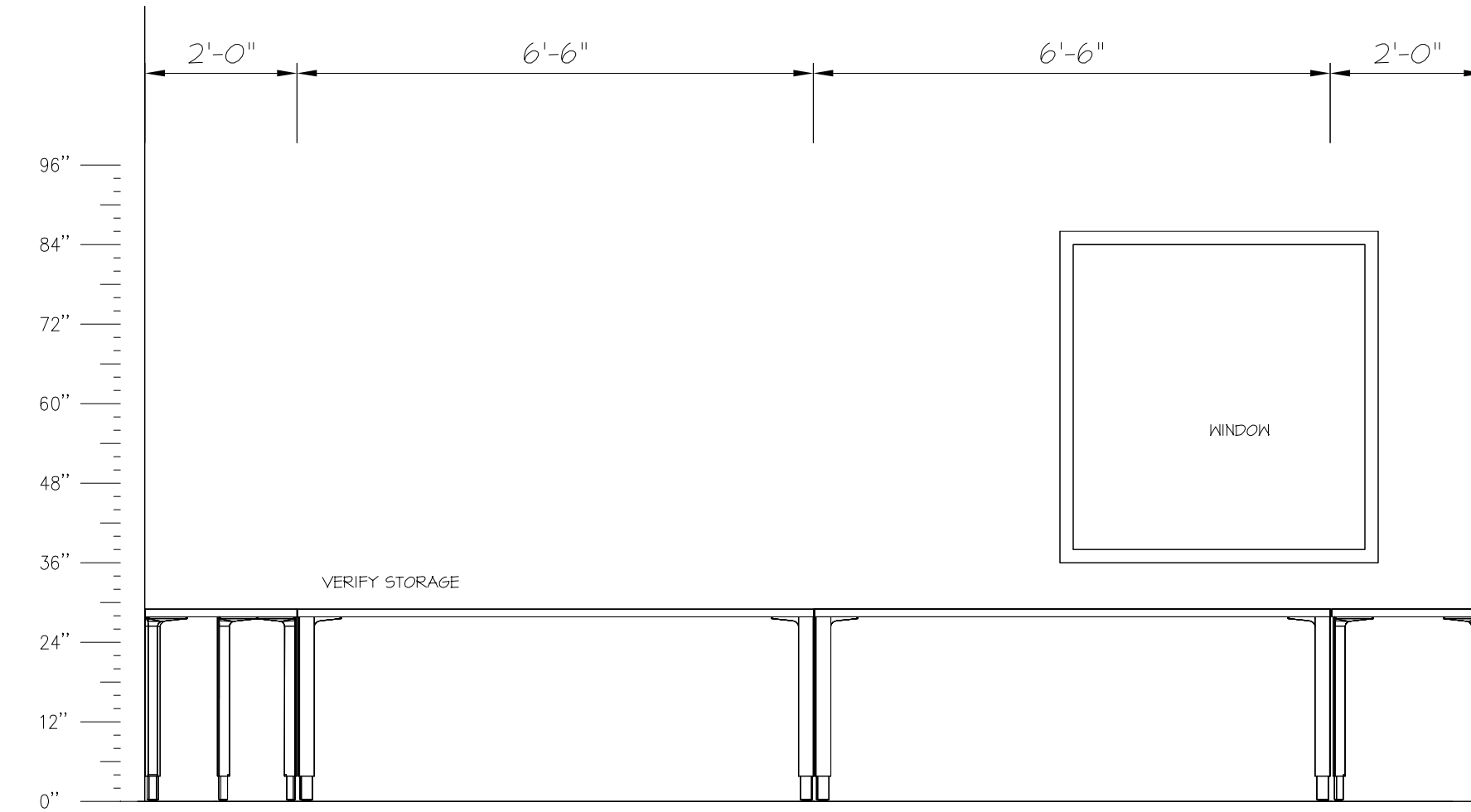

E6 PRODUCTION OFFICE 110A

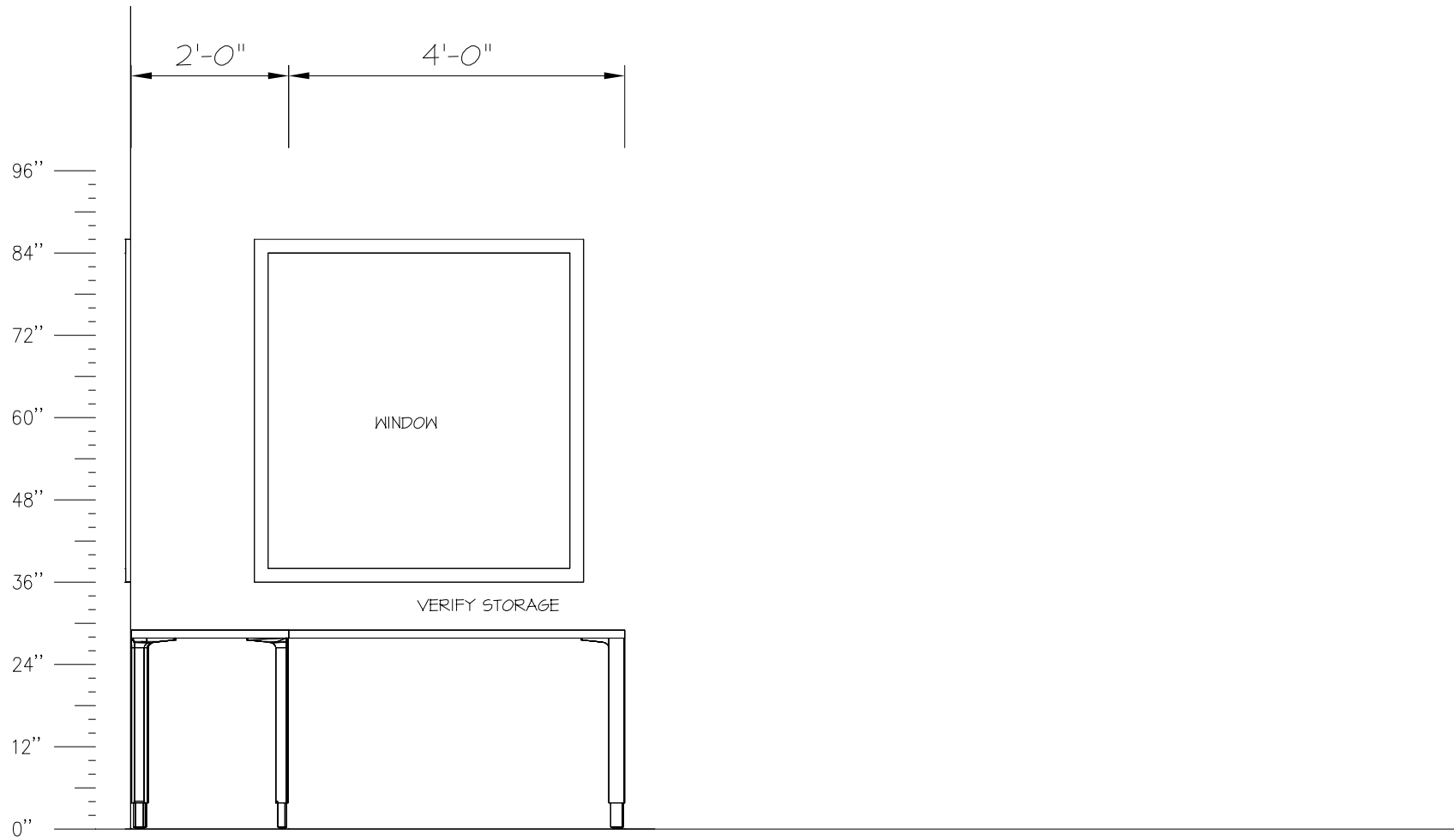

E7 PRODUCTION OFFICE 110A

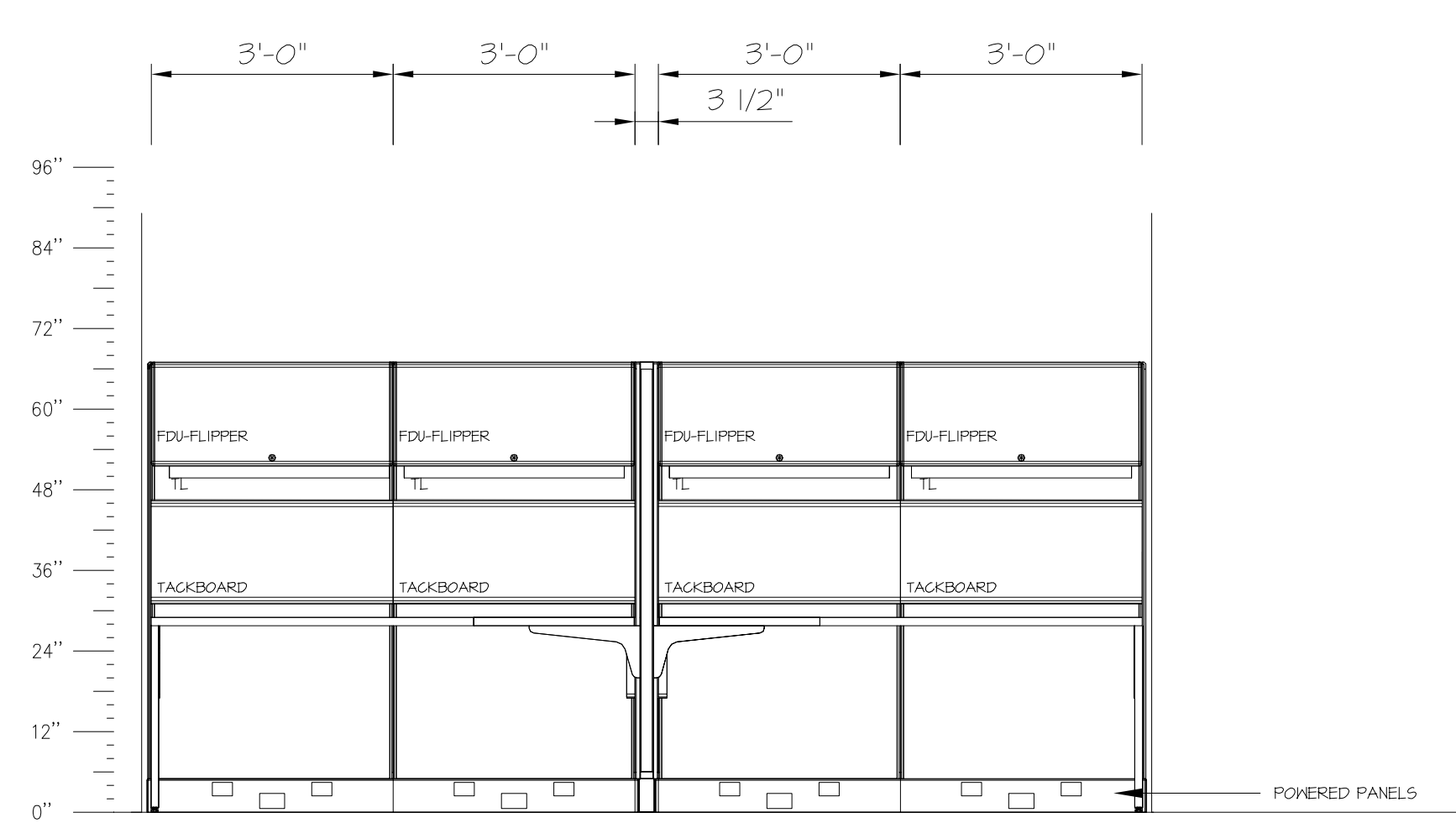

E8 CALL CENTER 121

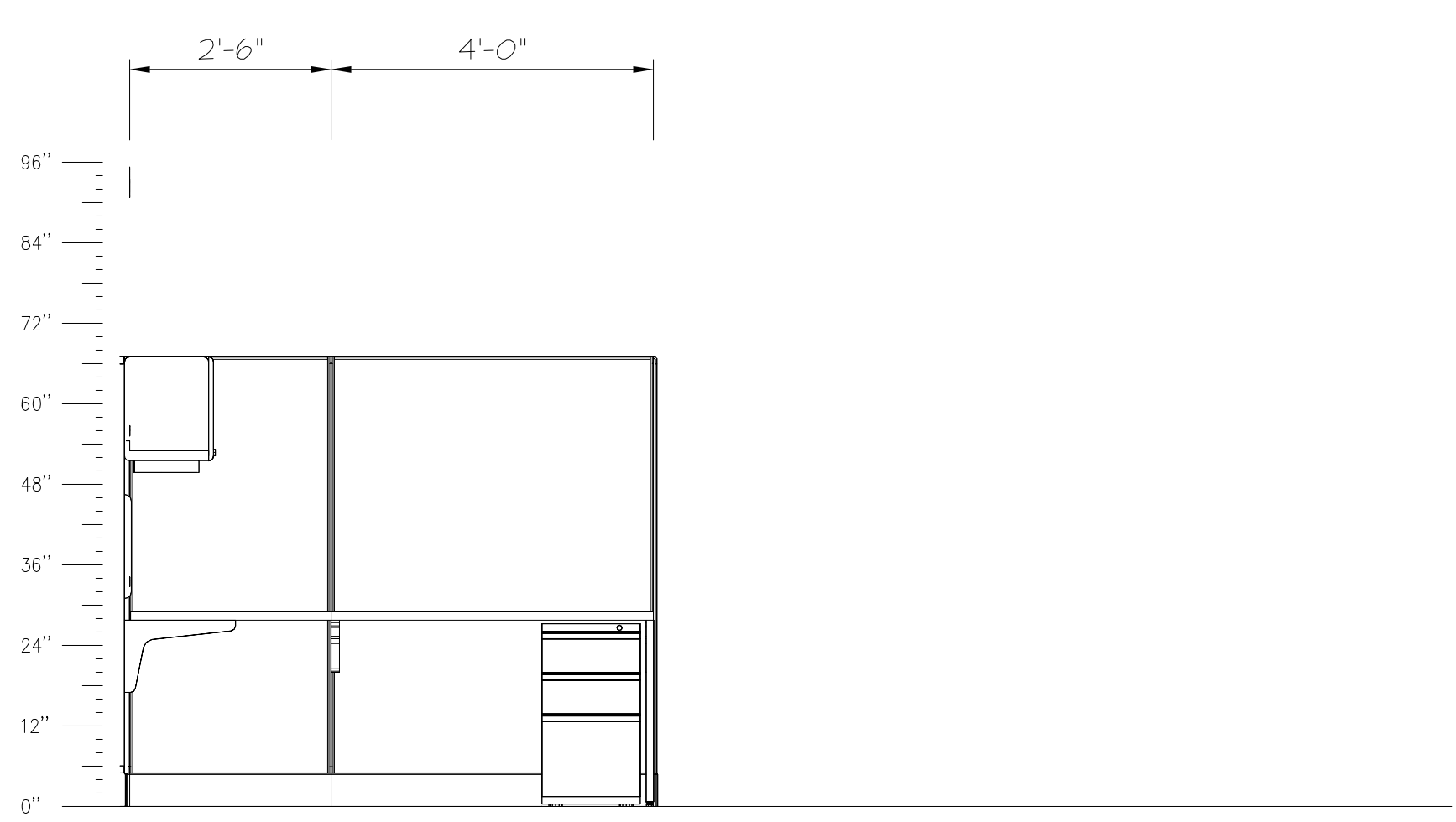

E9 CALL CENTER 121

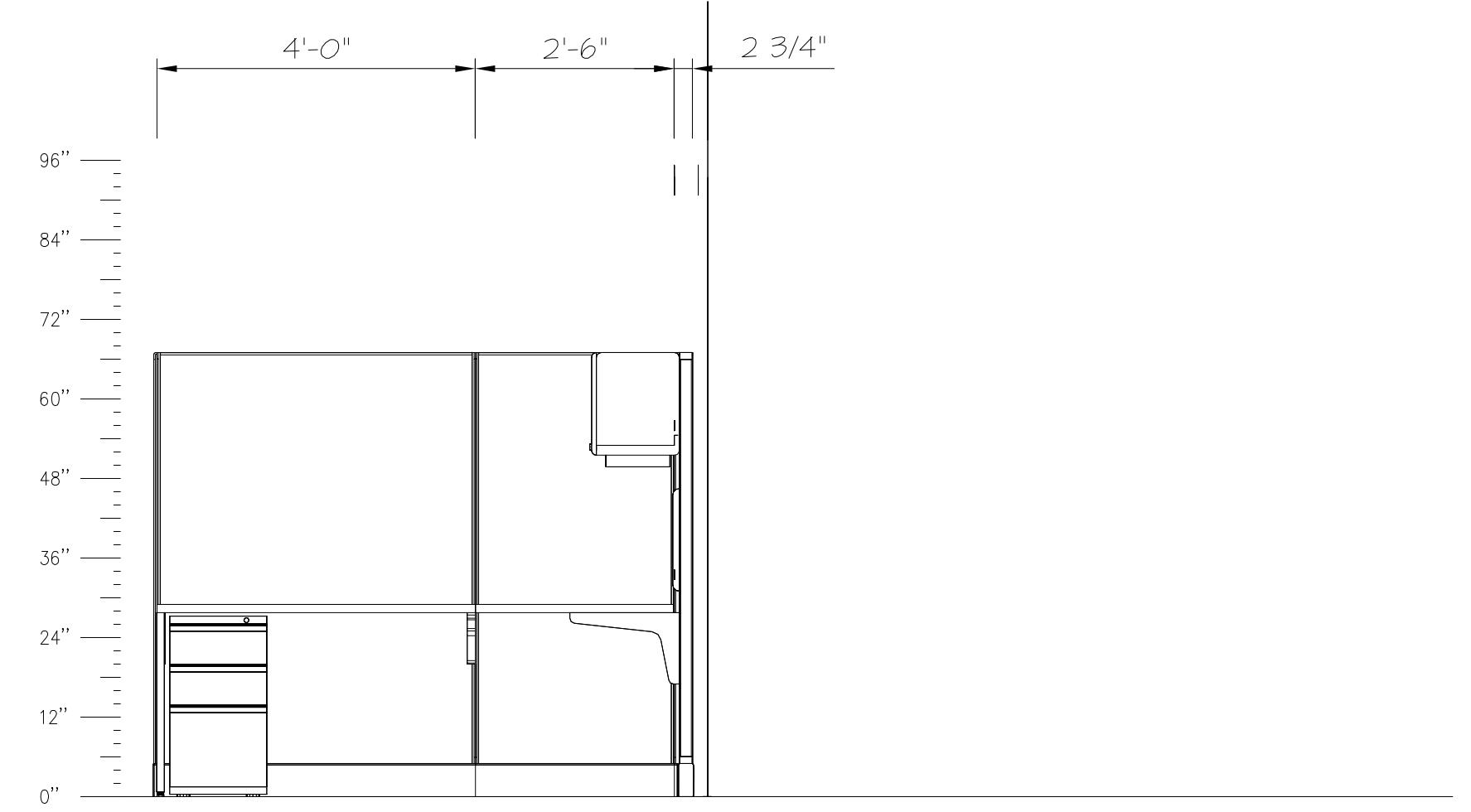

E10 CALL CENTER 121

FINAL BID DOCUMENTS	12-14-12
95% CONSTRUCTION DOCUMENT SUBMISSION	11-26-12
50% REVISED DOCUMENTS FOR REVIEW	11-19-12
90% CONSTRUCTION DOCUMENTS SUBMISSION	05-17-12
50% CONSTRUCTION DOCUMENTS SUBMISSION	04-06-12
35% DOCUMENTS SUBMISSION	02-22-12
SCHEMATIC DESIGN SUBMISSION	11-21-11
Revisions:	Date

Federal Health Care Center
U.S. Department of Veterans Affairs | U.S. Department of Defense

Captain James A. Lovell
Federal Health Care Center
3001 Green Bay Road
North Chicago, IL, 60064



CONSULTANTS:

ARNOLD & O'SHERIDAN
Consulting Engineers

CHEQUAMEGON BAY ENGINEERING, INC.

MACKESEY AND ASSOCIATES, LLC

PROJECT LEADER:

prarch
11000 West Park Place • Milwaukee WI 53224 • Tel 414 359-3060 • Fax 414 359-3070

Intelligent Designs **Inspired Results**
www.prarch.com
PRA Job No. 110172-01

Drawing Title
FURNITURE ELEVATIONS

Approved: Project Director

Project Title
AE SCIP for Building 6 FHCC

Location
North Chicago, IL

Date
December 14, 2012

Checked By:
KAO

Drawn By:
KJK

Project Number
556-11-119

Building Number
6

Drawing Number
IN-800

Office of Facilities Management

Department of Veterans Affairs

FINAL BID DOCUMENTS