

three inches = one foot
one and one half inch = one foot
one inch = one foot
three-quarters inch = one foot
one-half inch = one foot
three-eighths inch = one foot
one-quarter inch = one foot
one-eighth inch = one foot

GENERAL NOTES

- 1 THE CONTRACTOR SHALL NOTIFY "MISS UTILITY" AT (800) 257-7777, AND THE "VETERANS ADMINISTRATION" PROJECT ENGINEER (410) 842-2411, EXT. 5342 AT LEAST (7) DAYS PRIOR TO BEGINNING OF CONSTRUCTION. VETERANS ADMINISTRATION'S (VA) OWNED UTILITIES SHALL BE LOCATED AND MARKED BY "UNDERGROUND PROTECTION, INC" (410) 569-8989 UNDER THE DIRECTION OF THE CONTRACTOR. COST FOR LOCATING AND MARKING VA OWNED UTILITIES SHALL BE INCLUDED IN THE CONTRACTORS BID PRICE(S).
- 2 ALL CONSTRUCTION SHALL BE IN ACCORDANCE WITH THE STATE OCCUPATIONAL AND SAFETY LAW.
- 3 HORIZONTAL AND VERTICAL CONTROLS ARE BASED UPON AN ASSUMED COORDINATE SYSTEM AND DATUM WITH BOTH TIED TO THE VA MEDICAL CENTER MONUMENT COORDINATE SYSTEM AND DATUM. ELEVATIONS ARE REFERRED TO MEAN SEA LEVEL DATUM AS ESTABLISHED BY U.S.C. & G.S. B.M. "P-19" LOCATED ON THE FIRST STEPDOWN OF WEST END OF NORTH ABUTMENT OF PENNA R.R. BRIDGE OVER ROAD TO PERRY POINT. COORDINATES ARE PLANE COORDINATES AS ESTABLISHED BY U.S.C.&G.S. FOR THE STATE OF MARYLAND ARE BASED UPON TRIANGULATION STATION "PERRY".
"PERRY" N 625,427.03 E 1,068,770.55
- 4 CONTRACTOR SHALL PAY FOR ALL STAKING, RESTAKING, AND CUT SHEETS REQUIRED FOR THE PROPOSED CONSTRUCTION. ALL STAKE-OUT MUST BE DONE BY A REGISTERED LAND SURVEYOR OR PROFESSIONAL ENGINEER.
- 5 EXISTING UTILITIES ARE SHOWN FOR THE CONVENIENCE OF THE CONTRACTOR, BUT THE COMPLETION OR ACCURACY OF THE SAME IS IN NO WAY GUARANTEED. THE CONTRACTOR SHALL DETERMINE THE LOCATION AND ELEVATION OF EXISTING UTILITIES AT HIS OWN EXPENSE. THE CONTRACTOR SHALL BE RESPONSIBLE FOR ALL DAMAGES TO EXISTING UTILITIES DURING CONSTRUCTION. EXISTING UTILITIES ARE BASED ON SURVEY DRAWINGS PROVIDED BY VA'S ADMINISTRATION PERSONNEL.
- 6 ROADSIDE DRAINAGE DITCHES, CULVERTS, AND UNDERDRAINS, WHICH ARE DAMAGED OR DESTROYED BY CONSTRUCTION SHALL BE RESTORED TO A CONDITION AT LEAST EQUAL TO THAT PRIOR TO THE START OF CONSTRUCTION AT THE CONTRACTOR'S EXPENSE.
- 7 THE CONTRACTOR SHALL PROVIDE ALL NECESSARY SIGNING AND CONTROLS FOR PEDESTRIAN AND VEHICULAR TRAFFIC IN WORK AREAS FOR SAFETY AND TO MINIMIZE INTERRUPTION OF NORMAL ACTIVITY AS DIRECTED BY THE ENGINEER. THE CONTRACTOR SHALL REFER TO THE PROJECT SPECIFICATIONS AS WELL AS THE MARYLAND STATE HIGHWAY ADMINISTRATION SPECIFICATION AND STANDARD DETAILS, WHERE APPLICABLE, FOR ADDITIONAL REQUIREMENTS.
- 8 THE CONTRACTOR SHALL BE RESPONSIBLE FOR THE MAINTENANCE OF TRAFFIC AND TRAFFIC CONTROL DURING CONSTRUCTION.
- 9 THE CONTRACTOR SHALL TAKE ALL THE NECESSARY PRECAUTIONS TO PROTECT EXISTING TREES. NO TREE SHALL BE REMOVED, UNLESS SPECIFICALLY APPROVED IN WRITING BY THE ENGINEER PRIOR TO ANY REMOVAL OPERATIONS.
- 10 THE CONTRACTOR MUST OBTAIN WRITTEN APPROVAL FROM THE RESIDENT ENGINEER PRIOR TO PERFORMING ANY WORK ON SATURDAYS, SUNDAYS, OR FEDERAL HOLIDAYS.
- 11 CONTRACTOR SHALL COORDINATE WITH RESIDENT ENGINEER EXACT LIMITS OF SIDEWALK, CURB AND GUTTER TO BE REPLACED PRIOR TO START OF WORK. QUANTITIES SHALL BE AGREED UPON PRIOR TO START OF WORK.
- 12 THE CONTRACTOR SHALL MATCH ADJACENT SIDEWALKS OR CURB & GUTTER FOR LINE AND GRADE. CONTRACTOR SHALL WARP PAVING AS NECESSARY TO ENSURE POSITIVE DRAINAGE.
- 13 THE CONTRACTOR SHALL ADJUST ALL NEW AND EXISTING UTILITY BOXES, MANHOLES, ETC., WHICH ARE TO REMAIN TO CONFORM TO FINAL GRADE.
- 14 THE CONTRACTOR SHALL RESTORE ALL EXISTING FEATURES AFFECTED BY THE CONSTRUCTION TO MATCH ORIGINAL CONDITIONS, INCLUDING, BUT NOT LIMITED TO: CURBS, SIDEWALKS, PAVING, STRUCTURES, TURF, SIGNS, GRAVEL, PARKING, PARKING BLOCKS, RAILINGS, ETC. CONTRACTOR SHALL RESTORE ALL AREAS DISTURBED BY THEIR WORK ACTIVITY. THIS INCLUDES REGRADING OF GROUND ADJACENT TO WORK AREAS WHERE TIRE RUTS HAVE BEEN GENERATED. SEEDING AND SOIL STABILIZATION WILL BE REQUIRED IN REGRADED AREAS.
- 15 ANY DAMAGE TO EXISTING VA PROPERTY FROM CONTRACTOR ACTIVITIES SHALL BE RESTORED BY CONTRACTOR AT NO ADDITIONAL COST TO THE VA. THIS INCLUDES (BUT IS NOT LIMITED TO): REPAIRING CHIPPED CURB & GUTTER OR OTHER CONCRETE FEATURES CRACKED BY CONTRACTOR EQUIPMENT; FILLING IN RUTS IN ADJACENT GRASSY AREAS CAUSED BY CONTRACTOR EQUIPMENT OR VEHICLES; REPLANTING GRASS DAMAGED BY VEHICULAR TRAFFIC, ETC.

BID QUANTITIES*		
ITEM DESCRIPTION	TOTAL QTY.	
CONCRETE CURB & GUTTER, SHA TYPE 'D'	3850 LF	
CONCRETE H.C. RAMP w/ TACTILE WARNING STRIP	14 EA	
4" CONCRETE SIDEWALK	17960 SF	

*NOTE: BID QUANTITIES ARE PROVIDED FOR CONTRACTOR'S INFORMATION ONLY AND ARE IN NO WAY INTENDED TO LIMIT SCOPE OF WORK. CONTRACTOR MUST FIELD VERIFY QUANTITIES TO THEIR SATISFACTION.

INDEX OF DRAWINGS	
SHEET No.	DRAWING TITLE
SW-01	TITLE SHEET
SW-02	PLAN SHEET
SW-03	PLAN SHEET
SW-04	DETAIL SHEET - CONCRETE CURBS & SIDEWALKS
SW-05	DETAIL SHEET - EROSION AND SEDIMENT CONTROL DETAILS AND NOTES

MISCELLANEOUS ISOLATED
SIDEWALK, CURB & GUTTER
REPAIRS
512-11-337

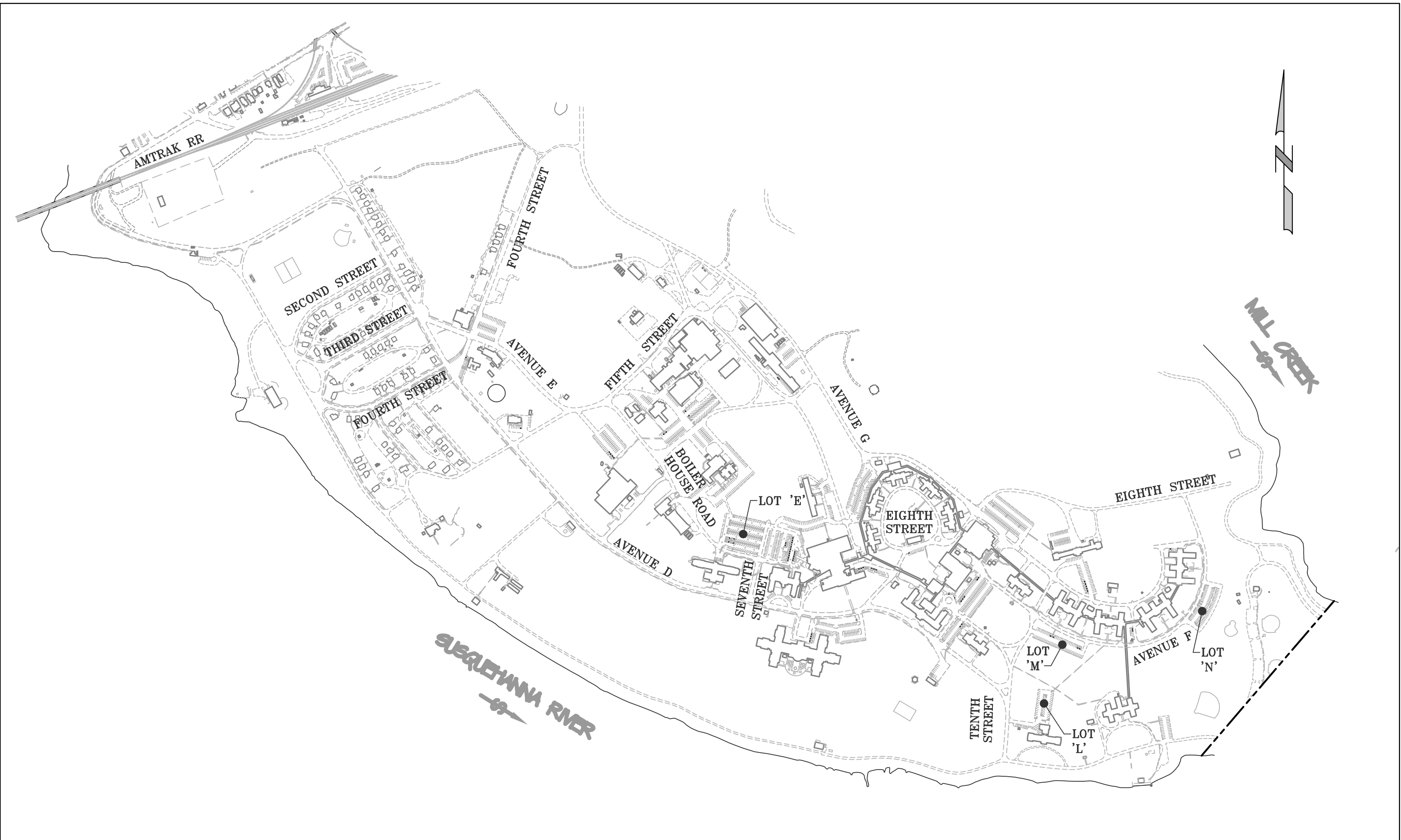

SITE MAP
SCALE: 1"=500'

DEPARTMENT OF VETERANS AFFAIRS
MARYLAND HEALTH CARE CENTER
PERRY POINT MEDICAL CENTER
PERRY POINT, MD 21902

Additions:	Date:			Approved:	Approved: Chief, Facilities and Engineering:	Drawing Title: TITLE SHEET	Project Title: MISC. ISOLATED SIDEWALK, CURB AND, GUTTER REPAIRS	Date: AUGUST 7, 2012
					Approved: Associate Chief for Maintenance And Operations, Perry Point:			Project No: 512-11-337
Revisions:					Approved: Engineering Projects Supervisor	Approved: Associate Director for Operations:	Scale: 1"=500'	Building No: N/A
					Approved: Infection Control Officer	Approved: Director, Medical Center:	Checked: MHD	Drawn: MHD/MOH
						Location: VAMHCS PERRY POINT, MD 21902		DRAWING NO: SW-01 OF 5