

VAMC FRESNO - SITE IRRIGATION AND LANDSCAPE IMPROVEMENTS

PROJECT DATA

SITE ADDRESS:
VA CENTRAL CALIFORNIA HEALTH CARE SYSTEM
2615 E. CLINTON AVE.
FRESNO, CA 93703-2286
(559) 255-6100

APPLICABLE CODES

VA SITE DESIGN MANUAL & CONTRACT SPECIFICATIONS
UNIFORM FEDERAL ACCESSIBILITY STANDARDS (UFAS)
CBC 2010
CFC 2010
NEC 2010
NFPA

PROJECT TEAM

ARCHITECT/ENGINEER OF RECORD
(ARCHITECTURAL, CIVIL, STRUCTURAL)
PAULI ENGINEERING, INC.
2501 W. SHAW AVE, STE 121
FRESNO, CA 93711
(559) 237-4408

LANDSCAPE ARCHITECT
SAITO ASSOCIATES
2804 N. BLACKSTONE AVE.
FRESNO, CA 93703
(559) 227-5494

SCOPE OF WORK SUMMARY:

- DEMOLISH AND REMOVE EXISTING LANDSCAPING MATERIAL, IRRIGATION DISTRIBUTION LINES, AND IRRIGATION CONTROL WIRING AND VALVES AS SHOWN ON PLANS
- INSTALL LANDSCAPE PLANTING AS SHOWN ON PLANS.
- BUILD PLANTERS WALL AND EDGING AS SHOWN ON PLANS
- BUILD IRRIGATION DISTRIBUTION SYSTEM AS SHOWN ON PLANS.
- CONNECT ALL (N) VALVES TO (E) 2 WIRE IRRIGATION CONTROL SYSTEM
- PROGRAM AUTOMATIC IRRIGATION CONTROL AS SHOWN ON PLANS
- BUILD RETAINING WALL ALONG NORTH SIDE OF BUILDING #24
- BUILD NEW EARTH BERMS ALONG CLINTON AVE.
- RAISE SIGN AT CLINTON AVE. ENTRANCE.

NOTE: THIS SCOPE OF WORK SUMMARY IS INTENDED TO PROVIDE AN OVERVIEW OF THE WORK TO BE COMPLETED. CONTRACTOR SHALL REFER TO PLANS AND SPECIFICATIONS FOR ADDITIONAL INFORMATION AND COMPLETE SCOPE OF WORK.

ACRONYMS/ABBREVIATIONS:

CBC: CALIFORNIA BUILDING CODE
CFC: CALIFORNIA PLUMBING CODE
CFC: CALIFORNIA FIRE CODE
NEC: NATIONAL ELECTRIC CODE
NFPA: NATIONAL FIRE PROTECTION ASSOCIATION
A/E: ARCHITECT-ENGINEER FIRM
COC: CONTRACTING OFFICER
COR: CONTRACTING OFFICERS REPRESENTATIVE
S.O.W.: SCOPE OF WORK
U.N.O.: UNLESS NOTED OTHERWISE
N.T.P.: NOTICE TO PROCEED

CONSTRUCTION CONTRACT SPECIFICATIONS:

IT IS THE CONTRACTOR'S RESPONSIBILITY TO READ AND UNDERSTAND THE PROVIDED CONTRACT SPECIFICATIONS BEFORE COMMENCING ANY WORK.

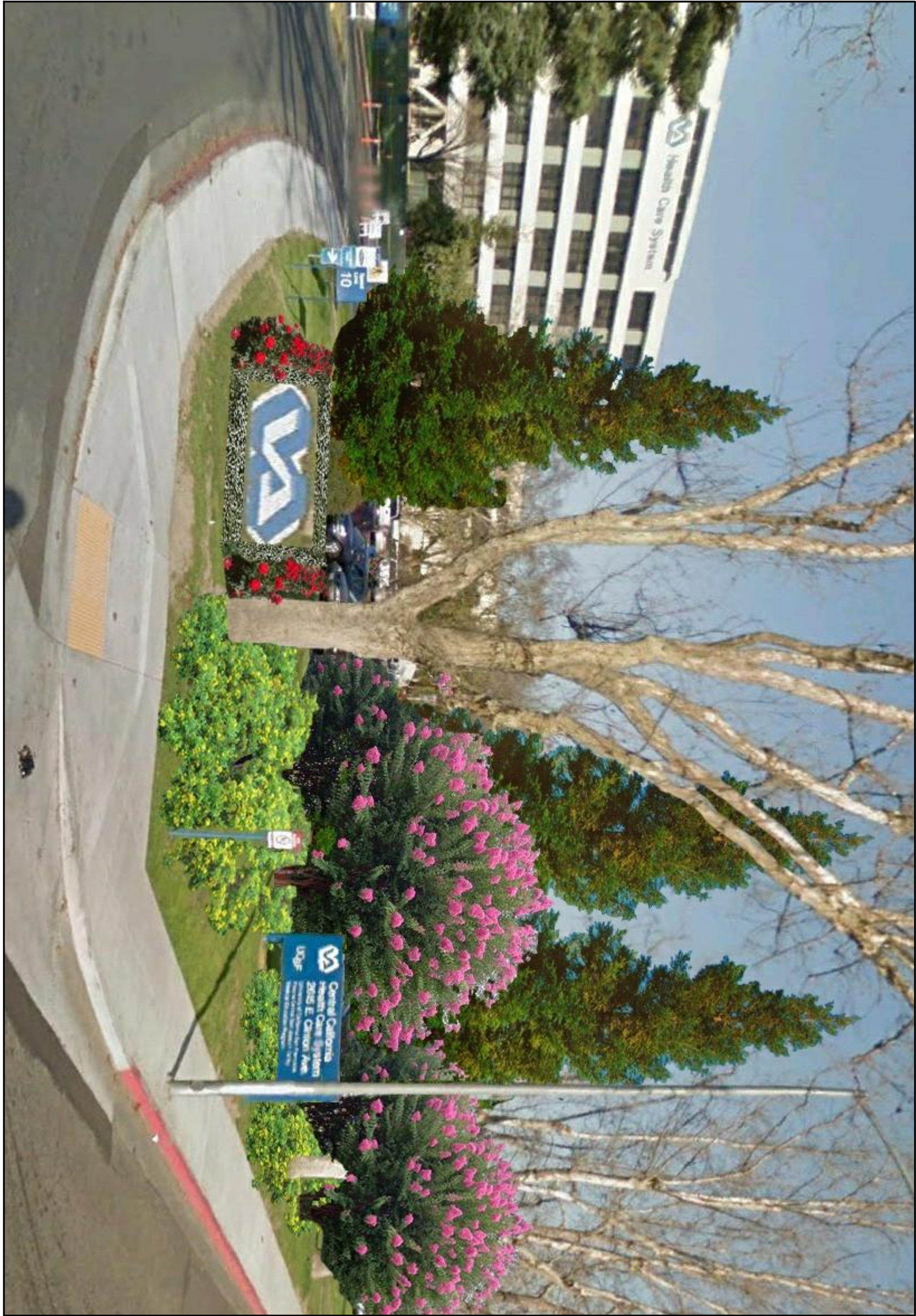

SCHEMATIC REPRESENTATION ONLY

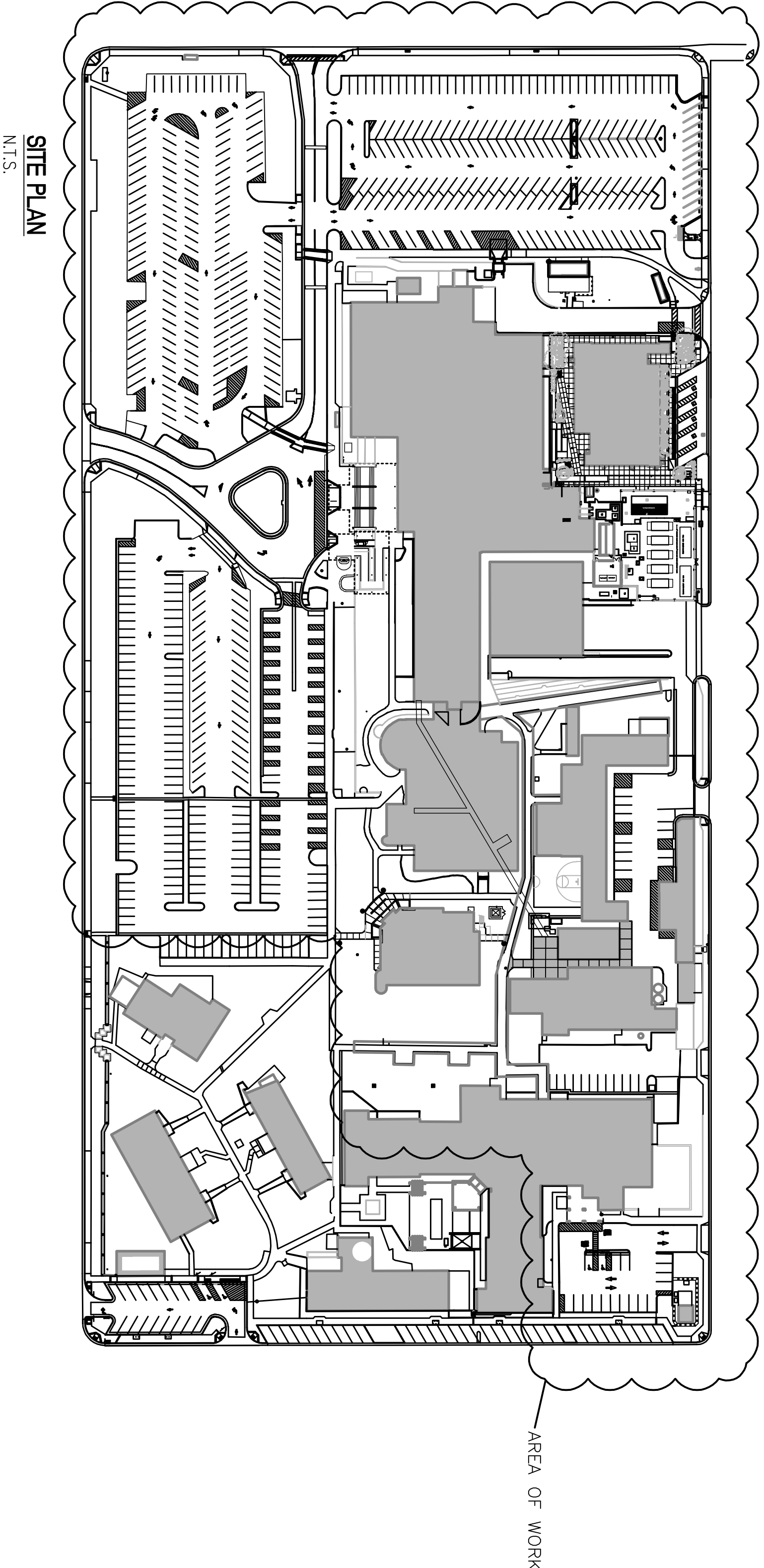

GENERAL INDEX TO SHEETS

- | | |
|-------|--|
| GI001 | COVER SHEET |
| GI002 | CONSTRUCTION NOTES |
| CD100 | DEMOLITION PLAN |
| CD101 | EXISTING MAIN IRRIGATION SYSTEM LAYOUT |
| CL001 | PROPOSED MAIN IRRIGATION SYSTEM LAYOUT |
| CL100 | LANDSCAPE REFERENCES |
| CL101 | PROPOSED LANDSCAPE |
| CL102 | PROPOSED LANDSCAPE |
| CL103 | BERMS AND PLANTER |
| CL104 | BERMS AND PLANTER |
| CL105 | IRRIGATION PLAN |
| CL106 | IRRIGATION PLAN |
| CL107 | IRRIGATION PLAN |
| CL108 | IRRIGATION NOTES & IRRIGATION SCHEDULE |
| CS501 | SECTION AND DETAILS |
| CS502 | SECTION AND DETAILS |
| CS503 | SECTION AND DETAILS |
| CS504 | SECTION AND DETAILS |
| CS505 | DETAILS |
| CS506 | DRIP IRRIGATION DETAILS |
| X100 | PHASING PLAN |

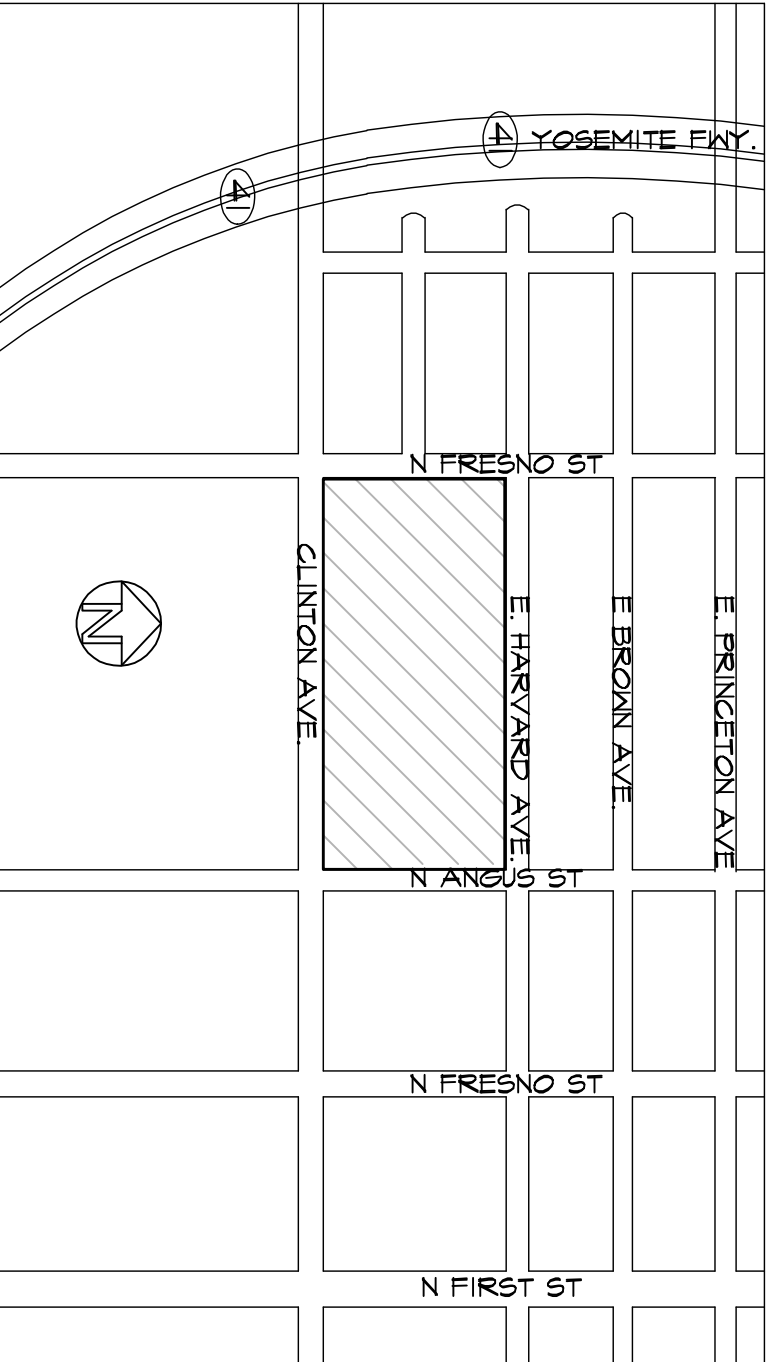

100% SUBMITAL - FOR CONSTRUCTION

CONSULTANTS:		ARCHITECTS/ENGINEERS:		Drawing Title	
		PAULI ENGINEERING, INC. 2501 W. SHAW AVE., #121, FRESNO, CA 93711 PH: (559)237-4408 - FAX: (559)237-4404 E-MAIL: pauliengineering@csccglobal.net www.pauliengineering.com		COVER SHEET	
		Approved Project Director		Project Title	
		Location		SITE IRRIGATION AND LANDSCAPE IMPROVEMENTS	
		2615 E. Clinton Ave, Fresno, CA		Project Number	
		10/2008		570-12-200	
		Checked		Building Number	
		Drawn		CA/MFUS	
		Dwg		Drawing Number	
		GI001		GI001	
		Date		Office of Construction and Facilities Management	
		10/2008		Department of Veterans Affairs	

