

one eighth inch = one foot

one quarter inch = one foot

three eighths inch = one foot

one half inch = one foot

three quarters inch = one foot

one inch = one foot

one and one half inches = one foot

three inches = one foot

Revisions	Date

CONSULTANTS:

ARCHITECT/ENGINEERS:

PAULI ENGINEERING, INC.
2501 N. SHAN AVE., #21, FRESNO, CA 93711
PH: (559)237-4408 - FAX: (559)237-4404
E-MAIL: pauliengineering@comcast.net
www.pauliengineering.com

PHASING PLAN

SITE IRRIGATION AND
LANDSCAPE IMPROVEMENTS

Location
2615 E Clinton Ave, Fresno, CA

Date
1/3/2018

Dwg
X100

Office of
Construction
and Facilities
Management
Department of
Veterans Affairs

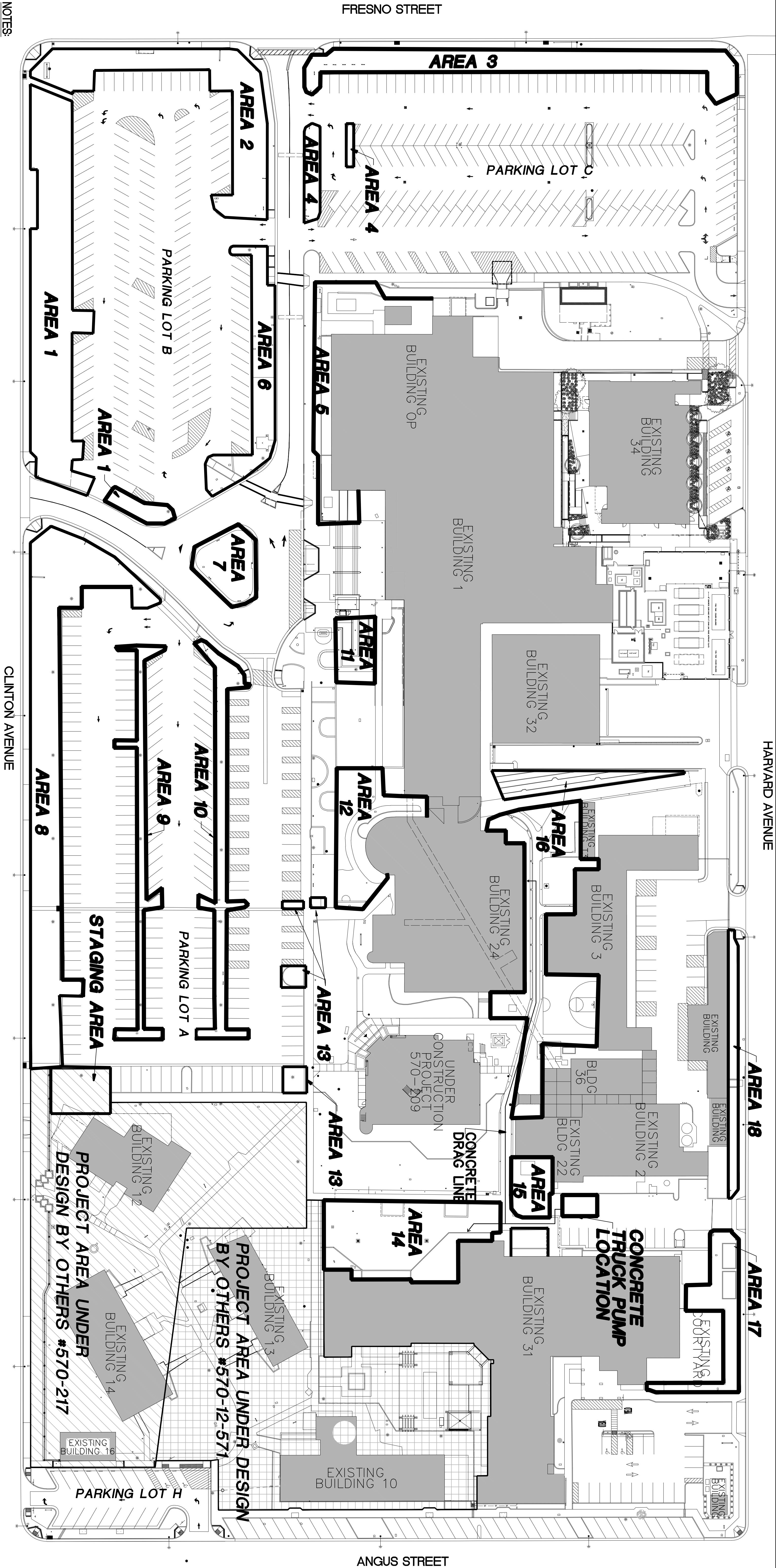

NOTES:

- EXECUTE WORK AS TO MINIMIZE INTERFERENCE WITH THE NORMAL FUNCTIONS OF THE MEDICAL CENTER AS A WHOLE, INCLUDING OPERATIONS OF UTILITY SERVICES, FIRE PROTECTION SYSTEMS, ANY EXISTING EQUIPMENT, AND WITH WORK BEING DONE BY OTHERS. .
- DO NOT STORE MATERIALS AND EQUIPMENT ANYWHERE OTHER THAN ASSIGNED AREAS.
- SCHEDULE DELIVERY OF MATERIALS AND EQUIPMENT TO IMMEDIATE CONSTRUCTION WORKING AREAS IN QUANTITIES SUFFICIENT FOR WORK IN THAT AREA. PROVIDE UNOBSTRUCTED ACCESS TO MEDICAL CENTER AREAS REQUIRED TO REMAIN IN OPERATION. MATERIALS DELIVERY AND FENCE INSTALLATION SHALL OCCUR DURING NON-REGULAR HOURS OR WITHOUT OBSTRUCTING PEDESTRIAN AND VEHICULAR TRAFFIC.
- PHASING: THE CONTRACTOR SHALL FURNISH THE VA COR WITH A SCHEDULE OF APPROXIMATE PHASING DATES ON WHICH THE CONTRACTOR INTENDS TO ACCOMPLISH WORK IN EACH SPECIFIC AREA OF SITE. IN ADDITION, CONTRACTOR SHALL NOTIFY THE VA COR TWO WEEKS IN ADVANCE OF THE PROPOSED DATE OF STARTING WORK IN EACH SPECIFIC AREA OF SITE. ARRANGE SUCH PHASING DATES AND CONSTRUCTION ACCORDANCE WITH THIS WORK IN SUCCESSIVE PHASES MUTUALLY AGREEABLE TO MEDICAL CENTER DIRECTOR, VA COR AND CONTRACTOR. CONTRACTOR TO PHASE THE PROJECT IN SUCH A WAY THAT CAUSES THE LEAST IMPACT TO THE NORMAL OPERATION OF THE FACILITY.
- FACILITY IS CURRENTLY SHORT IN PARKING STATUS. CONTRACTOR SHALL SCHEDULE WORK SUCH THAT TEMPORARY FENCES ENCLOSING THE AREAS SELECTED SHALL NOT OCCUPY MORE THAN 10 TOTAL PARKING SPOTS AT A TIME
- CONTRACTOR SHALL START AND COMPLETE WORK ON AREAS 7, 9, 10 & 11 DURING NON-REGULAR WORKING HOURS AS DIRECTED BY THE VA COR AT NO EXTRA COST TO THE VA
- CONTRACTOR MAY WORK ON AREAS 1, 2, 3, 17 & 18 APPROACHING FROM THE STREET, SINCE PARTIAL STREET ENCROACHMENT AND TRAFFIC OBSTRUCTION MAY BE NECESSARY, THE CONTRACTOR SHALL NOTIFY AND COORDINATE WITH THE CITY OF FRESNO WHEN WORKING IN THESE AREAS. ANY FEES REQUIRED BY THE CITY OF FRESNO SHALL BE PAID BY THE CONTRACTOR AT NO EXTRA COST TO THE VA. CONTRACTOR IS RESPONSIBLE FOR PROTECTING CURB, GUTTERS, AND SIDEWALK AND REPAIRING THEM IF DAMAGED DURING CONSTRUCTION AT NO EXTRA COST TO THE VA
- FRESNO STREET PARTIAL ENCROACHMENT MAY BE NECESSARY WHEN REMOVING TREES WITHIN AREA 2 AND 3. IT IS THE CONTRACTOR'S RESPONSIBILITY TO NOTIFY THE CITY OF FRESNO AND PAY ANY FEES REQUIRED BY THE CITY AT NO EXTRA COST TO THE VA
- DELIVERY OF MATERIALS SHALL BE SCHEDULED DURING NON-REGULAR WORKING HOURS. SPECIALLY FILL MATERIAL FOR THE CONSTRUCTION OF THE BERMS.
- THE CONTRACTOR SHALL SUBMIT SPECIFICATIONS OF MATERIAL AND PRODUCTS TO BE USED 30 DAYS BEFORE PURCHASING OR INSTALLING SAID PRODUCTS AND MATERIALS
- IT IS THE GENERAL CONTRACTOR'S RESPONSIBILITY TO DEVELOP A DETAILED PROJECT SCHEDULE TO BE COORDINATED WITH THE CONTRACTING OFFICER TECHNICAL REPRESENTATIVE. WORK MUST BE COMPLETED WITHIN PERIOD OF TIME STATED WITHIN THE CONTRACT.
- CONTRACTOR TO PROVIDE BARRICADES AND RE-ROUTE SIGNAGE FOR TRAFFIC CONTROL. SEE SHEET 61002 FOR CONSTRUCTION SIGNAGE
- CONTRACTOR IS REQUIRED TO START THE PROJECT AT AREA 14, IRRIGATION AND LANDSCAPE WORK SHALL NOT BE STARTED ON OTHER AREAS UNTIL WORK ON AREA 14 IS COMPLETED TO THE VA COR'S SATISFACTION

100% SUBMITTAL - FOR CONSTRUCTION