

1. MEASUREMENTS SHOWN ARE FOR BID PURPOSES ONLY AND MUST BE FIELD VERIFIED PRIOR TO MANUFACTURE
2. INSTALL 4' X 4' SQUARE RESILIENT VINYL SHEETS BEHIND EACH PATIENT BED. ANY ROOM ON THIS FLOOR LABELED "HOSPICE" OR "ISOLATION ROOM" WILL NOT RECEIVE A VINYL SHEET.
3. FOR SPECIFIC CRASH RAIL, CORNER GUARD, RESILIENT VINYL SHEET, AND DOOR FRAME GUARDS INFORMATION REFER TO PROJECT SPECIFICATIONS
4. ROUGHLY 50% OF WALL GUARDS SHOWN ARE REPLACEMENTS, REMOVE AND REINSTALL. ANY DAMAGE TO PAINT OR OTHER FINISHES SHALL BE RETURN TO AT LEAST EQUAL OF ORIGINAL QUALITY.
5. DRAWINGS ARE NOT TO SCALE. IF SPECIFIC MEASUREMENTS ARE REQUIRED, UTILIZE GRAPHIC SCALE.

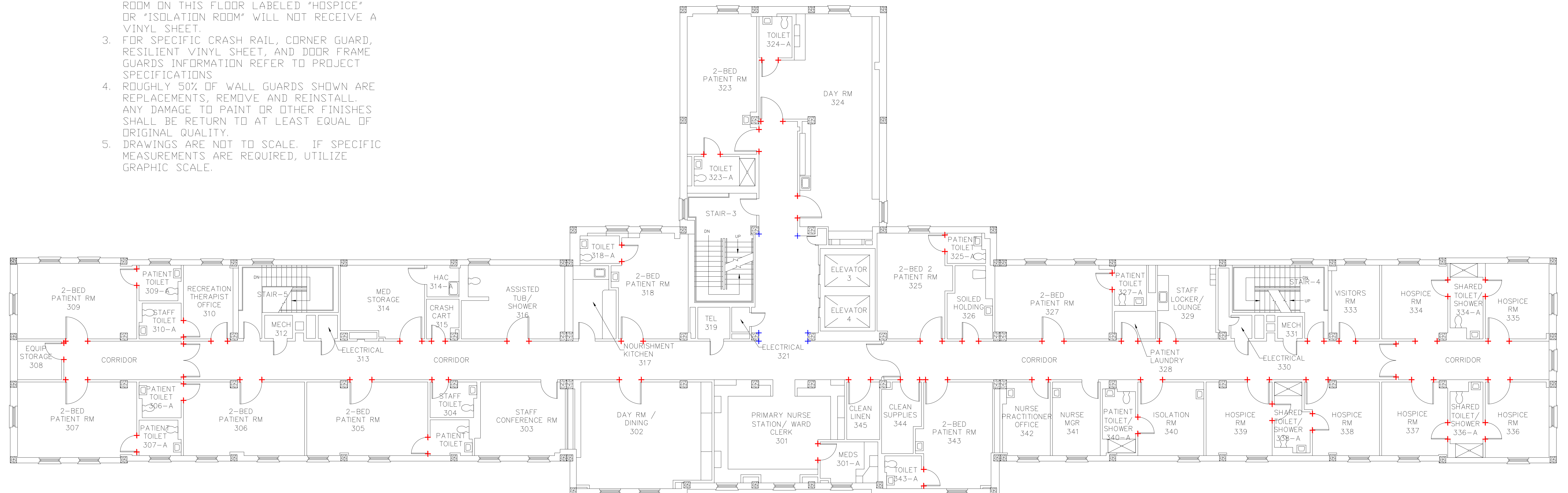

					Drawing Title THIRD FLOOR PLAN WALL PROTECTION	Project Title HALLS AND WALLS FY-13	Date 01-05-2013		Department of Veterans Affairs VA		
					Approved:	Building Number 23H	Checked			Drawn	Project No. 512A5-13-305
Revisions	Date			Professional Seal	Approved:	Location VAMC PERRYPOINT MARYLAND	Drawing No. WP-6				