

three inches = one foot
one and one half inches = one foot
one inch = one foot
three quarters inch = one foot
one half inch = one foot
one quarter inch = one foot
three eighths inch = one foot
one eighth inch = one foot
one eighth inch = one foot

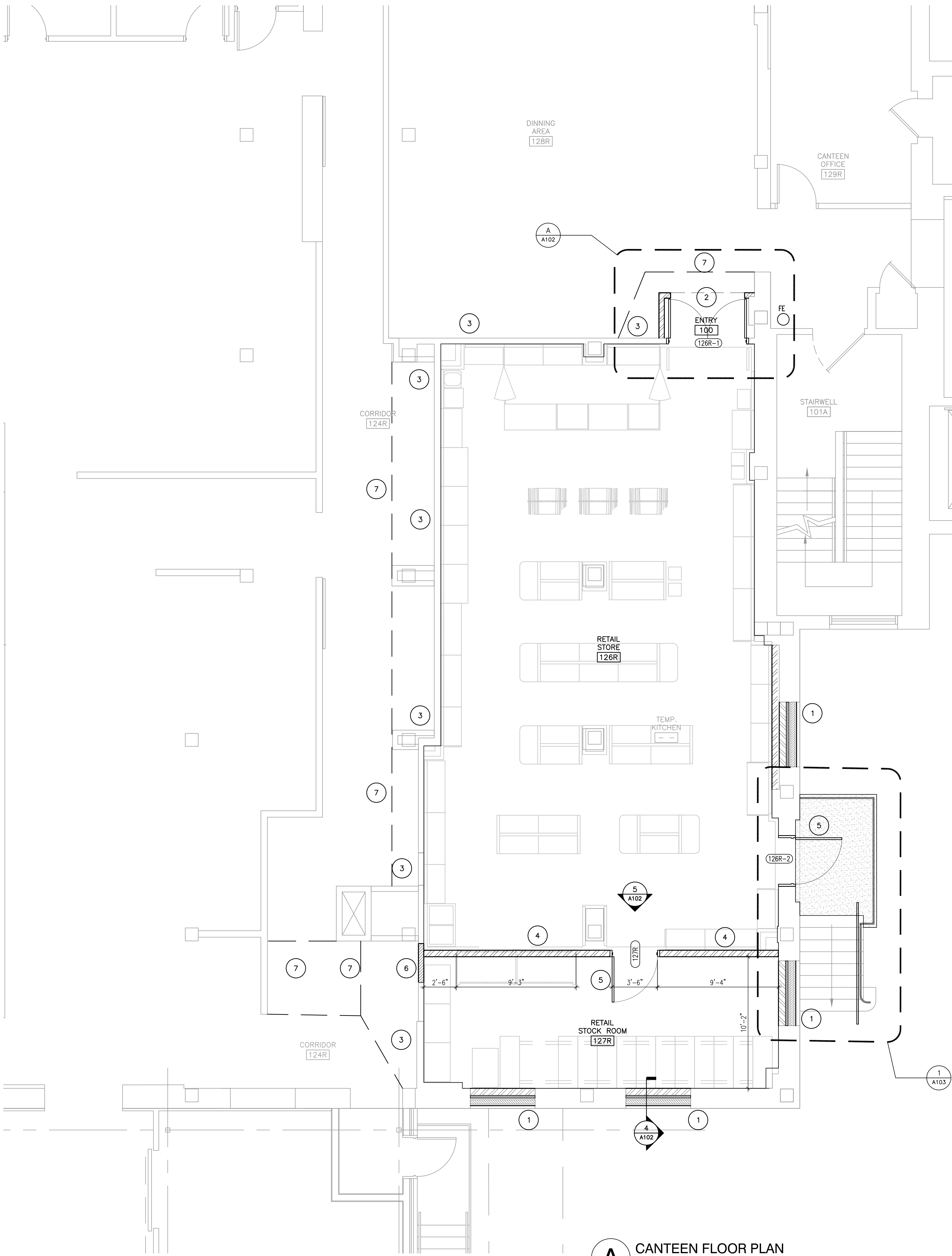

DOOR & FRAME SCHEDULE

DOOR NO.	LABEL (MIN.)	KEY SIDE ROOM	TO/ FROM	ROOM	DOOR				FRAME				HDIR GROUP NO.	REMARKS	
					WIDE×HIGH	TYPE	MAT'L	QTY.	TYPE	MAT'L	DETAIL HEAD	JAMB			SILL
126R-1	-	126R	TO	126R	6'-0"×7'-0"	A	WD	PR	1	EX (HM)	---	---	---	11Ar	2, 3, 4
126R-2	-	EXTERIOR	TO	126R	3'-6"×7'-0"	A	HM	S	1	HM	---	---	---	E4x	1, 2
127R	-	126R	TO	127R	3'-6"×7'-0"	A	WD	S	1	HM	---	---	---	5dx	2, 3

DOOR AND FRAME NUMBERED REMARKS

1. PROVIDE NEW FRAME THAT IS THE FULL WIDTH OF THE WALL THICKNESS TO MATCH EXISTING AND WITH SHEET METAL EXTENSIONS AT EXTERIOR TO MATCH EXISTING
2. PAINT NEW FRAMES AND METAL DOORS PT-2
3. DOORS TO BE STAINED TO MATCH EXISTING DOORS IN THE BUILDING
4. REUSE EXISTING FRAME; MODIFY AS NECESSARY AND PAINT

ROOM FINISH SCHEDULE

ROOM NO.	ROOM NAME	FLOORING MATERIAL	BASE MATERIAL	WALLS				CEILING MATERIAL	REMARKS
				NORTH	EAST	SOUTH	WEST		
100	ENTRY	EXTG QT	VB	NONE	GB/PT-1	GB/PT-1	GB/PT-1	GB/PT-4	1
126R	RETAIL STORE	SV-1	NONE	EXGB/PT-3	EXGB/GB/PT-3	GB/PT-3	EXGB/PT-3	ACT-1	2
127R	RETAIL STOCK ROOM	SV-1	NONE	GB/PT-1	EXGB/GB/PT-1	EXGB/GB/PT-1	EXGB/GB/PT-1	ACT-1	2

FINISHES

FLOORS
SV-1 SHEET VINYL: TEKNOFLOR, BLACK CHERRY #31116
EXTG QT EXISTING QUARRY TILE

WALLS
GB NEW (OR PATCHED) GYPSUM BOARD
EXGB EXISTING GYPSUM BOARD (PATCH AS NECESSARY)
PT-# INDICATES PAINT TYPE AND COLOR

CEILING
GB NEW GYPSUM BOARD
PT-# INDICATES PAINT TYPE AND COLOR
ACT-1 ACOUSTICAL CEILING TILE: ARMSTRONG, CIRRUS, ANGLED TRIANGULAR EDGE

PAINT COLOR AND GLOSS

PT-1 PAINT-SHERWIN WILLIAMS: KILIM BEIGE SW6106 - EGGSHELL
PT-2 PAINT-SHERWIN WILLIAMS: LATTE SW6108 - SEMI-GLOSS (DOOR FRAMES)
PT-3 PAINT-PRIME PAINT ALL AS WOULD BE REQUIRED FOR PT-1. FINISH PAINT ONLY PORTIONS THAT WILL BE EXPOSE AFTER INSTALLATION OF SLOT WALL AND OTHER FIXTURES. FINISH PAINT COLOR TO MATCH WILSONART "FASION GREY" C381-60 (APPROXIMATELY SHERWIN WILLIAMS: SW7084 "PASSIVE"-EGGSHELL)
PT-4 PAINT-SHERWIN WILLIAMS: DOVER WHITE SW6385 - EGGSHELL

EXTERIOR RAILING TO BE PAINTED BLACK, SEMI-GLOSS. SEE SPECIFICATION FOR HIGH PERFORMANCE PAINT TYPE.

ROOM FINISH NUMBERED REMARKS:

1. EXTEND NEW FINISH AROUND THE INSIDE AND THE OUTSIDE OF THE VESTIBULE WALL TO MEET THE EXISTING DINING ROOM WALLS. VERIFY PAINT COLOR - MATCH DINING ROOM WALLS.
2. SEE CEILING PLAN FOR LAYOUT OF NEW CEILING GRID AND CEILING TILE

GENERAL NOTES

1. INTERIOR WALLS OF SALES AREA: PATCH WALLS AS NECESSARY TO PROVIDE CONTINUOUS AND FLAT SURFACE. PRIME NEW GYPSUM BOARD AND PATCH WORK. PROVIDE FINISH PAINT ONLY WHERE EXPOSED AFTER INSTALLATION OF "SLOTWALL" BY OWNER. COORDINATE EXTENT WITH OWNER.
2. INTERIOR WALLS IN STOREROOM: PATCH WALLS AND PROVIDE NEW WALLS AS REQUIRED. PRIME ALL NEW AND PATCH WORK. PROVIDE TWO FINISH COATS OVER NEW WORK AND PATCHED AREAS AND ONE FINISH COAT OVER EXISTING PAINTED SURFACES. PROVIDE ADDITIONAL COATS IF NECESSARY TO COVER PROPERLY AND PROVIDE A MONOLITHIC SURFACE.
3. REPAIR FLOOR SURFACE AS NECESSARY. WHERE HOLES HAVE TO BE FILLED, PROVIDE FORM AND SEAL SUCH THAT NO CONCRETE OR WATER LEAKS IN TO THE SPACE BELOW.
4. COORDINATE ALL WORK OUTSIDE THE ENCLOSED WORK AREA WITH THE OWNER. COORDINATE ALL CONSTRUCTION ACTIVITY IN SPD STORAGE AREA BELOW RETAIL STORE WITH COTR. ALL WORK IN SPD MUST BE COMPLETED BETWEEN 8:00PM FRIDAY AND 6:00AM SUNDAY.

KEYED NOTES

- ① INFILL EXISTING WINDOW. SEE DETAILS 3 AND 4 ON SHEET A102
- ② NEW DOORS IN EXISTING FRAME.
- ③ PATCH EXISTING WALLS AS NECESSARY TO PROVIDE CONTINUOUS SECURITY BARRIER (CONSTRUCT AND SEAL AS 1-HOUR RATED FIRE BARRIER) FROM FLOOR TO UNDERSIDE OF STRUCTURAL DECK ABOVE.
- ④ NEW WALL CONTINUOUS FROM FLOOR TO STRUCTURAL DECK ABOVE FOR SECURITY BARRIER.
- ⑤ NEW DOOR AND FRAME.
- ⑥ CLOSE OPENING IN EXISTING WALL WITH NEW WALL TO MATCH AND ALIGN WITH SURROUNDING WALL.
- ⑦ TEMPORARY CONSTRUCTION PARTITIONS TO PROVIDE DUST-PROOF SEPARATIONS BETWEEN CONSTRUCTION AREAS AND ADJOINING AREAS. CONSTRUCT PARTITIONS SHALL CONFORM TO NFPA 241-04 AND SHALL CONSIST OF FIRE RETARDANT POLYETHYLENE FILM WITH A MINIMUM THICKNESS OF 6 MIL OR OTHER FIRE RETARDANT TARPULINS ON NONCOMBUSTIBLE SUBFRAME OR STRUCTURE FORMING A DUST-PROOF ENCLOSURE. SEAL SEAMS CONTINUOUSLY WITH DUCT TAPE. FILMS AND TARPULINS USED MUST MEET THE REQUIREMENTS OF NFPA 201 FOR FIRE RETARDANCY. EXACT LOCATION OF PARTITIONS TO BE AGREED TO WITH RESIDENT ENGINEER. REMOVE TEMPORARY CONSTRUCTIONS WHEN NO LONGER REQUIRED.

A CANTEN FLOOR PLAN
1/4" = 1'-0"

Revisions:		Date		CONSULTANTS:		ARCHITECT/ENGINEERS:		Drawing Title		Project Title		Project Number	
						BUILDING IS FULLY SPRINKLED		FIRST FLOOR PLAN + SCHEDULES		CANTEN RETAIL STORE		636A6-10-712	
						BROOKS BORG SKILES ARCHITECTURE ENGINEERING LLP		Scale: AS NOTED		Building Number		2	
						317 6th Avenue, Suite 400 Des Moines, IA 50309-4136 515 244 7167		Approved: Project Director		Location:		Drawing Number	
						AE PROJECT NO. 10031				DES MOINES, IOWA		A101	
										Date		Dwg. 4 of 16	
										11/01/2011			
										Checked		Drawn	
										SS		WES	