

three inches = one foot
 one and one-half inches = one foot
 one inch = one foot
 three-quarters inch = one foot
 one-half inch = one foot
 three-eighths inch = one foot
 one-quarter inch = one foot
 one-eighth inch = one foot

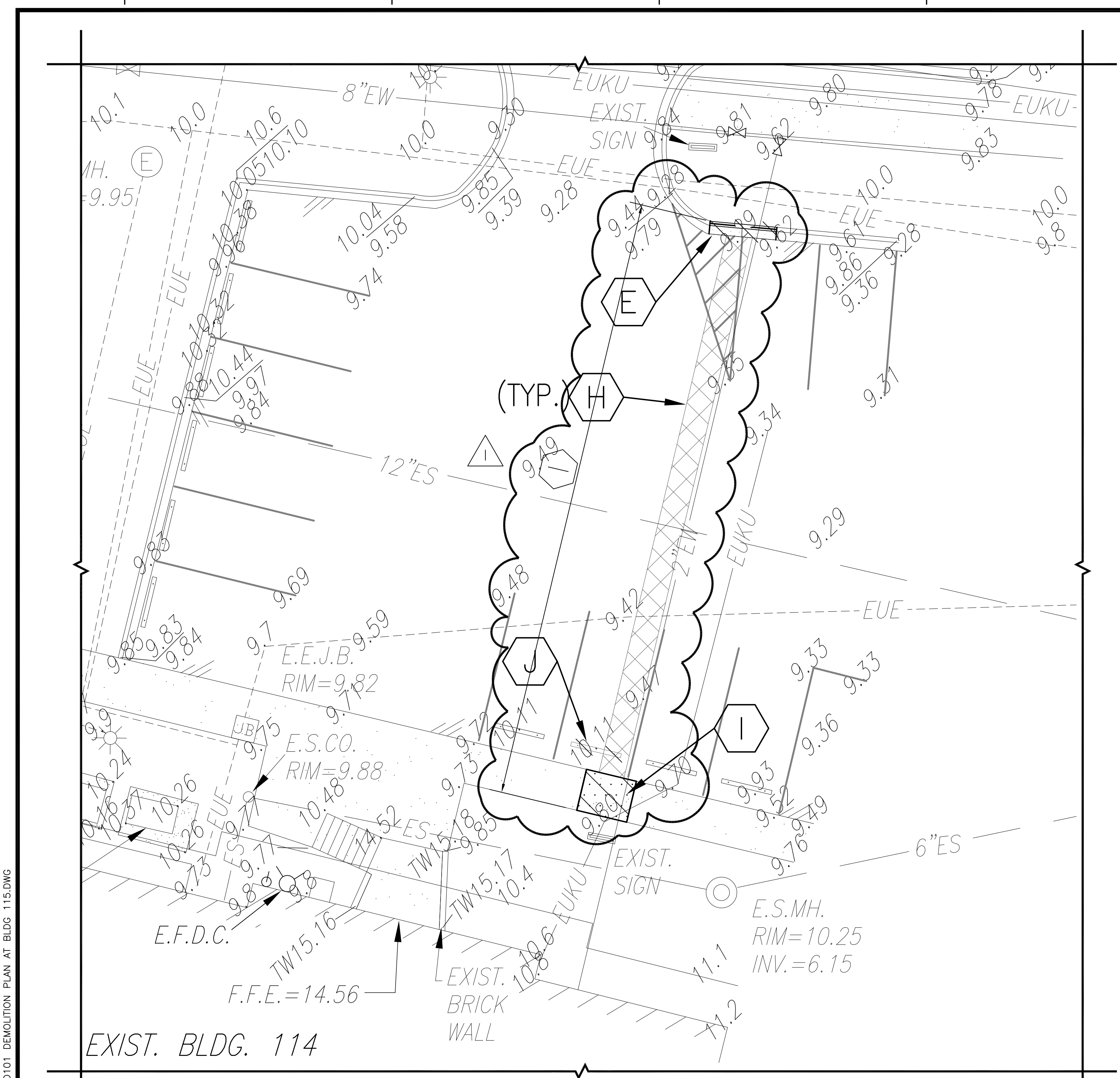

PARTIAL DEMOLITION SITE PLAN AT BLDG 114
 1/8" = 1'-0" (REFER TO SHEET CD102 ON CONSTRUCTION DOCUMENTS FOR REFERENCED PROJECT)

(#) DEMOLITION NOTES

1. AREA BETWEEN THESE POINTS AND CLOUDED AREA SHOWN ON PLAN ARE NOT IN CONTRACT. COORDINATE WORK WITH COR.

GENERAL NOTES

REFER TO PROJECT "REPLACE DETERIORATED WATER LINE" VAMC PROJECT NUMBER 590-12-120 CONSTRUCTION DOCUMENTS DATED 8/21/12 FOR ADDITIONAL INFORMATION.

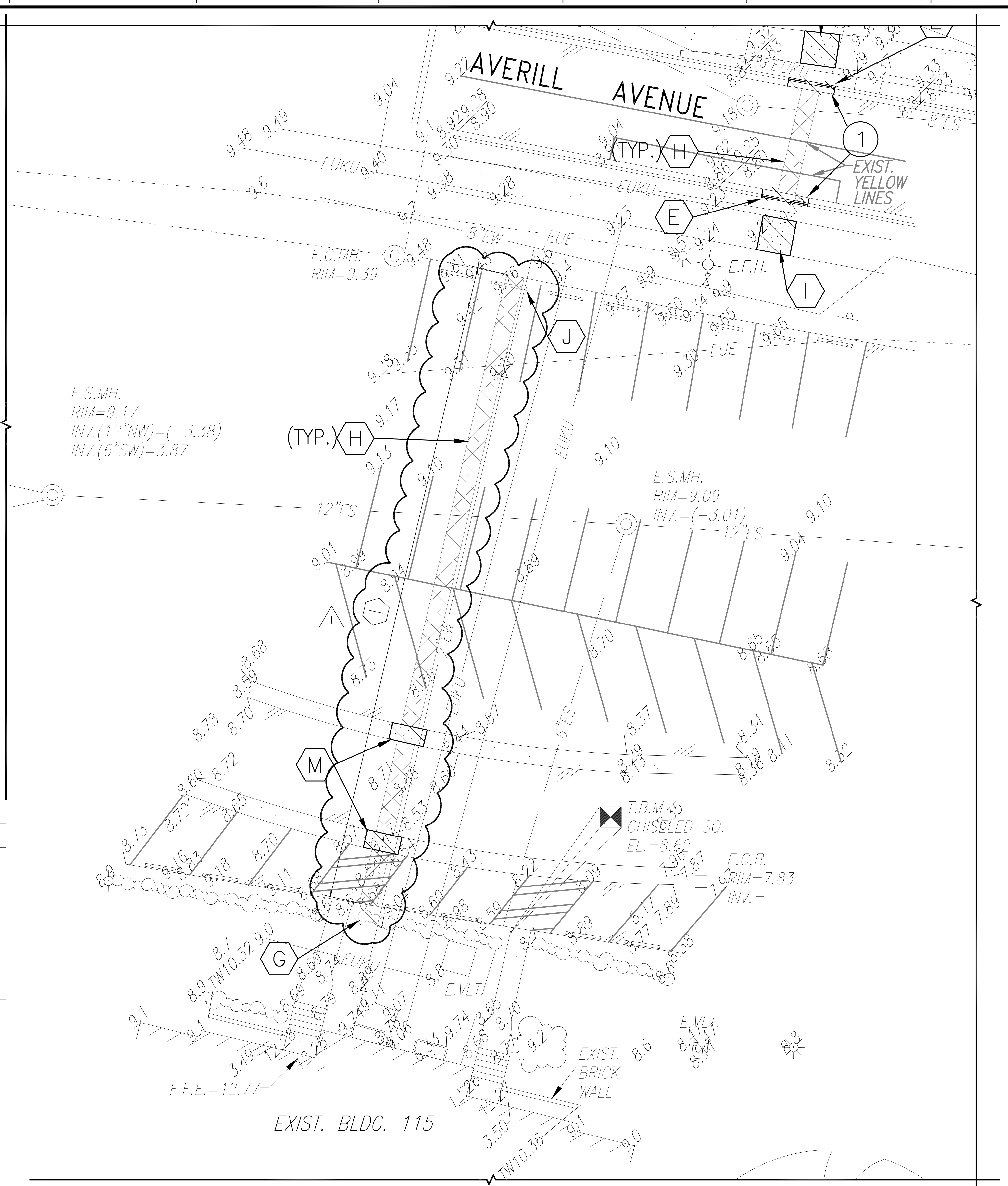

PARTIAL DEMOLITION SITE PLAN AT BLDG 115
 1/8" = 1'-0" (REFER TO SHEET CD103 ON CONSTRUCTION DOCUMENTS DATED 8/21/12 OF REFERENCED PROJECT)

Revisions	Date
1 REVISION	1-3-2013



Drawing Title Demolition Plan At Bldg 115
Location HAMPTON, VIRGINIA

Project Title Replace Deteriorated Water Line
Printed: January 4, 2013
Building No. At 114 & 115

Date 1-3-13
Project No. 590-12-120
CSK1
SHEET OF

