

three inches = one foot
 one and one-half inches = one foot
 one inch = one foot
 three-quarters inch = one foot
 one-half inch = one foot
 three-eighths inch = one foot
 one-quarter inch = one foot
 one-eighth inch = one foot

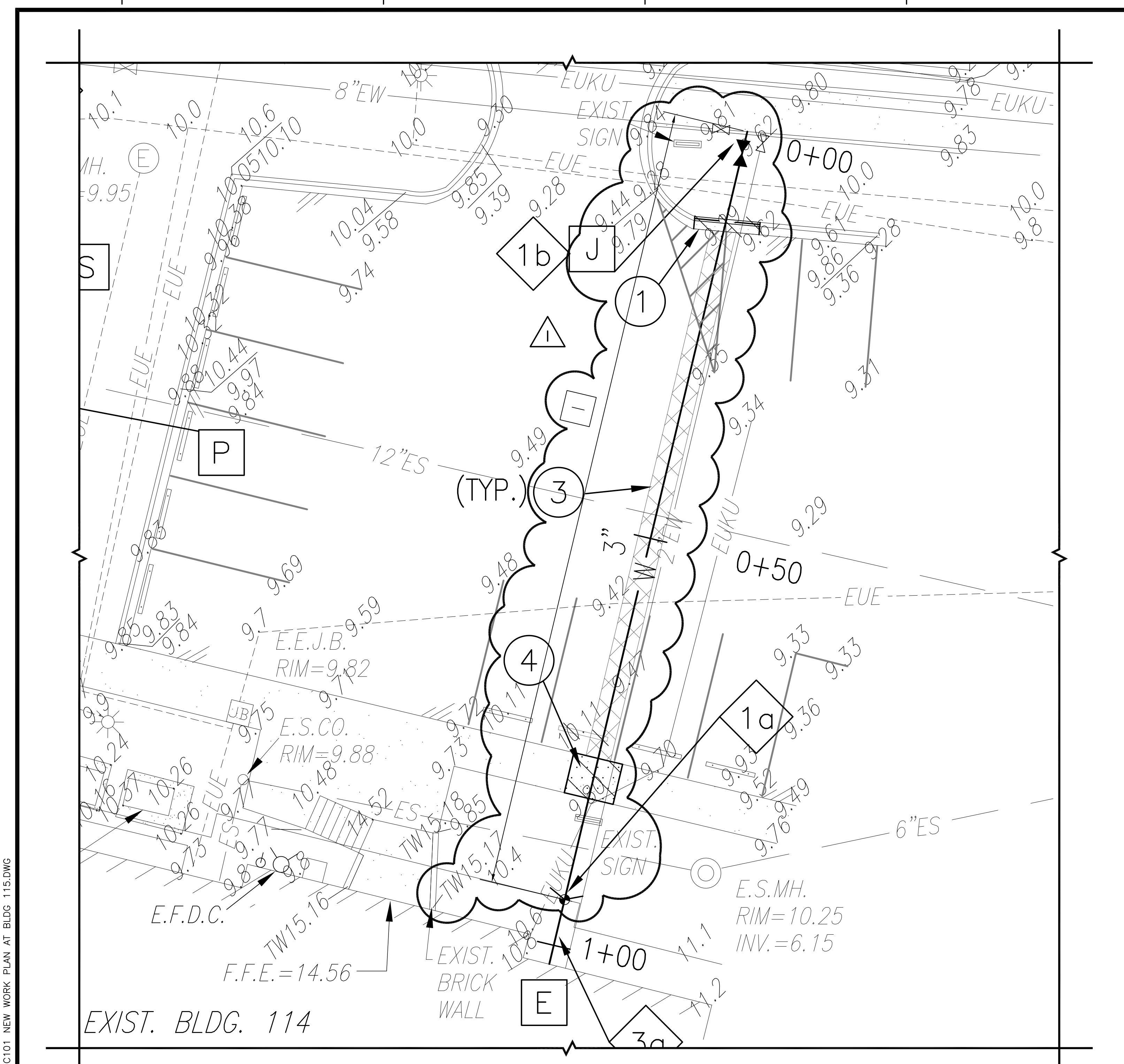

PARTIAL NEW WORK SITE PLAN AT BLDG 114
 1/8" = 1'-0" (REFER TO SHEET CUI13 ON CONSTRUCTION DOCUMENTS DATED 8/21/12 OF REFERENCED PROJECT)

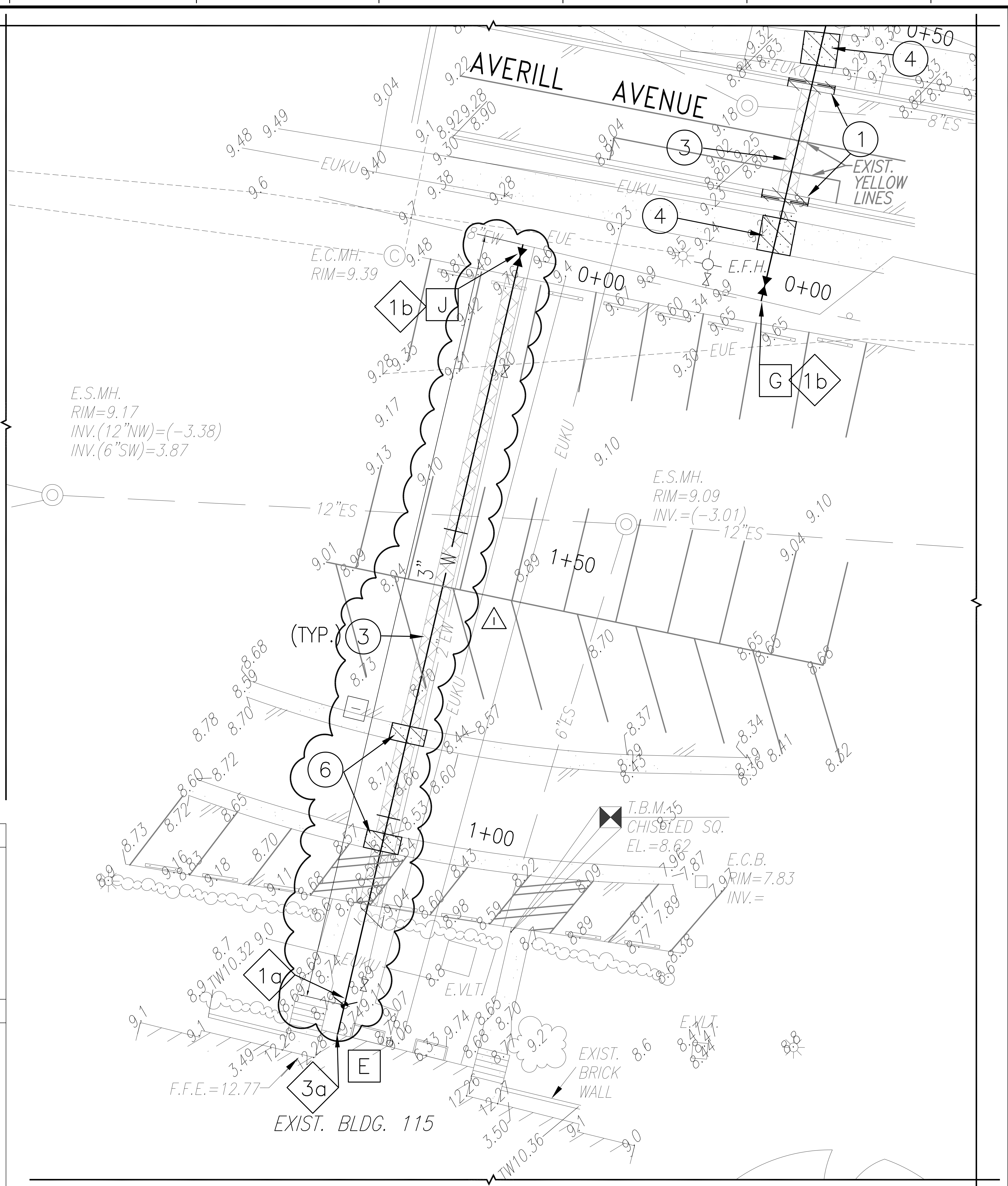

PARTIAL NEW WORK SITE PLAN AT BLDG 115
 1/8" = 1'-0" (REFER TO SHEET CUI13 ON CONSTRUCTION DOCUMENTS DATED 8/21/12 OF REFERENCED PROJECT)

NEW WORK NOTES

- 1. AREA BETWEEN THESE POINTS AND CLOUDED AREA SHOWN ON PLAN ARE NOT IN CONTRACT. COORDINATE WORK WITH COR.

GENERAL NOTES

- REFER TO PROJECT "REPLACE DETERIORATED WATER LINE" VAMC PROJECT NUMBER 590-12-120 CONSTRUCTION DOCUMENTS DATED 8/21/12 FOR ADDITIONAL INFORMATION.

Revisions	Date
1 REVISION	1-3-2013



Drawing Title New Work Plan At Bldg 115
Location HAMPTON, VIRGINIA

Project Title Replace Deteriorated Water Line
Printed: January 4, 2013
Building No. At 114 & 115

Date 1-3-13
Project No. 590-12-120
CSK2
SHEET OF

