

three inches = one foot
 one and one-half inches = one foot
 one inch = one foot
 three-quarters inch = one foot
 one-half inch = one foot
 three-eighths inch = one foot
 one-quarter inch = one foot
 one-eighth inch = one foot

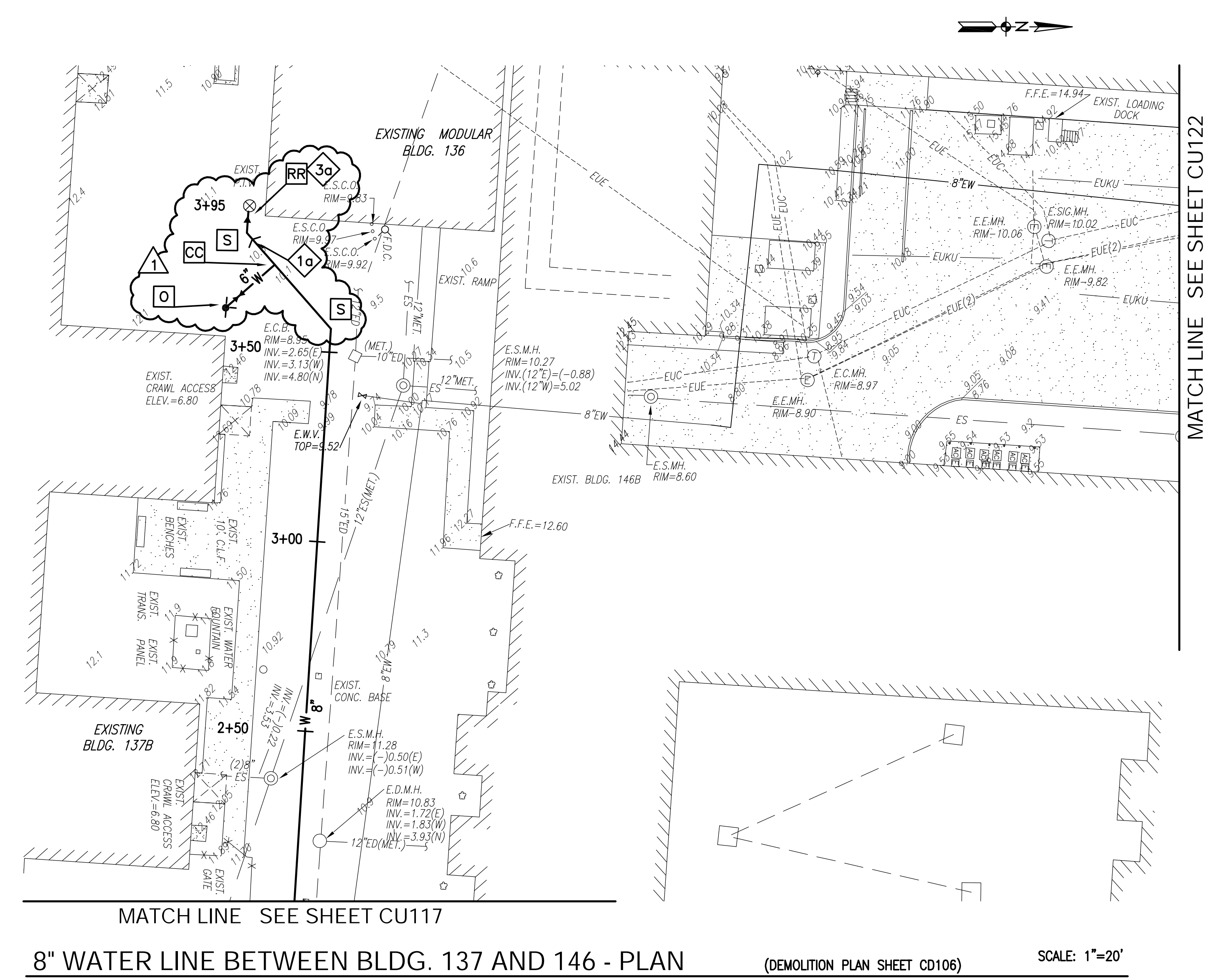

- NOTES:** (THIS SHEET)
- FOR GENERAL NOTES, LEGEND AND ABBREVIATIONS SEE SHEET C-001.
 - FOR UTILITY NOTES INDICATED THUS: $\#$ ON PLAN, SEE SHEET CU109.
 - FOR CONSTRUCTION NOTES INDICATED THUS: $\#$ ON PLAN, SEE SHEET CU109.
 - FOR PHASING NOTES INDICATED THUS: $\#$ ON PLAN, SEE SHEET CU109.
 - WATER LINE THRUST RESTRAINTS (NOT SHOWN FOR CLARITY) SHALL BE PROVIDED AS SPECIFIED. FOR TYPICAL CONCRETE THRUST BLOCK DETAIL, SEE SHEET C-501.

MATCH LINE SEE SHEET CU117
8" WATER LINE BETWEEN BLDG. 137 AND 146 - PLAN
 (DEMOLITION PLAN SHEET CD106) SCALE: 1"=20'

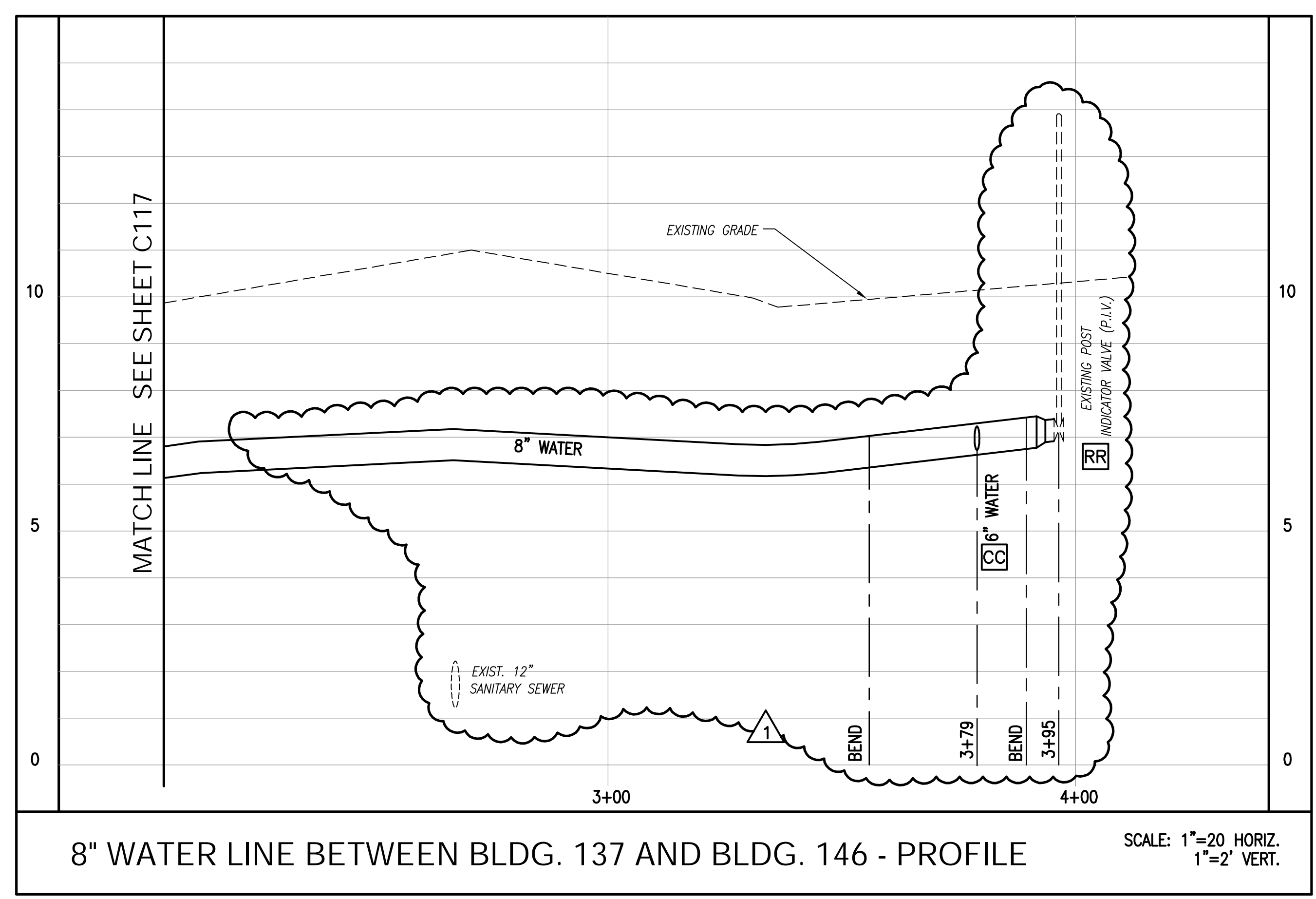

MATCH LINE SEE SHEET C117
8" WATER LINE BETWEEN BLDG. 137 AND BLDG. 146 - PROFILE
 SCALE: 1"=20' HORIZ.
 1"=2' VERT.

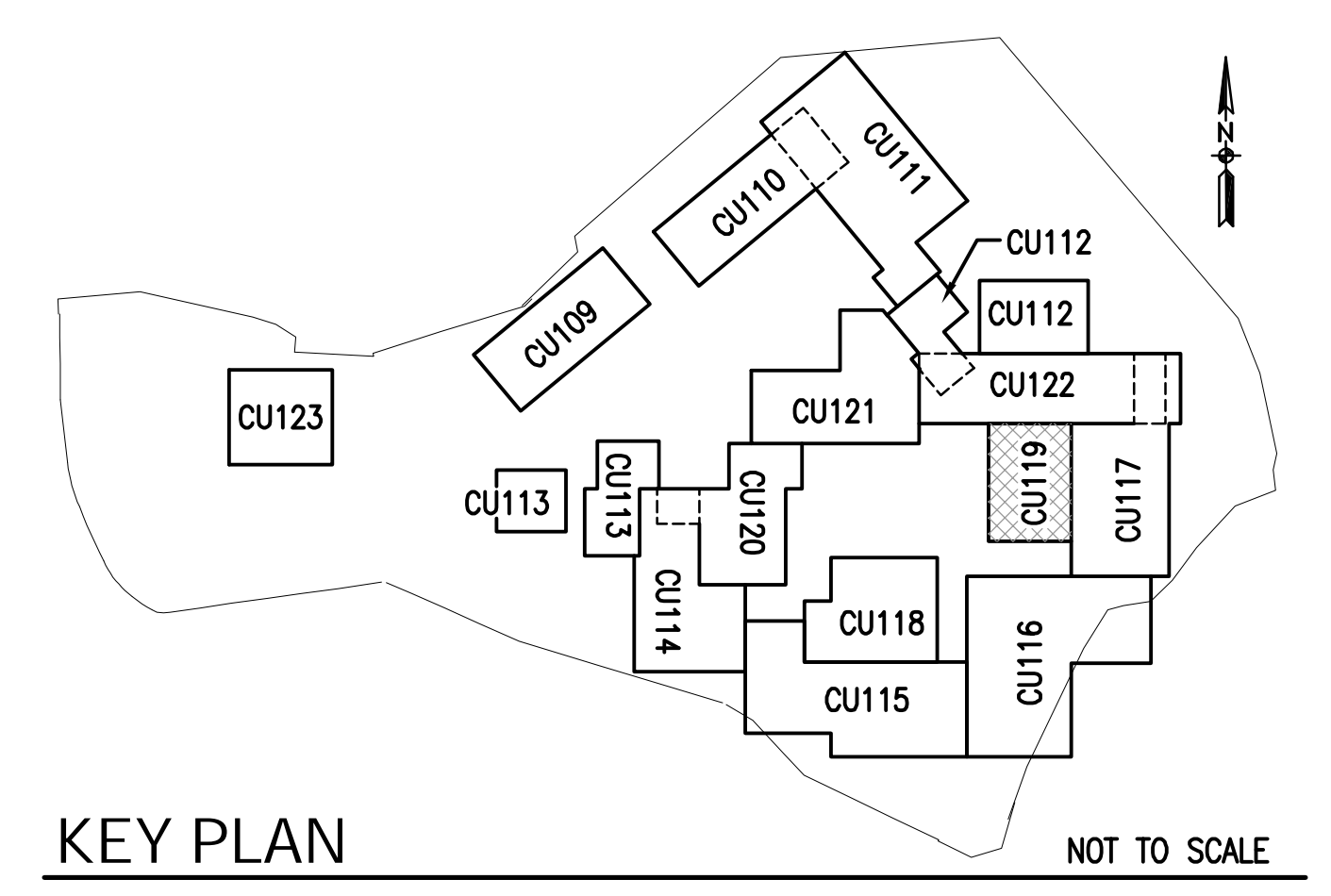

KEY PLAN NOT TO SCALE

	WATER LINE REVISION Revisions	2-01-13 Date
	2-01-13 Date	Date

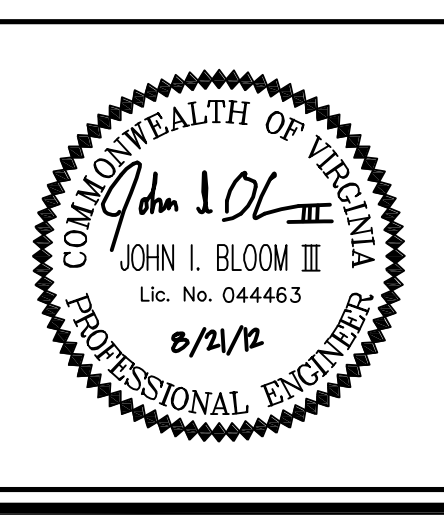

HOGGARD-EURE ASSOCIATES, P.C.
 Engineers
 Surveyors
 Planners

901 PortCentre Parkway
 Suite 5
 Portsmouth, Virginia 23704

BOWMAN, FOSTER & ASSOC.
 CONSULTING ENGINEERS
 #4 INTERSTATE CORP. CENTER
 NORFOLK, VA 23502
 2424 26th ROAD SOUTH
 ARLINGTON, VA 22206

GRAPHIC SCALE:
 1"=20' HORIZ.
 1"=2' VERT.

Drawing Title WATER MAINS PLAN AND PROFILE	Project Title WATER LINE REPLACEMENT	Date 08/21/12
LOCATION	Building Number VAMC, HAMPTON VIRGINIA	Project No.
Location	Checked Drawn	DRAWING NO. CU119 DWG. Of

