

North Avenue

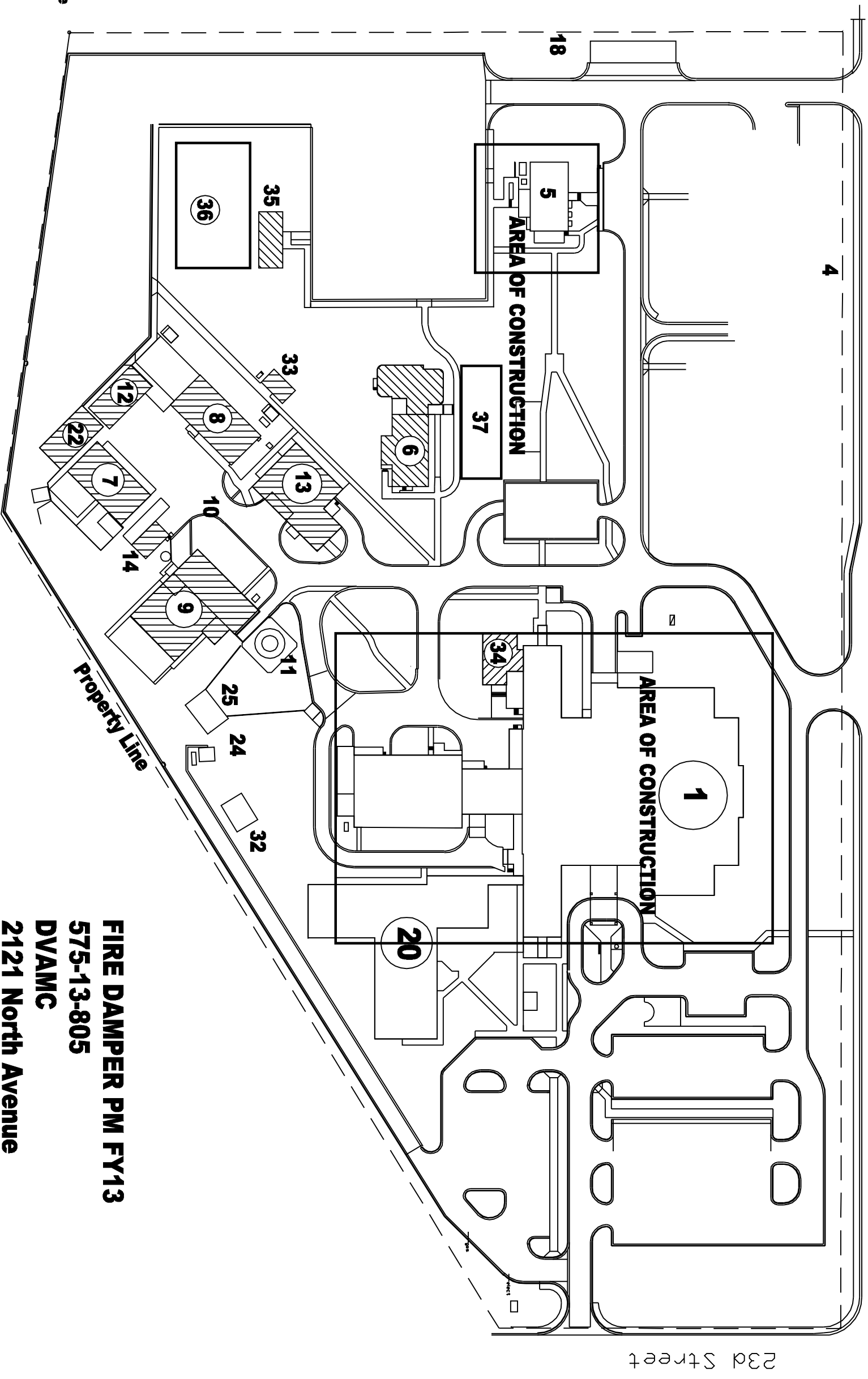

| Bldg # | Function |
|--------|---------------------------|
| 1 | Hospital |
| 2 | Quarters Abandoned |
| 3 | Quarters Abandoned |
| 4 | Garage Storage |
| 5 | Administrative |
| | A&MM Admin |
| | Recreation Therapy |
| | Credit Union |
| 6 | Administrative |
| | Police & Security |
| | Environmental Mgt |
| | DSS |
| | ITS Training |
| | Teleconferencing |
| 7 | Warehouse |
| 8 | Administrative |
| | Engineering |
| 9 | Boiler/Chiller Plant |
| 10 | Smokestack |
| 11 | Water Tower |
| 12 | Administrative |
| | Engineering |
| 13 | Laundry |
| 14 | Incinerator |
| 18 | Carport |
| 20 | Nursing Home |
| 22 | Warehouse |
| 24 | Electric Switch |
| 25 | Fuel Storage |
| 32 | Shelter |
| 33 | Telephone Switch |
| 34 | ITS |
| 35 | Administrative |
| 36 | Administrative |
| 37 | Recreation/administrative |

**FIRE DAMPER PM FY13
575-13-805
DVAMC
2121 North Avenue
Grand Junction, CO
Site Plan**