

1. PRIOR TO THE START OF ANY EXCAVATION, PERFORM AN SURVEY OF THE OF EACH SECTION. SUBMIT TO CONTRACTING OFFICER & COTR FOR APPROVAL PRIOR TO BEGINNING ANY EXCAVATION.

2. ALL EXISTING TOPOGRAPHY, UNDERGROUND UTILITIES, STRUCTURES AND ASSOCIATED FACILITIES SHALL BE PROTECTED FROM DAMAGE. CONTRACTOR IS TO VERIFY ALL EXISTING STRUCTURES AND FACILITIES AND NOTIFY ENGINEER OF ANY CONFLICTS OR DISCREPANCIES PRIOR TO STARTING OF WORK.

3. CONTRACTOR SHALL COMPLETE ALL WORK FOR THE FIRST THREE ADJACENT GRAVESITE ROWS AS IDENTIFIED BY THE COTR FOR INSPECTION AND APPROVAL. ONCE THESE ROWS ARE ACCEPTED, THE CONTRACTOR SHALL BE AUTHORIZED TO BEGIN WORK ON THE REMAINING GRAVESITES. HOWEVER, NO MORE THAN TEN ROWS SHALL BE RENOVATED AT ONE TIME UNLESS APPROVED BY THE CONTRACTING OFFICER IN WRITING.

3. THE CONTRACTOR SHALL SUBSCRIBE TO ALL GOVERNING REGULATIONS AND SHALL OBTAIN ALL NECESSARY PUBLIC AGENCY PERMITS. THE CONTRACTOR, BY USING THESE PLANS FOR THEIR WORK, AGREE TO HOLD HARMLESS ENGINEER, THEIR EMPLOYEES AND AGENTS AND AGAINST ANY AND ALL LIABILITY, CLAIMS, DAMAGES, AND THE COST OF DEFENSE ARISING OUT OF CONTRACTOR(S) PERFORMANCE OF THE WORK DESCRIBED HEREIN, BUT NOT INCLUDING THE SOLE NEGLIGENCE OF THE OWNER, HIS AGENTS, THE ENGINEER, HIS EMPLOYEES AND AGENTS.

4. ALL EXCAVATED SOIL (SPOILS) SHALL BE REMOVED FROM THE GRAVESITE / SECTIONS WITHIN TWO HOURS. SOIL WHICH IS NOT REUSED DURING RENOVATION SHALL BE REMOVED FROM THE SITE AT THE CONTRACTOR'S EXPENSE.

5. NO BURNING OR INCINERATION OF RUBBISH WILL BE PERMITTED ON SITE.

6. THE CONTRACTOR SHALL PROVIDE FOR THE SAFE AND ORDERLY PASSAGE OF TRAFFIC AND PEDESTRIANS WHERE HIS OPERATIONS ABUT PUBLIC THOROUGHFARES AND ADJACENT PROPERTY. WHERE ROADS ARE CLOSED FOR CONSTRUCTION, THE CONTRACTOR SHALL PROVIDE DIRECTIONAL SIGNAGE OF APPROPRIATE SIZE AND HEIGHT AND PLACED AT THE CONSTRUCTION BOUNDARY FENCE OR AS DIRECTED BY THE COTR DIRECTING VISITORS.

7. CONSTRUCTION OPERATIONS SHALL BE CONDUCTED IN SUCH A WAY AS TO PREVENT TRACKING OF MUD OR SOIL ONTO PUBLIC THOROUGHFARES. AT THE END OF EACH DAY THE CONTRACTOR SHALL CLEAN UP ALL MUD OR SOIL WHICH HAS BEEN TRACKED ONTO PUBLIC AND CEMETERY STREETS.

8. PRIOR TO NEW WORK THE CONTRACTOR SHALL FIELD CHECK ALL DIMENSIONS AND ELEVATIONS AND VERIFY THE LOCATION AND ELEVATION OF EXISTING UTILITY LINES AND STRUCTURES WITHIN THE AREA OF WORK. DISCREPANCIES SHALL BE REPORTED TO THE COTR IMMEDIATELY. ALL FIELD TILES ENCOUNTERED DURING EXCAVATION SHALL BE REPAIRED WHERE PRACTICABLE AND PROMPTLY REPORTED TO THE ENGINEER.

9. BEFORE EXCAVATING OVER OR ADJACENT TO ANY EXISTING UTILITIES, NOTIFY THE OWNER OF SUCH UTILITIES TO ENSURE THAT PROTECTIVE WORK WILL BE COORDINATED AND PERFORMED BY THE CONTRACTOR IN ACCORDANCE WITH THE REQUIREMENTS OF THE OWNER OF THE UTILITY INVOLVED. IF ANY EXISTING SERVICE LINES, UTILITIES AND UTILITY STRUCTURES WHICH ARE TO REMAIN IN SERVICE ARE UNCOVERED OR ENCOUNTERED DURING THIS OPERATION, THEY SHALL BE SAFEGUARDED, PROTECTED FROM DAMAGE AND SUPPORTED IF NECESSARY.

10. ALL SEDIMENT SHALL BE PREVENTED FROM ENTERING ANY EXISTING STORM DRAINAGE SYSTEM. THE CONTRACTOR SHALL BE RESPONSIBLE FOR REMOVING SEDIMENT RESULTING FROM THIS PROJECT FROM STORM SEWERS AND DRAINAGE STRUCTURES.

11. AREAS OUTSIDE THE CONSTRUCTION LIMIT LINE IMPACTED BY OPERATIONS OF THE CONTRACTOR SHALL BE RETURNED TO THE STATE IT WAS FOUND PRIOR TO NEW CONSTRUCTION, EXCEPT WHERE NEW WORK IS SHOWN.

12. ALL TREES SHALL BE PROTECTED TO THE EXTENT POSSIBLE FROM DAMAGE TO TRUNKS, BRANCHES AND ROOTS. CUTTING OF TREE ROOTS IS ALLOWED TO THE LIMITS OF THE TRENCHES WHERE NEW FOOTING ARE TO BE PLACED.

13. STREET PAVING AND CURBS SHALL BE PROTECTED FROM DAMAGE, AND, IF DAMAGED, SHALL BE REPLACED PROMPTLY IN CONFORMANCE WITH VA STANDARD SPECIFICATIONS IN MATERIALS AND WORKMANSHIP.

14. PROVIDE SMOOTH VERTICAL CURVES THROUGH HIGH AND LOW POINTS. PROVIDE UNIFORM SLOPES BETWEEN NEW AND EXISTING GRADES. AVOID RIDGES AND DEPRESSIONS.

15. CONTRACTOR SHALL MAINTAIN ACCURATE RECORDS OF ALL UNDERGROUND UTILITY CONSTRUCTION AND SUBMIT "RECORD" INFORMATION TO ENGINEER FOR USE IN PREPARING "RECORD DRAWINGS".

16. CONTRACTOR SHALL BE RESPONSIBLE FOR TAKING TOPSOIL SAMPLES AND TESTING THE TOPSOIL TO DETERMINE NECESSARY ADDITIVES REQUIRED FOR PROPOSED PLANTINGS. LANDSCAPE CONTRACTOR SHALL SUPPLY ALL ADDITIVES IN SUFFICIENT QUANTITIES TO SATISFY THE RECOMMENDATIONS OF THE TESTING LAB. IF TOPSOIL TEST RECOMMENDATIONS CONFLICT WITH THE SPECIFICATIONS, LANDSCAPE CONTRACTOR SHALL NOTIFY COTR BEFORE PROCEEDING WITH WORK. SUPPLY COPIES OF LAB REPORTS AND RECOMMENDATION TO COTR FOR REVIEW.

17. CONTRACTOR SHALL TAKE NECESSARY PRECAUTIONS TO PREVENT INJURY TO ALL PLANT MATERIALS DURING DIGGING, HANDLING, PLANTING, AND MAINTENANCE OPERATIONS.

18. INSPECT AND TEST SPRINKLER SYSTEM WITHIN WORK AREA PRIOR TO STARTING ANY WORK TO VERIFY IN WORKING CONDITION. DOCUMENT AND SUBMIT TO THE COTR AND CONTRACTING OFFICER, ANY PART NOT IN GOOD WORKING CONDITION. PROTECT EXISTING SPRINKLER SYSTEM. CONTRACTOR DAMAGE WILL BE REPAIRED BY CONTRACTOR AT CONTRACTOR EXPENSE. SPRINKLER LINES AND HEADS AFFECTED BY THE PLACEMENT OF THE NEW FOOTING SHALL BE REPLACED WITH NEW. TURN OVER OLD SPRINKLER HEADS TO THE CEMETERY. DISPOSE OF OLD PIPING. SLEEVE FOOTING FOR NEW SPRINKLER PIPING THAT CROSSES FOOTINGS.

19. THE GENERIC GRAVESITE SECTION DETAIL DEFINES AND DEPICTS THE WORK AREA LIMITS OF VARIOUS GRAVESITE ROWS WITHIN A TYPICAL GRAVESITE SECTION. IT DOES NOT DEPICT ANY PARTICULAR SECTION AT THE CEMETERY.

20. PHYSICAL LIMITS OF TURF WORK: NEW SOD TO BE INSTALLED TO THE FULL EXTENT OF THE SECTION OR PART THEREOF, UP TO THE BOUNDARY LIMITS AS DEFINED BY THE CURB, TREE OR GARDEN EDGE, FENCE, PROPERTY LINE, OR MID-WAY BETWEEN TWO SECTIONS. SEE SPECIFICATIONS FOR GRADING, SOIL PREPARATION AND PLACING OF SOD.

21. A TYPICAL "HEADSTONE SUPPORT ROW" INCLUDES THE HEADSTONE SUPPORT FOOTING, THE ASSOCIATED GRAVESITES THAT PARTICULAR HEADSTONE FOOTING SUPPORTS AND THE AREA OUT TO THE TURF BOUNDARY LIMITS OF THAT PARTICULAR HEADSTONE SUPPORT ROW. SEE TYPICAL GRAVESITE SECTION DETAIL.

NATIONAL CEMETERY ADMINISTRATION
FT. RICHARDSON NATIONAL CEMETERY

Marker Support System

Checked	Approved by CJS	REVISIONS		
		No.	Date	Description
Drawn CJS	Date Jan 29, 2013			

Drawing Number

01

Page 1 of 5

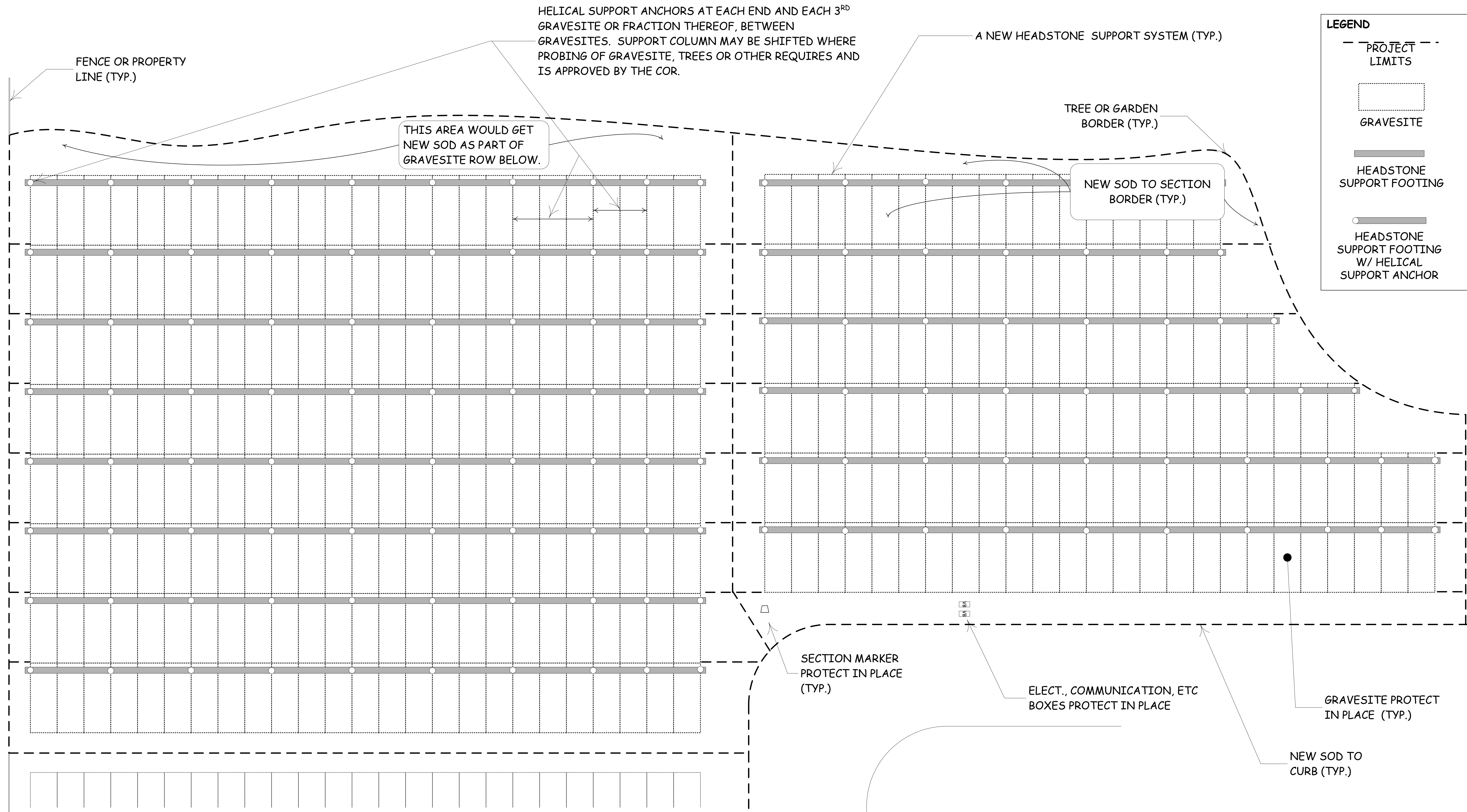

GENERIC GRAVESITE SECTION (Not to Scale, nor does this represent any specific burial section.)

Checked	Approved by CJS	REVISIONS		
		No.	Date	Description
Drawn CJS	Date Jan 29, 2013			

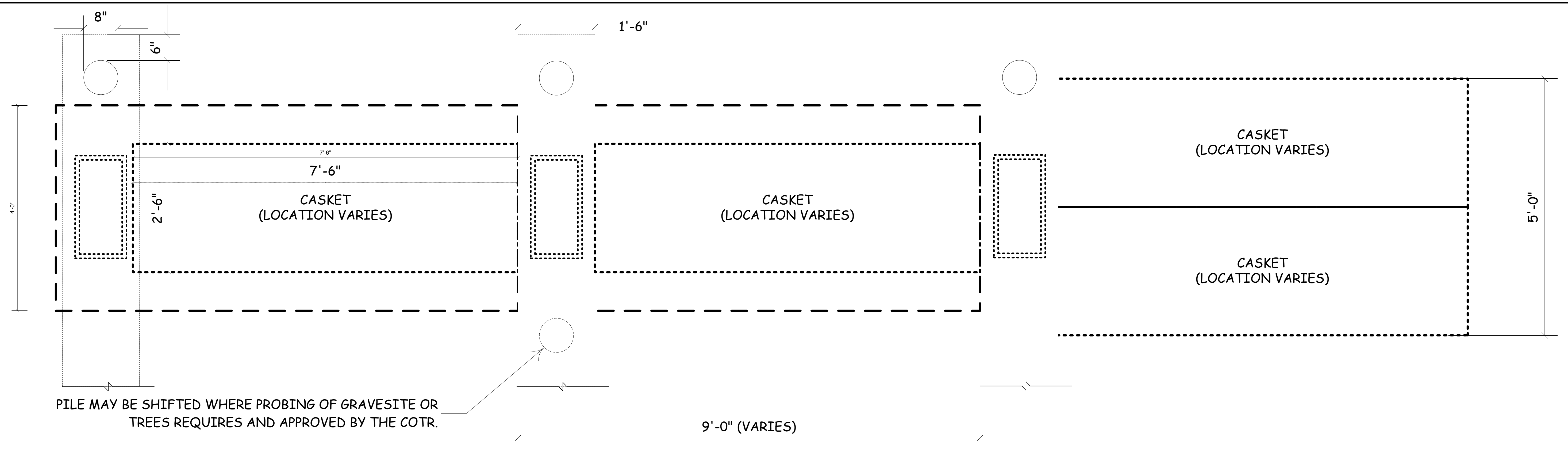

HEADSTONE SUPPORT FOOTING PLAN VIEW

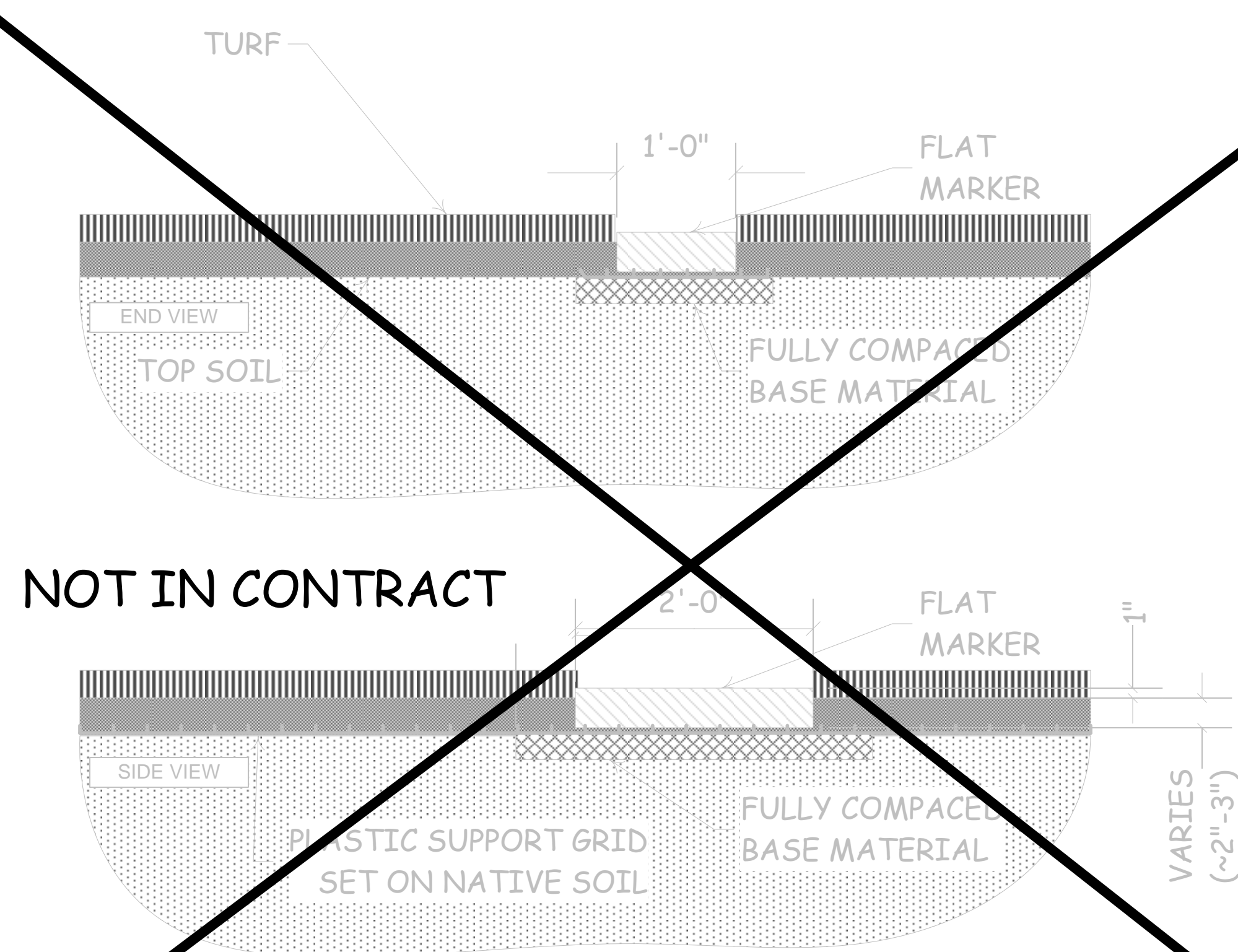

FLAT MARKER INSTALLATION DETAIL

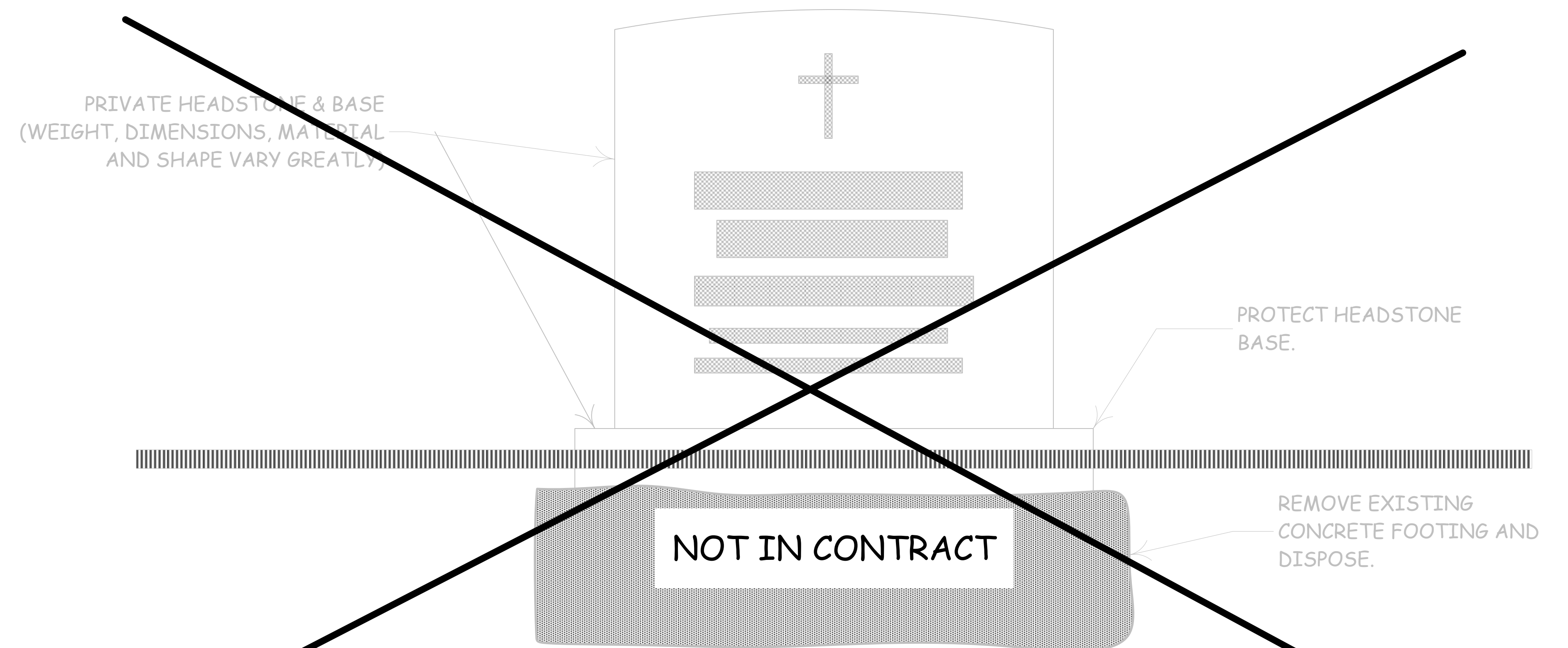

CONCRETE FOOTING REMOVAL PROCEDURE

**NATIONAL CEMETERY ADMINISTRATION
FT. RICHARDSON NATIONAL CEMETERY**

Marker Support System

Checked	Approved by CJS	REVISIONS		
		No.	Date	Description
Drawn CJS	Date Jan 29, 2013			

Drawing Number

03

Page 3 of 5

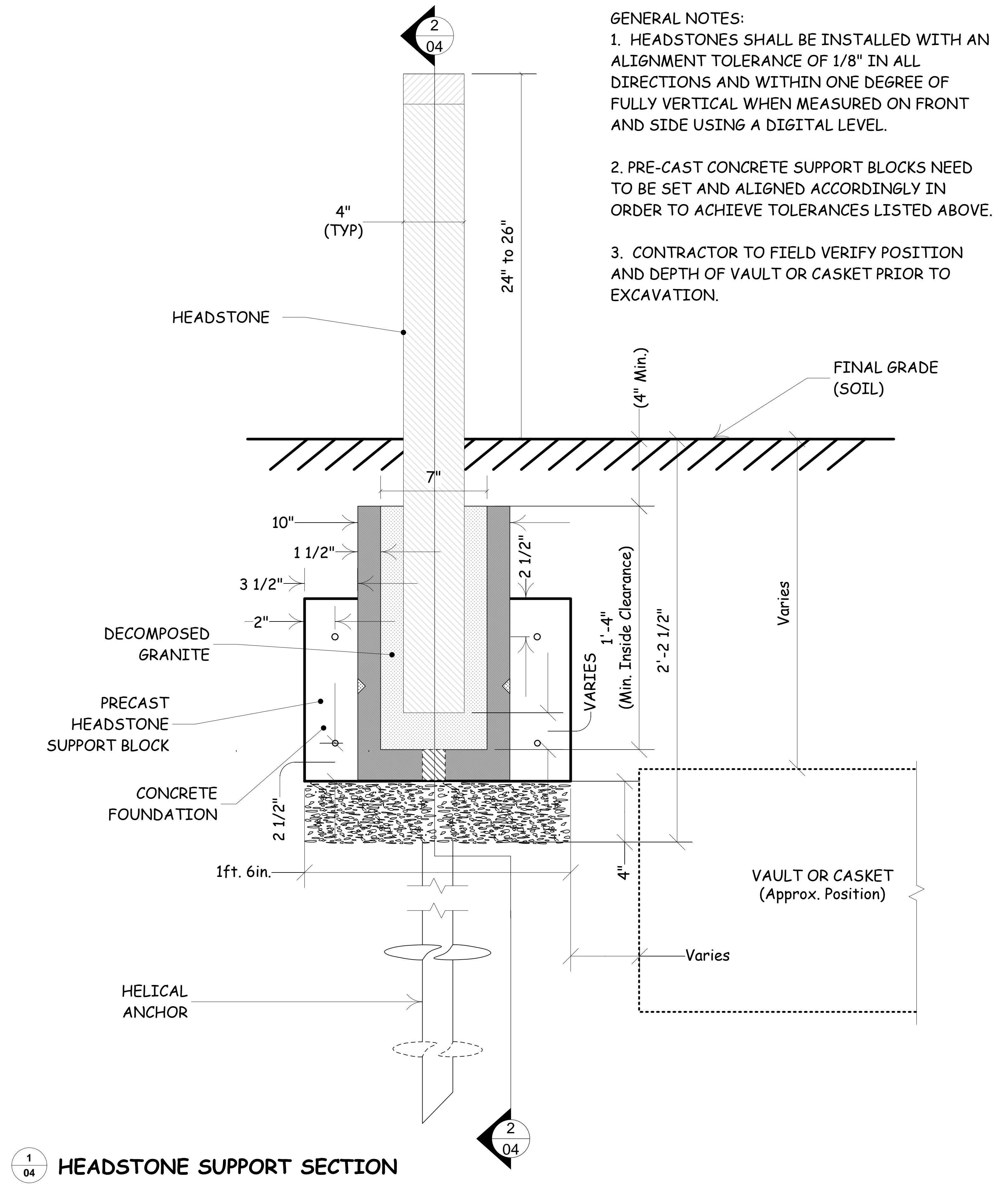
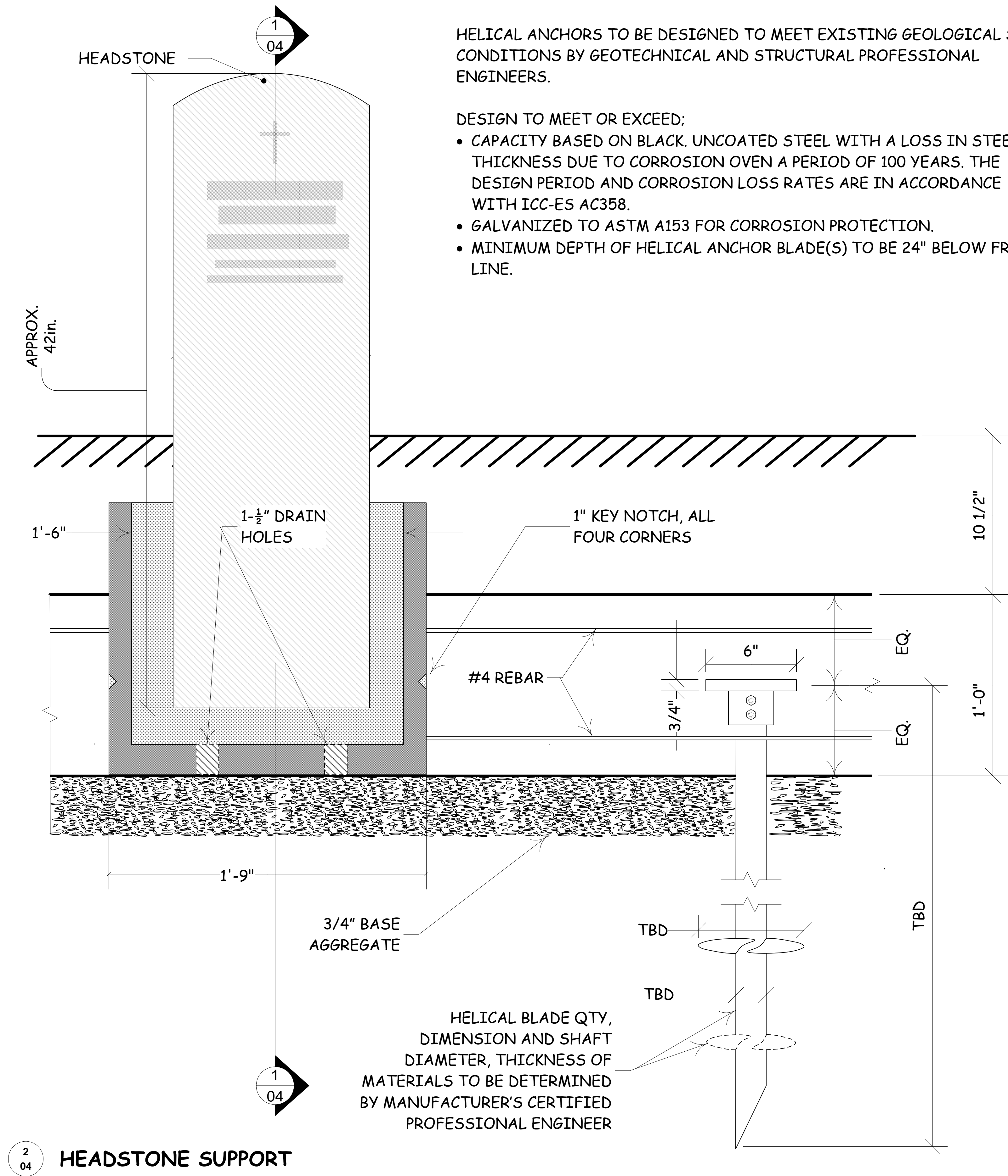

**NATIONAL CEMETERY ADMINISTRATION
FT. RICHARDSON NATIONAL CEMETERY**

Marker Support System

Checked	Approved by	REVISIONS		
	CJS	No.	Date	Description
Drawn	Date			
CJS	Jan 29, 2013			

Drawing Number

04

Page 4 of 5

FOR CLARITY PURPOSES,
"ASSUMING" A FIVE FOOT FROST LINE.

(ACTUAL FROST LINE TO BE OBTAINED FROM LOCAL BUILDING CODE AND
USED FOR CALCULATING THE REQUIRED ANCHOR CAPACITY.)

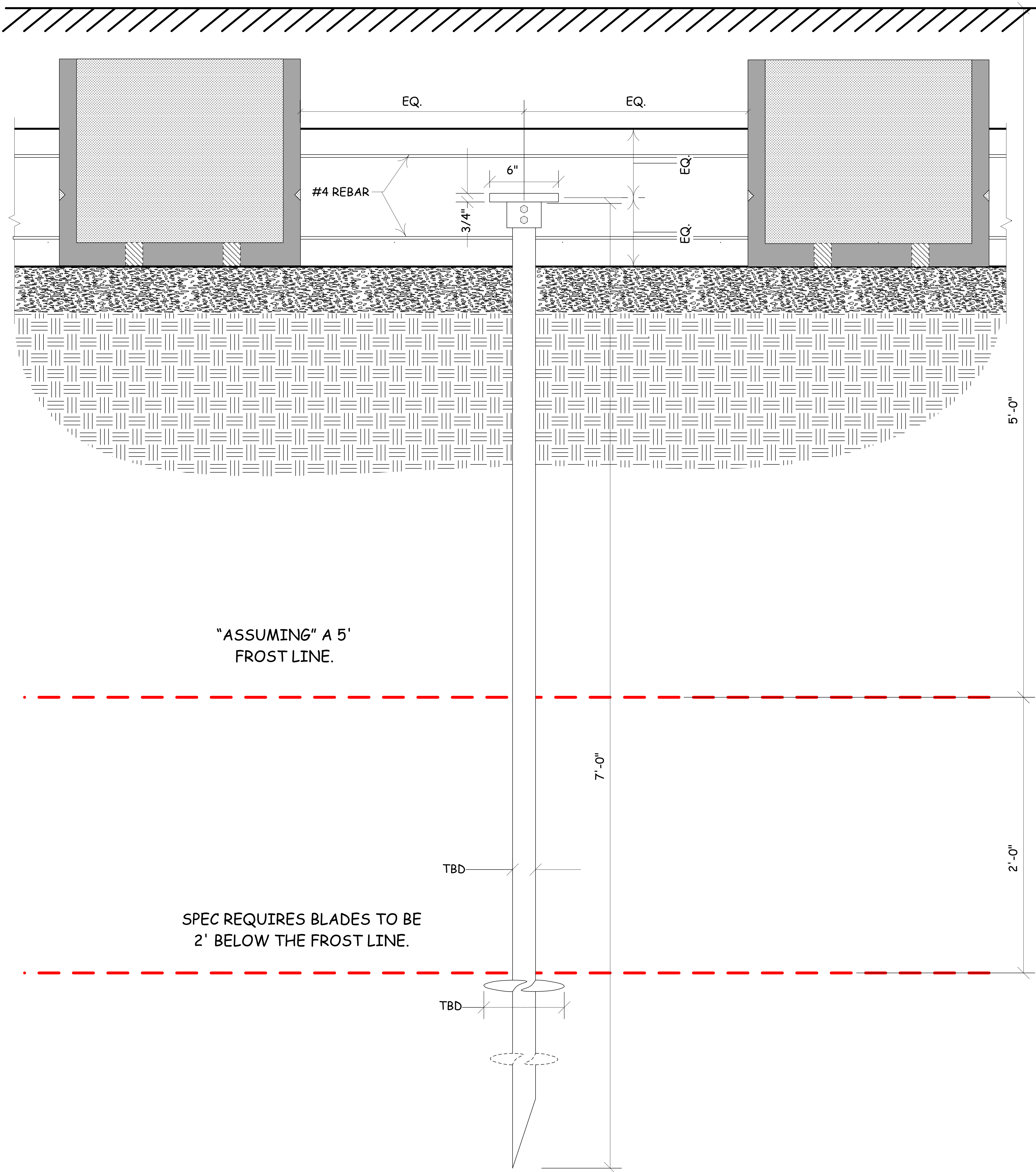

Checked	Approved by CJS	REVISIONS		
		No.	Date	Description
Drawn CJS	Date Jan 29, 2013			