

PIPE BASEMENT PLAN
SCALE: 1/8"=1'-0"

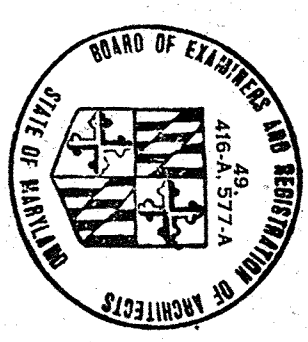
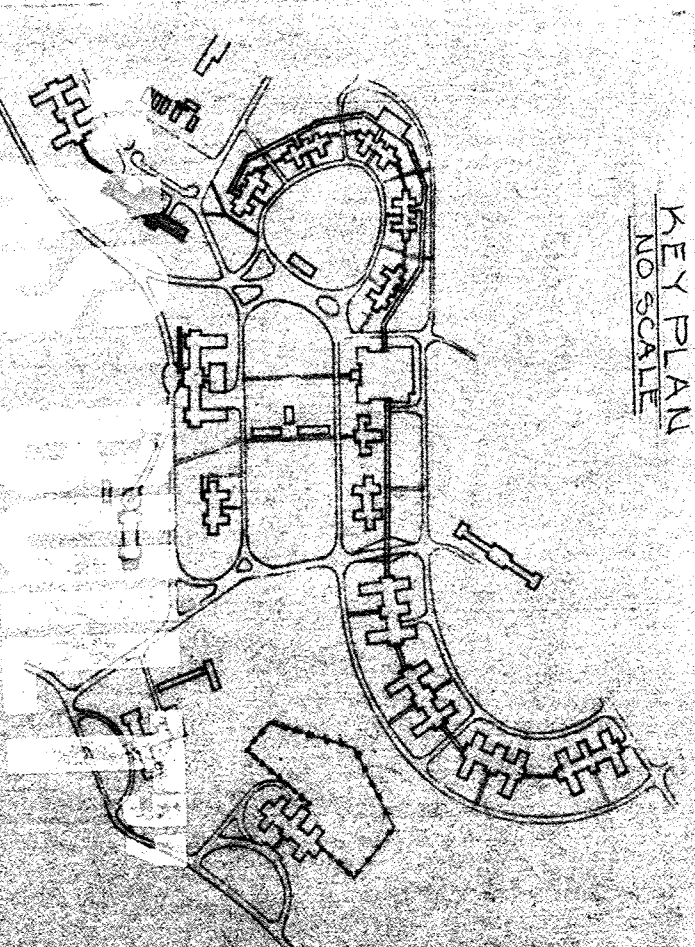
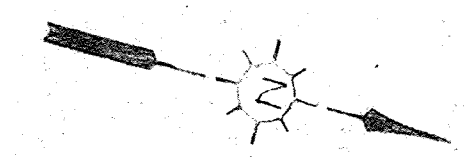
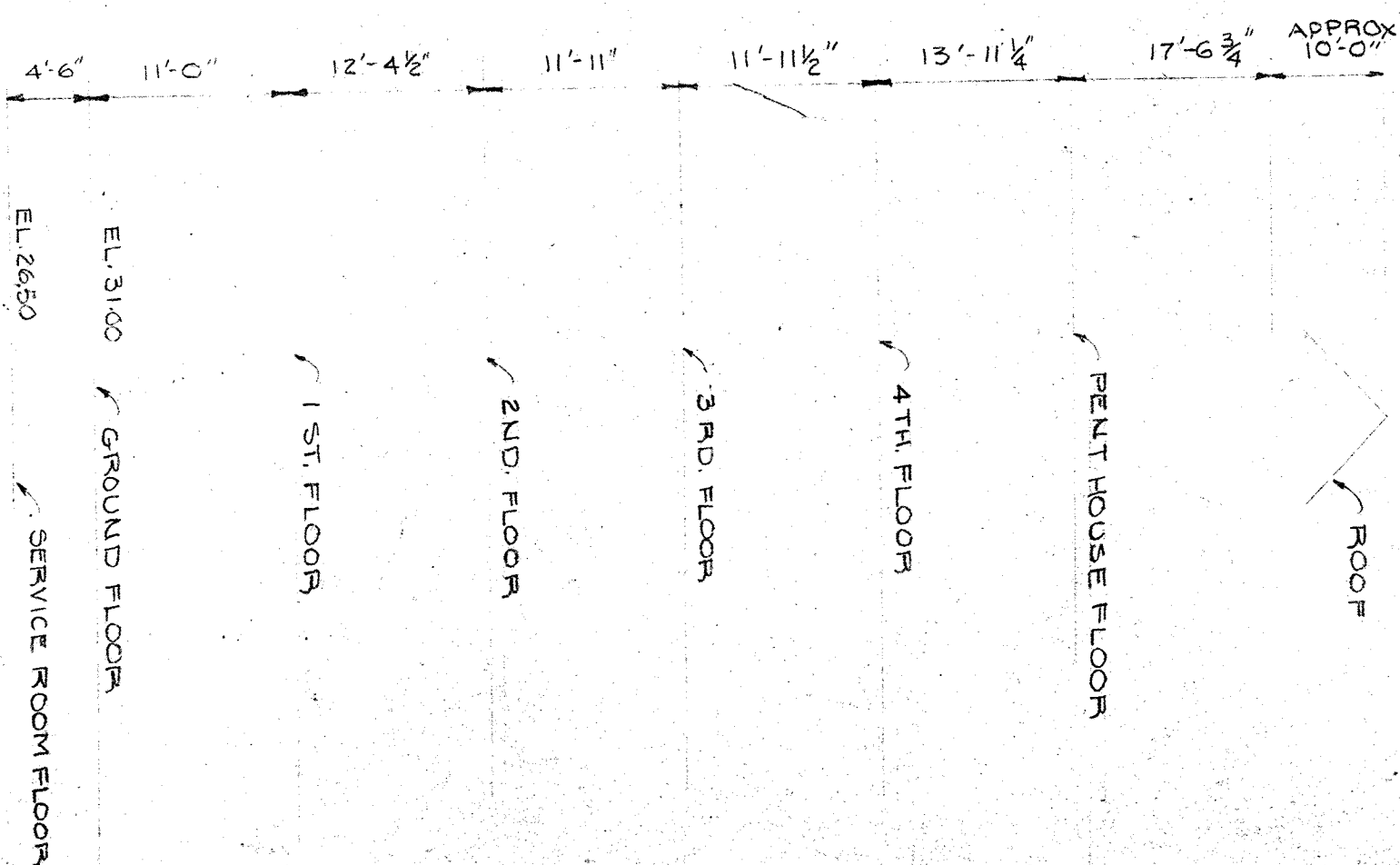

APPROVED <i>James R. Edmunds, Jr.</i> DIRECTOR, DESIGN SERVICE	
THE OFFICE OF JAMES R. EDMUNDS, JR. ARCHITECTS 1025 ST. PAUL ST. BALTIMORE 2, MD.	
PROJECT NO. 19-5123	SHEET 156 OF 196
DRAWN BY: J.E. CHECKED BY: J.E. DATE: FEB. 1957	
REVISIONS	
NUMBER 23H- H-1	
PERRY POINT, MD. VETERANS ADMINISTRATION ADDITIONS & ALTERATIONS TO BUILDINGS & UTILITIES	
- PIPE BASEMENT PLAN - - G.M.S. BUILDING 23H -	