

NO.	BUILDING SCHEDULE
1	MAIN HOSPITAL BUILDING
2	RESEARCH & WAREHOUSE
7	CHILLER PLANT BUILDING
8	RECYCLING BUILDING
9	EMERGENCY GENERATOR
10	WALK-IN SWITCHGEAR
11	TRANSFORMER PAD
12	TRANSFORMER PAD
13	TRANSFORMER PAD
14	MAIN ENTRANCE SIGN
15	TRANSFORMER BUILDING
16	BOILER PLANT
17	TRANSFORMER
18	OXYGEN STORAGE
19	STORAGE BUILDING
20	MISCELLANEOUS SERVICE BUILDING
21	ADMINISTRATION OFFICE BUILDING
23	FUEL OIL PUMP HOUSE
24	GAS METER PIT
26	ENGINEERING STORAGE BUILDING
27	REAR ENTRANCE SIGN
29	SMOKING SHELTER
30	SMOKING SHELTER
32	SMOKING SHELTER
33	TRANSFORMER PAD
34	FLAGPOLE
35	TRANSFORMER PAD
36	INCINERATOR BUILDING
37	SHELTER
38	EMERGENCY GENERATOR BUILDING
39	SMOKING SHELTER
40	RESEARCH
41	RESEARCH
42	RESEARCH

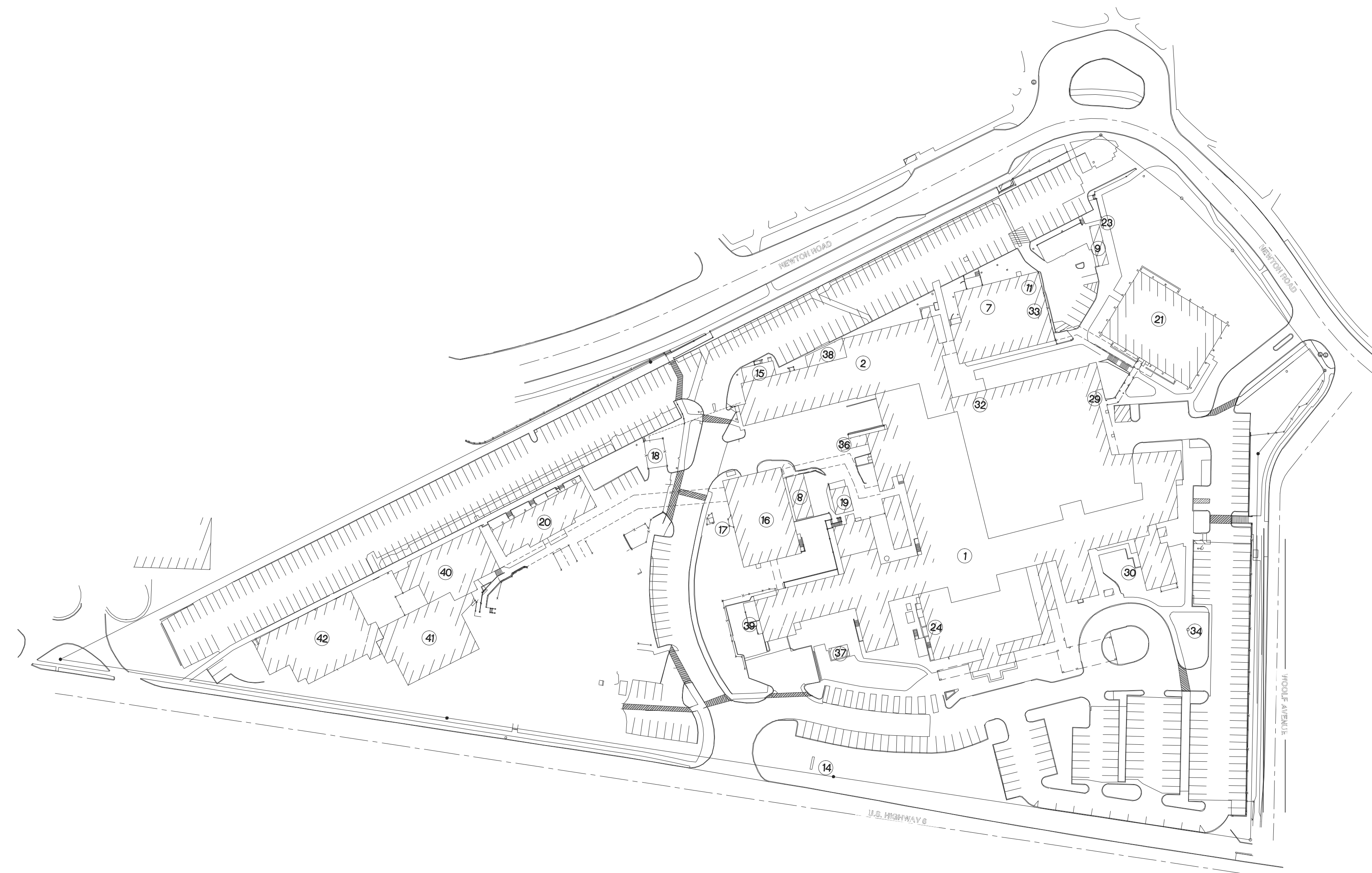

1I	COVER SHEET
1-A1	SUB-BASEMENT FLOOR PLAN - ARCHITECTURAL
1-E1	SUB-BASEMENT FLOOR PLAN - ELECTRICAL
1-E2	BASEMENT FLOOR PLAN - ELECTRICAL
1-E3	FIRST, SECOND, FOURTH, FIFTH, AND SIXTH FLOOR PLANS - ELECTRICAL
1-E4	THIRD FLOOR PLAN - ELECTRICAL
1-E5	TWELFTH FLOOR PLAN - ELECTRICAL
1-E6	ELECTRICAL RISER DIAGRAM
1-E7	ELECTRICAL NOTES AND SCHEDULES
1-E8	ELECTRICAL SCHEDULES
1-E9	ELECTRICAL SCHEDULES

		Architect/Engineer		Project Title		Project Number		<div style="text-align: center;"> <p>Office of Facilities Management</p>  <p>Department of Veterans Affairs</p> </div>	
Approved Supervisor Facility Manager				COVER SHEET		636A8-12-009			
Approved Associate Director Patient Care						Building Number			
Approved Associate Director						1			
Approved Chief of Staff		Key Plan		Approved Project Director		Location		Drawing Number	
Approved Director						IOWA CITY, IOWA		<div style="text-align: center;"> <p>11</p> <p>Dwg. 1 of 11</p> </div>	
Revisions		Stamp		Calvin L. Hinz Architects, P.C. CLH 3010-10 3705 North 200th Street Omaha, Nebraska 68122 Phone: 402.291.6941 Fax: 402.291.3048 www.clh-jew.com				Date 12-14-12	
						Drawn REEWIN		Checked LEEVAN	
								Approved MATSNY	