

AMENDMENT 002

AMENDMENT DATE: February 22, 2013

PROJECT: Canteen Retail Store

BBSAE PROJECT NUMBER: 10031

VA Project No. 636A6-10-712

The information contained in this Addendum modifies, supplements or replaces information contained in the Bidding Documents dated November 1, 2011 and is hereby made a part of the Contract Documents.

Addendum consists of 5 pages of Addendum plus attachments.

ADDENDUM INDEX

APPLICABLE TO THE PROJECT MANUAL	Item #1 only
APPLICABLE TO THE DRAWINGS:	Item #2 through Item #7 inclusive
ATTACHMENTS:	See the end of the Addendum for a list of attachments.

APPLICABLE TO PROJECT MANUAL

ITEM #1 SECTION 01 00 00 – GENERAL REQUIREMENTS

- A. General: At all references to FARs and VAARs **REMOVE** all specific number references.
- B. Reference Article 1.1. **Replace** Paragraph D with the following:
Before placement and installation of work subject to tests by testing laboratory retained by the Contractor, the Contractor shall notify the Resident Engineer in sufficient time to enable testing laboratory personnel to be present at the site in time for proper taking and testing of specimens and field inspection. Such prior notice shall be not less than three work days unless otherwise designated by the Resident Engineer.
- C. Reference Article 1.3: **Add** new Paragraph E and subparagraphs to read as follows:
 - E. **Document Control:**
 - 1. **Before starting any work, the General Contractor/Sub Contractors shall submit an electronic security**

memorandum describing the approach to following goals and maintaining confidentiality of “sensitive information”.

2. The General Contractor is responsible for safekeeping of all drawings, project manual and other project information. This information shall be shared only with those with a specific need to accomplish the project.
4. Certain documents, sketches, videos or photographs and drawings may be marked “Law Enforcement Sensitive” or “Sensitive Unclassified”. Secure such information in separate containers and limit the access to only those who will need it for the project. Return the information to the Contracting Officer upon request.
5. These sensitive documents shall not be removed or transmitted from the project site without the written approval of Contracting Officer.
6. All paper waste or electronic media such as CD’s and diskettes shall be shredded and destroyed in a manner acceptable to the VA.
7. Notify Contracting Officer and Site Security Officer immediately when there is a loss or compromise of “sensitive information”.

D. Reference Article 1.4: Replace Paragraph E (and subparagraphs) with the following:

E. Temporary Construction Partitions:

1. Install and maintain temporary construction partitions to provide smoke-tight separations between construction areas and adjoining areas. Construct partitions of gypsum board or treated plywood (flame spread rating of 25 or less in accordance with ASTM E84) on both sides of fire retardant treated wood or metal steel studs. Extend the partitions through suspended ceilings to floor slab deck or roof. Seal joints and penetrations. At door openings, install Class C, ¾ hour fire/smoke rated doors with self-closing devices.
2. Install one-hour fire-rated temporary construction partitions as shown on drawings to maintain integrity of existing exit stair enclosures, exit passageways, fire-rated enclosures of hazardous areas, horizontal exits, smoke barriers, vertical shafts and openings enclosures.
3. Close openings in smoke barriers and fire-rated construction to maintain fire ratings. Seal penetrations with listed through-penetration firestop materials in accordance with Section 07 84 00, FIRESTOPPING.

APPLICABLE TO DRAWINGS

ITEM #2 SHEET AD101 – FIRST FLOOR DEMOLITION PLAN

A. ADD a General Access Note to read as follows:

CONTRACTOR TO USE THE EXISTING EXTERIOR DOOR AS THE PRIMARY PROJECT ACCESS. SCHEDULE CONCRETE WORK AND OTHER WORK AT THAT ENTRY SO THAT DELIVERIES CAN BE MADE WHEN THE DOOR CAN BE USED. CONTRACTOR MAY USE EXISTING WINDOW OPENINGS FOR REMOVAL OF DEBRIS AND DELIVERY OF MATERIALS. PROTECT EXISTING TRANSFORMER AND ALL EXISTING EQUIPMENT AND CONSTRUCTION TO REMAIN.

ITEM #3 SHEET A-101 – FIRST FLOOR PLAN AND SCHEDULES

- A. Reference Plan A: At the existing ramp to be removed, **MODIFY** the ramp to show the current condition (the ramp has been enlarged since drawing was issued) and **RELOCATE** the temporary walls as required to enclose the revised Work Area.

- B. NOTE: The room numbers and door numbers have been changed to conform to the new numbering system. The final drawings will have the new room numbers, but, since the room configurations have not changed, the drawing is not being reissued. For reference the following have changed:

<u>Room</u>	<u>Old Number</u>	<u>New Number</u>
Retail Store	126R	1050
Retail Stock Room	127R	1052
Entry	100	1050A

<u>Doors</u>	<u>Old Number</u>	<u>New Number</u>
	126R-1	1050-1
	126R-2	1050-2
	127R	1052

- C. **ADD** a General Access Note to read as follows:
CONTRACTOR TO USE THE EXISTING EXTERIOR DOOR AS THE PRIMARY PROJECT ACCESS. SCHEDULE CONCRETE WORK AND OTHER WORK AT THAT ENTRY SO THAT DELIVERIES CAN BE MADE WHEN THE DOOR CAN BE USED. CONTRACTOR MAY USE EXISTING WINDOW OPENINGS FOR REMOVAL OF DEBRIS AND DELIVERY OF MATERIALS. PROTECT EXISTING TRANSFORMER AND ALL EXISTING EQUIPMENT AND CONSTRUCTION TO REMAIN.

- D. **ADD** SITE AREA PLAN B – Issued herewith as SD-01.

- E. **ADD** GENERAL SITE USE NOTES to read as follows:

- 1. MAINTAIN ACCESS TO BUILDING 2, STAIRWELL #1 DOOR AT ALL TIMES.**
- 2. PROVIDE AND MAINTAIN ORANGE CONSTRUCTION FENCE AROUND STOOP AND OTHER EXTERIOR WORK AREAS. FENCE MAY BE SUPPORTED ON WEIGHTED RUBBER PYLONS RATHER THAN PENETRATING THE EXISTING WALK.**
- 3. PROVIDE PEDESTRIAN SAFETY CONTROL WHEN USING THE STOOP ACCESS PARTICULARLY DURING DEMOLITION**

OPERATIONS.

4. **NEITHER THE CONTRACTOR NOR ANY SUBCONTRACTOR IS PERMITTED TO DUMP DEMOLITION DEBRIS INTO THE DUMPSTER WITHOUT HAVING A SAFETY SPOTTER ON THE SIDEWALK LEADING TO BUILDING 2.**
5. **KEEP THE SIDEWALK CLEAR AT ALL TIMES OF DEMOLITION AND/OR CONSTRUCTION DEBRIS. VERIFY THAT THE SIDEWALK IS CLEAR AND CLEAN AT THE END OF EACH WORK SHIFT.**
6. **REPLACE ANY ALL DAMAGED PCC SIDEWALK OR DRIVE CAUSED BY THIS WORK. PANELS SHALL BE REMOVED TO THE NEAREST JOINT AND REPLACED. ENSURE POSITIVE DRAINAGE ON ALL REPLACED PCC.**
7. **CONTRACTOR MAY USE THE EXTERIOR DOOR TO THE WORK AREA OR WINDOW OPENINGS FOR PASSING MATERIALS OR DEBRIS. THE KITCHEN EXIST DOOR MAY ALSO BE USED BY OBTAINING PRIOR WRITTEN PERMISSION AND COORDINATION WITH FIRE CHIEF.**
8. **A STAGING AREA WILL BE AVAILABLE IN THE COMPACTED GRAVEL AREA WEST OF THE SMOKE SHACK. CONTRACTOR CAN ALSO USE THE FENCED STAGING AREA EAST OF THE DAY PLAZA LOCATED WEST OF PARKING LOT 7M.**

ITEM #4 SHEET A-102

- A. Reference Detail A: **Show** existing wall bumper rail at the existing dining room. **ADD** a note to **cut back the bumper** and **re-terminated** to permit construction of the new wall.

ITEM #5 SHEET A-601 – REFLECTED CEILING PLANS – DEMOLITION AND NEW

- A. **ADD** General Note 1 to read:
IN SPS AREA AT THE BASEMENT BELOW THE WORK AREA, WHERE ABOVE CEILING PLUMBING WORK IS REQUIRED, REMOVE AND STORE EXISTING CEILING TILES AND DISMANTLE AND STORE GIRD AS REQUIRED TO PERMIT REMOVAL OF PIPING, ETC. AND TO PROTECT THE CEILING SYSTEM. REINSTALL CEILING GRID AND TILES AT THE END OF EACH WORK SESSION EXCEPT AS SPECIFICALLY AUTHORIZED IN WRITING BY THE OWNER. CONTRACTOR IS RESPONSIBLE TO REPLACE ANY DAMAGED GIRD AND TILE TO MATCH EXISTING. CONTRACTOR TO PROVIDE FIVE (5) WORKING DAYS' NOTICE TO THE OWNER PRIOR TO BEGINNING WORK IN THE SPS AREA

ITEM #6 SHEET PD101 – FIRST FLOOR PLUMBING DEMOLITION PLAN

- A. **ADD** a General Note to read as follows:
AFTER DEMOLITION OF CEILING AND FLOOR IS COMPLETED ON

**FIRST FLOOR, VERIFY PIPING TO BE REMOVED WITH COTR AND
ENGINEER PRIOR TO PLUMBING PIPING DEMOLITION.**

- B. **ADD** vent piping demolition as shown on revised plumbing drawing SD-02.

ITEM #7 SHEET P101 –PLUMBING PLANS

- A. **DELETE** all new work indicated on both first floor and basement plumbing plans.

APPLICABLE TO ATTACHMENTS:

1. Supplementary Drawing (Site Area Plan) SD-01 (1 -8½x11 Pages).
2. Supplementary Drawing (Revised Plumbing) Drawing SD-02 (1 -8½x11 Pages).

END OF AMENDMENT 002
Issued February 22, 2013

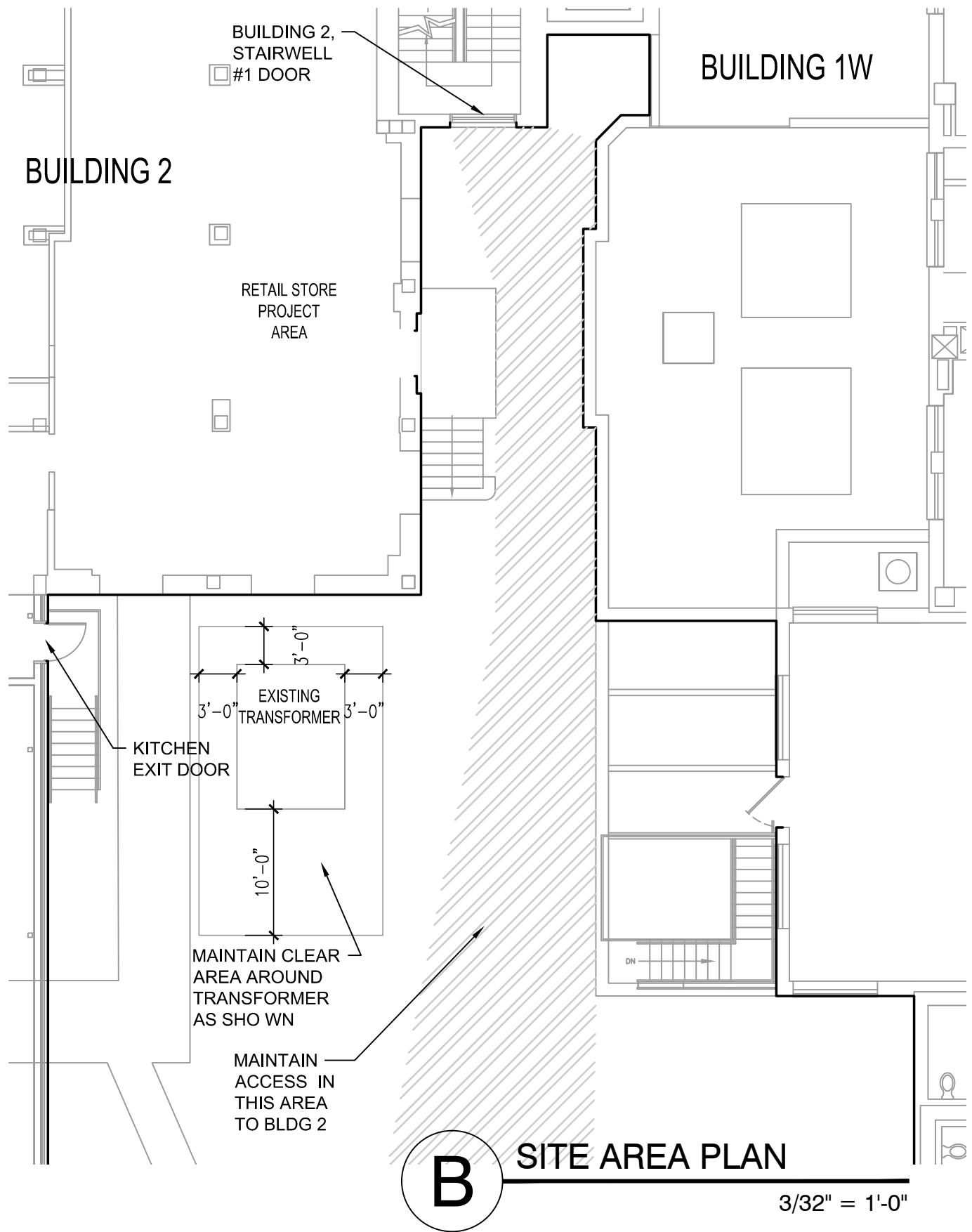

VA RETAIL STORE
BUILDING #2
CENTRAL IOWA HC
DES MOINES, IA

PROJECT 10031
636A6-10-712
DATE 02-22-2013
SCALE AS NOTED

SHEET TITLE
AREA SITE PLAN
REFERENCE SHT A101

SHEET NO.
SD-01

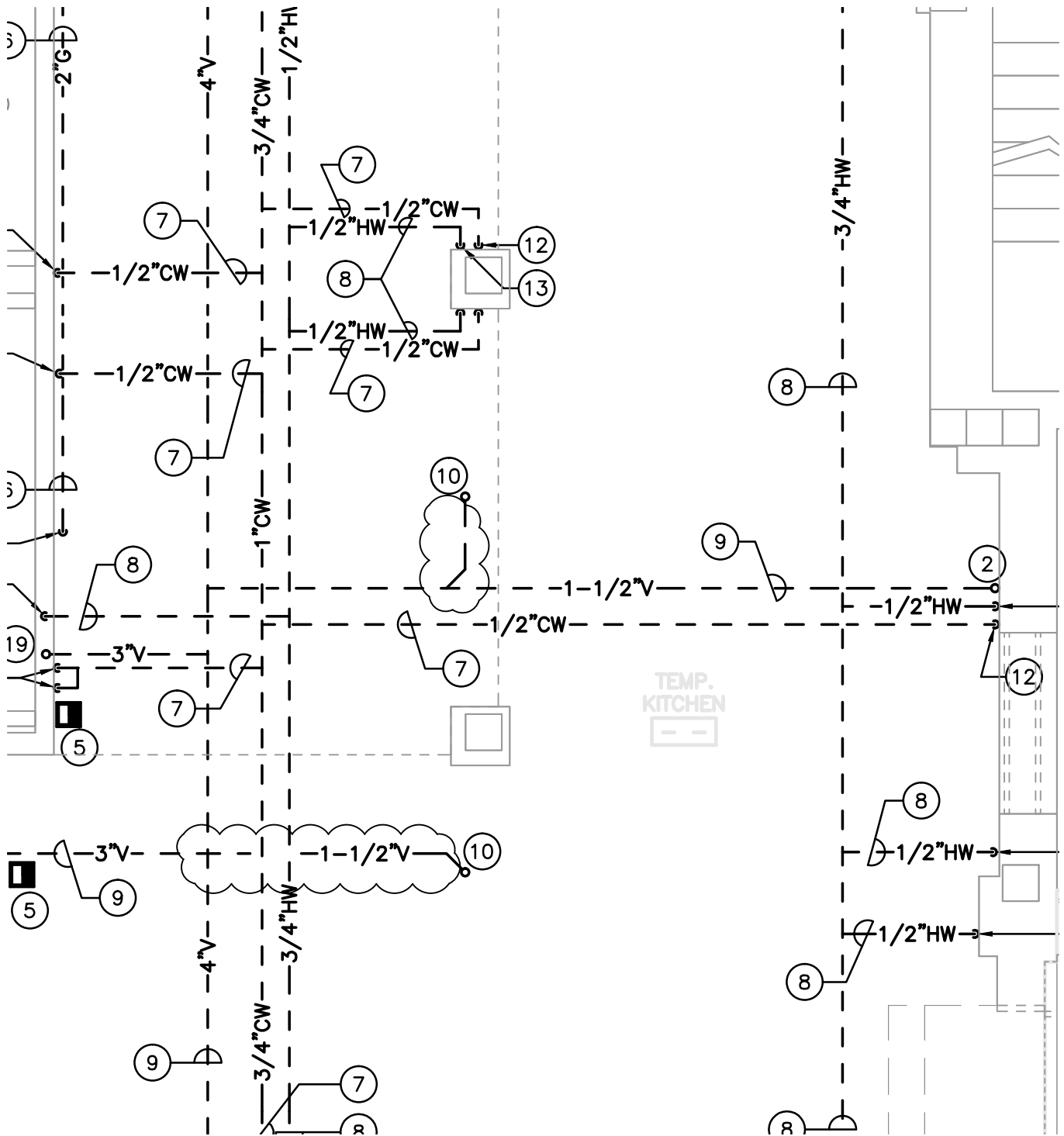

A

FIRST FLOOR PLUMBING DEMOLITION PLAN

1/4" = 1'-0"

CANTEEN RETAIL STORE

DES MOINES, IA

PROJECT 10031

DATE 02-22-2013

SCALE 1/4"=1'-0"

SHEET TITLE
PD101 - PLUMBING DEMOLITION PLANS

SHEET NO.

SD-02

ADD #001