

- PARTIAL ROOM LEGEND**
 PLAN AREA A
 101-102
 103-104
 105-106
 107-108
 109-110
 111-112
 113-114
 115-116
 117-118
 119-120
 121-122
 123-124
 125-126
 127-128
 129-130
 131-132
 133-134
 135-136
 137-138
 139-140
 141-142
 143-144
 145-146
 147-148
 149-150
 151-152
 153-154
 155-156
 157-158
 159-160
 161-162
 163-164
 165-166
 167-168
 169-170
 171-172
 173-174
 175-176
 177-178
 179-180
 181-182
 183-184
 185-186
 187-188
 189-190
 191-192
 193-194
 195-196
 197-198
 199-200
 201-202
 203-204
 205-206
 207-208
 209-210
 211-212
 213-214
 215-216
 217-218
 219-220
 221-222
 223-224
 225-226
 227-228
 229-230
 231-232
 233-234
 235-236
 237-238
 239-240
 241-242
 243-244
 245-246
 247-248
 249-250
 251-252
 253-254
 255-256
 257-258
 259-260
 261-262
 263-264
 265-266
 267-268
 269-270
 271-272
 273-274
 275-276
 277-278
 279-280
 281-282
 283-284
 285-286
 287-288
 289-290
 291-292
 293-294
 295-296
 297-298
 299-300
 301-302
 303-304
 305-306
 307-308
 309-310
 311-312
 313-314
 315-316
 317-318
 319-320
 321-322
 323-324
 325-326
 327-328
 329-330
 331-332
 333-334
 335-336
 337-338
 339-340
 341-342
 343-344
 345-346
 347-348
 349-350
 351-352
 353-354
 355-356
 357-358
 359-360
 361-362
 363-364
 365-366
 367-368
 369-370
 371-372
 373-374
 375-376
 377-378
 379-380
 381-382
 383-384
 385-386
 387-388
 389-390
 391-392
 393-394
 395-396
 397-398
 399-400
 401-402
 403-404
 405-406
 407-408
 409-410
 411-412
 413-414
 415-416
 417-418
 419-420
 421-422
 423-424
 425-426
 427-428
 429-430
 431-432
 433-434
 435-436
 437-438
 439-440
 441-442
 443-444
 445-446
 447-448
 449-450
 451-452
 453-454
 455-456
 457-458
 459-460
 461-462
 463-464
 465-466
 467-468
 469-470
 471-472
 473-474
 475-476
 477-478
 479-480
 481-482
 483-484
 485-486
 487-488
 489-490
 491-492
 493-494
 495-496
 497-498
 499-500
 501-502
 503-504
 505-506
 507-508
 509-510
 511-512
 513-514
 515-516
 517-518
 519-520
 521-522
 523-524
 525-526
 527-528
 529-530
 531-532
 533-534
 535-536
 537-538
 539-540
 541-542
 543-544
 545-546
 547-548
 549-550
 551-552
 553-554
 555-556
 557-558
 559-560
 561-562
 563-564
 565-566
 567-568
 569-570
 571-572
 573-574
 575-576
 577-578
 579-580
 581-582
 583-584
 585-586
 587-588
 589-590
 591-592
 593-594
 595-596
 597-598
 599-600
 601-602
 603-604
 605-606
 607-608
 609-610
 611-612
 613-614
 615-616
 617-618
 619-620
 621-622
 623-624
 625-626
 627-628
 629-630
 631-632
 633-634
 635-636
 637-638
 639-640
 641-642
 643-644
 645-646
 647-648
 649-650
 651-652
 653-654
 655-656
 657-658
 659-660
 661-662
 663-664
 665-666
 667-668
 669-670
 671-672
 673-674
 675-676
 677-678
 679-680
 681-682
 683-684
 685-686
 687-688
 689-690
 691-692
 693-694
 695-696
 697-698
 699-700
 701-702
 703-704
 705-706
 707-708
 709-710
 711-712
 713-714
 715-716
 717-718
 719-720
 721-722
 723-724
 725-726
 727-728
 729-730
 731-732
 733-734
 735-736
 737-738
 739-740
 741-742
 743-744
 745-746
 747-748
 749-750
 751-752
 753-754
 755-756
 757-758
 759-760
 761-762
 763-764
 765-766
 767-768
 769-770
 771-772
 773-774
 775-776
 777-778
 779-780
 781-782
 783-784
 785-786
 787-788
 789-790
 791-792
 793-794
 795-796
 797-798
 799-800
 801-802
 803-804
 805-806
 807-808
 809-810
 811-812
 813-814
 815-816
 817-818
 819-820
 821-822
 823-824
 825-826
 827-828
 829-830
 831-832
 833-834
 835-836
 837-838
 839-840
 841-842
 843-844
 845-846
 847-848
 849-850
 851-852
 853-854
 855-856
 857-858
 859-860
 861-862
 863-864
 865-866
 867-868
 869-870
 871-872
 873-874
 875-876
 877-878
 879-880
 881-882
 883-884
 885-886
 887-888
 889-890
 891-892
 893-894
 895-896
 897-898
 899-900
 901-902
 903-904
 905-906
 907-908
 909-910
 911-912
 913-914
 915-916
 917-918
 919-920
 921-922
 923-924
 925-926
 927-928
 929-930
 931-932
 933-934
 935-936
 937-938
 939-940
 941-942
 943-944
 945-946
 947-948
 949-950
 951-952
 953-954
 955-956
 957-958
 959-960
 961-962
 963-964
 965-966
 967-968
 969-970
 971-972
 973-974
 975-976
 977-978
 979-980
 981-982
 983-984
 985-986
 987-988
 989-990
 991-992
 993-994
 995-996
 997-998
 999-1000

GENERAL NOTES
 1. ALL EMERGENCY LIGHTING, EXIT SIGNS AND NIGHT LIGHTS ARE UNIDENTIFIED.

- SHEET WORK NOTES**
 1. SINGLE ROOM CONTROLLER - SEE DETAILS 3/ED.3 & 3/ED.3
 2. PATIENT HEAD WALL BED LIGHT TO BE CONTROLLED VIA THE FOLLOWING: CONTROL TO PROVIDE A READING LEVEL AND UPON CURRENT LEVEL, BOTH READING AND AMBIENT LIGHT LEVEL, AND OFF.
 3. CIRCUIT CONTROLLED VIA LIGHTING RELAY PANEL LCC-1.
 4. 1 BUTTON SWITCH - SEE DETAIL 8/ED.3
 5. MOUNT TYPE B1 IN THIS ROOM AT 3'-6" TO BOTTOM OF TEXTURE.

**THIRD FLOOR - AREA A
 ELECTRICAL LIGHTING PLAN**
 1/2" = 1'-0"

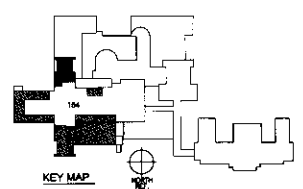

CONSULTANTS [Blank space for consultant information]		ARCHITECT/ENGINEERS OTA ARCHITECTS ENGINEERS 13 N BOND STREET SUITE 1430 (OFFICE) BIRMINGHAM, AL 35203 PHONE (205) 240-7400 FAX (205) 240-7400 275 Project Number: 154-E21		THIRD FLOOR ELECTRICAL LIGHTING PLAN PROJECT NO. 154-E21 SHEET NO. 154-E21 DATE 08/10/10 DRAWN BY [Signature] CHECKED BY [Signature]		CLIENT CORRECT PATIENT FINANCIAL SERVICES VA MONTANA HEALTHCARE SYSTEM 154-E21 08/10/10	
--	--	---	--	---	--	---	--

