

NORTH
SCALE: 3/8" = 1'



NEW WORK NOTES:

- 1
- PROVIDE AND INSTALL METAL STUD WALL FROM FLOOR TO 6" ABOVE CEILING GRID HEIGHT, 5/8" SHEETROCK BOTH SIDES.
- 2
- PROVIDE AND INSTALL ELECTRIC OUTLET, WIRING AND STAINLESS STEEL FACE PLATE
- 3
- PROVIDE AND INSTALL INPRO 3500 SERIES HANDRAIL, TYPE AND QUALITY TO MATCH EXISTING IN THE CORRIDOR (QTY. 5 L.F.)
- 4
- PROVIDE AND INSTALL NEW SOLID BIRCH WOOD DOOR, METAL FRAME, BEST LOOKS, 7KC SERIES, INTERCHANGEABLE CORES, LEVER: 15D, FINISH 626, ALL HARDWARE, FINISH DOORS
- 5
- PROVIDE AND INSTALL NEW AMTICO, VINYL PLANK FLOORING, PRIOR OAK, AROWZ200, 4.5"x36", BEVELED EDGE
- 6
- PROVIDE AND INSTALL NEW CEILING TILE AND GRID, BAROQUE, BET-157, 24"x24"x5/8"
- 7
- PROVIDE AND INSTALL KNOCK DOWN FINISH ON WALLS, PAINT WALLS WITH SHERWIN WILLIAMS HARMONY PAINT, PAINT DOOR FRAMES WITH SHERWIN WILLIAMS DTM ACRYLIC
- 8
- PROVIDE AND INSTALL INPRO DOOR FRAME GUARDS, TYPE: CUSTOM FORMED, INPRO DOOR PROTECTION KICKPLATE, TYPE: MODEL 10, K41
- 9
- FINISH WOOD DOOR WITH SHERWIN WILLIAMS WOOD CLASSICS, FRUIT WOOD OIL STAIN, SEMI-GLOSS LACQUER, 2-COATS SANDING SEALER

DEMO NOTES:

- 1D
- DEMO EXISTING WALL TO THE SUBSTRATE, WINDOW, METAL FRAME AND METAL COUNTERTOP. REPAIR ADJACENT WALLS AS NEEDED.
- 2D
- DEMO ELECTRICAL WITHIN WALL BACK TO THE NEAREST J-BOX
- 3D
- DEMO METAL FRAME DOOR OPENING AND THE WALL ABOVE
- 4D
- DEMO COVE BASE

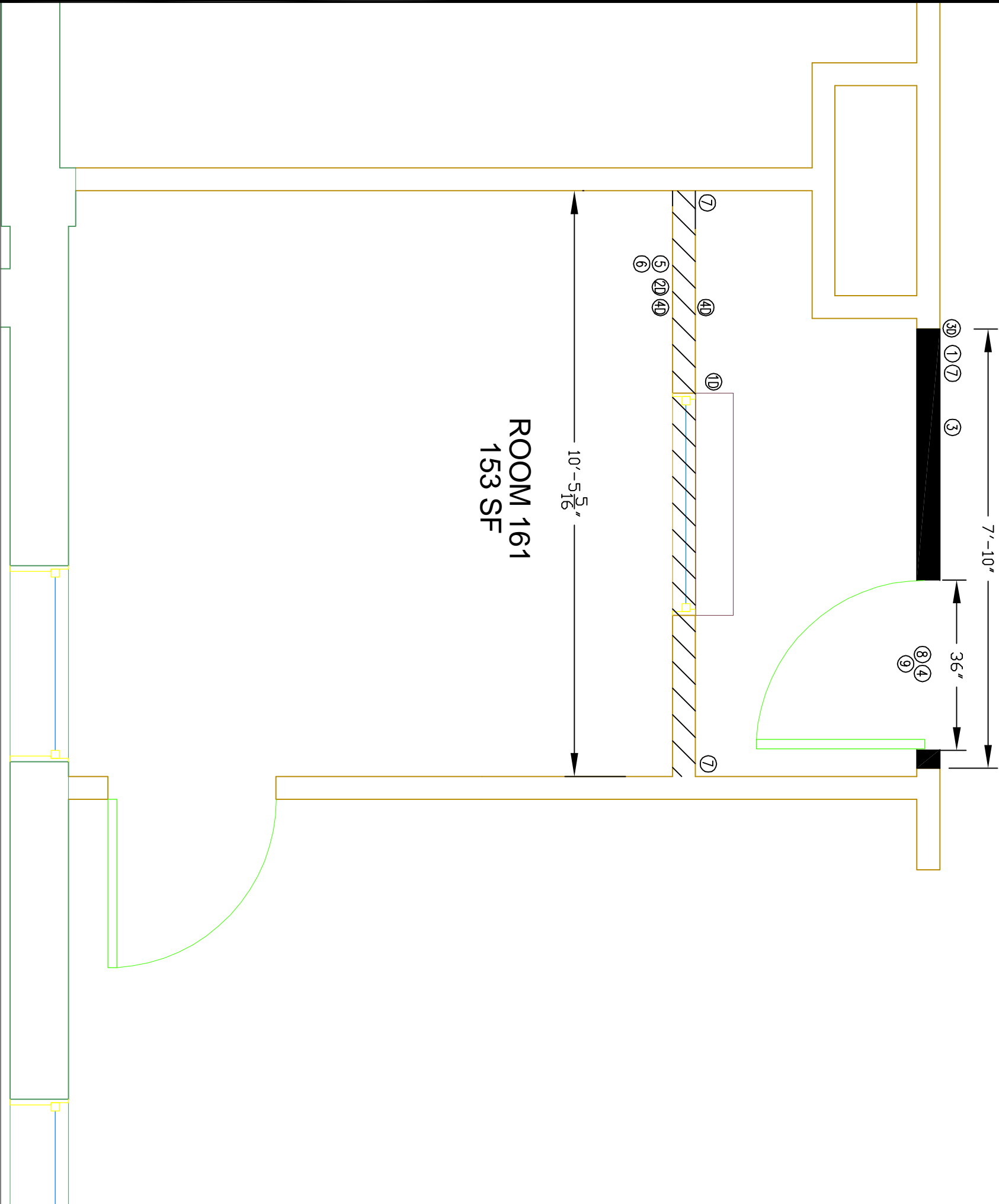

LEGEND

- NEW METAL STUD WALL WITH 5/8" SHEETROCK
- DEMO WALL

PRIMARY CARE PHASE III
ROOM 161
SHEET 106

GENERAL NOTES (APPLIES TO ALL SHEETS):
CONTRACTOR WILL MAINTAIN NEGATIVE PRESSURE, VACUUM WITH HEPA FILTER TO CLEAN OFF CLOTHES/SHOES, PROVIDE AND INSTAL PLASTIC OVER ALL RETURN AIR OPENINGS, AND STICKY MATS AT EACH ENTRANCE/EXIT TO THE CONSTRUCTION AREAS. ALL CEILING DEVICES ARE TO BE TEMPORARILY MOVED AND PLACED BACK INTO THE ORIGINAL LOCATION AFTER THE CEILING TILE AND GRID ARE INSTALLED. ALL WORK WILL BE DURING NORMAL BUSINESS HOURS, 7:30 A.M. TO 4:00 P.M., M-F UNLESS OTHERWISE APPROVED BY THE VA ENGINEER.