

SPACE	SPACE			37	A	38			SPACE
SPACE	SPACE			39	B	40			SPACE
SPACE	SPACE			41	C	42			SPACE

CONTROL, LEGEND: L-LIGHTING, R-RECEPTACLES, M-MOTORS, H-RESISTANCE HEAT, C-CONTROL, LOCKING MLO- MAIN LUGS ONLY, DSL- DOUBLE SET OF LUGS, MB-MAIN BREAKER, LC-LOCKING CLIP, SFL-SUB FEED LUGS

## GENERAL NOTES

A.- ALL NEW CONDUITS SHALL BE RUN IN EXISTING OR NEW CHASES.

B.- ALL CONDUITS SHALL BE PROVIDED CONCEALED ABOVE EXISTING CEILINGS IN FINISHED AREAS WHERE POSSIBLE.

C.- ALL DEMOLISHED ELECTRICAL FEEDS SHALL BE REMOVED BACK TO SOURCE AND MARKED AS SPARE. SPARE BREAKERS MAY BE REUSED AS PART OF THE NEW WORK DESCRIBED IN THESE DOCUMENTS.

D.- CONNECT SMOKE DUCT DETECTORS TO EXISTING FIRE ALARM SYSTEM. PROVIDE ALL NECESSARY BOOSTER PANELS, SYSTEM PROGRAMMING, RELAYS, ETC FOR COMPLETE OPERATING SYSTEM.

E.-PROVIDE A LABELED EMERGENCY MANUAL CONTROL SHUT OFF BUTTON NEAR THE FIRE ALARM ANNUNCIATOR PANEL PER NFPA 90A.



GND

HC

JB

MH

NIC

PC

R

RD

S

TYP

WG

WP

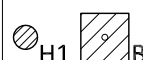
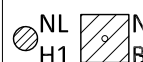
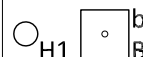

1 DEL Bulletin #1  
RFI Date: 03-15-13



DATE: 03-15-13

PROJECT NO.: 120050

DWN BY: SWH

MODERNIZE HVAC B115

DAYTON VAMC

BUILDING 115

**Dynamix**  
Engineering Ltd.  
Facility Engineering Consultants

COPYRIGHT  
DYNAMIX ENGINEERING LTD. ALL RIGHTS RESERVED

REVISES SHEET  
E0

**SK1-E0**