

three inches = one foot
one and one half inches = one foot
one inch = one foot
three quarters inch = one foot
one half inch = one foot
one quarter inch = one foot
three eighths inch = one foot
one eighth inch = one foot

GENERAL NOTES

- FOR SIMPLICITY AND CLARITY BRANCH FEEDER CONDUIT AND WIRES IS NOT SHOWN ON THE DRAWING. ONLY CIRCUIT NUMBER TO THE EQUIPMENT AND HOMERUNS ARE SHOWN. CONTRACTOR SHALL PROVIDE AND INSTALL BRANCH FEEDER CONDUITS, OUTLET BOXES, WIRE AND JUNCTION BOXES FOR NEW WIRING INSTALLATION. ALL HOMERUN CIRCUITS ARE 6#10 AND 1#10 GND (GRN) IN A 3/4" CONDUIT, UNLESS OTHERWISE NOTED.
- CIRCUIT NUMBERS WITHOUT IDENTIFICATION ARE FROM PNL '1NL2'; OTHERS ARE PRECEDED BY PANEL IDENTIFICATION.
- BACK TO BACK RECEPTACLES SHALL BE SPACED AT LEAST 12" APART.
- TELECOMMUNICATION DEVICES AND POWER RECEPTACLES SHALL BE MINIMUM 6" APART.
- TELECOMMUNICATION DEVICES (FACEPLATES/JACKS) SHALL BE CAT 6 AND HAVE THE FOLLOWING:
 - FACE PLATE SHALL BE IVORY IN COLOR.
 - EACH PLATE SHALL HAVE 4 PORTS (2 VOICE & 2 DATA), UNLESS OTHERWISE NOTED. DATA PORT ON TOP AND VOICE PORT ON BOTTOM.
 - DATA SHALL BE GREEN IN COLOR & VOICE SHALL BE WHITE IN COLOR.
 - VOICE & DATA WIRING SHALL MEET ANSI/TIA/EI-T568A STANDARDS. WIRES SHALL BE PLENUM TYPE. VOICE WIRES SHALL BE CAT 5E AND DATA WIRES SHALL BE CAT 6.
 - FACEPLATE LABELING SHALL MATCH CURRENT EXISTING VAMC STANDARDS.
 - DATA ONLY FACEPLATE SHALL HAVE 2 PORTS.
 - TELEPHONE ONLY FACEPLATE SHALL HAVE 1 PORT.
- ALL CONDUITS SHALL BE CONCEALED WHENEVER POSSIBLE.
- ALL SHOULD CONFORM TO APPENDIX 'A' OF THE SPECIFICATIONS.

SHEET NOTES

- PROVIDE CONDUIT AND WIRES PER MANUFACTURER'S RECOMMENDATIONS
- PRESSURE MONITOR DISPLAY
- CONNECT TO DENTURE PROCESSING UNIT. COORDINATE WITH MANUFACTURER FOR LOCATION OF J-BOX AND WIRING REQUIREMENT
- MOUNT RECEPTACLES AND TELECOM OUTLETS +18" AFF AT PARTITION. RUN CONDUITS AND WIRES FOR RECEPTACLES AND TELECOM OUTLETS INSIDE PARTITION SPACE OF BACK TO BACK WORKSTATIONS. ROUTE CONDUITS AND WIRES TO FURRED OUT WALL AND UP TO CEILING AT FULL HEIGHT FURRED WALL FOR HOMERUN.
- CONTRACTOR TO FIELD LOCATE ALL (E) RECEPTACLES ON EXTERIOR WALLS AND RECONNECT TO PANEL 1NL3, CKT. #28. PROVIDE 2 #10 & 1 #10 GND IN 3/4" CONDUIT WHERE REQUIRED
- ONE (1) 3"C AND ONE (1) 2"C STUB-UP. SEE DWG EP401 FOR CONTINUATION
- CONNECT TO FACP POWER SUPPLY. PROVIDE 2 #10 & 1 #10 IN 3/4"C TO MAIN SWITCHBOARD 'MSB', CKT. #22A
- EMERGENCY SHUT-OFF FOR LAB GAS SUPPLY. PROVIDE 20A, 120/277V, 2-POLE TOGGLE SWITCH AND 2 #10 & 1 #10 GND IN 3/4"C TO SOLENOID VALVE IN BASEMENT EQUIPMENT ROOM. SEE DWG PL300 AND EP401 FOR SOLENOID VALVE LOCATION.
- EMERGENCY SHUT-OFF SWITCH FOR DENTAL WATER SUPPLY. PROVIDE 20A, 120/277V 2-POLE TOGGLE SWITCH AND 2 #10 & 1 #10GND IN 3/4"C TO SOLENOID VALVE IN BASEMENT EQUIPMENT ROOM. SEE DWG PL300 AND EP401 FOR SOLENOID VALVE LOCATION.
- MOUNT RECEPTACLE 4" ABOVE SOAP DISPENSER
- ACCESS CONTROL PANEL

SHEET NOTES

- PROVIDE RECESSED J.B. WITH EASILY ACCESSIBLE COVER FOR TRANSFORMER INSTALLATION
- X-RAY LINE POWER. PROVIDE WIRING AND EQUIPMENT PER X-RAY MANUFACTURER'S RECOMMENDATION
- MOUNT J-BOX AT HEIGHT AND LOCATION PER X-RAY MANUFACTURER'S RECOMMENDATION.
- MOUNT OUTLET ABOVE J-BOX FOR X-RAY.
- PROVIDE RECESSED J-BOX (2" x 4") FOR X-RAY MACHINE REMOTE CONTROL. PROVIDE 3/4" CONDUIT AND WIRING PER X-RAY MANUFACTURER'S RECOMMENDATION
- PROVIDE 1/2" THK x 4"H x 18"W COPPER GROUND BUS MOUNTED 18" A.F.F. PROVIDE INSULATED SPACER BETWEEN GROUND BUS AND SUPPORT
- PROVIDE 20A, 120/277V, 2 POLE TOGGLE SWITCH WALL RECESSED ±6" ABOVE COUNTER TOP FOR ON/OFF CONTROL OF FUME HOOD. PROVIDE 3/4"C AND WIRING TO ROOF MOUNTED EF-5. COORDINATE WITH MECHANICAL FOR WIRING CONNECTION. SEE DWG. EP403 FOR LOCATION OF EF-5
- CONNECT TO SLIDING DOOR OPERATOR. PROVIDE POWER SUPPLY PER DOOR CONTROL MANUFACTURER'S RECOMMENDATIONS
- CONNECT TO (E) FRONT SLIDING DOOR POWER SUPPLY. PROVIDE CONDUIT, WIRING AND RECONNECT (E) MOTION SENSOR WHERE REQUIRED.
- CONNECT TO LAB WORKSTATION POWER SUPPLY
- CONNECT TO DUST COLLECTOR

"FULLY SPRINKLERED"

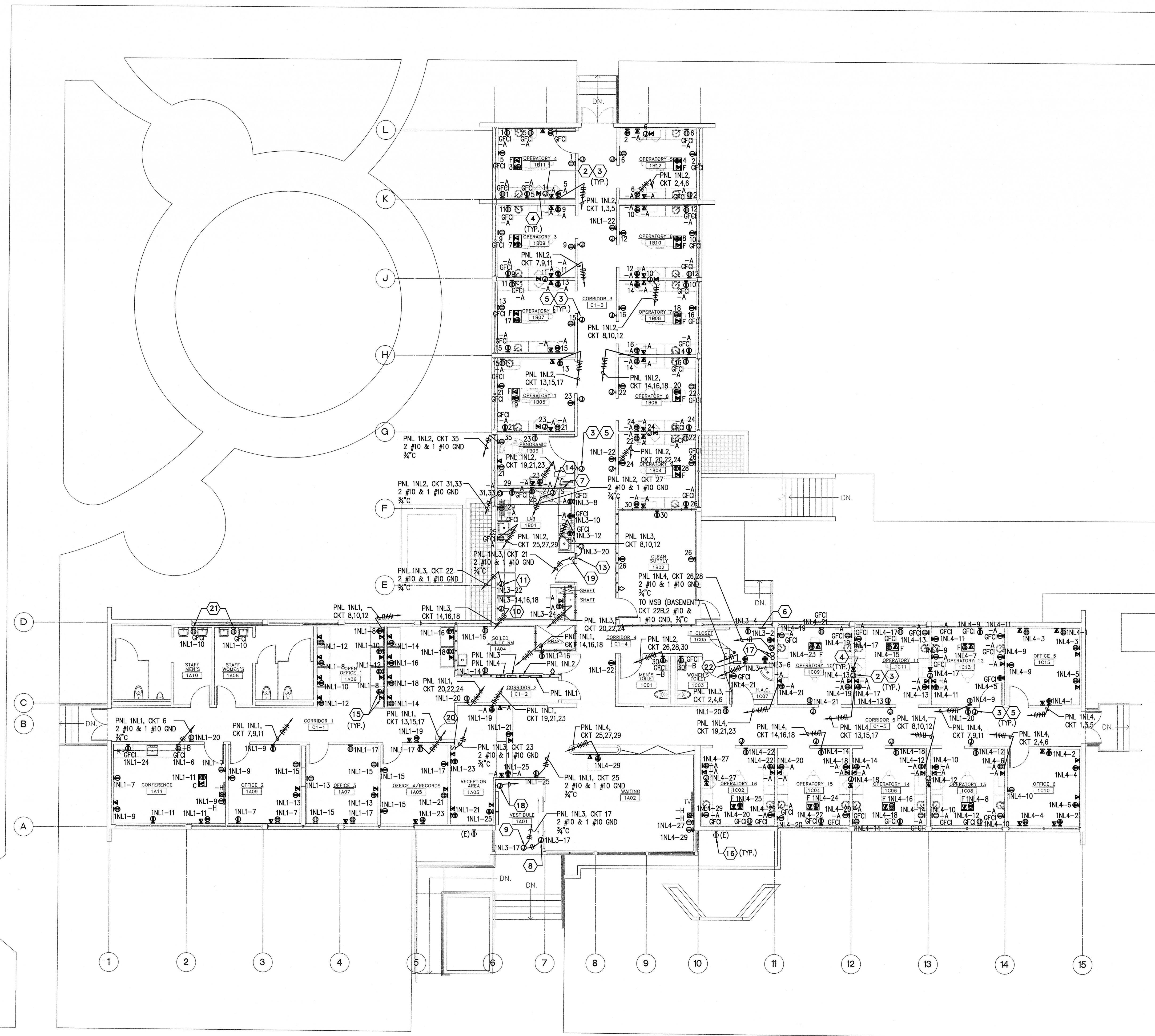

FIRST FLOOR POWER PLAN
SCALE: 1/8" = 1'-0"

CONSULTANTS:

ARCHITECT/ENGINEERS:

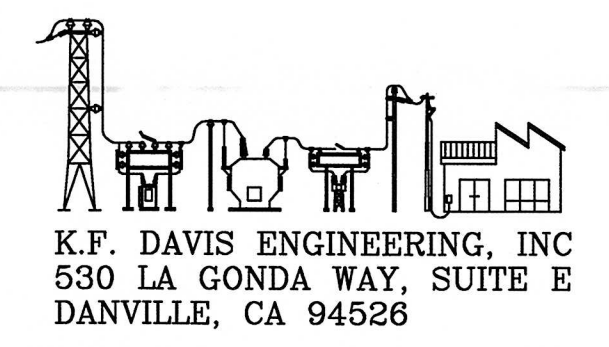
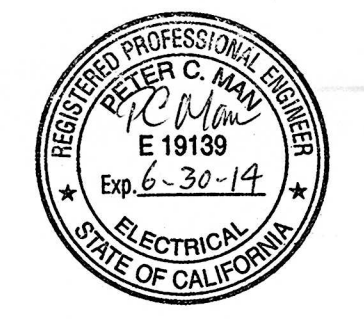

Drawing Title FIRST FLOOR POWER PLAN		Project Title DESIGN OF BUILD BACK BLDG 88 McCLELLAN		Project Number 612-12-288	Office of Facilities Management
Approved: Project Director		Location McCLELLAN, CA		Building Number MCC-88	
		Date 09/12/2012	Checked PCM	Drawn MSA	
				Drawing Number EP402	Dwg. 61 of 73