

three inches = one foot  
one and one half inches = one foot  
one inch = one foot  
three quarters inch = one foot  
one half inch = one foot  
three eighths inch = one foot  
one quarter inch = one foot  
one eighth inch = one foot

GENERAL NOTES

1. PROVIDE 2"D X 8"W WIRE BASKET TRAY ABOVE CORRIDOR, WIREMOLD FIELDMATE WIRE BASKET TRAY CAT. NO. WB10ZP208 OR EQUAL. RUN BASKET TRAY CONCEALED ABOVE CEILING. PROVIDE TRAY SUPPORT ATTACHED TO BUILDING STRUCTURE.
2. GROUND AND BOND WIRE BASKET TRAY PER NEC.

SHEET NOTES

- 1 2"C STUB-UP FOR FIBER OPTIC. SEE DWG. EP401 FOR CONTINUATION
- 2 3"C STUB-UP FOR TELECOM. SEE DWG EP401 FOR CONTINUATION
- 3 PROVIDE CONDUIT AND WIRES PER MANUFACTURER'S RECOMMENDATION
- 4 PROVIDE 20A, 120/277V, 2 POLE SWITCH IN NEMA 1 ENCLOSURE WITH PADLOCKABLE METALLIC COVER FOR POWER DISCONNECT
- 5 PROVIDE ALL THE REQUIRED CONDUITS, WIRES, DEVICES, ETC. TO INTERFACE WITH THE ACCESS CONTROL.
- 6 PROVIDE DOOR POWER SUPPLY PER DOOR CONTROL MANUFACTURER'S RECOMMENDATION
- 7 PROVIDE 3/4"C AND WIRES TO REMOTE DOOR RELEASE BUTTONS
- 8 LOCAL STAND ALONE NURSE CALL IS TO BE EDWARDS SIGNALING & SECURITY SYSTEM. CALL FOR ASSISTANCE KIT. CAT. NO. 6538-G5 OR EQUAL. PROVIDE J.B. FOR TRANSFORMER MOUNTING AND CONDUITS & WIRES FOR SYSTEM INSTALLATION
- 9 PROVIDE VERTICAL BEND TRAY SECTIONS FOR TRANSITION BETWEEN DIFFERENT CEILING HEIGHTS. SEE DWG AS401 FOR CEILING HEIGHTS OF CORRIDORS
- 10 CONNECT TO NURSE CALL SYSTEM POWER SUPPLY
- 11 "REQUEST TO EXIT DEVICE". SEE ACCESS CONTROL DRAWINGS FOR COORDINATION AND ADDITIONAL REQUIREMENTS

"FULLY SPRINKLERED"

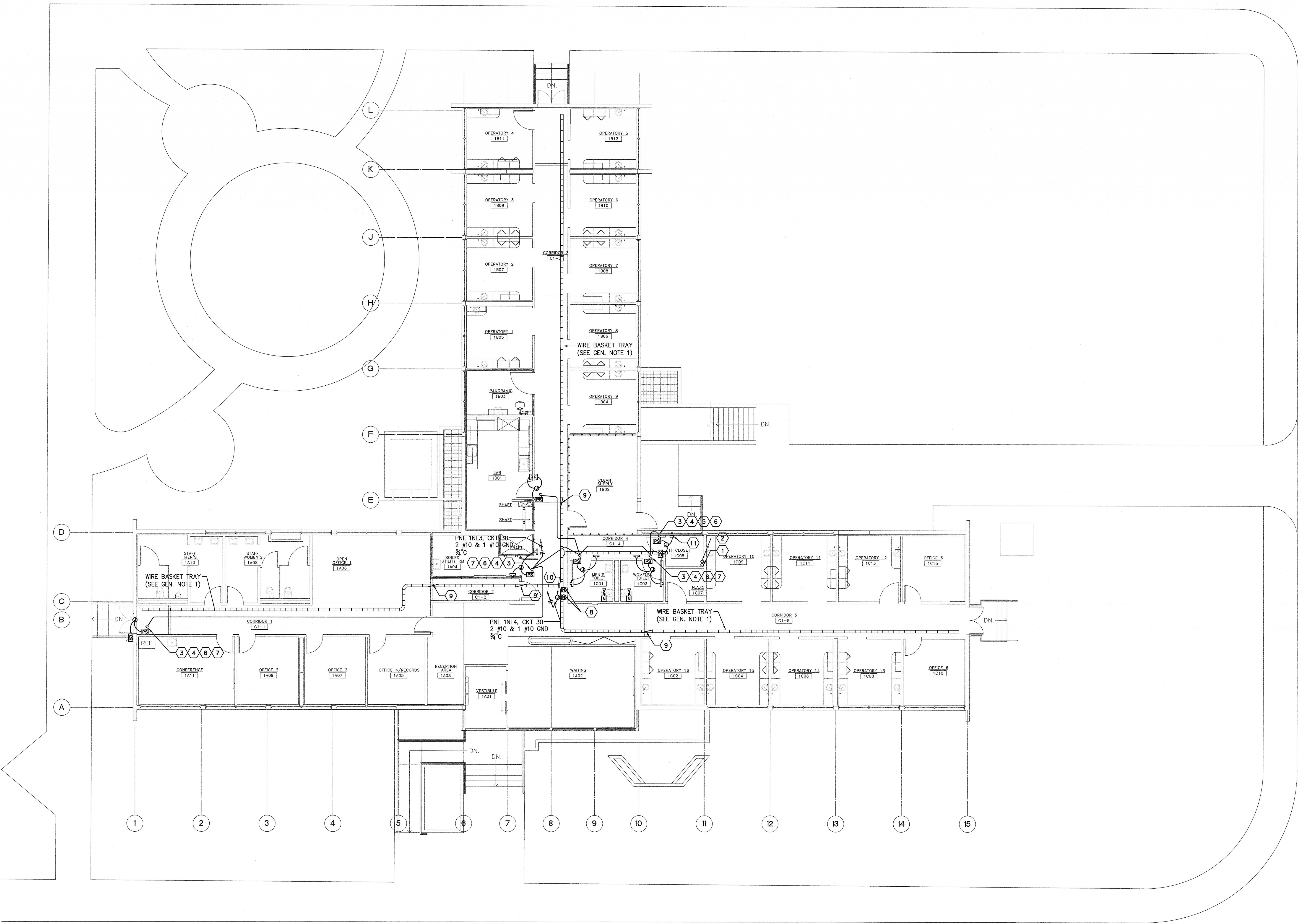

FIRST FLOOR SIGNAL PLAN  
SCALE: 1/8" = 1'-0"



CONSULTANTS:



ARCHITECT/ENGINEERS:

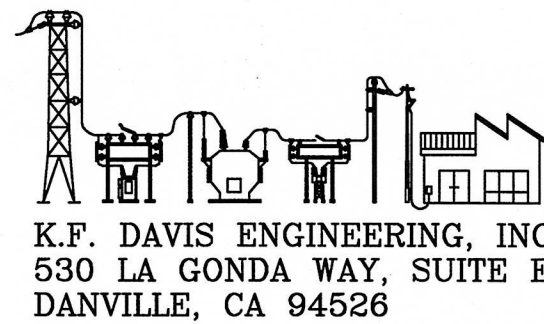

Drawing Title

FIRST FLOOR  
SIGNAL PLAN

Approved Project Director

Project Title

DESIGN OF BUILD BACK  
BLDG 88 McCLELLAN

Location

McCLELLAN, CA

Date

09/12/2012

Checked

PCM

Drawn

MSA

Project Number

612-12-288

Building Number

MCC-88

Drawing Number

EP404

Dwg. 63 of 73

Office of  
Facilities  
Management

