

**GENERAL NOTES:**

THE CONTRACTOR SHALL PROTECT EXISTING LIGHTING, ELECTRICAL OUTLETS, PHONE/DATA JACKS, THERMOSTATS, FIRE & SECURITY SYSTEMS THAT ARE TO REMAIN. CONTRACTOR TO REMOVE COVER PLATES AS NEEDED TO REMOVE WALL FINISHES. QUESTIONS SHOULD BE ADDRESSED WITH THE COR

CONTRACTOR TO TURN OFF VENTILATION, COVER ALL DIFFUSERS, SPRINKLER HEADS & SMOKE DETECTORS DURING CONSTRUCTION TO PREVENT SPREAD OF CONSTRUCTION DUST IN ACCORDANCE WITH SPECIFICATIONS

- SHEET NOTES:**
- ① CARPETING TO BE REMOVED AFTER REMODELING WALLS, MAINTAIN ACCESS TO KEYPAD ON COLUMN THROUGH OUT PROJECT
  - ② NEW MILL WORK TO BE INSTALLED LAST, THIS AREA TO BE USED FOR TEMP LOCATION FOR PHASE 4
  - ③ TEMPORARY PLASTIC WALL TO BE SET UP FOR EMPLOYEE PASSAGE
  - ④ MAINTAIN OPEN SINK THROUGH OUT PROJECT WITH EYEWASH STATION
  - ⑤ VINYL FLOORING TO BE LAST ITEM INSTALLED, PROVIDE MASONITE FOR TRAFFIC, DURING THE FIRST 48 HRS
  - ⑥ PROVIDE TEMPORARY COVER OVER PASS THROUGH DOOR
  - ⑦ LOCATION OF REFRIGERATOR OR FREEZER, TO BE RELOCATED BY VA
  - ⑧ HARD WIRED PANIC ALARM LOCATION, TO BE RELOCATED PER COR (SEE SHEET ED 102)
  - ⑨ THIS FURNISHING ITEM TO BE MOVED BY VA
  - ⑩ FIRE EXTINGUISHER CABINET IN PARTITION
  - ⑪ CURRENT ALARM KEY PAD LOCATION
  - ⑫ INSTALL SECONDARY ALARM KEY PAD, TIE IN WITH EXISTING IN LOCATION SHOWN (SEE NOTE 11)
  - ⑬ LOCATION OF REFRIGERATOR, USE AS TEMP REFRIGERATOR PHASE 1 IN ROOM 1701
  - ⑭ VOLOCITY PC TO BE RELOCATED, PER COR
  - ⑮ MEDICAL VLAN OMNI CELL PC TO BE RELOCATED, TO BE RELOCATED PER COR
  - ⑯ MAIL PC TO BE RELOCATED TO PHASE 5 PASS THRU WINDOW
  - ⑰ MEDICAL PACKAGING MACHINE AND PC, TO BE RELOCATED TO PHASE 1
  - ⑱ MEDICAL VLAN OMNI CELL PC, TO BE RELOCATED TO PHASE 1
  - ⑲ TPN COMPOUNDER PC AND CAMERA, TO BE RELOCATED TO PHASE 1
  - ⑳ REFRIGERATOR TO BE RELOCATED TO PHASE 1, REQUIRES DATA PORTS FOR METASYS & CHECKPOINT

**LEGEND:**

= NO WORK IN THE INTERIOR AREA OF THIS ROOM

= TEMPORARY PLASTIC PARTITION

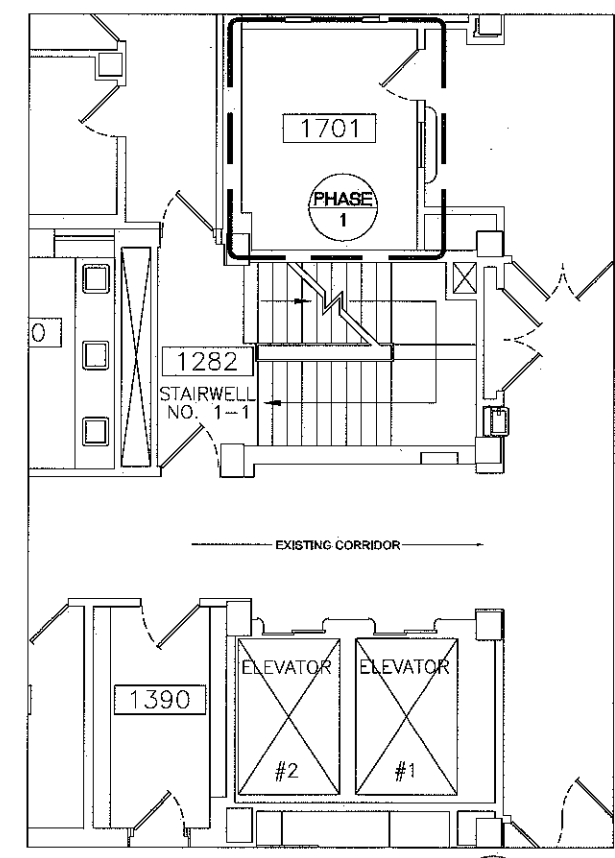

ENLARGED DETAIL PHASE 1 GI002  
2

<b>CONSULTANTS:</b> 		<b>ARCHITECT/ENGINEERS:</b> 		<b>Drawing Title:</b> FIRST FLOOR BUILDING 1 PHARMACY PHASING PLAN		<b>Project Title:</b> EMERGENCY REPAIRS TO PHARMACY		<b>Project Number:</b> 638A8-13-012		<b>Office of Construction and Facilities Management</b> 
<b>Approved Project Director:</b> 		<b>Location:</b> DES MOINES, IOWA		<b>Location:</b> DES MOINES, IOWA		<b>Building Number:</b> BUILDING 1		<b>Drawing Number:</b> GI 002		
<b>Date:</b> 12/2/2012		<b>Checked:</b> 		<b>Drawn:</b> JDM						
<b>Revisions:</b> 										