

three inches = one foot
one and one half inches = one foot
one inch = one foot
three quarters inch = one foot
one half inch = one foot
three eighths inch = one foot
one quarter inch = one foot
one eighth inch = one foot

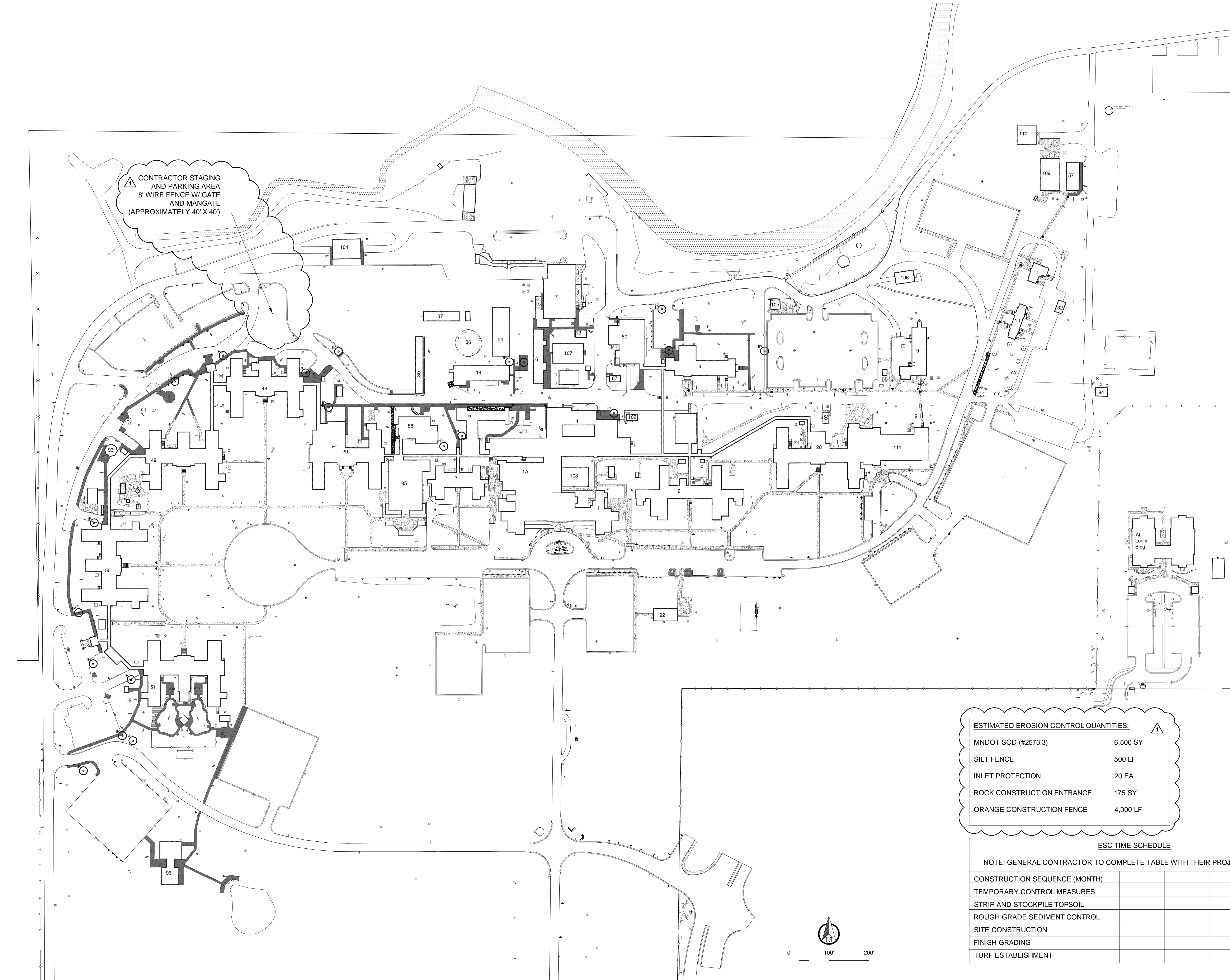

- NOTES:**
1. SALVAGE AND REPLACE EXISTING TOPSOIL. SCREEN PRIOR TO PLACEMENT AND FERTILIZE UPON STABILIZATION.
 2. SILT FENCE SHALL BE PROVIDED ON ALL AREAS DOWN GRADIENT OF CONSTRUCTION ACTIVITY.
 3. INLET PROTECTION SHALL BE PROVIDED ON ALL CATCH BASINS AND INLETS DOWN GRADIENT OF CONSTRUCTION ACTIVITY AND AS INDICATED ON THE PLAN.
 4. ALL DISTURBED AREAS SHALL BE RESTORED WITH 6" MINIMUM TOPSOIL AND STABILIZED WITH MNDOT SALT RESISTANT SOD (SPEC. #3878.2C). OVERCUT DISTURBED AREAS BY 6" OR MORE TO ACCOMMODATE FULL-WIDTH ROLLS OF SOD.
 5. PROVIDE ROCK CONSTRUCTION ENTRANCE(S). IF SEDIMENT TRACKING SHOULD OCCUR, IT IS THE CONTRACTOR'S RESPONSIBILITY TO SWEEP STREETS AS NECESSARY TO MINIMIZE SEDIMENT TRACKING.
- SEQUENCE OF CONSTRUCTION:**
1. INSTALL STABILIZED ROCK CONSTRUCTION ENTRANCE(S).
 2. PROVIDE ORANGE CONSTRUCTION FENCE AROUND ENTIRE PERIMETER OF CONSTRUCTION AREA (SEE DETAIL 5/C502).
 3. INSTALL SILT FENCE.
 4. CONTACT OWNER'S REPRESENTATIVE TO INSPECT BMP'S. GENERAL CONTRACTOR SHALL HOLD A STORM WATER PRE-CONSTRUCTION MEETING WITH ALL HIS SUB-CONTRACTORS PRIOR TO CONSTRUCTION.
 5. PROVIDE INLET PROTECTION ON INLETS DOWN GRADIENT OF CONSTRUCTION ACTIVITY.
 6. BEGIN GRADING THE SITE.
 7. TEMPORARILY SEED DISTURBED AREAS AND STABILIZE WITHIN 24 HOURS OF ACTIVELY BEING WORKED.
 8. BACKFILL ALL TRENCHES IMMEDIATELY, AND AT THE END OF THE WORKING DAY. NO OPEN TRENCHES ALLOWED OVERNIGHT.
 9. REINSTALL ANY DISTURBED INLET PROTECTION DEVICES.
 10. PREPARE SITE FOR SURFACING.
 11. CONSTRUCT CONCRETE WALK/PAVEMENT AND CURB/CURB AND GUTTER. PATCH BITUMINOUS PAVEMENT.
 12. ADJUST MISCELLANEOUS CASTINGS.
 13. COMPLETE FINAL GRADING WITH SALVAGED (SCREENED) TOPSOIL. FERTILIZE AND STABILIZE WITH SOD IMMEDIATELY AFTER COMPLETION OF GRADING.
 14. ALL EROSION AND SEDIMENT CONTROL BMP'S TO BE APPROVED BY THE VA.
 15. CONTRACTOR TO HAVE CERTIFIED PERSONNEL TO FOLLOW ALL SWPPP REQUIREMENTS.
 16. REMOVE ALL TEMPORARY EROSION AND SEDIMENT CONTROL DEVICES (ONLY IF SITE IS STABILIZED, AND APPROVED BY THE VA.)
 17. CONTRACTOR TO WORK WITH THE VA TO OBTAIN ALL REQUIRED PERMITS.
 18. ALL DISTURBED AREAS SHALL BE RESTORED AND STABILIZED WITHIN 7 DAYS OF CONSTRUCTION.

OWNER:
BARRY BAHL (OR DESIGNEE)
ST. CLOUD VA HEALTHCARE SYSTEM
4801 VETERANS DRIVE
ST. CLOUD, MN 56303

GENERAL CONTRACTOR:

CONTRACTOR SWPPP QUALIFIED PERSONNEL:

ESTIMATED EROSION CONTROL QUANTITIES:

MNDOT SOD (#2573.3)	6,500 SY
SILT FENCE	500 LF
INLET PROTECTION	20 EA
ROCK CONSTRUCTION ENTRANCE	175 SY
ORANGE CONSTRUCTION FENCE	4,000 LF

ESC TIME SCHEDULE

NOTE: GENERAL CONTRACTOR TO COMPLETE TABLE WITH THEIR PROJECT SCHEDULE

CONSTRUCTION SEQUENCE (MONTH)					
TEMPORARY CONTROL MEASURES					
STRIP AND STOCKPILE TOPSOIL					
ROUGH GRADE SEDIMENT CONTROL					
SITE CONSTRUCTION					
FINISH GRADING					
TURF ESTABLISHMENT					

LEGEND

- EXISTING CONCRETE WALK/PAVEMENT TO REMAIN
- CONCRETE WALK/PAVEMENT TO BE REMOVED AND REPLACED (56,300 SF)
- CONCRETE WALK/PAVEMENT TO BE REMOVED (1,240 SF)
- NEW CONCRETE WALK/PAVEMENT TO BE CONSTRUCTED (2,700 SF)
- SILT FENCE, AS REQUIRED (NOT SHOWN)
- INLET PROTECTION, AS REQUIRED
- SOD (MNDOT SPEC. 2575.3), AS REQUIRED (NOT SHOWN)
- FLOW DIRECTION

100% CD'S - FOR CONSTRUCTION