

TEMPORARY CONSTRUCTION BARRIER REQUIREMENTS:

1. CONTRACTOR SHALL CONSTRUCT AND MAINTAIN A 1-HOUR SMOKE TIGHT PARTITION BETWEEN THE CONSTRUCTION AREA AND THE OCCUPIED SIDE OF THE HOSPITAL. PARTITIONS SHALL BE RULI, HEAT, EXTENDING THROUGH SUSPENDED CEILINGS TO THE FLOOR SLAB OR ROOF DECK ABOVE AND SHALL BE ONE HOUR FIRE RATED.
2. TEMPORARY DOORS SHALL BE SPRINGS LOADED WITH DUST CONTROL. SEAL TEMPORARY DOORS TO PREVENT MITIGATION OF DUST. SCREEN WALL WITH TAPE IS NOT PERMITTED.
3. TEMPORARY INTERIOR WALL CONSTRUCTION SHALL BE 1 HOUR SMOKE TIGHT AND MADE OF METAL OR FIRE RESISTIVE WOOD STUD WITH TYPE "X" GYPSUM WALLBOARD. GENERAL CONTRACTOR SHALL SUBMIT A DETAILED TEMPORARY PARTITION PLAN TO CORP. FOR APPROVAL. CORP. SHALL FINISH WALLS, CEILING, AND FLOORING WITH ADEQUATE LIGHTING AND FIRE PROTECTION SYSTEM COVERAGE.

FIRE SPRINKLER:

4. CONTRACTOR SHALL MAINTAIN SPRINKLER PROTECTION IN THE CONSTRUCTION AREA AT ALL TIMES.
5. LIMITED SPRINKLER OUTAGES (8 HOURS OR LESS) WILL BE ALLOWED ONLY TO MAKE REQUIRED MODIFICATIONS IN THE SPRINKLER SYSTEM.
6. THE CEILING IS REMOVED ON THE CONSTRUCTION SIDE, THE CONTRACTOR SHALL MODIFY THE EXISTING SPRINKLER SYSTEM HEADS TO PROVIDE ADEQUATE COVERAGE IN ACCORDANCE WITH NFPA. ADDITIONAL SPRINKLER HEADS MAY BE REQUIRED TO PROVIDE ADEQUATE COVERAGE OF THE SPACE DURING CONSTRUCTION. IF AND WHERE ALLOWED BY CODE, THE CONTRACTOR MAY REUSE THE HEADS DURING THE CONSTRUCTION PHASE. FOR THE PERMANENT SPRINKLER HEADS NEW SPRINKLER HEADS SHALL BE USED.

SMOKE / HEAT DETECTORS:

7. CONTRACTOR SHALL PROVIDE AT MINIMUM 5 SMOKE AND HEAT DETECTORS WITHIN THE CONSTRUCTION AREA. THESE DETECTORS SHALL BE TIED INTO THE HOSPITALS FIRE ALARM SYSTEM FOR ADEQUATE MONITORING. COORDINATE THE LOCATIONS OF THE DETECTORS WITH THE COR.
 8. FIRE ALARM SYSTEM MUST REMAIN ACTIVE AT ALL TIMES DURING CONSTRUCTION. WHEN WORK IS REQUIRED FOR THE ABOVE MENTIONED LIFE SAFETY ELEMENTS, GC SHALL MINIMIZE SHUT DOWN TIME.
- CONSTRUCTION TIME:
9. WHILE DESTRUCTION IS OCCURRING, SENSITIVE MEDICAL ACTIVITIES WILL BE PROCEEDING IN ADJACENT AREAS. MINIMIZE NOISE AND DUST LEVELS AND TEMPORARILY SUSPEND ALL MEDICAL ACTIVITIES AS REQUESTED BY OWNER DEPT. IT WILL WORK SUCH AS JACK HAMMERING, CORE DRILLING AND OTHER LOW ACTIVITIES SHALL BE ACCOMPLISHED ON WEEKENDS BEFORE SLEEPING HOURS. THESE HOURS ARE FROM 8 AM TO 8PM. GENERAL CONTRACTOR MUST MAINTAIN NEGATIVE PRESSURE FOR AREA DURING DESTRUCTION OR CONSTRUCTION.

10. AFTER NORMA

11. WEEKEND HOURS ARE 6PM FRIDAY NIGHT UNTIL 5 AM MONDAY MORNING.
12. CONSTRUCTION OF TEMPORARY PARTITIONS SHALL BE ACCOMPLISHED AFTER NORMAL WORKING HOURS.

STANDARD OF PROCEDURES:

13. GENERAL CONTRACTOR SHALL PROVIDE AND DOCUMENT ALL INTERIM LIFE SAFETY PLANS FOR THIS PROJECT. GENERAL CONTRACTOR SHALL MAINTAIN REQUIRED MEANS OF EGRESS AT ALL TIMES.
14. GENERAL CONTRACTOR SHALL SUBMIT A COMPLETE PHASING PLAN ALONG WITH CONSTRUCTION SCHEDULE FOR REVIEW, COORDINATION AND APPROVAL BY OWNER. ALL PHASING SHALL BE COORDINATED WITH ALL TRADES.

GENERAL:

15. CONTRACTOR SHALL MAINTAIN NEGATIVE PRESSURE FOR AREAS UNDER CONSTRUCTION AND DUST FREE ENVIRONMENT AT ADJACENT CLINICAL AREAS.
16. REFER TO PROJECT MANUAL SECTION 01 00 00 GENERAL REQUIREMENTS

COORDINATION:

17. COORDINATE DEMOLITION WORK AND PHASING PLAN WITH ASBESTOS REMOVAL DRAWINGS AND SPECIFICATIONS.

PHASE 1	365 CALENDAR DAYS
TRANSITION BETWEEN PHASES	30 CALENDAR DAYS
PHASE 2	270 CALENDAR DAYS

NOTE: CONTRACTOR SHALL PROVIDE PERIODIC CONSTRUCTION SCHEDULE TO COR AND A/E ACCORDING TO PROJECT MANUAL.

NOTES:

- A. RATED WALL DESIGNATIONS ARE DRAWN THROUGH OPENINGS TO INDICATE THAT THE WALL CONSTRUCTION ABOVE THE OPENING HAS THE SAME RATING AS THE CONSTRUCTION ON EITHER SIDE OF OPENING.
- B. THE CONTRACTOR MUST SUBMIT DOCUMENTATION WHEN RATED WALL ASSEMBLY HAS BEEN TESTED AND APPROVED BY AGENCY OTHER THAN UL.
- C. THE CONTRACTOR SHALL VERIFY EXISTING RATED WALLS. IF DEFICIENCIES ARE FOUND, THE CONTRACTOR SHALL UPGRADE WALL RATINGS AS ON LIFE SAFETY PLAN AIN AND AIE.

- NON RATED SMOKE PARTITION**
DOOR AND FRAME - NOT RATED
DAMPERS - NOT REQUIRED
PENETRATIONS-PERFETER - SEALED
EXTENDING AT LEAST ONE LAYER OF GYPSUM WALL BOARD
TO DECK ABOVE ON ENTIRE WALL CONSTRUCTION TO
SMOKE RESISTANT CORRIDOR CEILING
- ONE HOUR FIRE BARRIER**
DOOR AND FRAME - 45 MIN RATING
DAMPERS - FIRE - SEE TECH CODE
PENETRATIONS-PERFETER - SEALED
EXTEND ENTIRE WALL CONSTRUCTION TO DECK ABOVE.
- TWO HOUR FIRE BARRIER**
DOOR AND FRAME - 90 MIN RATING
DAMPERS - FIRE - SEE TECH CODE
PENETRATIONS-PERFETER - FIRE CALKED
EXTEND ENTIRE WALL CONSTRUCTION TO DECK ABOVE.
- FIRE SMOKE BARRIER**
DOOR AND FRAME - 90 MIN RATING
DAMPERS - FIRE - SEE TECH CODE
PENETRATIONS-PERFETER - SEALED
EXTEND ENTIRE WALL CONSTRUCTION TO DECK ABOVE.
- ONE HOUR FIRE-SMOKE BARRIER**
DOOR AND FRAME - 90 MIN RATING
DAMPERS - FIRE AND SMOKE - SEE TECH CODE
PENETRATIONS-PERFETER - FIRE CALKED
EXTEND ENTIRE WALL CONSTRUCTION TO DECK ABOVE.
- TWO HOUR FIRE-SMOKE BARRIER**
DOOR AND FRAME - 90 MIN RATING
DAMPERS - FIRE AND SMOKE - SEE TECH CODE
PENETRATIONS-PERFETER - FIRE CALKED
EXTEND ENTIRE WALL CONSTRUCTION TO DECK ABOVE.

DURING PROJECT CONSTRUCTION:

1. ISOLATE HVAC SYSTEM IN AREA WHERE WORK IS TO BE DONE TO PREVENT CONTAMINATION OF DUCT SYSTEM.
2. COMPLETE ALL CRITICAL BARRIERS IE. SHEETROCK, PLYWOOD, SEAL TO SEAL AREA FROM NON-WORK AREA OR IMPELMENT CONTROL CUBE METHOD (CAST WITH PLASTIC COVERING AND SEAL) TO PREVENT AIR FROM ENTERING WORK AREA. VACUUM PRIOR FOR VACUUMING (FOR EXIT) BEFORE CONSTRUCTION BEGINS.
3. MAINTAIN NEGATIVE AIR PRESSURE WITHIN WORK SPACE. BY DISCHARGING AIR TO EXTERIOR. CONTRACTION MAY USE TEMPORARY FAN THAT HAS A HEPA FILTER WITH DISCHARGE TO EXTERIOR SPACE OUTSIDE MECHANICAL ROOM. USE MECHANICAL PLANS.
4. SEAL ALL HOLES, PIPES, CONDUITS, PENETRATIONS OR FRACTURES WITHIN ENVELOPE OF WORK AREA IN APPROPRIATE MANNER.
5. CONTRACT WITH AN ADEQUATELY TRAINED PERSONNEL, TO PASS THROUGH THIS ROOM SO THEY CAN BE VACUUMED USING A HEPA VACUUM CLEANER BEFORE LEAVING WORK SITE OR THEY CAN WEAR CLOTH OR PAPER COVERALLS THAT ARE REMOVED EACH TIME THEY LEAVE THE WORK SITE. KEEP AREA ADJACENT OF EXIT ANTE ROOM CLEAN. LEAN AS REGARDS PROJECT.
6. DURING DEMOLITION OR ANY DUST PRODUCING WORK OR WORK IN THE CEILING, DISPOSABLE SHOES OR SHOE COVER MUST BE WORK AND REMOVE IN THE ANTE ROOM WHEN THE WORKER ENTERS THE WORK SITE.
7. DO NOT REQUIRE CONSTRUCTION BARRIERS IN THE AREA UNTIL COMPLETE PROJECT IS SIGNED OFF BY ARCHITECT AND HAS INSPECTION CONTROL, DEPARTMENT, AND THOROUGHLY CLEANED BY WAS ENVIRONMENTAL SERVICES DEPARTMENT.
8. PROHIBIT DUSTY DEBRIS FROM ANY TYPE OF CONSTRUCTION AREA AND REFUSE OR CLEAN WHEN NO LONGER EFFECTIVE.
9. KEEP AREA BROOM CLEAN AND REMOVE DEBRIS DAILY IN MANNER (PATH AS NOTED.

INFECTIOUS CONTROL NOTES - UPON PROJECT COMPLETION:

1. REMOVE BARRIER MATERIAL CAREFULLY TO MINIMIZE SPREADING OF DIRT AND DEBRIS ASSOCIATED WITH CONSTRUCTION.
2. CONTAIN CONSTRUCTION WASTE BEFORE TRANSPORT IN TIGHTLY COVERED CONTAINERS.
3. COVER TRANSPORT RECEPTACLES OR CARTS. TAPE COVERINGS UNLESS SOLID LID.
4. VACUUM WORK AREA WITH HEPA FILTERED VACUUM.
5. WIP UP AREA WITH DISINFECTANT.
6. REMOVE ISOLATION OF HVAC SYSTEMS IN AREAS WHERE WORK IS BEING PERFORMED.
7. WIFE CASEWORK AND HORIZONTAL SURFACES AT COMPLETION OF PROJECT.
8. CONTRACTOR IS TO PERIODICALLY REMOVE DEBRIS FROM REMOVAL CARTS.

INFECTIOUS CONTROL SUBMITTALS:

1. CONTRACTOR IS TO REVIEW INFECTIOUS CONTROL PROCEDURES INCLUDING LOCATION AND DETAILS OF BARRIERS, MEANS OF CREATING NEGATIVE PRESSURE, ETC. PRIOR TO START OF PROJECT FOR REVIEW BY OWNER HEALTH AND SAFETY AND FACILITIES PERSONNEL RESPONSIBLE FOR MANAGING THE PROJECT.
2. CONTRACTOR SHALL SUBMIT PRODUCT DATA FOR REVIEW AS REQUESTED.

INFECTIOUS CONTROL PRODUCTS & MATERIALS:

1. CONSTRUCTION BARRIERS SHALL CONSIST OF METAL STUDS WITH 6 MILL THICK FIRE RETARDANT PLASTIC SHEETS OR GYPSUM BOARD, UNLESS OTHERWISE NOTED.
2. SOLID CORE WOODEN DOORS IN METAL FRAME - PAINTED.
3. EXHAUST HOSES ARE TO BE HEAVY DUTY, STEEL REINFORCED HOSE, WPC SUCH AS MANUFACTURED BY FEDERAL HOSE MFG. PAINSVILLE, OH OR EQUIVALENT.
4. DISINFECTANT AS APPROVED BY VA HOSPITAL.

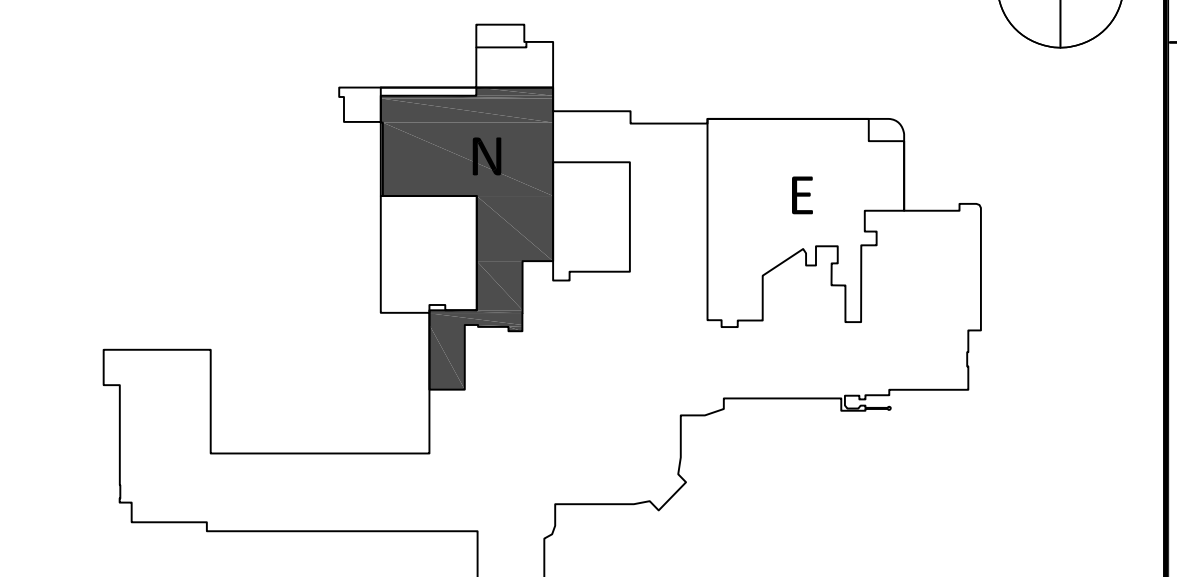

ale: AS NOTED

		CONSULTANTS:		PROJECT MANAGERS AND ENGINEERS:		Drawing Title		Project Title		Project Number		Office of Construction and Facilities Management	
		 The Estopinal Group Estopinal Engineering Insurance 820 Jordan Street, Suite 507 tel. 318.424.3700 Shreveport, LA 71103 tel. 318.424.3164		 TNF A VETERAN OWNED COMPANY 3 EXECUTIVE COURT, UNIT 4 SOUTH BARRINGTON, IL 60010		PHASING PLAN - I NORTH		RENOVATE ED # PRIMARY CARE Phase I		667-10-100 Building Number 1 N			
Revisions:		Date				Approved: Project Director		Location		Drawing Number		 Department of Veterans Affairs	
								SHREVEPORT VAMC 510 EAST STONER AVE		A.I.N.I Dwg. 8 of 112			
								Date		Checked		Drawn	
								01/09/13		JAH		CSH	