

three inches = one foot
one and one half inches = one foot
one inch = one foot
three quarters inch = one foot
one half inch = one foot
three eighths inch = one foot
one quarter inch = one foot
one eighth inch = one foot



01 PHASE 2 PHASING PLAN - FIRST FLOOR EAST
SCALE: 1/8"=1'-0"

PHASING PLAN KEYNOTES:

- 1. EAST (PHASE 2)**
- PHASE 2A SHALL BE COMPLETED IN 90 DAYS. PHASE 2B SHALL BE CONDUCTED IN CONJUNCTION WITH PHASE 2A.
2. TEMPORARY PARTITION DURING PHASE 2A REFER TO GENERAL PHASING PLAN BELOW FOR ADDITIONAL INFORMATION.
3. TEMPORARY DOOR DURING PHASE 2A DOOR SHALL BE HINGED TYPE AND DUST FREE. PLACE A SIGN ON THE DOOR "CONSTRUCTION ACCESS - NOT FOR PUBLIC USE".
4. TEMPORARY PARTITION DURING PHASE 2B REFER TO GENERAL PHASING PLAN BELOW FOR ADDITIONAL INFORMATION.
5. TEMPORARY DOOR DURING PHASE 2B DOOR SHALL BE HINGED TYPE AND DUST FREE. PLACE A SIGN ON THE DOOR "CONSTRUCTION ACCESS - NOT FOR PUBLIC USE".
- PHASE 2C SHALL BE CONDUCTED UPON COMPLETION OF PHASE 2A.
6. PHASE 2D: PUBLIC CORRIDOR WORK SHALL BE PERFORMED ON WEEKENDS OR AFTER HOURS WHEN WORK IS CONDUCTED ON WEEKDAYS. GENERAL CONTRACTOR SHALL RETURN CORRIDOR TO ACCEPTABLE CONDITIONS FOR PUBLIC USE THE NEXT DAY.
7. LIMIT OF FINISHES REFER TO ID SHEETS.
8. FAN WITH HEPA FILTER TO BE INSTALLED IN EXISTING WINDOW OPENINGS TO ACHIEVE NEGATIVE PRESSURE DURING CONSTRUCTION - SEE MECHANICAL.

GENERAL PHASING NOTES:

- TEMPORARY CONSTRUCTION BARRIER REQUIREMENTS:**
1. CONTRACTOR SHALL CONSTRUCT AND MAINTAIN A 1-HOUR SMOKE TIGHT PARTITION BETWEEN THE CONSTRUCTION AREA AND THE OCCUPIED SIDE OF THE HOSPITAL. PARTITIONS SHALL BE FULL HEIGHT, EXTENDING THROUGH SUSPENDED CEILING TO THE FLOOR SLAB OR ROOF DECK ABOVE AND SHALL BE ONE HOUR FIRE RATED.
2. TEMPORARY DOORS SHALL BE SPRING LOADED WITH DUST CONTROL. SEAL TEMPORARY DOORS TO PREVENT MITIGATION OF DUST. SCREEN WALL WITH TAPE IS NOT PERMITTED.
3. TEMPORARY INTERIOR WALL CONSTRUCTION SHALL BE 1 HOUR SMOKE TIGHT AND MADE OF METAL OR FIRE RESISTIVE WOOD STUD WITH TYPE "X" GYPSUM WALLBOARD. GENERAL CONTRACTOR SHALL SUBMIT A DETAILED TEMPORARY PARTITION PLAN TO COR FOR APPROVAL. CLINICAL SIDE SHALL HAVE FINISHED WALLS, CEILING, AND FLOORING WITH ADEQUATE LIGHTING AND FIRE PROTECTION SYSTEM COVERAGE.
- FIRE SPRINKLER:**
4. CONTRACTOR SHALL MAINTAIN SPRINKLER PROTECTION IN THE CONSTRUCTION AREA AT ALL TIMES.
5. LIMITED SPRINKLER OUTAGES (4 HOURS OR LESS) WILL BE ALLOWED ONLY TO MAKE REQUIRED MODIFICATIONS IN THE SPRINKLER SYSTEM.
6. THE CEILING IS REMOVED ON THE CONSTRUCTION SIDE, THE CONTRACTOR SHALL MODIFY THE EXISTING SPRINKLER SYSTEM HEADS TO PROVIDE ADEQUATE COVERAGE IN ACCORDANCE WITH NFPA. ADDITIONAL SPRINKLER HEADS MAY BE REQUIRED TO PROVIDE ADEQUATE COVERAGE OF THE SPACE DURING CONSTRUCTION. IF AND WHERE ALLOWED BY CODE, THE CONTRACTOR MAY REUSE THE HEADS DURING THE CONSTRUCTION PHASE. FOR THE PERMANENT SPRINKLER HEADS, NEW SPRINKLER HEADS SHALL BE USED.
- SMOKE / HEAT DETECTORS:**
7. CONTRACTOR SHALL PROVIDE AT MINIMUM 5 SMOKE AND HEAT DETECTORS WITHIN THE CONSTRUCTION AREA. THESE DETECTORS SHALL BE TIED INTO THE HOSPITAL FIRE ALARM SYSTEM FOR ADEQUATE MONITORING. COORDINATE THE LOCATIONS OF THE DETECTORS WITH THE COR.
8. FIRE ALARM SYSTEM MUST REMAIN ACTIVE AT ALL TIMES DURING CONSTRUCTION. WHEN WORK IS REQUIRED FOR THE ABOVE MENTIONED LIFE SAFETY ELEMENTS, GC SHALL MINIMIZE SHUT DOWN TIME.

- CONSTRUCTION TIME:**
9. WHILE DEMOLITION IS OCCURRING SENSITIVE MEDICAL ACTIVITIES WILL BE PROCEEDING IN ADJACENT AREAS. MINIMIZE NOISE AND DUST LEVELS AND TEMPORARILY SUSPEND DEMOLITION ACTIVITIES AS REQUESTED BY OWNER. DEMOLITION WORK SUCH AS JACK HAMPERING, CORE DRILLING AND OTHER LOUD ACTIVITIES SHALL BE ACCOMPLISHED ON WEEKENDS BEFORE SLEEPING HOURS. THESE HOURS ARE FROM 8 AM TO 6PM. GENERAL CONTRACTOR MUST MAINTAIN NEGATIVE PRESSURE FOR AREAS UNDER DEMOLITION OR CONSTRUCTION.
10. AFTER NORMAL HOURS ARE 6PM UNTIL 2 AM THE FOLLOWING DAY ON WEEKDAYS.
11. WEEKEND HOURS ARE 6PM FRIDAY NIGHT UNTIL 5 AM MONDAY MORNING.
12. CONSTRUCTION OF TEMPORARY PARTITIONS SHALL BE ACCOMPLISHED AFTER NORMAL WORKING HOURS.
- STANDARD OF PROCEDURES:**
13. GENERAL CONTRACTOR SHALL PROVIDE AND DOCUMENT ALL INTERIM LIFE SAFETY PLANS FOR THIS PROJECT. GENERAL CONTRACTOR SHALL MAINTAIN REQUIRED MEANS OF EGRESS AT ALL TIMES.
14. GENERAL CONTRACTOR SHALL SUBMIT A COMPLETE PHASING PLAN ALONG WITH CONSTRUCTION SCHEDULE FOR REVIEW, COORDINATION AND APPROVAL BY OWNER. ALL PHASING SHALL BE COORDINATED WITH ALL TRADES.
- GENERAL:**
15. CONTRACTOR SHALL MAINTAIN NEGATIVE PRESSURE FOR AREAS UNDER CONSTRUCTION AND DUST FREE ENVIRONMENT AT ADJACENT CLINICAL AREAS.
16. REFER TO PROJECT MANUAL SECTION 01 20 00 GENERAL REQUIREMENTS.

- COORDINATION:**
17. COORDINATE DEMOLITION WORK AND PHASING PLAN WITH ASBESTOS REMOVAL DRAWINGS AND SPECIFICATIONS.

ESTIMATED PROJECT DURATION:

PHASE 1	365 CALENDAR DAYS
TRANSITION BETWEEN PHASES	30 CALENDAR DAYS
PHASE 2	270 CALENDAR DAYS

NOTE: CONTRACTOR SHALL PROVIDE PERIODIC CONSTRUCTION SCHEDULE TO COR AND A/E ACCORDING TO PROJECT MANUAL

WALL RATINGS LEGEND:

- NOTES:**
- A. RATED WALL DESIGNATIONS ARE DRAIN THROUGH OPENINGS TO INDICATE THAT THE WALL CONSTRUCTION ABOVE THE OPENING HAS THE SAME RATING AS THE CONSTRUCTION ON EITHER SIDE OF OPENING.
- B. THE CONTRACTOR MUST SUBMIT DOCUMENTATION WHEN RATED WALL ASSEMBLY HAS BEEN TESTED AND APPROVED BY AGENCY OTHER THAN UL.
- C. THE CONTRACTOR SHALL VERIFY EXISTING RATED WALLS. IF DEFICIENCIES ARE FOUND, THE CONTRACTOR SHALL UPGRADE WALL RATINGS AS ON LIFE SAFETY PLAN A/E AND A/E.
- NON RATED SMOKE PARTITION**
- DOOR AND FRAME - NOT RATED
- DAMPERS - NOT REQUIRED
- PENETRATIONS/PERIMETER - SEALED
- EXTEND AT LEAST ONE LAYER OF GYPSUM WALL BOARD TO DECK ABOVE OR ENTIRE WALL CONSTRUCTION TO SMOKE RESISTANT CORRIDOR CEILING
- ONE HOUR FIRE BARRIER**
- DOOR AND FRAME - 18 MIN. RATING
- DAMPERS - FIRE - SEE MECH CODE
- PENETRATIONS/PERIMETER - FIRE CALLED
- EXTEND ENTIRE WALL CONSTRUCTION TO DECK ABOVE
- TWO HOUR FIRE BARRIER**
- DOOR AND FRAME - 30 MIN. RATING
- DAMPERS - FIRE - SEE MECH CODE
- PENETRATIONS/PERIMETER - FIRE CALLED
- EXTEND ENTIRE WALL CONSTRUCTION TO DECK ABOVE
- FIRE SMOKE BARRIER**
- DOOR AND FRAME - 20 MIN. RATING
- DAMPERS - SMOKE - SEE MECH CODE
- PENETRATIONS/PERIMETER - SEALED
- EXTEND ENTIRE WALL CONSTRUCTION TO DECK ABOVE
- ONE HOUR FIRE SMOKE BARRIER**
- DOOR AND FRAME - 18 MIN. RATING
- DAMPERS - FIRE AND SMOKE - SEE MECH CODE
- PENETRATIONS/PERIMETER - FIRE CALLED
- EXTEND ENTIRE WALL CONSTRUCTION TO DECK ABOVE
- TWO HOUR FIRE SMOKE BARRIER**
- DOOR AND FRAME - 30 MIN. RATING
- DAMPERS - FIRE AND SMOKE - SEE MECH CODE
- PENETRATIONS/PERIMETER - FIRE CALLED
- EXTEND ENTIRE WALL CONSTRUCTION TO DECK ABOVE

INFECTION CONTROL NOTES:

- DURING PROJECT CONSTRUCTION:**
1. ISOLATE HVAC SYSTEM IN AREA WHERE WORK IS TO BE DONE TO PREVENT CONTAMINATION OF DUCT SYSTEM.
2. COMPLETE ALL CRITICAL BARRIERS IE. SHEETROCK, FLYWOOD, PLASTIC, TO SEAL AREA FROM NON-WORK AREA OR IMPLEMENT CONTROL CUBE METHOD / CART WITH PLASTIC COVERING AND SEALED CONNECTION TO WORK SITE WITH HEPA VACUUM PRIOR FOR VACUUMING PRIOR TO EXIT BEFORE CONSTRUCTION BEGINS.
3. MAINTAIN NEGATIVE AIR PRESSURE WITHIN WORK SPACE BY DISCHARGING AIR TO EXTERIOR. CONTRACTOR MAY USE TEMPORARY FAN THAT HAS A HEPA FILTER WITH DISCHARGE TO EXTERIOR SPACE OUTSIDE MECHANICAL ROOM. SEE MECHANICAL PLANS.
4. SEAL ALL HOLES, PIPES, CONDUITS, PENETRATIONS OR PUNCTURES WITHIN ENVELOPE OF WORK AREA IN APPROPRIATE MANNER.
5. CONSTRUCT "ANTE-ROOM" AND REQUIRE ALL PERSONNEL TO PASS THROUGH THIS ROOM SO THEY CAN BE VACUUMED USING A HEPA VACUUM CLEANER BEFORE LEAVING WORK SITE OR THEY CAN WEAR CLOTH OR PAPER COVERALLS THAT ARE REMOVED EACH TIME THEY LEAVE THE WORK SITE. KEEP AREA ADJACENT TO ANTE ROOM MOFFED LEAN AS REQUIRED BY PROJECT TRAFFIC.
6. DURING DEMOLITION OR ANY DUST PRODUCING WORK OR WORK IN THE CEILING, DISPOSABLE BAGS OR SHOE COVERS MUST BE WORN AND REMOVE IN THE "ANTE-ROOM" WHEN THE WORKER EXITS THE WORK SITE.
7. DO NOT REMOVE CONSTRUCTION BARRIERS FROM WORK AREA UNTIL COMPLETE PROJECT IS SIGNED OFF BY ARCHITECT AND VA'S INFECTION CONTROL DEPARTMENT, AND THOROUGHLY CLEANED BY VA'S ENVIRONMENTAL SERVICES DEPARTMENT.
8. PROVIDE DUST "STICKY" MAT ENTRANCE/EXIT OF CONSTRUCTION AREA AND REPLACE OR CLEAN WHEN NO LONGER EFFECTIVE.
9. KEEP AREA BROOM CLEAN AND REMOVE DEBRIS DAILY IN MANNER / PATH AS NOTED.
- INFECTION CONTROL NOTES - UPON PROJECT COMPLETION:**
1. REMOVE BARRIER MATERIAL CAREFULLY TO MINIMIZE SPREADING OF DIRT AND DEBRIS ASSOCIATED WITH CONSTRUCTION.
2. CONTAIN CONSTRUCTION WASTE BEFORE TRANSPORT IN TIGHTLY COVERED CONTAINERS.
3. COVER TRANSPORT RECEPTACLES OR CARTS. TAPE COVERING UNLESS SOLID LID.
4. VACUUM WORK AREA WITH HEPA FILTERED VACUUM.
5. WIP TOP AREA WITH DISINFECTANT.
6. REMOVE ISOLATION OF HVAC SYSTEMS IN AREAS WHERE WORK IS BEING PREPARED.
7. LIFE CASEWORK AND HORIZONTAL SURFACES AT COMPLETION OF PROJECT.
8. CONTRACTOR IS TO PERIODICALLY REMOVE DEBRIS FROM REMOVAL CARTS.
- INFECTION CONTROL SUBMITTALS:**
1. CONTRACTOR IS TO REVIEW INFECTION CONTROL PROCEDURES INCLUDING LOCATION AND DETAILS OF BARRIERS MEANS OF CREATING NEGATIVE PRESSURE ETC. PRIOR TO START OF PROJECT FOR REVIEW BY OWNER HEALTH AND SAFETY AND FACILITIES PERSONNEL RESPONSIBLE FOR MANAGING THE PROJECT.
2. CONTRACTOR SHALL SUBMIT PROJECT DATA FOR REVIEW AS REQUESTED.
- INFECTION CONTROL PRODUCTS & MATERIALS:**
1. CONSTRUCTION BARRIERS SHALL CONSIST OF METAL STUDS WITH 6" MILL THICK FIRE RETARDANT PLASTIC SHEETS OR GYPSUM BOARD UNLESS OTHERWISE NOTED.
2. SOLID CORE WOODEN DOORS IN METAL FRAME - PAINTED.
3. EXHAUST HOSES ARE TO BE HEAVY DUTY STEEL REINFORCED HOSE UP TO SUCH AS MANUFACTURED BY FEDERAL HOSE MFG. PAINSVILLE, OH OR EQUIVALENT.
4. DISINFECTANT AS APPROVED BY VA HOSPITAL.

KEYPLAN: FIRST FLOOR

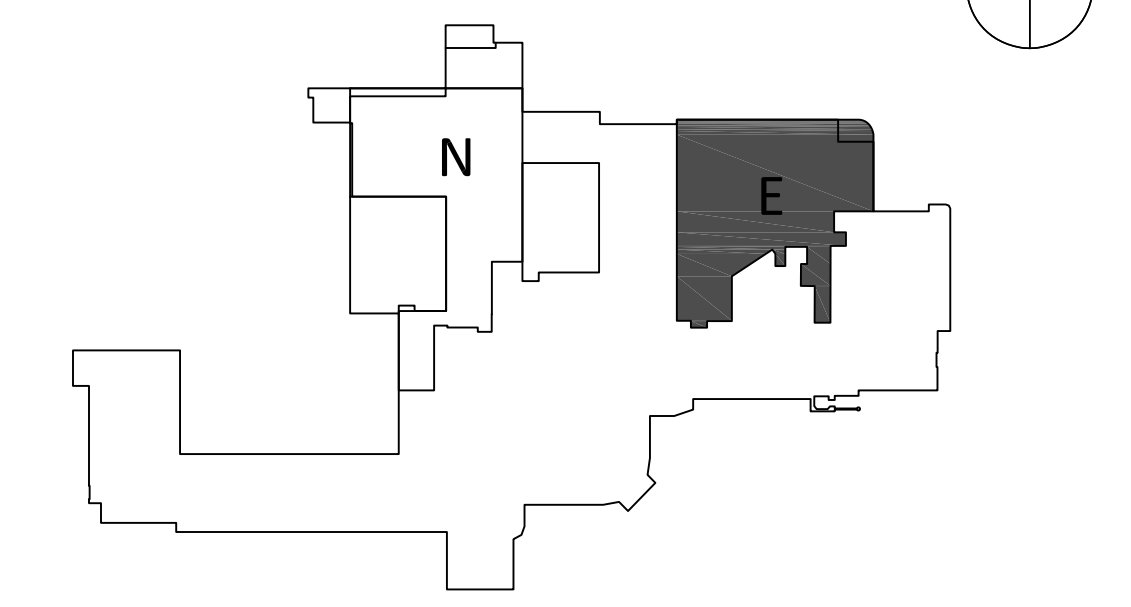

CONSULTANTS:		PROJECT MANAGERS AND ENGINEERS:		Drawing Title PHASING PLAN - I EAST		Project Title RENOVATE ED & PRIMARY CARE Phase 2		Project Number 667-10-100		Office of Construction and Facilities Management Department of Veterans Affairs	
				Approved: Project Director		Location SHREVEPORT VAMC 510 EAST STONER AVE		Building Number 1E			
						Date 01/09/13		Drawing Number A1.E1			
						Checked JAH		Drawn CSH			
Revisions:		Date		THE ESTOPINAL GROUP 320 Jordan Street, Suite 507 Shreveport, LA 71101 tel. 318.424.3700 fax 318.424.3764		TNF A VETERAN OWNED COMPANY 3 EXECUTIVE COURT, UNIT 4 SOUTH BARRINGTON, IL 60010		Drawn 10 of 112			